

✓
"Submittal" ✓

✓
TR #8 REQUEST

✓
OPERATOR: HIGH MOUNTAIN MINING COMPANY, LLC
OPERATION NAME: ALMA PLACER MINE
LOCATION: 460 SOUTH MAIN STREET, ALMA, CO 80420
PERMIT NUMBER: M-1985-029 ✓

RECEIVED

✓ JUN 19 2012

Division of Reclamation,
Mining & Safety
to

High Mountain Mining Company, LLC is applying for a technical revision (TR) to their permit to construct a 13,600 square foot building on their currently permitted area to house the company's processing equipment and serve as the company's business office. The proposed building is a pre-engineered - LM Kersting of Buena Vista, Colorado provided the engineering and design of the structure including design of the footings. LM Kersting will oversee all construction activities. All local permits have been obtained.

LOCATION ON PERMITTED AREA:

Please refer to the attached maps that show the exact location of the proposed building:

Map Number 1:

Wide view of the proposed location "yellow rectangle" and its relationship to the existing processing facility (small white building) adjacent to the north side of the proposed building.

Map Number 2:

Close up of proposed location "yellow rectangle". The exact GPS coordinates of the corners are shown below:

NE Corner – 13S 408987E, 4348693N
SE Corner – 13S 409001E, 4348672N
NW Corner – 13S 408940E, 4348664N
SW Corner – 13S 408954E, 4348643N

Map Number 3:

Close up of proposed building location on topo map.

BUILDING & FOUNDATION SIZING:

Building Specifications:

Square Feet – 13,600
Cubic Feet – 376,000

Foundation Specifications:

Footings (Reinforced) – 149 Cubic Feet
Floor Slab – 6" Thick Reinforced – 6,800 Cubic Feet

Please find a check attached for the TR Application Fee in the amount of \$175.

L. Steven Palmer

L. Steven Palmer
High Mountain Mining Company, LLC
3040 S. Vallejo Street
Englewood, CO 80110
303-680-2724 (Office)
402-650-3877 (Cell)
spalmer1215@aol.com

Division of Reclamation, Mining, and Safety

Fee Receipt for M1985029

High Mountain Mining Co., LLC

000000000

Receipt #: 13142

Date: 06/19/2012

Permit: M1985029

Payment Method	Revenue Code	Fee Description/Notes	Amount
1167	4300-11	Minerals Technical Revision M-1985-029	\$175.00
Receipt Total:			\$175.00

MAP #1
HIGH MOUNTAIN MINING CO
PERMIT # M-1985-029
ALMA PLACER MINE
TR #8 REQUEST

NE Corner
SE Corner
NW Corner
SW Corner

100 ft

Alma Mine

Singleton Rd

S Main St

Co Rd 19

Chisholm Way

Robeson St

Spine St

S Oak St

Spruce St

W 1st St

W 2nd St



transformer on pole



NE Corner

SE Corner

SW Corner

NW Corner

100 ft

MAP #2
HIGH MOUNTAIN MINING CO
PERMIT # M-1985-029
ALMA PLACER MINE
TR #8 REQUEST

© 2012 Google

Image © 2012 GeoEye

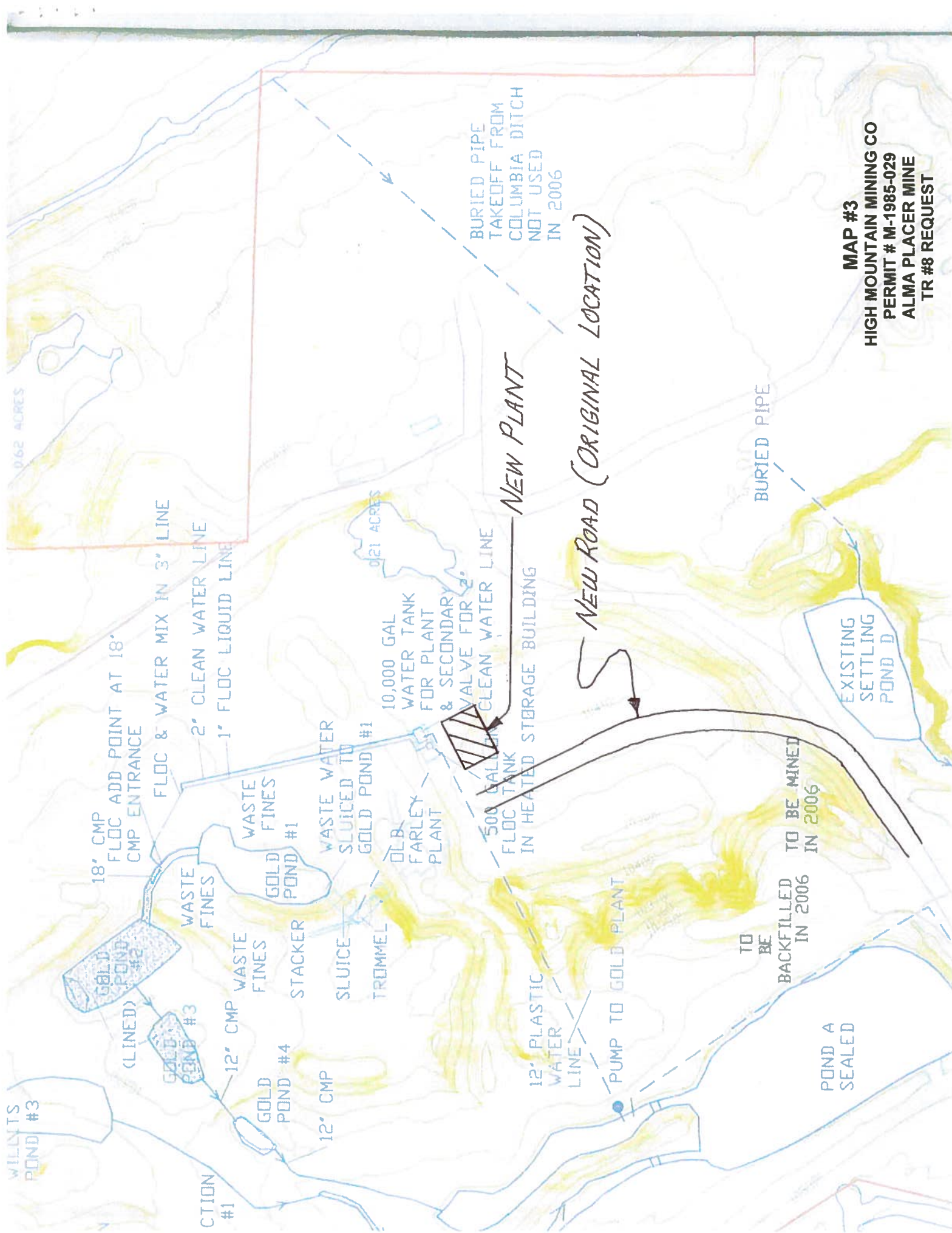

MAP #3
HIGH MOUNTAIN MINING CO
PERMIT # M-1985-029
ALMA PLACER MINE
TR #8 REQUEST