

LEGEND

BOUNDARIES

DRMS Permit Boundary

BUILDINGS AND RELATED STRUCTURES

Buildings

ROADS AND RELATED FEATURES

Light duty road, gravel

RIVERS, LAKES, SHORELINES, AND CANALS

Intermittent stream/ditch

Intermittent lake/pond

VEGETATION

Reclamation Seeding

CONTOURS

Existing Major Contour

Existing Minor Contour

Reclamation Major Contour

Reclamation Minor Contour

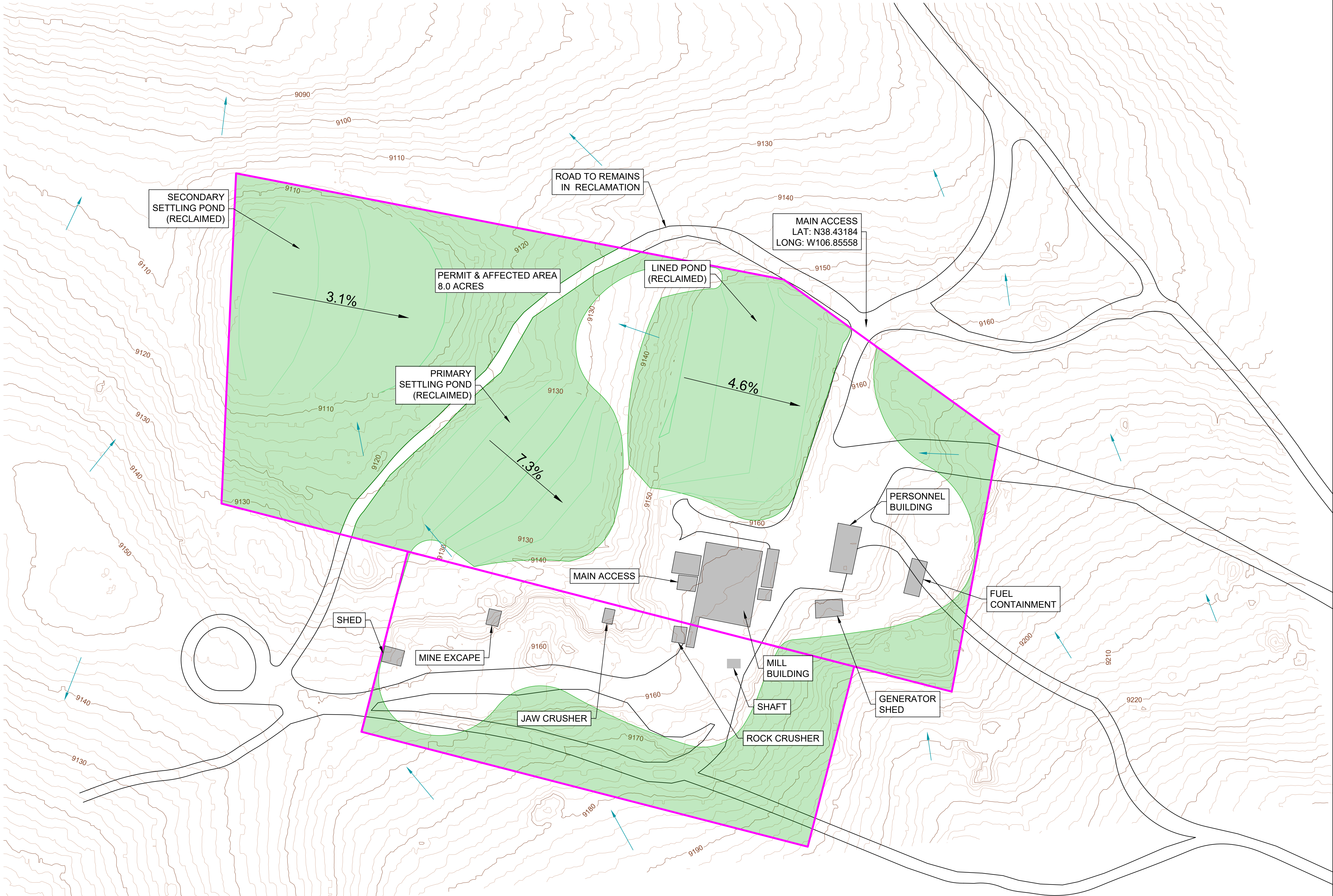

F-1 Reclamation Plan

Lucky Strike Mine & Mill

DRMS Permit Number: M-1982-020

ALSH LLC

Mine Entry Location:

Latitude: 38.43184

Longitude: -106.85558

State: CO

County: Gunnison

Nearest Town: Gunnison

Section: 10

Township: 48N

Range: 11E

PM: 6th

Major Watershed:

Gunnison River

MSHA ID: 889

Map Scale: 1" = 100'

0

100

200

North Arrow

Map Georeferencing Information:

Datum: NAD83

Projection: CO SOUTH

Survey Source: CO LIDAR

Drawn by: LA

Date: 09/10/25

Imagery Source: N/A

Checked by: BEL

Date: 09/15/25

Survey Date: 2016

Approved by: BEL

Date: 09/15/25

Imagery Date: N/A

File Name: Lucky Strike Mill

Plot Date: 9/15/25

Lewicki & Associates

3375 West Powers Circle

Littleton, CO USA 80123

(303)-346-5196

info@lewicki.biz

