



September 9, 2025

Ms. Jocelyn Carter
Division of Reclamation, Mining and Safety
1313 Sherman Street, Room 215
Denver, CO 80203

RE: Rich Pit, M-1985-218, Technical Revision (TR-2), Mine Plan and Reclamation Plan Update

Dear Ms. Carter

Martin Marietta Materials, Inc. ("Martin Marietta") submits this Technical Revision to Permit M-1985-218 to update the mining and reclamation plan to reflect mining of most of the Phase II area of 56.7 acres that was approved in TR-1 on December 14, 2023 and allow the Division to adjust the reclamation bond, if needed.

I have attached the following updated Exhibits:

- Exhibit C – Mining Plan Maps
- Exhibit F – Reclamation Plan Maps

This is being submitted as a Technical Revision because the changes do not have more than a minor effect upon the approved mine permit and reclamation plan due to the following:

- Mining and reclamation remains within the 282 acre Affected Area previously approved for mining in Amendment 01 ("AM 01") on July 18, 1996, and within the Phase I and Phase II areas that were approved in TR-1.
- No changes to the approved reclamation plan which calls for wildlife habitat in the mining area and commercial/industrial area in the plant area.
- The additional detail shown on the attached Mining and Reclamation plan Maps demonstrate how the mine will be further developed and reclaimed as contemplated in AM 01 and TR-1.

Exhibit C: Mining Plan Map

Mining will be accomplished within the 282-acre Affected Area per the previously approved mining plan at AM 01, Exhibit D. Enclosed Exhibits C and F show that mining will occur take place in 100.2 acres, which includes 54.6 acres included as Phase I in TR-1 and 45.6 acres that were shown as Phase II in TR-1.

Other areas within the Affected Area may still be used for interim uses such as overburden storage, silt storage, material hauling, and fresh water resources associated with the mineral extraction area as shown on the attached Exhibits.

A Substitute Water Supply Plan ("SWSP") is currently approved by the Colorado Division of Water Resources for all exposed groundwater surface area within the mining area. Martin Marietta will ensure an approved Substitute Water Supply Plan remains in place as mining progresses.

[West Division](#)

1627 Cole Blvd, Suite 200, Lakewood, CO 80401

t. (720) 245-6400 f. (303) 657-4212

www.martinmarietta.com

Exhibit F: Reclamation Plan Map

The mining area will be reclaimed as wildlife habitat and the Plant Site will be reclaimed as commercial/industrial area per the approved Reclamation Plan in AM 01, Exhibit E. For your information in calculating the bond, the mining area will be reclaimed by backfilling to an elevation that is 2 feet above the groundwater level. This will require 2,476,110 cubic yards of backfill material. The backfill will include overburden and waste material removed from the mining area.

The total available volume of material for backfilling includes:

- 889,460 cubic yards of overburden and waste that is either temporarily stored or still to be removed from mining area.
- 1,586,650 cubic yards to be brought in from owned neighboring property.

As stated in the previously approved Exhibit E, all slopes will be graded to no steeper than 3H:1V. The roads into the property will remain in place after mining. Reclaimed areas will be seeded with the approved seed mix after final grading.

Should you have additional questions please contact me at 720-612-6232 or phillip.courtney@martinmarietta.com.

Sincerely,

A handwritten signature in blue ink, appearing to read "Phillip J. Courtney".

Phillip J. Courtney
Land Manager

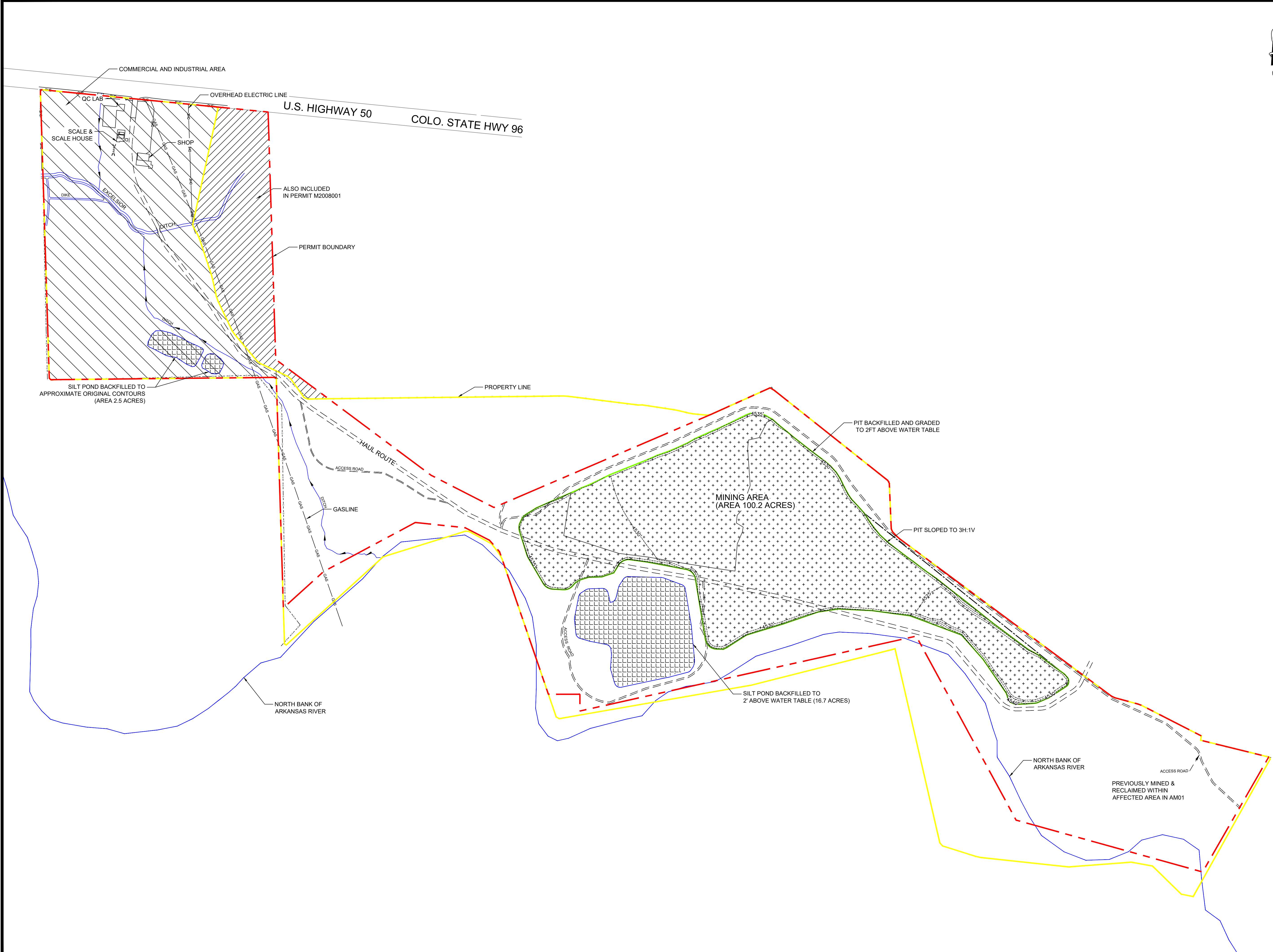

REV. No.	DESCRIPTION	DATE
1	2025 Technical Revision	08/28/2025

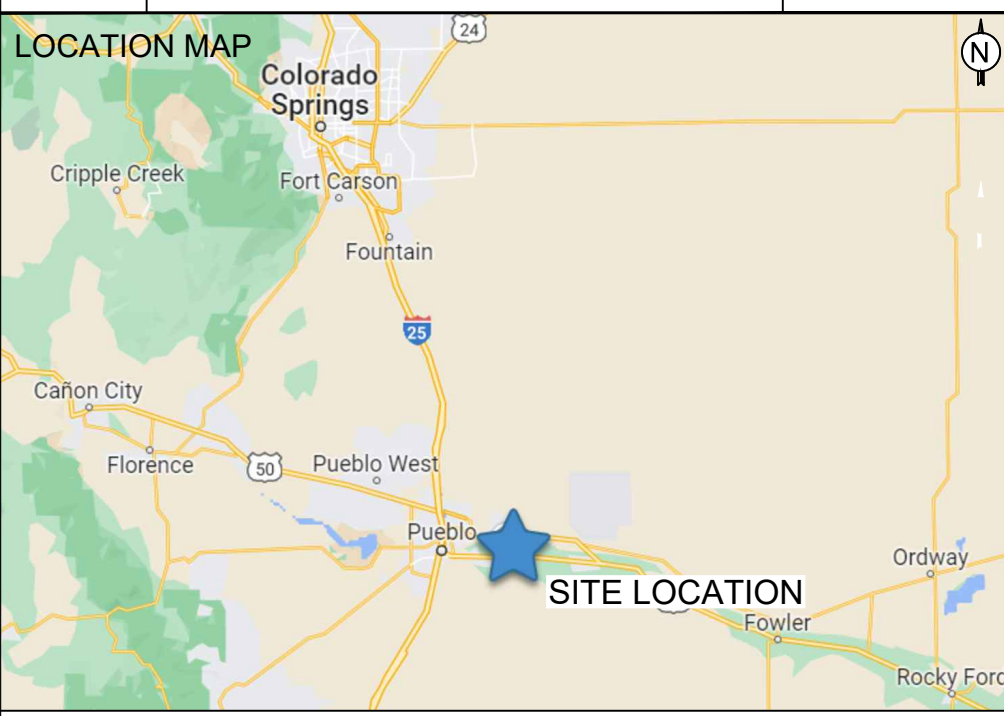

LEGEND:	
	PROPERTY BOUNDARY
	PERMIT BOUNDARY
	MINING AREA
	EXISTING TOPOGRAPHY (5')
	MINE CONTOURS (5')
	EDGE POND, DITCH & RIVER
	EXISTING DIRT ROAD
	EXISTING FENCE
	EXISTING GAS LINE
	EXISTING OVERHEAD ELECTRICAL
	AUGER HOLE LOCATIONS

- NOTES:
1. ALL ACTIVITIES SHOWN WITHIN AFFECTED AREA DELINEATED IN AM01
 2. MINING SLOPE AT A 1H:1V
 3. PIT DEPTH IS ESTIMATED BASED ON 2020 DRILLING DATA AND MAY BE SUBJECT TO CHANGE DEPENDING ON ACTUAL GEOLOGIC CONDITIONS.

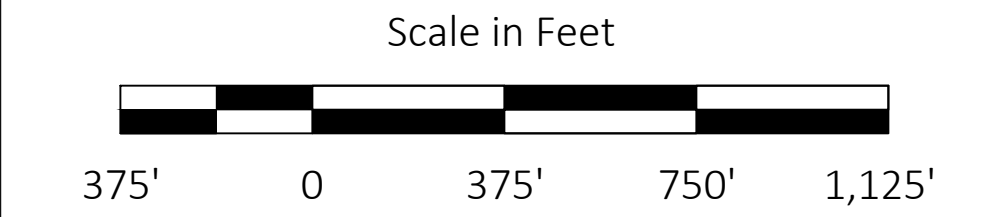
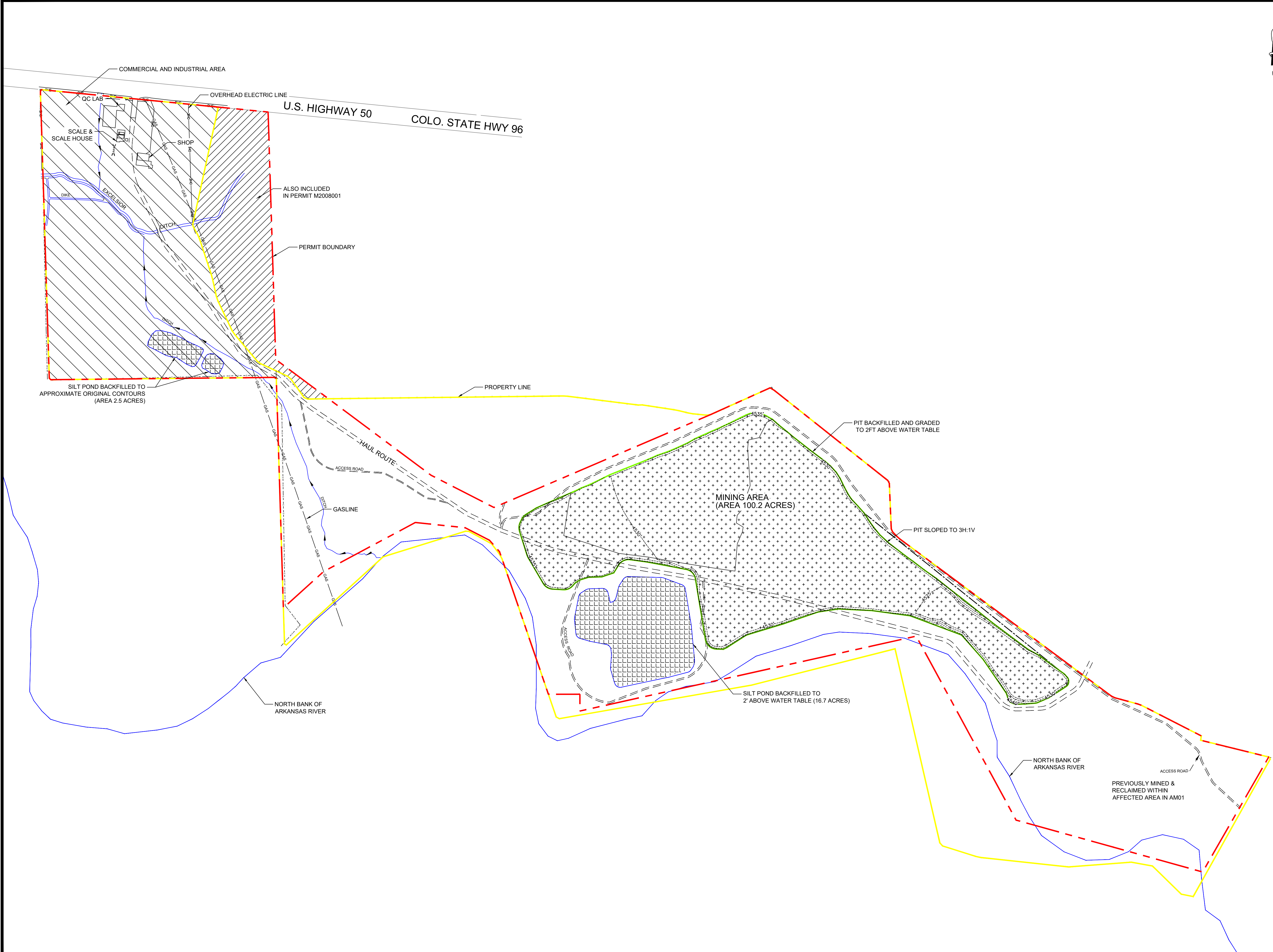

Exhibit C - Mining Plan Map
Rich Pit - M-1985-218
Pueblo County, Colorado

COORD. SYS.: Colorado State Plane South (1983, US feet)

DATE:	08/28/2025	MAP NO. Exhibit-C
DRAWN BY:		
CHECKED BY:		

© 2025 BY MARTIN MARIETTA MATERIALS, INC.
ALL RIGHTS RESERVED. UNAUTHORIZED DUPLICATION IS PROHIBITED.



REV. No.	DESCRIPTION	DATE
1	2025 Technical Revision	08/28/2025

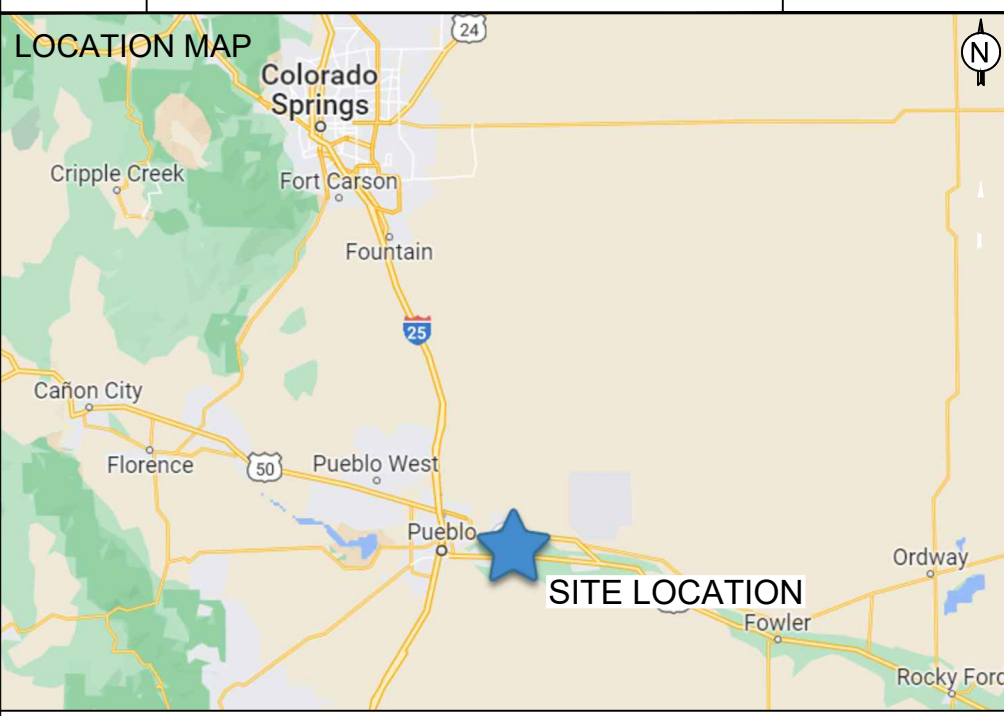

LEGEND:

- PROPERTY BOUNDARY
- PERMIT BOUNDARY
- MINING AREA
- RECLAMATION CONTOURS (5')
- EDGE POND, DITCH & RIVER
- EXISTING DIRT ROAD
- EXISTING FENCE
- GAS
- OHE
- EXISTING GAS LINE
- EXISTING OVERHEAD ELECTRICAL
- SEEDING
- COMMERCIAL AND INDUSTRIAL SITE TO REMAIN
- SILT POND CAP

NOTES:

- RECLAMATION SLOPE AT A 3H:1V, BACKFILLED TO 2FT ABOVE GROUND WATER.
- TOPSOIL TO BE REPLACED ON THE SLOPES AT AN AVERAGE OF 5" TO 8" IN DEPTH
- FERTILIZER APPLIED AT 40 LBS PER ACRE AVAILABLE N&P
- 4000 LBS PER ACRE MULCH
- GROUND WATER LEVELS BASED ON 2020 DRILLING.
- POND AND PIT - 119.4 ACRES BE GRADED AND SEEDED. 2,476,110 C.Y. OF BACKFILL VOLUME REQUIRED. 889,460 C.Y. OF BACKFILL MATERIAL AVAILABLE.

SPECIES	RECOMMENDED SEED MIXTURE	
	VARIETY	DRILLED SEED RATE (PLS/ACRE)
WESTERN WHEATGRASS	ARRIBA	4.8
SIDEOATS GRAMMA	VAUGH OR MINER	2.7
ALKALI SACATON		0.3
SAND DROPSEED		0.1
YELLOW SWEETCLOVER		0.7
FOURWING SALTBUUSH		0.5

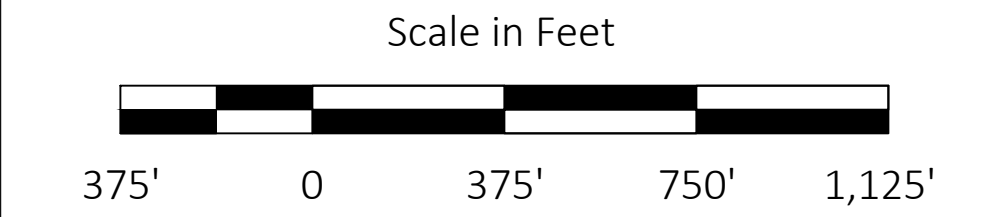

Exhibit F
Reclamation Map - Rich Pit
M-1985-218 Pueblo County, Colorado

COORD. SYS.: Colorado State Plane South (1983, US feet)

DATE:	08/28/2025	MAP NO.
DRAWN BY:		Exhibit-F
CHECKED BY:		

© 2025 BY MARTIN MARIETTA MATERIALS, INC.
ALL RIGHTS RESERVED. UNAUTHORIZED DUPLICATION IS PROHIBITED.