

OWNERSHIP AFFECTED LANDS

4K EQUIPMENT LLC
6201 MCINTYRE ST.
GOLDEN, CO 80403

LOCATED IN PARTS OF THE SE $\frac{1}{4}$, OF
SECTION 3, T-3-S, R-61-W, 6TH P.M.,
ADAMS COUNTY COLORADO

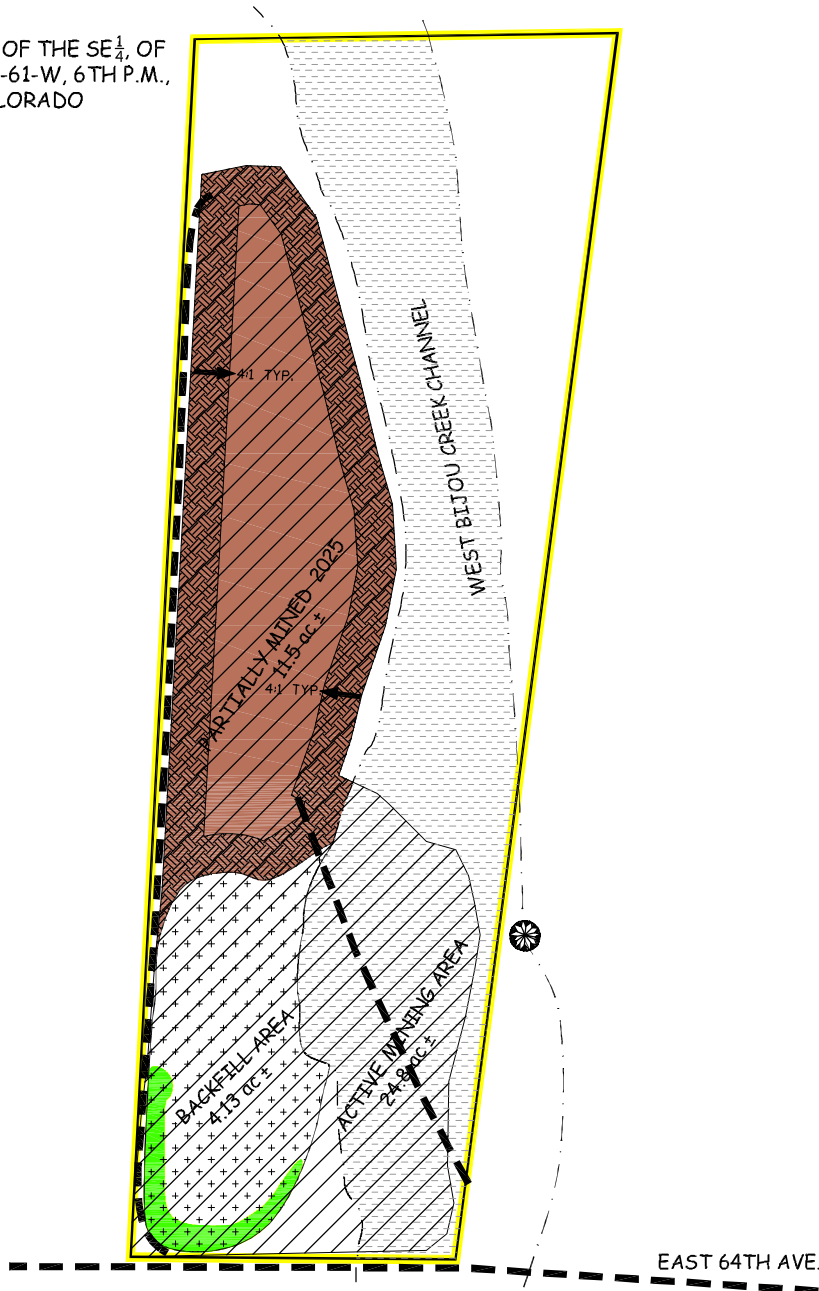

4K Equipment LLC

SAND CREEK MINE - M-1992-038

ANNUAL REPORT MAP - 2025

L E G E N D

- PERMIT LINE/AFFECTED LANDS
- OLD PLANT SITE & BACKFILL AREA
- BACKFILLED - 0.68 AC
- ACTIVE MINING AREA - 11.5 AC
- PARTIALLY MINED AREA 24.9 AC ±
- SLOPED 4:1 - 6.0 AC ±
- INTERNAL ROAD

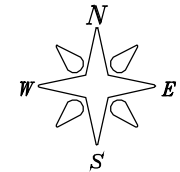

DATE: AUG 27, 2025 - 11:59:21

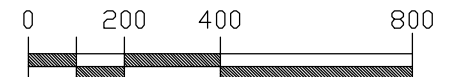

SCALE 1"=400'

PREPARED BY:
ENVIRONMENT, INC.
7985 VANCE DR., # 205A
ARVADA, CO 80003
(303) 423-7297
environment-inc@startmail.com