

MRP-Wide Reclamation Plan - Map 078a  
P-2003-018 Annual Report - Map 15  
P-2004-011 Annual Report - Map 02  
COC67069 Annual Report - Map 04  
COC68010 Annual Report - Map 06

Report Year: 2024

Approved seed mix: 2014 BLM custom mix for pre-2007  
Shell sites.

Status of site for DRMS and BLM Annual Reports:

2 of 7 installed boreholes P&A'd 05/2004 and 11/2007. Pad downsized, some soil material re-spread, and site seeded 09/2007 (phase 2 interim reclamation). Portion of soil not re spread was seeded and Curlex applied. Remaining 5 boreholes P&A'd 10/2015. Remaining disturbed areas graded and seeded Fall 2015 (final reclamation phase). Weed control conducted annually 2012 through 2024. Noxious weed monitoring conducted each year. Ongoing spot re-seeding to establish vegetation growth. 2023: amended the site with wood chips and organic mulch, reseed.

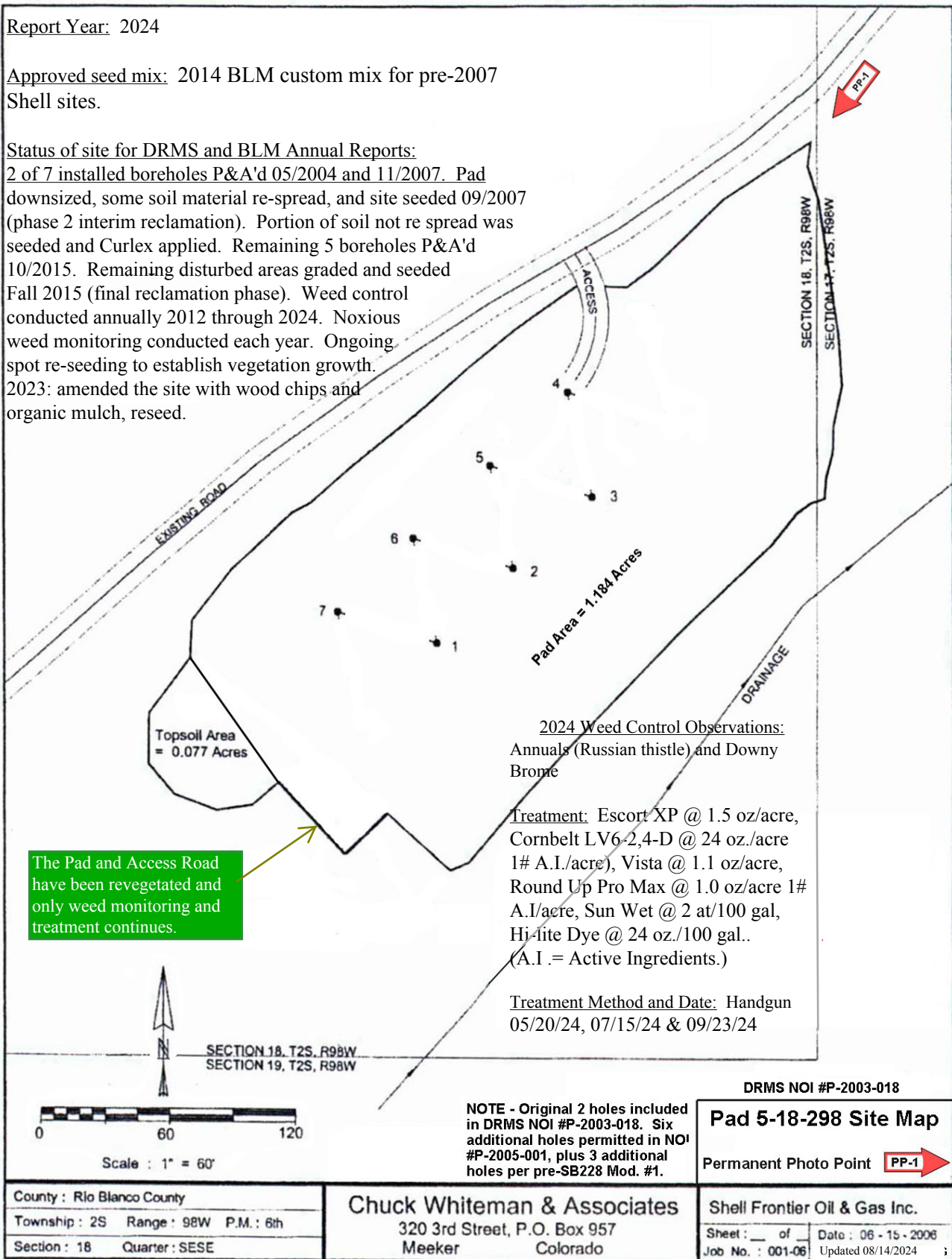

MRP-Wide Reclamation Plan - Map 079b  
P-2003-018 Annual Report - Map 16  
P-2005-001 Annual Report - Map 05  
COC67069 Annual Report - Map 05

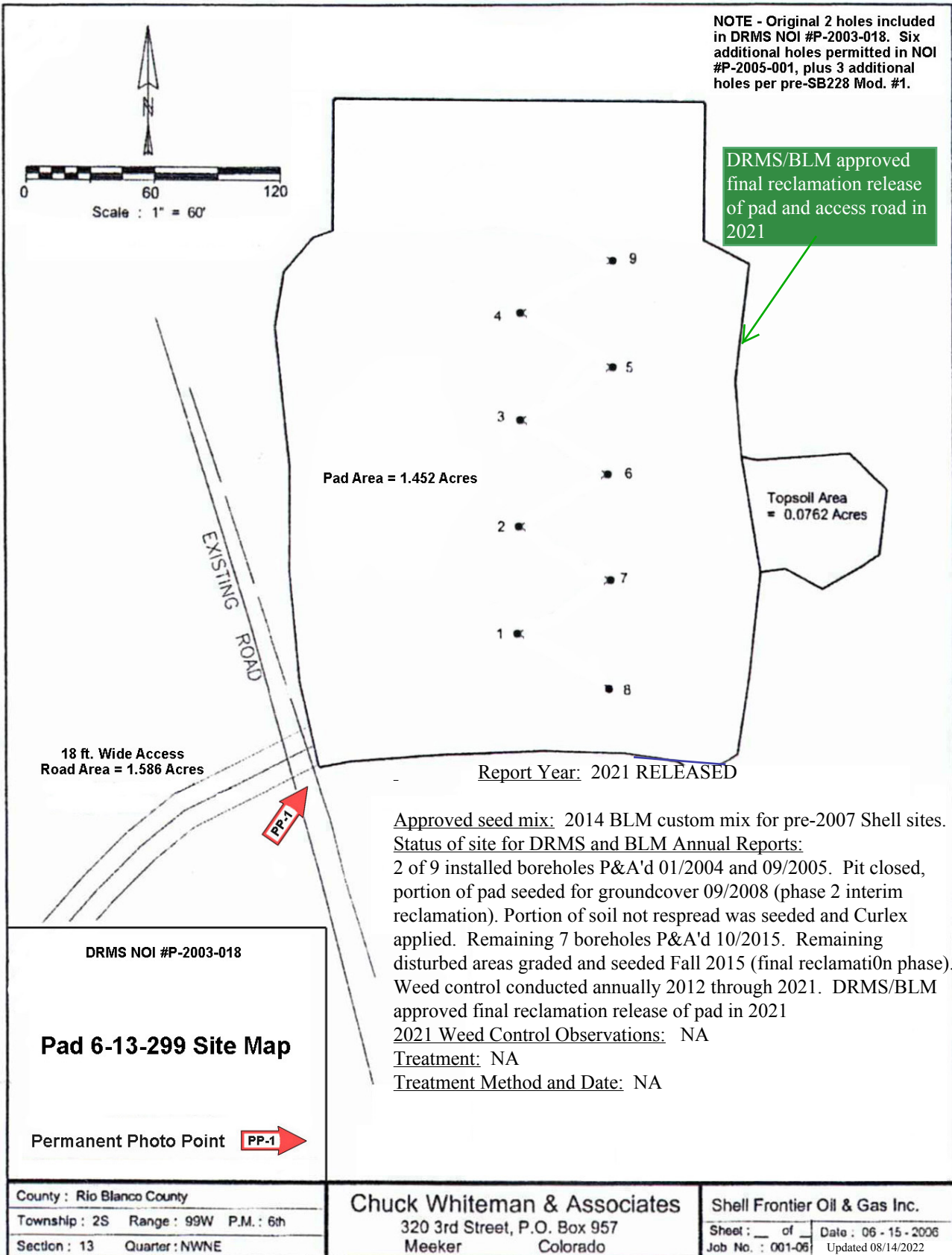

MRP-Wide Reclamation Plan - Map 080b  
 P-2003-018 Annual Report - Map 17  
 P-2005-001 Annual Report - Map 06  
 COC67069 Annual Report - Map 06



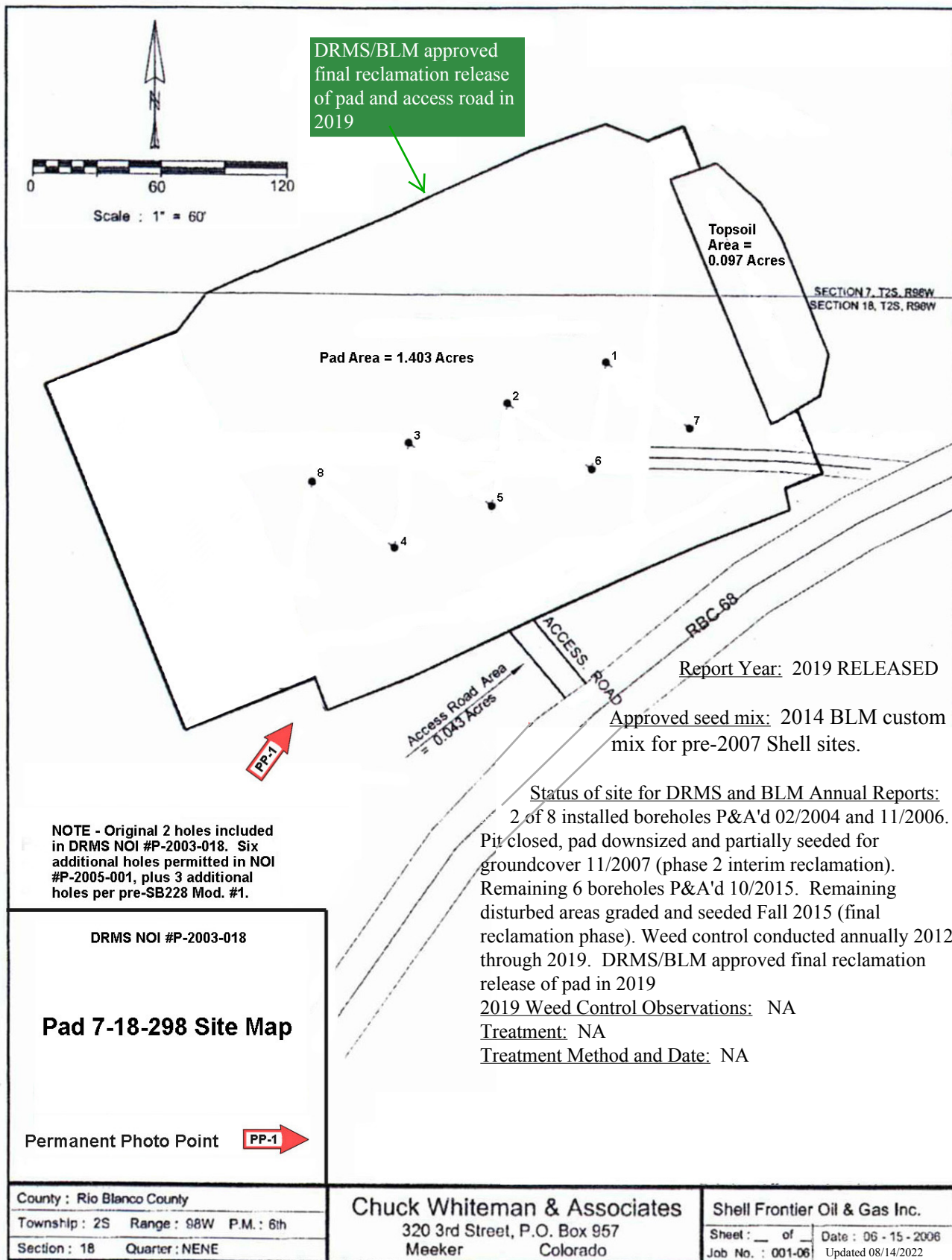

MRP-Wide Reclamation Plan - Map 082b  
P-2003-018 Annual Report - Map 18  
P-2005-001 Annual Report - Map 07  
COC67069 Annual Report - Map 07



NOTE - Original 2 holes included in DRMS NOI #P-2003-018. Six additional holes permitted in NOI #P-2005-001, plus 3 additional holes per pre-SB228 Mod. #2.

The Pad and Access Road have been revegetated and only weed monitoring and treatment continues.

Access Road  
Area = 0.0206  
Acres

RBC 83

Topsoil Area  
= 0.0669 Acres

Report Year: 2024

Approved seed mix:  
2014 BLM custom mix for  
pre-2007 Shell sites.

Status of site for DRMS and BLM Annual  
Reports: 1 of 6 installed boreholes has been  
P&A'd (03/2004. Pit closed, pad downsized, some  
soil material respread, and site seeded 09/2007 (phase 2  
interim reclamation). Remaining 5 boreholes P&A'd  
10/2015. Remaining disturbed areas graded and seeded  
Fall 2015 (final reclamation phase). Weed control  
conducted annually 2012 through 2024. Noxious weed  
monitoring conducted each year. 2023: amended the soil  
with organic matter and applied wood chips and re-  
seeded.2024:

Pad Area = 1.253 Acres

2024 Weed Control Observations: Downy Brome,  
Russian thistle & annuals.

Treatment: Escort XP @ 1.5 oz/acre, Cornbelt  
LV6-2,4-D @ 24 oz./acre 1# A.I./acre), Vista @  
1.1 oz/acre, Round Up Pro Max @ 1.0 oz/acre 1#  
A.I/acre, Sun Wet @ 2 at/100 gal, Hi-lite Dye @  
24 oz./100 gal.. (A.I. = Active Ingredients.)

Treatment Method and Date:

Handgun 05/20/24, 07/15/24 & 09/23/24

DRMS NOI #P-2003-018

## Pad 8-3-298 Site Map

Permanent Photo Point 

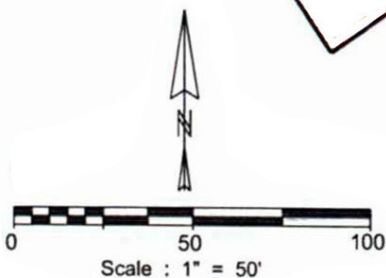

County: Rio Blanco County  
Township: 2S Range: 98W P.M.: 6th  
Section: 3 Quarter: NWNW

Chuck Whiteman & Associates  
320 3rd Street, P.O. Box 957  
Meeker, Colorado

Shell Frontier Oil & Gas Inc.  
Sheet: \_\_\_ of \_\_\_ Date: 06-30-2006  
Job No.: 001-06 Updated 08/14/2024

MRP-Wide Reclamation Plan - Map 083  
P-2003-018 Annual Report - Map 19  
P-2005-001 Annual Report - Map 08  
COC67069 Annual Report - Map 08

**NOTE** - Original 2 holes included in DRMS NOI #P-2003-018. Six additional holes permitted in NOI #P-2005-001, plus 3 additional holes per pre-SB228 Mod. #1.

The Pad and Access Road have been revegetated and only weed monitoring and treatment continues.

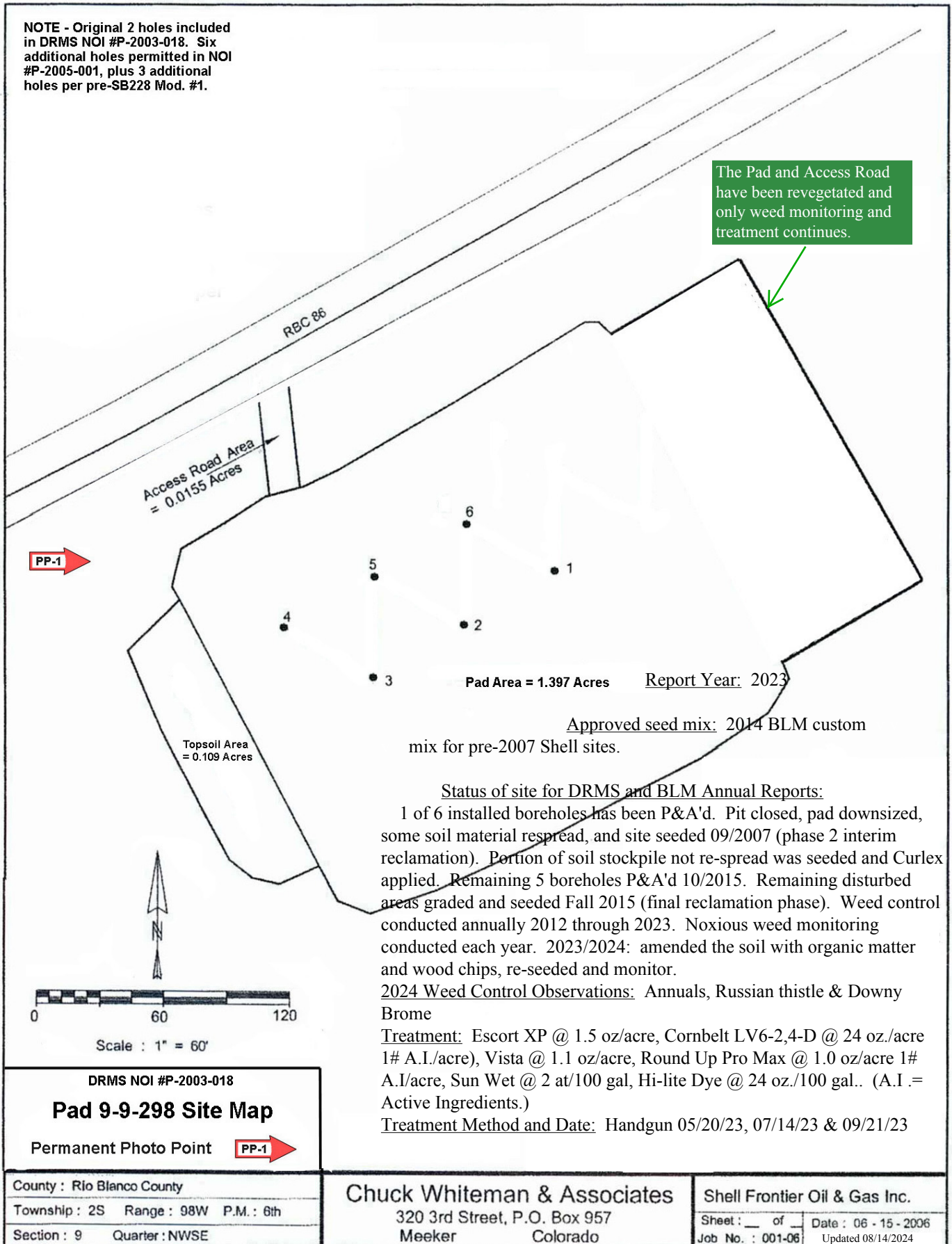

Report Year: 2023  
Approved seed mix: 2014 BLM custom mix for pre-2007 Shell sites.

Status of site for DRMS and BLM Annual Reports:  
 1 of 6 installed boreholes has been P&A'd. Pit closed, pad downsized, some soil material respread, and site seeded 09/2007 (phase 2 interim reclamation). Portion of soil stockpile not re-spread was seeded and Curlex applied. Remaining 5 boreholes P&A'd 10/2015. Remaining disturbed areas graded and seeded Fall 2015 (final reclamation phase). Weed control conducted annually 2012 through 2023. Noxious weed monitoring conducted each year. 2023/2024: amended the soil with organic matter and wood chips, re-seeded and monitor.  
2024 Weed Control Observations: Annuals, Russian thistle & Downy Brome  
Treatment: Escort XP @ 1.5 oz/acre, Cornbelt LV6-2,4-D @ 24 oz./acre 1# A.I./acre), Vista @ 1.1 oz/acre, Round Up Pro Max @ 1.0 oz/acre 1# A.I./acre, Sun Wet @ 2 at/100 gal, Hi-lite Dye @ 24 oz./100 gal.. (A.I. = Active Ingredients.)  
Treatment Method and Date: Handgun 05/20/23, 07/14/23 & 09/21/23

DRMS NOI #P-2003-018

## Pad 9-9-298 Site Map

Permanent Photo Point



County : Rio Blanco County

Township : 2S Range : 98W P.M. : 6th

Section : 9 Quarter : NWSE

**Chuck Whiteman & Associates**

320 3rd Street, P.O. Box 957  
 Meeker Colorado

Shell Frontier Oil & Gas Inc.

Sheet : \_\_\_ of \_\_\_ Date : 06 - 15 - 2006  
 Job No. : 001-06 Updated 08/14/2024

**MRP-Wide Reclamation Plan - Map 084**  
**P-2003-018 Annual Report - Map 20**  
**P-2005-001 Annual Report - Map 09**  
**COC67069 Annual Report - Map 09**

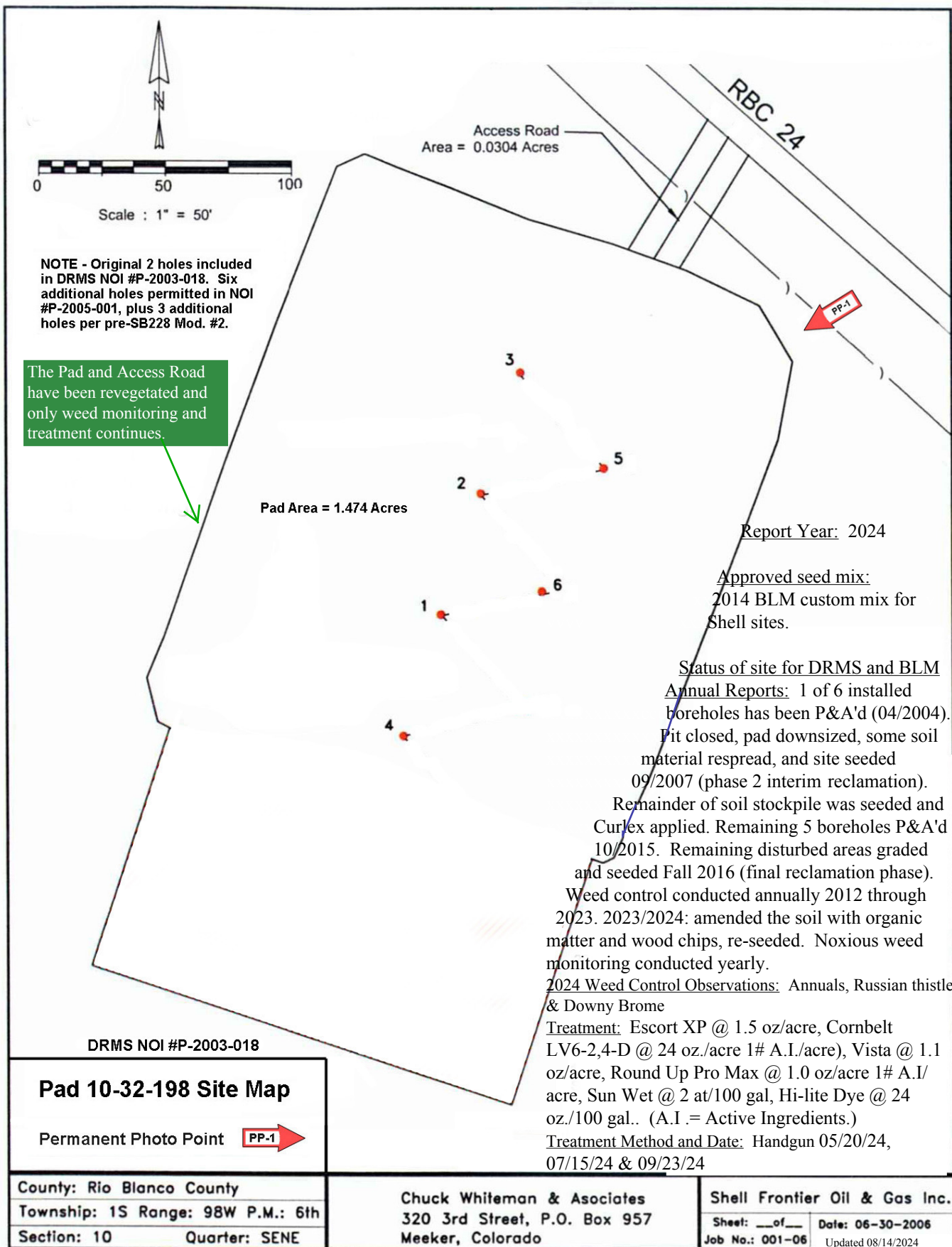



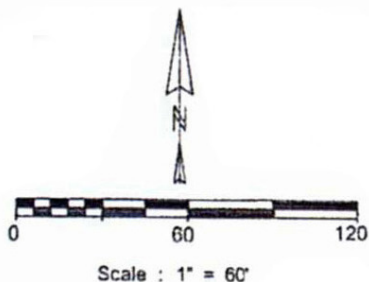

NOTE - Original 2 holes included in DRMS NOI #P-2003-018. Six additional holes permitted in NOI #P-2005-001, plus 3 additional holes per pre-SB228 Mod. #1.

DRMS/BLM approved final reclamation release of pad & access road in 2019

Topsoil Area  
= 0.0164 Acres



EXISTING ROAD

Pad Area = 1.292 Acres

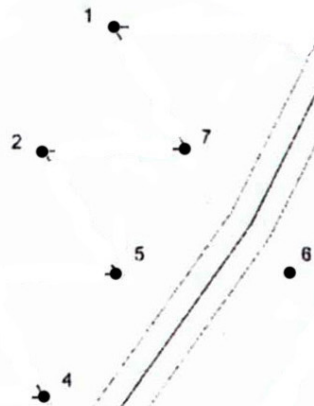

Report Year: 2019

Approved seed mix:  
BLM native mix #6 (1997 RMP).

Status of site for DRMS and BLM

Annual Reports: 2 of 7 installed boreholes

P&A'd 06/2004 and 11/2006. Pit closed 10/2008 (phase 2 interim reclamation). Remaining 6 boreholes P&A'd 10/2015. Remaining disturbed areas graded and seeded Fall 2015 (final reclamation phase). Weed control conducted annually 2012 through 2020. DRMS/BLM approved final reclamation release of pad in 2019.

2019 Weed Control Observations: NA

Treatment: NA

Treatment Method and Date: NA

DRMS NOI #P-2003-018

## Pad 11-16-298 Site Map

Permanent Photo Point



County : Rio Blanco County

Township : 2S Range : 98W P.M. : 6th

Section : 16 Quarter : SESW

Chuck Whiteman & Associates

320 3rd Street, P.O. Box 957  
Meeker Colorado

Shell Frontier Oil & Gas Inc.

Sheet : \_\_\_ of \_\_\_ Date : 06 - 15 - 2006  
Job No. : 001-06 Updated 08/14/2022

MRP-Wide Reclamation Plan - Map 087b  
P-2003-018 Annual Report - Map 22  
P-2005-001 Annual Report - Map 11  
COC67069 Annual Report - Map 11

2019 Weed Control Observations: annuals

Treatment: Escort XP @ 1.5 oz/acre,  
Cornbelt LV6-2,4-D @ 24 oz./acre 1# A.I./  
acre), Vista @ 1.1 oz/acre, Round Up Pro  
Max @ 1.0 oz/acre 1# A.I/acre, Sun Wet @  
2 at/100 gal, Hi-lite Dye @ 24 oz./100 gal..  
(A.I. = Active Ingredients.)

Treatment Method and Date: NA

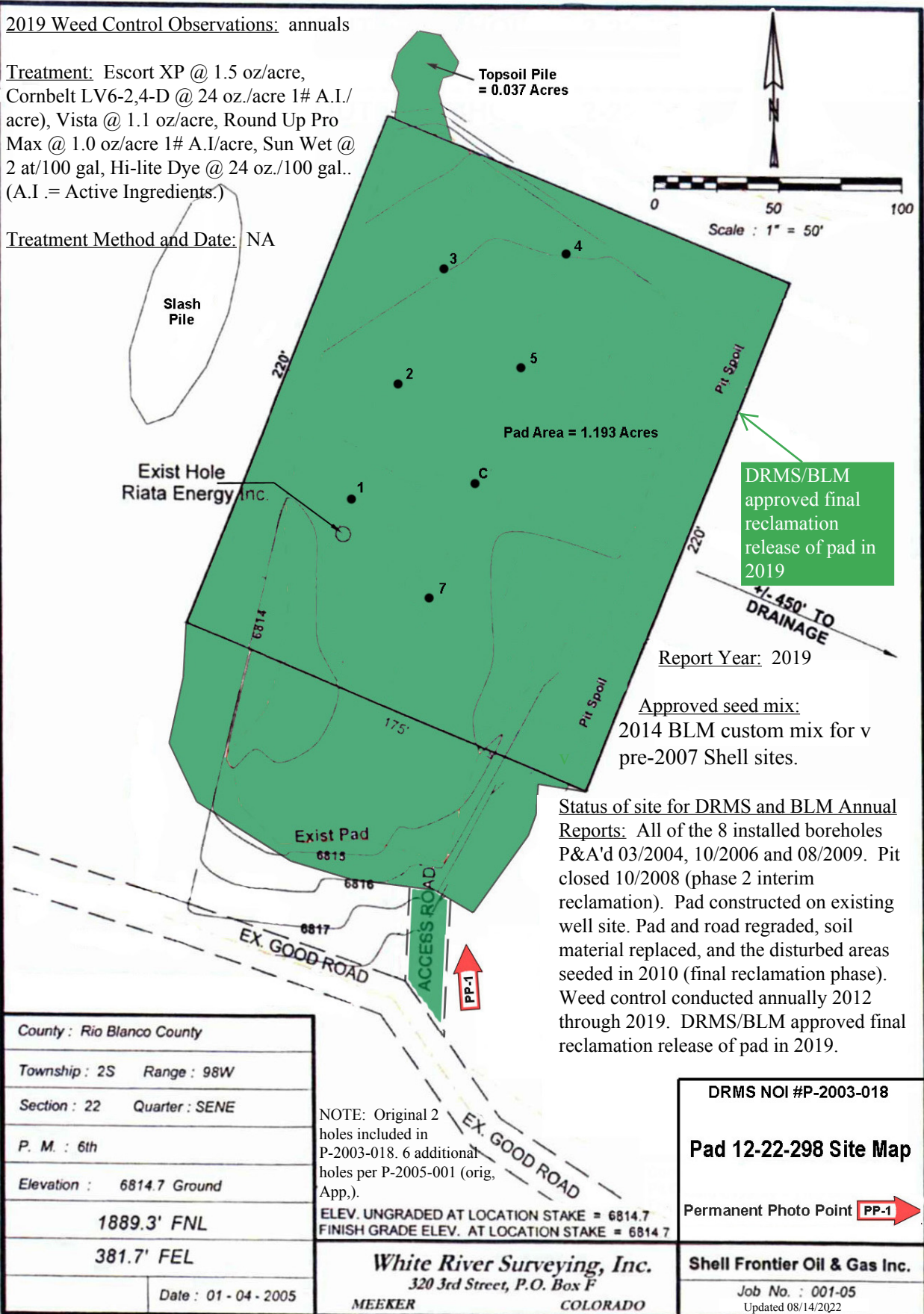

MRP-Wide Reclamation Plan - Map 088  
P-2003-018 Annual Report - Map 23  
P-2005-001 Annual Report - Map 12  
COC67069 Annual Report - Map 12

Note - Original 2 holes included in P-2003-018.  
6 additional holes per P-2005-001.



2024 Weed Control Observations:  
Annuals and Downy Brome

Treatment: Escort XP @ 1.5 oz/acre, Cornbelt LV6-2,4-D @ 24 oz./acre 1# A.I./acre, Vista @ oz./acre, Round Up Pro Max @ oz./acre 1# A.I./acre, Sun Wet at/100 gal, Hi-lite Dye @ 24 oz./100 gal.. (A.I. = Active Ingredients.)

Treatment Method and Date:  
Handgun 05/20/24 & 07/15/24

Approved seed mix: 2014 BLM custom mix for pre-2007 Shell sites.

Status of site for DRMS and BLM Annual Reports: Site in final reclamation phase. All 4 installed holes P&A'd (04/2004 and 08/2009). Remaining portion of pad and road regraded and soil material replaced, and seeding completed Fall 2010 (final reclamation phase). Weed control conducted annually 2012 through 2023. Noxious weed monitoring conducted each year. Spot reseeded around the wellhead area. DRMS/BLM approved final reclamation release of pad in 2024

County : Rio Blanco County
Township : 2S Range : 98W
Section : 14 Quarter : NWSE
P. M. : 6th
Elevation : 6567.5 Ground
2352.4' FSL
2148.5' FEL
Date : 12 - 31 - 2004

Permanent Photo Point



DRMS NOI #P-2003-018

Pad 13-14-298 Site Map

Shell Frontier Oil & Gas Inc.

Job No. : 001-05

Updated 08/14/2024

MRP-Wide Reclamation Plan - Map 089  
P-2003-018 Annual Report - Map 24  
P-2005-001 Annual Report - Map 13  
COC67069 Annual Report - Map 13



Report Year: 2023

Approved seed mix:

2014 BLM custom mix for pre-2007 Shell sites.

Status of site for DRMS and BLM Annual Reports:

Phase 1 interim reclamation completed during Construction. Roadway is maintained on an as-needed basis. Weed control conducted annually 2012 through 2022. Noxious weed monitoring conducted each year. DRMS/BLM approved final reclamation release of pad in 2023

2023 Weed Control Observations: annuals and Downy Brome Spring/Fall treatment

Treatment: Escort XP @ 2 oz//ac, Cornbelt LV6-2,4-D @ 24 oz./acre 1# A.I./acre, Sun Wet @ 2 qt/100 gal., Hi-Lite Dye @ 24 oz./100 gal.. (A.I. = Active Ingredients.)

Treatment Method and Date: Handgun 05/20/23, 07/15/23

MRP-Wide Reclamation Plan - Map 035a  
P-2003-018 Annual Report - Map 25a  
COC59309\* Annual Report - Map 01a  
\* also permitted under COC60385

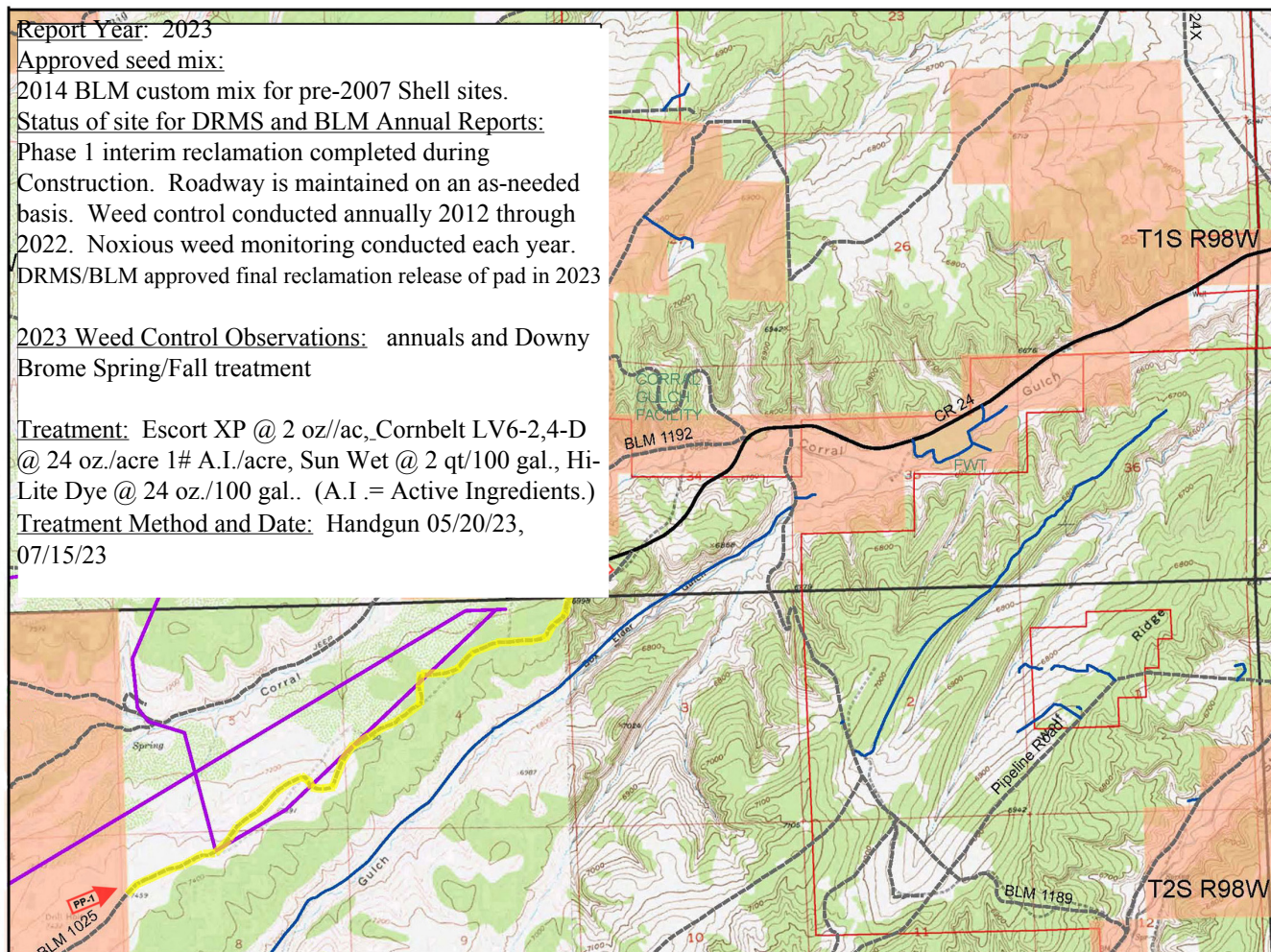

## Airplane Ridge Road Access Map (portion situated on BLM land)

### Legend

- Power Line (to Remain)
- Power Line (To Be Removed)
- Existing Access Road
- Unpaved Road
- Paved Road
- Portion of Airplane Ridge Road covered under BLM ROW Grants COC59309 and COC60385, and DRMS NOI #P-2003-018.

### Land Ownership

- Shell
- State
- Private
- BLM

### Disturbed Area

BLM Surface  
= 13.18 Acres  
(P-2003-018)  
  
Private Surface  
= 19.44 Acres  
(P-2003-022)

PP-1 Permanent Photo Point

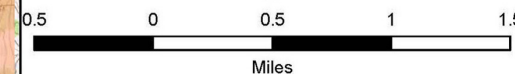
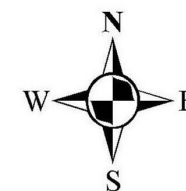

Updated 08/14/2023



## Airplane Ridge Road Disturbed Acreages

										Access Road					Telephone		Water Line			
	Mile Marker						Segment Length (ft)	Original Road Width (ft)	MFE Affected Area (ac)	Left Side (ft)	Travel Width (ft)	Right Side (ft)	Total Road Width (ft)	Total (acres)	Telephone Line Width* (ft)	Total (acres)	Water Line Width (ft)	Total (acres)	Mile Marker	
Public Land	0										16		16		0				0	End Asphalt-Begin New Affected Area
	0.25						1320	11	0.33	2	21	4	27	0.65	0	0.00			0.25	
	0.5						1320	11	0.33	6	19	3	28	0.83	0	0.00			0.5	
	0.75						1320	11	0.33	1	21	3	25	0.80	0	0.00			0.75	
	1						1320	11	0.33	2	19	3	24	0.74	0	0.00			1	
	1.25						1320	11	0.33	6	19	3	28	0.79	0	0.00			1.25	
	1.5						1320	11	0.33	7	19	3	29	0.86	0	0.00			1.5	
	1.75						1320	11	0.33	6	19	4	29	0.88	0	0.00			1.75	
	2						1320	11	0.33	8	19	5	32	0.92	0	0.00			2	
	2.15						792	11	0.20	7	19	3	29	0.55	11	0.10			2.15	Telephone not adjacent to road
	2.25						528	11	0.13	7	19	4	30	0.36	11	0.13			2.25	Telephone not adjacent to road
	2.3						264	11	0.07	7	19	4	30	0.18	11	0.07			2.3	Telephone not adjacent to road
	2.35						264	11	0.07	4	19	5	28	0.18	0	0.03			2.35	
	2.45						528	11	0.13	4	19	6	29	0.35	0	0.00			2.45	
2.5						264	11	0.07	3	21	0	24	0.16	8	0.02			2.5		
2.75						1320	11	0.33	3	19	0	22	0.70	5	0.20			2.75		
Totals on Public Land							14,520		3.67					8.96		0.55				
SFOGI Land	3						1320	11	0.33	3	19	0	22	0.67	6	0.17			3	
	3.25						1320	11	0.33	3	21	0	24	0.70	5	0.17			3.25	
	3.35						528	11	0.13	4	18	0	22	0.28	4	0.05	3	0.02	3.35	Location of Well 2-7
	3.5						792	11	0.20	4	18	0	22	0.40	3	0.06	3	0.05	3.5	
	3.75						1320	11	0.33	4	19	0	23	0.68	7	0.15	7	0.15	3.75	
	4						1320	11	0.33	4	18	0	22	0.68	9	0.24	8	0.23	4	
	4.25						1320	11	0.33	2	19	0	21	0.65	5	0.21	5	0.20	4.25	
	4.5						1320	11	0.33	3	20	0	23	0.67	8	0.20	7	0.18	4.5	
	4.75						1320	11	0.33	2	17	0	19	0.64	6	0.21	5	0.18	4.75	
	5						1320	11	0.33	2	19	0	21	0.61	7	0.20	6	0.17	5	
	5.25						1320	11	0.33	2	17	0	19	0.61	6	0.20	6	0.18	5.25	
	5.35						528	11	0.13	3	17	11	31	0.30	5	0.07	6	0.07	5.35	Old Jeep Trail
	5.5						792	11	0.20	6	20	12	38	0.63	5	0.09	5	0.10	5.5	Old Jeep Trail
	5.75						1320	11	0.33	5	20	12	37	1.14	6	0.17	5	0.15	5.75	Old Jeep Trail
	5.85						528	11	0.13	5	20	11	36	0.44	5	0.07	5	0.06	5.85	Old Jeep Trail
	6						792	11	0.20	5	22	0	27	0.57	5	0.09	5	0.09	6	
	6.25						1320	11	0.33	4	21	0	25	0.79	0	0.08	0	0.08	6.25	
Totals on SFOGI Land							18,480		4.67					10.44		2.42			1.91	
							Total Acres		8.33					19.40		2.97			1.91	

Original 11 foot width of road improved for Mahogany Field Experiment (MFE) on Public Land = 3.67 ac  
 Original 11 foot width of road improved for MFE on SFOGI Land = 4.67 ac  
 Total original road improvement for MFE = 8.33 ac

Additional road widening for Mahogany Field Experiment/Mahogany Demo. Proj./Mahogany Test Experiment  
 Monitoring Program (MFE/MDP/MTE Mon. Program) on Public Land (8.96 ac - 3.67 ac) = 5.29 ac  
 Additional road widening for MFE/MDP/MTE Mon. Program on SFOGI land (10.44 ac - 4.67 ac) = 5.77 ac  
 Total additional road widening for MFE/MDP/MTE Mon. Program = (5.29 ac + 5.77 ac) = 11.06 ac

**Notes:**

\* Split with Water Line where applicable