



STATE OF
COLORADO

Wein - DNR, Clayton <clayton.wein@state.co.us>

New Horizon Mine, C-1981-008, SL-29 Bond Release Inspection Report

1 message

Wein - DNR, Clayton <clayton.wein@state.co.us>

Tue, Aug 12, 2025 at 3:26 PM

To: Go West Land <Gowestland@gmail.com>

Good afternoon Mr. Guire,

Attached with my email is a copy of the report for the SL-29 Bond Release Inspection. Please feel free to contact me if you have any questions or concerns.

Sincerely,

Clayton Wein

Environmental Protection Specialist



COLORADO
Division of Reclamation,
Mining and Safety
Department of Natural Resources

P 720.762.6156 | F 303.832.8106

1313 Sherman Street, Room 215, Denver, CO 80203

clayton.wein@state.co.us | <https://www.drms.colorado.gov>



New Horizon Mine, C-1981-008, SL-29 Bond Release Inspection Report_CCW.pdf

1107K



PERMIT INFORMATION

Permit Number: C-1981-008 Mine Name: New Horizon Mine Operator: Elk Ridge Mining and Reclamation, LLC Operator Address: Mr Tony Tennyson P.O. Box 628 27646 West 5th Avenue Nucla, CO 81424	County: Montrose Operation Type: Surface Permit Status: Active Ownership: Private
	Operator Representative Present: Tony Tennyson
Operator Representative Signature: (Field Issuance Only) 	

INSPECTION INFORMATION

Inspection Start Date: July 23, 2025 Inspection Start Time: 12:00 Inspection End Date: July 23, 2025 Inspection End Time: 12:50		Inspection Type: Coal Partial Inspection Inspection Reason: Surety Release Requested Weather: Clear	
Joint Inspection Agency: None		Joint Inspection Contacts: None	
Post Inspection Agency: None		Post Inspection Contacts: None	
Inspector(s): Clayton Wein	Inspector's Signature: <i>Clayton Wein</i> Signature Date: 8/12/2025		

Inspection Topic Summary

NOTE: Y=Inspected N=Not Inspected R=Comments Noted V=Violation Issued NA=Not Applicable

N - Air Resource Protection

N - Availability of Records

N - Backfill & Grading

N - Excess Spoil and Dev. Waste

N - Explosives

N - Fish & Wildlife

N - Hydrologic Balance

N - Gen. Compliance With Mine Plan

N - Other

N - Processing Waste

N - Roads

R - Reclamation Success

N - Revegetation

N - Subsidence

N - Slides and Other Damage

N - Support Facilities On-site

N - Signs and Markers

N - Support Facilities Not On-site

N - Special Categories Of Mining

N - Topsoil

COMMENTS

This report documents the observations taken by the Division during a bond release request inspection of the New Horizon Mine, Permit No. C-1981-008. The inspection was conducted following Elk Ridge Mining and Reclamation's (ERMR) request for a bond release, Bond Release Application no. SL-29. The inspection was conducted on July 23, 2025. Clayton Wein of the Division conducted the inspection. Tony Tennyson Represented ERMR during the inspection. Land owners, Jim Guire and Rose Guire were also present for the inspection. The weather was clear with a temperature of 87°F. The ground conditions were dry during the inspection.

The SL-29 Bond Release Application requested for the Phase III release of the reclamation liability for 2.9 acres of land on the Guire property. The first cutting of the season had not yet occurred on the reclamation parcel.

Parties to the inspection met at the New Horizon Mine's office located on 5th Street at 12:00. Mr. Guire informed the Division of the amounts of Buffalo Burr that had been identified on the acreage located within the SL-29 bond release request. Mr. Guire requested the Division take a look this plant species during the SL-29 inspection. Mr. Guire also discussed with the Division his concerns about the agreement between ERMR and GW46 Revocable Trust to leave the side roll irrigation equipment. The inspection party then visited IP-10, the 2.9 acres of Land applied for Phase III Bond Release under SL-29.

RECLAMATION SUCCESS - Rule 4.15, Rule 3:

The land applied for Phase III bond release under SL-29 is located within the northern part of Section 6 on the south side of BB Road. All 2.9 acres included in the release request are located on land owned by GW46 Revocable Trust. The reclamation parcel, referred to as IP-10 was reclaimed to the post mining land use of Irrigated pasture. The reclamation parcel is bisected into an east and a west piece by a swale. The swale was reclaimed to be an irrigated pasture swale. Please refer to Map 2.05.4-5 of the C-1981-008 Permit for the approved post mining land use. The 2.9 acres of land requested for release under SL-29 was Phase I bond released under SL-05, SL-06 and SL-18. Phase II release was approved under SL-25 for the lands requested under SL-29.

Number of Partial Inspection this Fiscal Year: 2

Number of Complete Inspections this Fiscal Year: 0

The inspection of IP-10 started at the western portion of the parcel (Photos 1-5). The site was covered with grass and some alfalfa. Vegetative growth on the western portion of the reclamation parcel was consistent. Vegetation was roughly knee to hip height. Thistle that had been sprayed earlier in the season were noted to be dead. No live thistles were identified in the western portion of IP-10. Buffalo Burr, a known noxious plant species toxic to livestock, was found within the western portion of IP-10 (Photo 6). Buffalo Burr (*Solanum Rostratum*) is a State recognized noxious weed; however, is not listed Class A, Class B or Class C noxious weed in Colorado. Colorado also has a list of noxious weeds that require management by landowners. Buffalo Burr is also not on this state list. Throughout the inspection of the western portion of IP-10 Mr. Guire and Mr. Tennyson hand picked the Buffalo Burr that was spotted. The central portion of IP-10 has a swale running from north to south. The swale was covered with cattails and other grasses (Photos 7 and 8). The eastern portion of IP-10 was also covered with grass and Alfalfa (Photos 9 through 12). Buffalo Burr was identified and hand picked by Mr. Guire and Mr. Tennyson. Buffalo Burr was identified in fair amounts throughout the bond release area. The approved Weed Control Plan is located within Section 2.05.4(2)(e) of the C-1981-008 Permit. Seed mixes used for Irrigated Pastures can be viewed in Section 2.05.4(2)(e).

Reclamation on the western portion of IP-10 generally slopes down to the east/northeast. The reclamation was stable with vegetative cover. There were no indications of erosional features identified. The swale extends generally from the north downgradient to the south. The swale was observed to be stable with no erosional concerns. The eastern portion of IP-10 slopes from the northeast downgradient to the swale at the southwest. The eastern portion of IP-10 was covered with vegetation and was stable. There were no indications of erosional features. Side Roll irrigation equipment was located at the northern permit boundary of the eastern portion of IP-10. The equipment was inactive during the inspection (Equipment can be seen in the middle left portion of photos 5, 9 and 10). The approved post mining topography for IP-10 can be viewed on Map 2.05.4-1 of the C-1981-008 Permit.

DOCUMENTS RECEIVED: Mr. Guire handed the Division copies with highlighted portions of Section 2.05.4(2)(e).

OTHER (SPECIFY): None

Number of Partial Inspection this Fiscal Year: 2

Number of Complete Inspections this Fiscal Year: 0

ENFORCEMENT ACTIONS/COMPLIANCE

No enforcement actions were initiated as a result of this inspection, nor are any pending.

Number of Partial Inspection this Fiscal Year: 2

Number of Complete Inspections this Fiscal Year: 0

PHOTOGRAPHS

Note: The red arrow in all the photographs indicates the direction of north.

Photo 1: The northwestern portion of IP-10's west parcel.



Photo 2: The western portion of IP-10's western parcel.

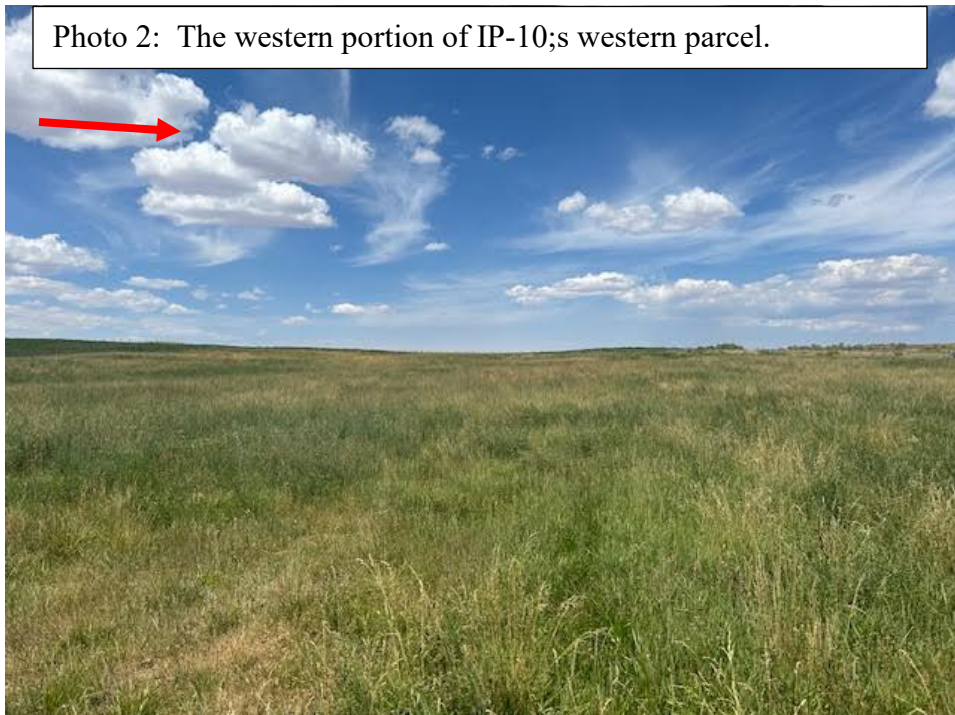

Number of Partial Inspection this Fiscal Year: 2

Number of Complete Inspections this Fiscal Year: 0

Photo 3: The southern portion of IP-10's western parcel

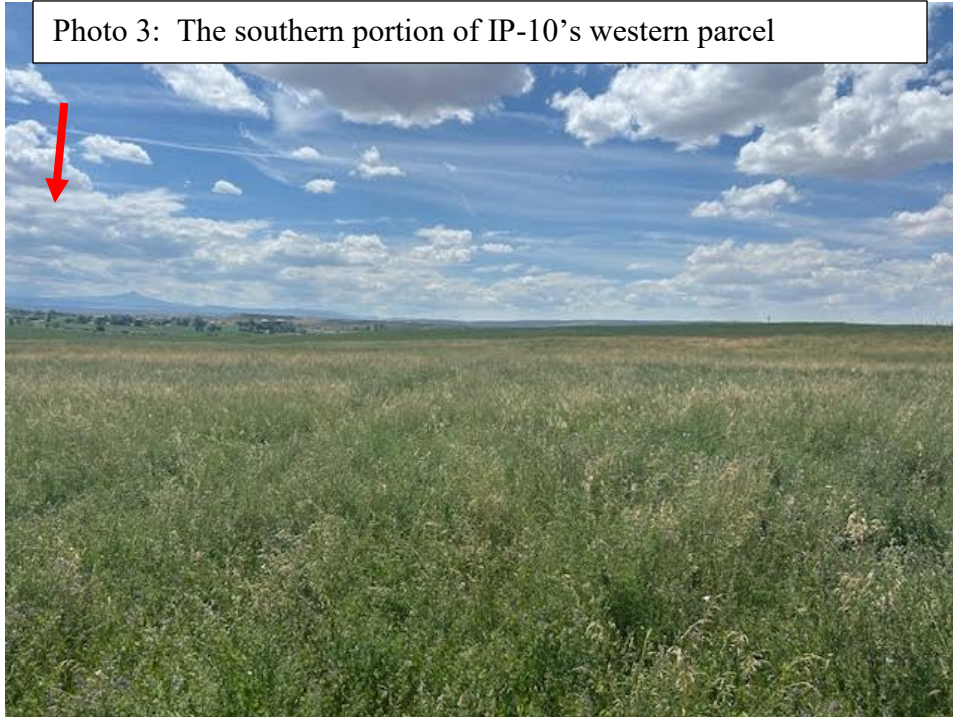
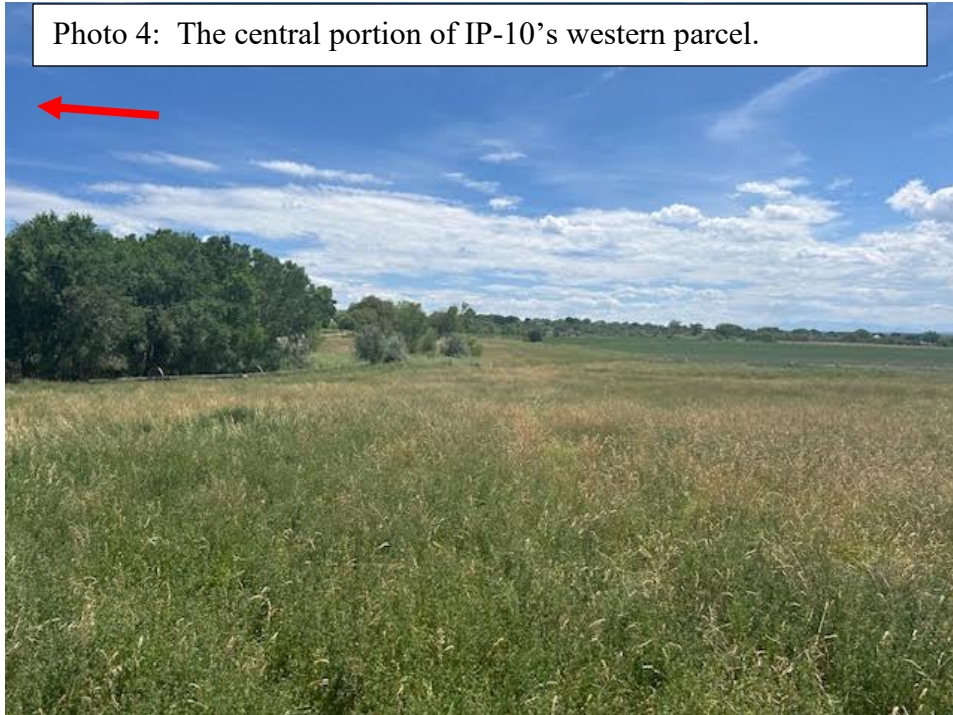

Photo 4: The central portion of IP-10's western parcel.



Number of Partial Inspection this Fiscal Year: 2

Number of Complete Inspections this Fiscal Year: 0

Photo 5: The eastern portion of IP-10's western parcel and the western portion of IP-10's eastern parcel.



Photo 6: An example of the Buffalo Burr found on IP-10.



Number of Partial Inspection this Fiscal Year: 2

Number of Complete Inspections this Fiscal Year: 0

Photo 7: The southern portion of the swale.



Photo 8: The central and northern portions of the swale.

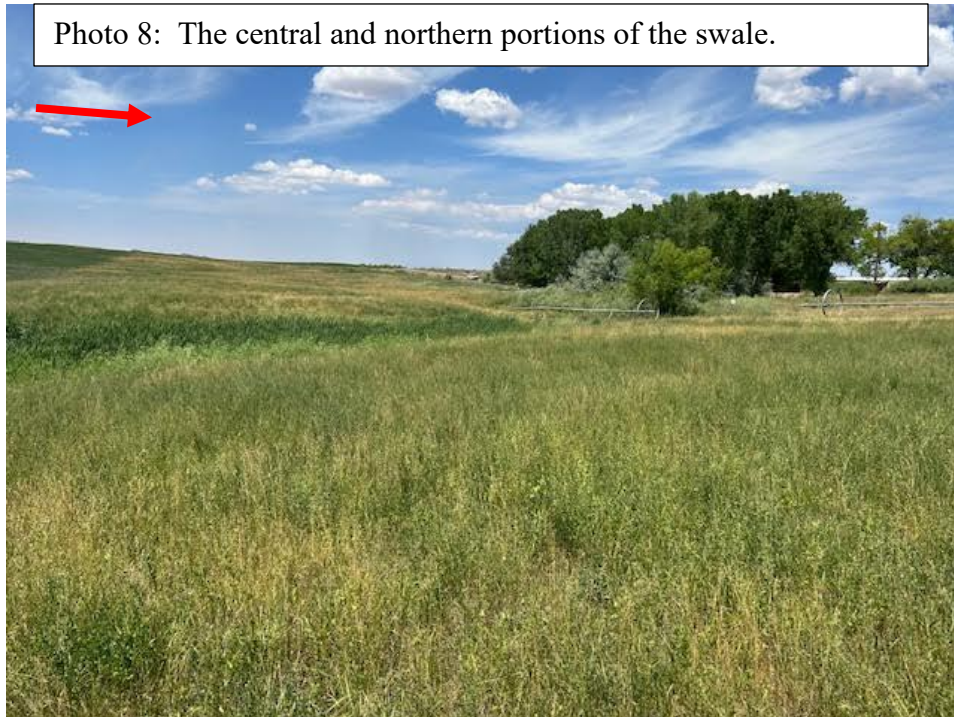

Number of Partial Inspection this Fiscal Year: 2

Number of Complete Inspections this Fiscal Year: 0

Photo 9: The western portion of IP-10's eastern parcel.



Photo 10: The eastern portion of IP-10's eastern parcel.



Number of Partial Inspection this Fiscal Year: 2

Number of Complete Inspections this Fiscal Year: 0

Photo 11: The southeastern portion of IP-10's eastern parcel.

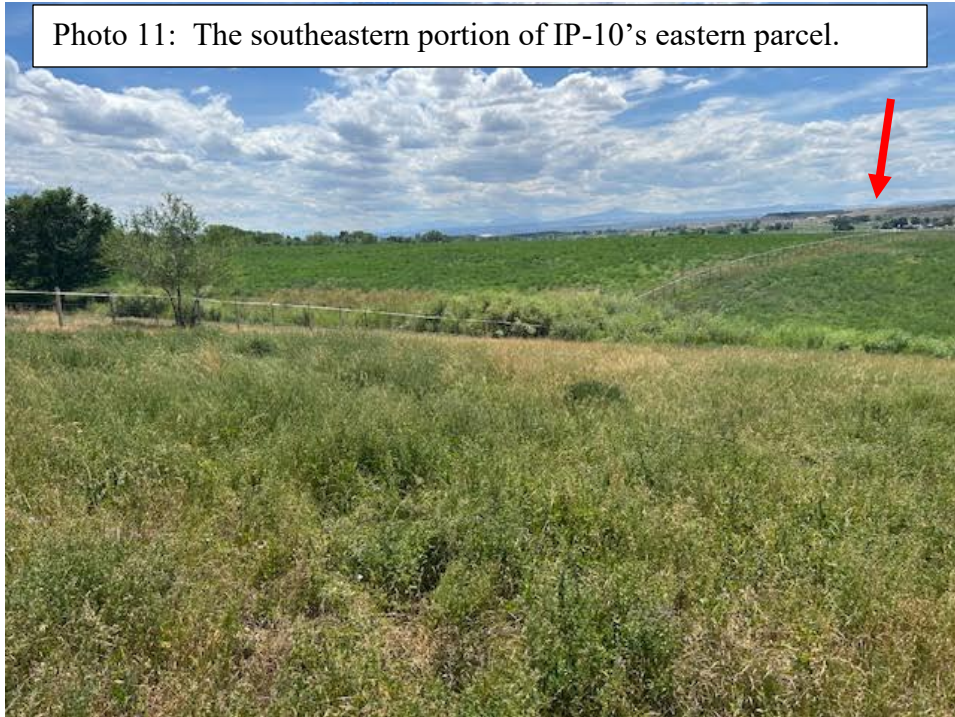
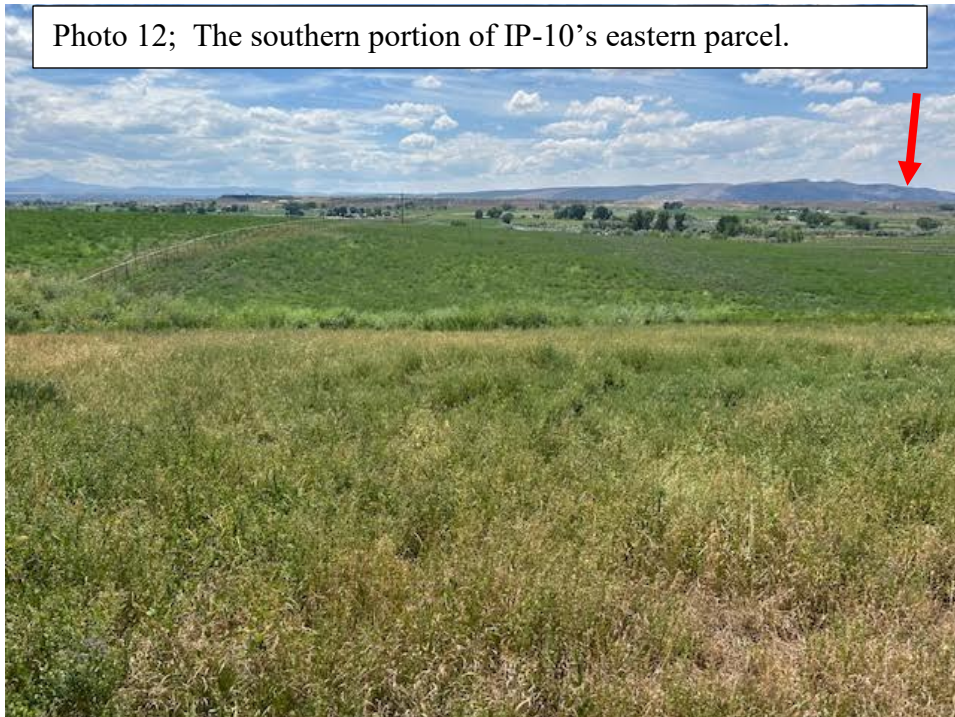

Photo 12; The southern portion of IP-10's eastern parcel.



Number of Partial Inspection this Fiscal Year: 2

Number of Complete Inspections this Fiscal Year: 0