

JANICE EVANS TRACT 4 GRADING PROJECT 2025 ANNUAL REPORT MAP

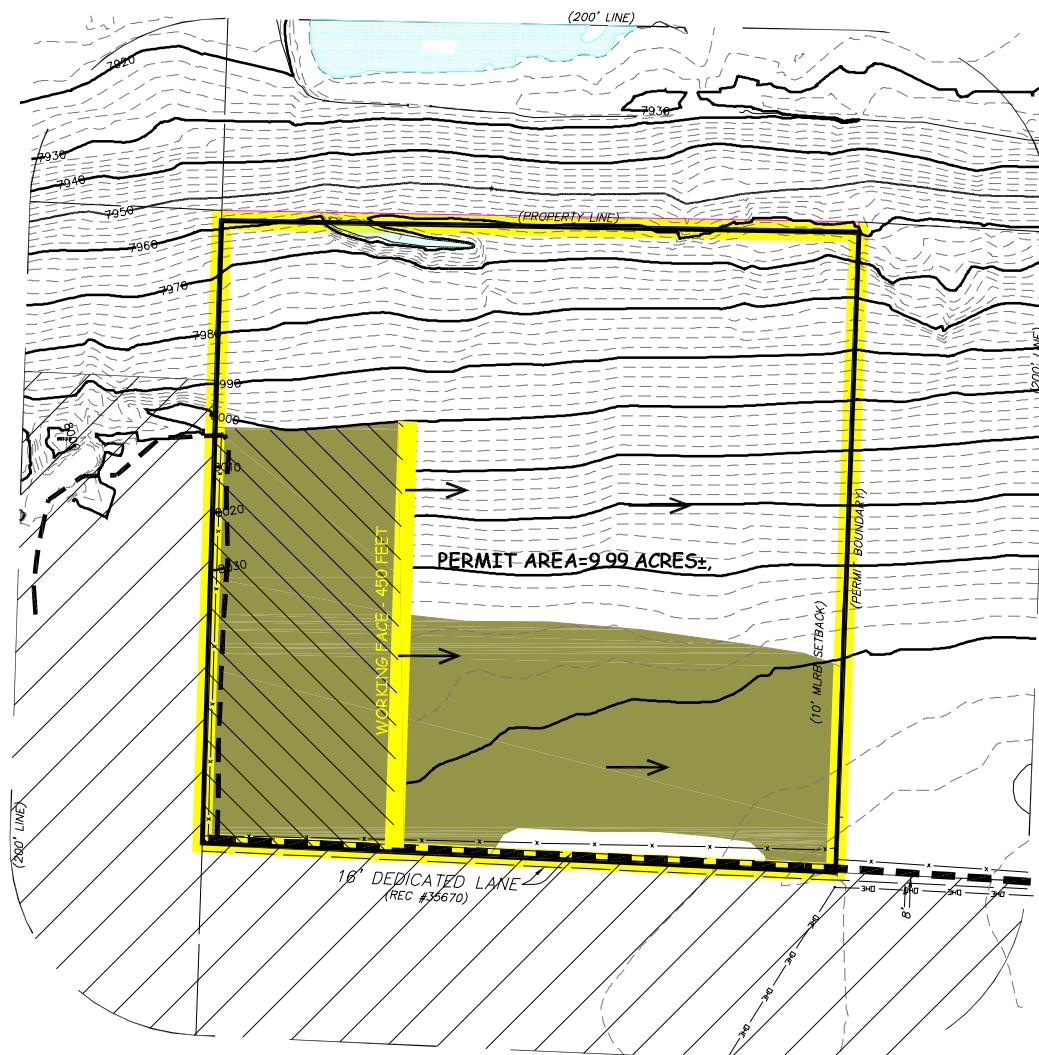

L E G E N D

	PERMIT LINE/AFFECTED LANDS
	200 FOOT LINE
	ROADS - EXISTING
	BARBED WIRE FENCE
	MINING DIRECTION
	THOMPSON RESOURCE ACTIVE MINE M-1983-102
	DISTURBED AREA - 4.30 AC.±
	MINED AREA 2.0 AC.±

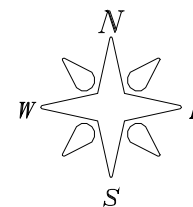

DATE: JUL 30, 2025 - 16:38:25

CONTOUR INTERVAL: 10 FEET

PREPARED BY: **ENVIRONMENT, INC.**
7985 VANCE DR., # 205A
ARVADA, CO 80003
(303) 423-7297
Environment-inc@outdrs.net

PART OF THE NW1/4 NE1/4, SECTION 31,
TOWNSHIP 2 NORTH, RANGE 76 WEST,
6TH PRINCIPAL MERIDIAN, GRAND COUNTY, COLORADO