

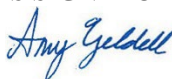

MINERALS PROGRAM INSPECTION REPORT
PHONE: (303) 866-3567

The Division of Reclamation, Mining and Safety has conducted an inspection of the mining operation noted below. This report documents observations concerning compliance with the terms of the permit and applicable rules and regulations of the Mined Land Reclamation Board.

MINE NAME: 32 Road Pit	MINE/PROSPECTING ID#: M-1985-219	MINERAL: Sand and gravel	COUNTY: Mesa
INSPECTION TYPE: Monitoring	WEATHER: Clear	INSP. DATE: July 8, 2025	INSP. TIME: 10:00
OPERATOR: Parkerson Construction, Inc.	OPERATOR REPRESENTATIVE: Eric Valdez	TYPE OF OPERATION: 112c - Construction Regular Operation	
REASON FOR INSPECTION: Normal I&E Program	BOND CALCULATION TYPE: Complete Bond	BOND AMOUNT: \$351,038.00	
DATE OF COMPLAINT: NA	POST INSP. CONTACTS: None	JOINT INSP. AGENCY: None	
INSPECTOR(S): Amy Yeldell	INSPECTOR'S SIGNATURE: 	SIGNATURE DATE: July 22, 2025	

GENERAL INSPECTION TOPICS

This list identifies the environmental and permit parameters inspected and gives a categorical evaluation of each. No problems or possible violations were noted during the inspection. The mine operation was found to be in full compliance with Mineral Rules and Regulations of the Colorado Mined Land Reclamation Board for the Extraction of Construction Materials and/or for Hard Rock, Metal and Designated Mining Operations. Any person engaged in any mining operation shall notify the office of any failure or imminent failure, as soon as reasonably practicable after such person has knowledge of such condition or of any impoundment, embankment, or slope that poses a reasonable potential for danger to any persons or property or to the environment; or any environmental protection facility designed to contain or control chemicals or waste which are acid or toxic-forming, as identified in the permit.

(AR) RECORDS----- <u>N</u>	(FN) FINANCIAL WARRANTY----- <u>Y</u>	(RD) ROADS----- <u>Y</u>
(HB) HYDROLOGIC BALANCE----- <u>Y</u>	(BG) BACKFILL & GRADING----- <u>Y</u>	(EX) EXPLOSIVES----- <u>NA</u>
(PW) PROCESSING WASTE/TAILING---- <u>NA</u>	(SF) PROCESSING FACILITIES----- <u>Y</u>	(TS) TOPSOIL----- <u>Y</u>
(MP) GENL MINE PLAN COMPLIANCE- <u>Y</u>	(FW) FISH & WILDLIFE----- <u>N</u>	(RV) REVEGETATION---- <u>Y</u>
(SM) SIGNS AND MARKERS----- <u>Y</u>	(SP) STORM WATER MGT PLAN---- <u>NA</u>	(RS) RECL PLAN/COMP-- <u>Y</u>
(ES) OVERBURDEN/DEV. WASTE----- <u>N</u>	(SC) EROSION/SEDIMENTATION-- <u>Y</u>	(ST) STIPULATIONS----- <u>N</u>
(AT) ACID OR TOXIC MATERIALS----- <u>NA</u>	(OD) OFF-SITE DAMAGE----- <u>N</u>	

Y = Inspected / N = Not inspected / NA = Not applicable to this operation / PB = Problem cited / PV = Possible violation cited

OBSERVATIONS

This inspection was conducted as part of the Colorado Division of Reclamation, Mining and Safety's (Division) normal monitoring program. The 32 Road Pit is a 112c permitted site that includes a total of 50.40 permitted acres. This site located 6 miles east of Grand Junction, Colorado in Mesa County, at the intersection of Highway 141 and C 1/2 Road. Amy Yeldell of the Division conducted the inspection. Eric Valdez represented the Operator, Parkerson Construction, Inc.

Acid And Toxic Materials:

No fuel or other hazardous debris was observed on site.

Backfilling and Grading:

The highwalls along the northeast side surrounding remain near vertical, averaging 20 ft high. The highwalls around the house will require backfilling (600 LF). The other northern slopes are cut fill as they will eventually daylight out (approx. 900 LF).

330 LF of highwall on the west side of the agricultural field remains. Additionally, the southern permit boundary highwall remains unchanged

Within the stripped southeast corner approx. 1,000 LF requires backfill. An additional 400 LF of interstitial benching between stripped and mined out area is present. This can be cut/fill contoured. Within the northeast corner approximately 400 yards of grading remains. A small eastern portion (200 LF) along the adjacent property required backfill. The remainder of grading throughout the site is cut fill grading.

Explosives:

Explosives are not used at this site.

Financial Warranty:

The Division currently requires a financial warranty amount of \$351,038.00 for this site. The bond has not been increased since SI-3 in 2022 In an effort to ensure the Financial Warranty adequately, reflects the actual current cost of fulfilling the requirements of the approved reclamation plan the Division will be updating the reclamation cost estimate. If the current bond is found to be insufficient the Division will send a Notice of Surety Increase under a separate cover.

Hydrologic Balance:

No exposed groundwater or surface water flows were observed at this site.

Gen. Compliance With Mine Plan:

The site was inactive at the time of the inspection. Mining has progressed since the previous inspection and hauling out of existing stockpiles is evident. A loader was located on site.

Active mining is taking place in the southeast corner (Area 1). The previously stripped bench is being pushed back. It consists of stripped overburden (10-20 ft thick) and the gravel layer (15-25 ft thick). The entirety of Area 1 has been stripped, and a narrow strip remains unmined.

There is additional land to be mined in the northwest section of the pit (Areas 2 and 3). Currently these areas are serving as a visual screen, and will be the last area to be mined. The pit will daylight out with the house in the center remaining with backfilled highwalls.

Several large stockpiles of processed materials are located throughout the pit floor. Some of the overburden is also being sold. The operator is reminded that backfilling for the approximately 35 ft high slopes will require a large amount of material, exercise caution when selling overburden in order to ensure enough material remains on site to complete final reclamation.

Reclamation Success:

There is an agricultural field located in the southwest corner of the permit boundary. The field appears to be functional. The majority of the highwalls appear to be properly graded however that is a small section (330 linear feet) that has additional dirt work remaining. Once this area is contoured and seed is established the cropland area will be ready for release (12 acres). The Division would like to note that this area has been in final reclamation since at least 2002 and should be made a priority.

Revegetation:

Noxious weeds appear to be well managed throughout the pit.

This site has an extremely outdated seed mix for the rangeland areas. All three species are introduced and the seed mix contains no native species. The Division requests that the Operator coordinate with the local conservation district to develop a more modern and ecologically robust seed mix to be used on site. Changes to the Reclamation Plan shall be submitted as a Technical Revision.

Support Facilities On-site:

The scale and scale house located near the pit entrance remains on site. No other structures related to mining are located within the mine site.

Signs and Markers:

A mine sign was posted at the entrance to the mine site as required by Rule 3.1.12(1). The information depicted was correct/ up to date and the sign was of sufficient size. The permit boundary of the affected land was clearly delineated pursuant to Rule 3.1.12(2).

Topsoil:

Topsoil is located in berms above the highwalls surrounding the pits.

Ten photos are included with this report.

No problems or violations were noted during this inspection.

Responses to this inspection report should be directed to: Amy Yeldell at the Division of Reclamation, Mining and Safety, Rm 215, 1001 E 62nd Ave, Denver Co 80216. Direct contact can be made by phone at 970-210-1272 or via email at amy.yeldell@state.co.us

Inspection Contact Address

Eric Valdez
Parkerson Construction, Inc.
710 S. 15th St
Grand Junction, CO 81501

CC:

Travis Marshall, Senior EPS, Grand Junction DRMS

PHOTOGRAPHS







Photo 5: Pit overview, south highwall.

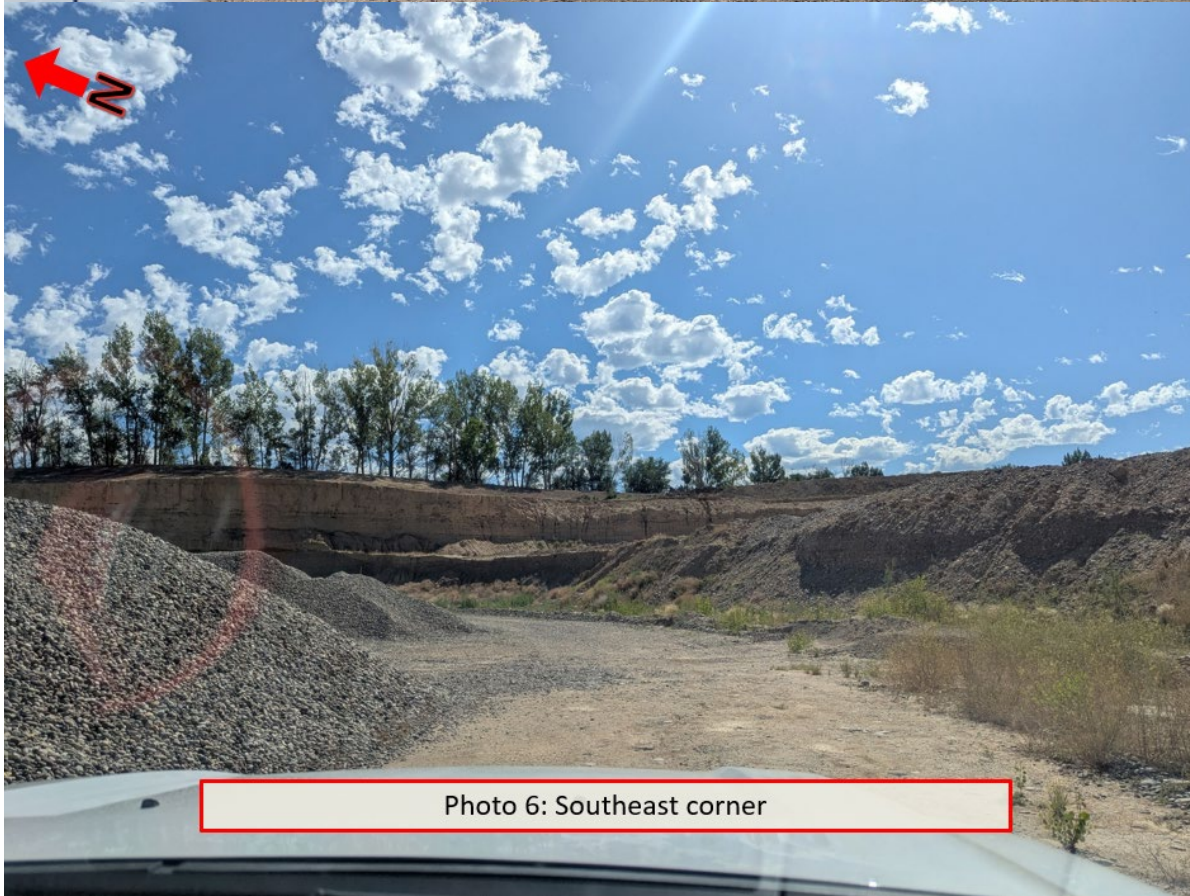

Photo 6: Southeast corner



Photo 7: Pit Overview



Photo 8: Eastern highwalls

