

LEGEND

- PERMIT BOUNDARY
- SECTION LINE
- GEOLOGICAL CONTACT
- FAULT
- Kwf** WILLIAMS FORK FORMATION
- Ki** ILES FORMATION
- Km** MANCOS SHALE
- ANTICLINE-SHOWING TRACE OF AXIAL PLANE AND DIRECTION OF PLUNGE
- SYNCLINE-SHOWING TRACE OF AXIAL PLANE AND DIRECTION OF PLUNGE
- STRIKE WITH 0 - 3 DEGREE DIP *
- STRIKE WITH 3 - 10 DEGREE DIP *
- STRIKE WITH 10 - 25 DEGREE DIP *
- CROSS SECTIONS (FIGURES 2.04.6 SHEETS 1 & 2)

- B BURN AREAS (NOT ALL AREAS SHOWN) *
- Q SURFICIAL DEPOSITS, UNDIFFERENTIATED. * INCLUDES SOME AREAS OF BURN.
- Qls LANDSLIDE DEPOSITS *
- Qv VALLEY FILL DEPOSITS
- * From: Photogeologic map of an area in Rio Blanco and Moffat Counties, Colorado. By: Intrasearch, Denver, Colorado (unpublished) and field geology

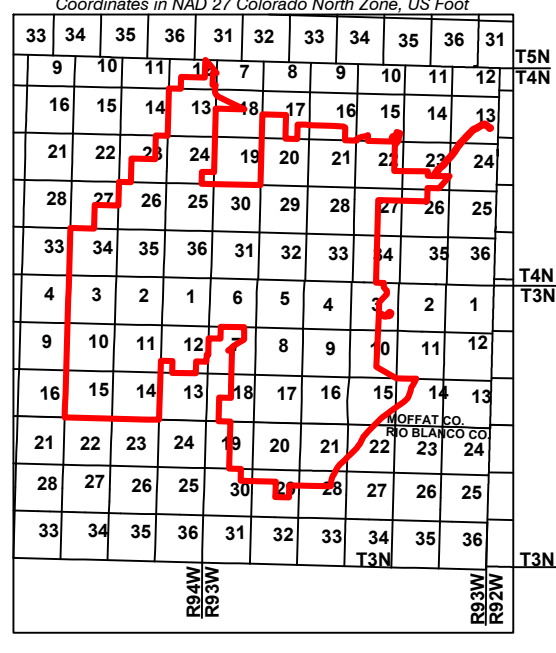
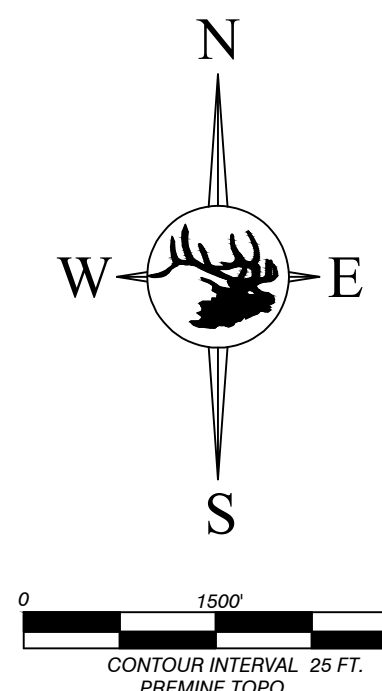

ENGINEERS CERTIFICATION
I, Trevor B. Hagadone, hereby certify that this map has been reviewed by me and is true and correct to the best of my knowledge and information, relying on information supplied by experts employed by Colowyo Coal Company or qualified consultants working for Colowyo Coal Company, and that I am a Professional Engineer licensed in Colorado as required by the provisions of C.R.S. 12-25-119. IN WITNESS WHEREOF, I have hereunder set my hand and affixed my seal.



REGIONAL GEOLOGY



SCALE: 1" = 1000'
DATE: 5/2023
DRAWN BY: JCP
APPROVED BY: TBH

MAP 7A

No.	REVISION	DATE	BY	CHK
TR-141	Updated Permit Boundary	8/13/20	TCNY	AA
TR-155	Updated Permit Boundary	8/13/22	TCNY	TCNY
TR-165	Updated Permit Boundary & Mini Map	12/20/24	TCNY	TR
TR-167	Updated Permit Boundary & Mini Map	5/9/23	TCNY	TR

Note: Q means Quaternary