

LEGEND

- Permit Boundary
- Section Line
- Streams
- Roads
- Colowyo Coal Company L.P.
- Axial Basin Coal Company
- Bureau of Land Management
- State of Colorado
- Private Surface Ownership (As Noted)

NOTE: SEE EXHIBIT 1, ITEM 9 FOR LIST OF NAMES AND ADDRESSES OF OWNERS WITHIN AND CONTIGUOUS TO PERMIT BOUNDARY PER RULE 2.03.4 (7)

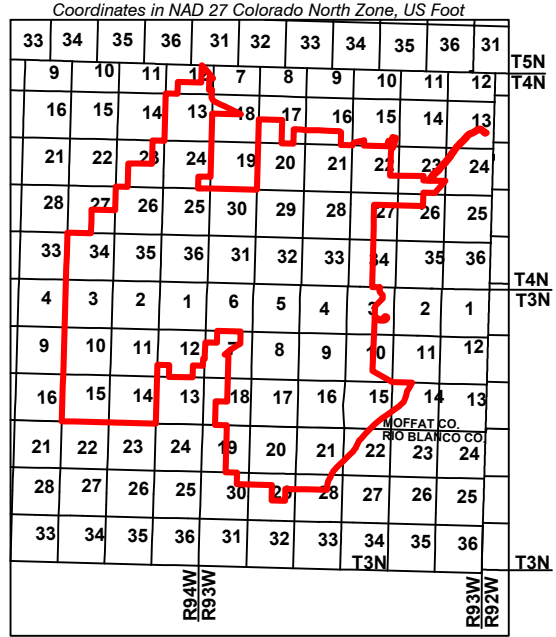
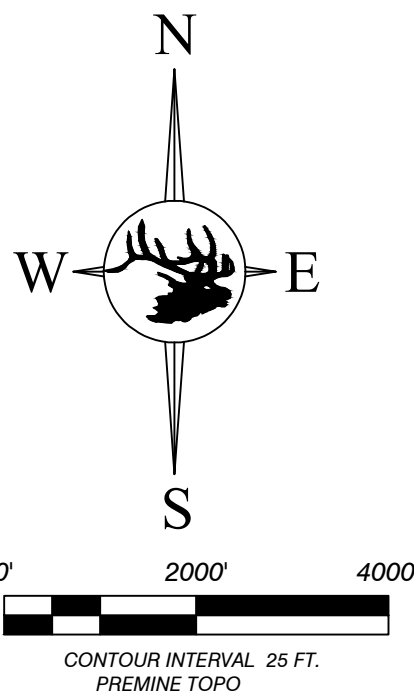

ENGINEERS CERTIFICATION
I, Trevor B. Riggsdale, hereby certify that this map has been reviewed by me and is true and correct to the best of my knowledge and information, relying on information supplied by experts employed by Colowyo Coal Company or qualified consultants working for Colowyo Coal Company, and that I am a Professional Engineer licensed in Colorado as required by the provisions of C.R.S. 12-25-101 through C.R.S. 12-25-119. IN WITNESS WHEREOF, I have hereunder set my hand and affixed my seal.



SURFACE OWNERSHIP



SCALE: 1" = 2000'
DATE: 5/18/2025
DRAWN BY: TCR
APPROVED BY:
DRAWN NO.

MAP 1

No.	REVISION	DATE	BY	CHK
TR-141	Updated Permit Boundary	8/13/20	TONY	AA
RM-05	Revised Private Ownership	4/14/22	TONY	AA
TR-165	Updated Permit Boundary & Mini Map	12/3/24	TONY	TR
TR-167	Updated Permit Boundary & Mini Map	5/9/25	TONY	TR