

## 6.4.1 EXHIBIT A – Legal Description

### (A) Legal Description

The West Side Placer exists on ground legally described as:

Township 12 North, Range 94 West, 6th Principal Meridian:

- Section 24:
- Lot 4: The Northwest quarter (NW 1/4), Southwest quarter (SW 1/4), and Southeast quarter (SE 1/4), totaling three-fourths of Lot 4.
- Lot 5: The eastern half (E 1/2).
- Lot 9: Entire lot.

The West Side Placer project spans 80 acres of land exclusively owned by the Colorado State Land Board.

### (B) Mine Entrance

The mine entrance is located at 107°54'5"W and 40°59'23"N WGS 84.

MINE ENTRANCE MAP

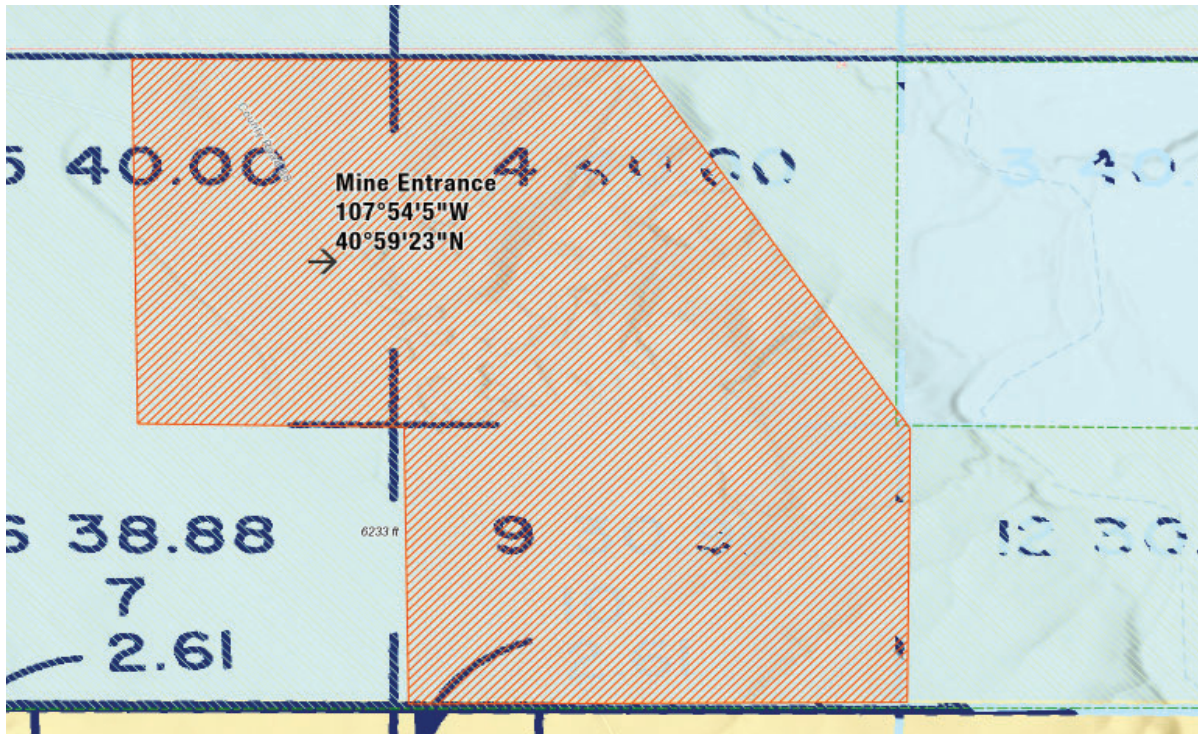

### (J) Maps Index