



STATE OF
COLORADO

Simmons - DNR, Leigh <leigh.simmons@state.co.us>

C1980007, West Elk Mine, February 2025 Inspection Report

Simmons - DNR, Leigh <leigh.simmons@state.co.us>
To: "Munz, Bob" <RobertMunz@coresources.com>

Fri, Mar 7, 2025 at 4:44 PM

Please find the inspection report attached.

Leigh Simmons
Environmental Protection Specialist



COLORADO
Division of Reclamation,
Mining and Safety
Department of Natural Resources

P [720.220.1180](tel:720.220.1180)

1313 Sherman Street, Room 215, Denver, CO 80203

leigh.simmons@state.co.us | <https://drms.colorado.gov>



INSP-REPORTC_C1980007_LDS_03072025042820.pdf
3324K



PERMIT INFORMATION

Permit Number: C-1980-007 Mine Name: West Elk Mine Operator: Mountain Coal Company, LLC Operator Address: Robert Munz 5174 Highway 133 Somerset, CO 81434	County: Delta, Gunnison Operation Type: Underground Permit Status: Active Ownership: Private
	Operator Representative Present: Josh Thompson
Operator Representative Signature: (Field Issuance Only) 	

INSPECTION INFORMATION

Inspection Start Date: February 27, 2025 Inspection Start Time: 11:00 Inspection End Date: Inspection End Time:	Inspection Type: Coal Partial Inspection Inspection Reason: Normal I&E Program Weather: Clear
Joint Inspection Agency: None	Joint Inspection Contacts:
Post Inspection Agency: None	Post Inspection Contacts:
Inspector(s): Leigh Simmons	Inspector's Signature:  Signature Date: March 7, 2025

Inspection Topic Summary

NOTE: Y=Inspected N=Not Inspected R=Comments Noted V=Violation Issued NA=Not Applicable

N - Air Resource Protection

N - Availability of Records

Y - Backfill & Grading

Y - Excess Spoil and Dev. Waste

N - Explosives

Y - Fish & Wildlife

Y - Hydrologic Balance

R - Gen. Compliance With Mine Plan

R - Other

R - Processing Waste

N - Roads

N - Reclamation Success

N - Revegetation

N - Subsidence

R - Slides and Other Damage

R - Support Facilities On-site

Y - Signs and Markers

N - Support Facilities Not On-site

N - Special Categories Of Mining

Y - Topsoil

COMMENTS

This was a partial inspection by Leigh Simmons of the Division of Reclamation, Mining and Safety (Division). The weather was clear and dry, with snow on the ground. The mine was active. The inspection was accompanied by Josh Thompson of Mountain Coal Company (MCC).

GENERAL MINE PLAN COMPLIANCE:

Longwall mining of the LWE16 panel was in progress, between cross-cuts 10 and 9 on the head gate.

Three development crews were working: in the B26 tail gate at around cross-cut 27, in the B26 head gate at around cross-cut 49, and in the B27 head gate at around cross-cut 27.

Contractors with Phoenix Mining continued to work on pillaring of the Sunset Mains, the job was expected to be completed by March 2025.

OTHER (SPECIFY):

The merger between Arch Resources and Consol Energy was completed in January, to form a new entity: Core Natural Resources, Inc. No changes were made to Mountain Coal Company, which continues to be the operator of the West Elk Mine. MCC plan to update the Permit Application Packet (PAP) with up-to-date information about the corporate hierarchy and the officers and directors as soon as possible.

PROCESSING WASTE/COAL MINE WASTE PILES – Rule 4.10 and 4.11**Drainage Control; Surface Stabilization; Placement:**

The processing plant continued to operate intermittently, to process material from the longwall as well as the development sections. Waste material was being temporarily stockpiled on the RPE.

The RPEE was not accessible, but the outcrops could be seen from across the river. The pile was snow-covered and there was no sign of any instability.

Stockpiled coal fines continued to be drawn down, with an estimated 60,000 tons remaining.

SLIDES and DAMAGE - Rule 4.12:

A small slump had been identified above the hairpin on the Sylvester Gulch haul road. The slump was in

Number of Partial Inspection this Fiscal Year: 6

Number of Complete Inspections this Fiscal Year: 2

undisturbed soil. The area will continue to be monitored.

SUPPORT FACILITIES - Rule 4.04:

The Box Canyon North was online.

The project to line silo 2 was still in progress. Concrete had begun to be poured. The project was estimated to be completed in August 2025.

Work had not begun on the loadout drainage project as MCC continued to review the design. If significant changes from the previously approved design are made the Permit Application Packet should be updated with a Minor Revision. It was expected that work would begin on the project in April/May 2025.

DOCUMENTS RECEIVED

N/A

OTHER (SPECIFY)

N/A

ENFORCEMENT ACTIONS/COMPLIANCE

No enforcement actions were initiated as a result of this inspection, nor are any pending.

Number of Partial Inspection this Fiscal Year: 6

Number of Complete Inspections this Fiscal Year: 2

PHOTOGRAPHS



Figure 1: Work in progress on Silo 2



Figure 2: RPE, south edge

Number of Partial Inspection this Fiscal Year: 6

Number of Complete Inspections this Fiscal Year: 2



Figure 3: Temporary waste pile on RPE



Figure 4: Vie to the south from Shaft 3

Number of Partial Inspection this Fiscal Year: 6

Number of Complete Inspections this Fiscal Year: 2



Figure 5: Run-of-mine coal stockpile



Figure 6: Overview of facilities

Number of Partial Inspection this Fiscal Year: 6

Number of Complete Inspections this Fiscal Year: 2



Figure 7: Aggregate storage area

Number of Partial Inspection this Fiscal Year: 6

Number of Complete Inspections this Fiscal Year: 2

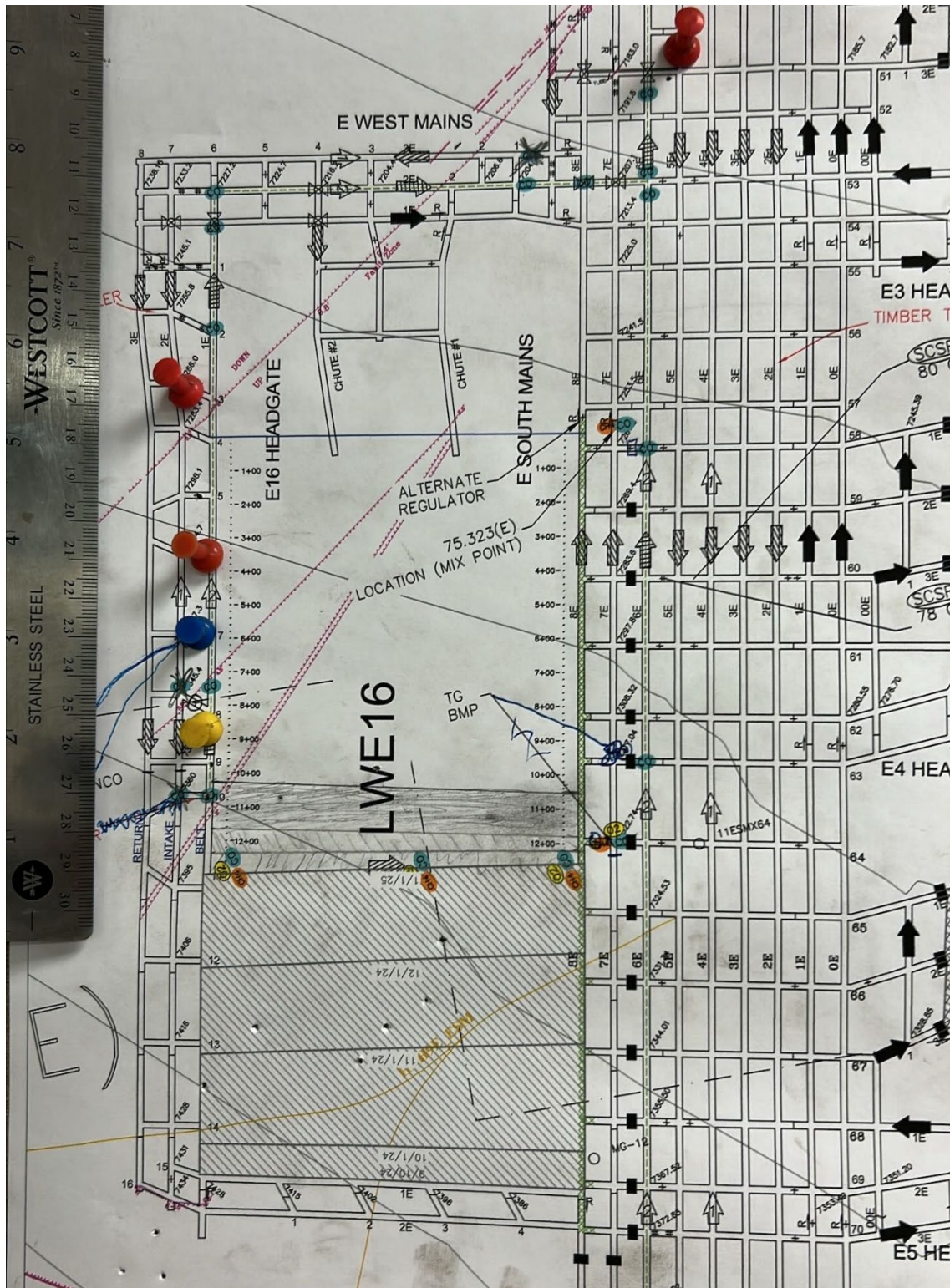

Figure 8: Mine map showing longwall progress in LWE16 panel

Number of Partial Inspection this Fiscal Year: 6

Number of Complete Inspections this Fiscal Year: 2



Number of Complete Inspections this Fiscal Year: 2