

## EXHIBIT E – RECLAMATION PLAN

120th Estate Partners, Permit No. M-2001-085

See Exhibit 1 for Overall Reclamation Plan Map for locations/descriptions of each area

### Henderson Pit Mining Area – Amendment 2 (2003)

Amendment 2 added 41.2 acres in the southwest corner of the site. By this amendment, we seek to change the reclamation of the mined land of the permit area from a clay-lined water storage reservoir to a backfilling of the site to two or more feet above the historical water table. The site will be backfilled with only clean fill dirt and other inert materials. Asphalt fragment and uncured concrete will not be placed below the alluvial water table per Adams County and CDPHE regulations. The site will be capped with clean dirt, seeded and restored to the pre mining condition. Seed mixes are included in this reclamation plan following the permit area descriptions. See Exhibit 2 for the updated Closure Plan/Final Topography of the Henderson Pit site.

Sand and Gravel mining has been completed on the site. The open pit of approximately 28 acres has been backfilled with inert material to bring the grade to a minimum of two feet above the water table.

The ditch crossing included in amendment 2 was completed and the ditch functionality has been maintained.

### Ski Lake Dredging - Amendment 3 (2004)

Amendment 3 added 7.6 acres into the permit area: 5 acres to dredge a portion of the adjacent ski lake, a 0.4 acre crossing of the Fulton Ditch, and incorporated 2.2 acres from Permit No. M-2002-113. This work was completed years ago and the since that time the ski lake has been restored to its use as a recreational lake surface. All areas associated with the access road have been reestablished to the historic condition for the adjacent property owner.

### Release Request 1 (AR1) 2004

The original permit area, a 34.3-acre reservoir on the north end of the site, has been released leaving 49.10 acres in the permit area.

### Stockpiling Permit - Amendment 5 (2011)

2 acres were added to incorporate two stockpiles on the adjacent property bringing the total acres to 51.10. The temporary stockpiles have been removed and the pre-stockpile condition has been reestablished.

## TYPE B SEED MIX: UPLAND SEED MIX

### Upland Shade-Tolerant Mix

Scientific Name (USDA)	Common Name (USDA)	Cultivar or Ecotype	Life History	% Mix	Pounds PLS Needed
<i>Achillea lanulosa</i> var. <i>occidentalis</i>	Western yarrow	Eagle or Yakima	NPF	3	0.02
<i>Adenolinum lewisii</i>	Lewis flax	Maple Grove or CO ecotype	NPF	6	0.46
<i>Bromus ciliatus</i>	fringed brome	Central CO	NPG-L	12	1.15
<i>Bromus marginatus</i>	mountain brome	Cold Springs Ecotype	NPG-L	12	3.24
<i>Coreopsis tinctoria</i>	plains coreopsis	CO Ecotype (or VNS)	NBF	2	0.03
<i>Elymus canadensis</i>	Canada wildrye	Mandan	NPG-L	10	1.99
<i>Elymus lanceolatus</i> ssp. <i>Lanceolatus</i>	thickspike wheatgrass	Critana	NPG-L	12	2.01
<i>Elymus trachycaulus</i>	slender wheatgrass	Pryor	NPG-L	12	1.88
<i>Gaillardia aristata</i>	blanketflower	CO Ecotype (or VNS)	NPF	2	0.24
<i>Monarda pectinata</i>	bergamot	CO Ecotype preferred	NAF	4	0.07
<i>Pascopyrum smithii</i>	western wheatgrass	Arriba	NPG-L	8	1.59
<i>Penstemon virgatus</i>	Front Range beardtongue	CO Ecotype or Bluebuckle	NPF	4	0.17
<i>Poa fendleriana</i>	muttongrass	Ruin Cyn	NPG-L	6	0.15
<i>Solidago missouriensis</i>	Missouri goldenrod	CO Ecotype (or VNS)	NPF	5	0.06
<i>Rudbeckia hirta</i>	blackeyed Susan	CO Ecotype (or VNS)	NBF	2	0.03

## TYPE C SEED MIX: FACULTATIVE SEED MIX

### Facultative

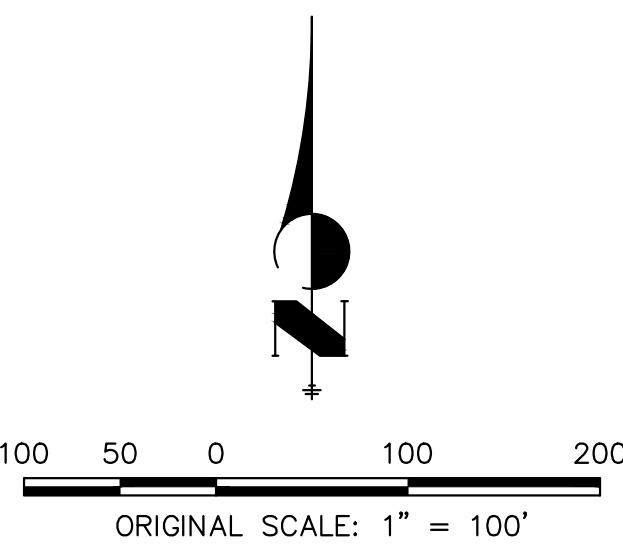
Scientific Name (USDA)	Common Name (USDA)	Cultivar or Ecotype	Life History	% Mix	Pounds PLS Needed
<i>Andropogon gerardii</i>	big bluestem	Bonilla	NPG-L	4	1.10
<i>Asclepias speciosa</i>	showy milkweed	CO Ecotype preferred	NPF	0.5	0.29
<i>Bromus ciliatus</i>	fringed brome	Central CO	NPG-L	8	1.39
<i>Carex praegracilis</i>	clustered field sedge	CO Ecotype (or VNS)	NPG-L	2	0.12
<i>Distichlis spicata</i>	saltgrass	CO Ecotype (or VNS)	NPG-L	8	0.63
<i>Elymus canadensis</i>	Canada wildrye	Mandan	NPG-L	8	2.89
<i>Elymus lanceolatus</i> ssp. <i>lanceolatus</i>	thickspike wheatgrass	Critana	NPG-L	7	2.13
<i>Glycyrrhiza lepidota</i>	American licorice	CO Ecotype (or VNS)	NPF	0.5	0.33
<i>Helianthus maximiliani</i>	Maximilian sunflower	CO Ecotype (or VNS)	NPF	2	0.45
<i>Hordeum jubatum</i>	foxtail barley	CO Ecotype (or VNS)	NPG-L	3	0.57
<i>Juncus arcticus</i> ssp. <i>littoralis</i>	wire rush	CO Ecotype preferred	NPG-L	5	0.02
<i>Nassella viridula</i>	green needlegrass	Cucharas	NPG-L	7	1.59
<i>Panicum virgatum</i>	switchgrass	Blackwell	NPG-L	12	2.14
<i>Pascopyrum smithii</i>	western wheatgrass	Arriba	NPG-L	12	4.33
<i>Puccinellia nuttalliana</i>	Nuttal alkalaigrass	CO Ecotype (or VNS)	NPG-L	5	0.07
<i>Sporobolus airoides</i>	alkali sacaton	Saldado	NPG-L	6	0.15
<i>Sporobolus cryptandrus</i>	sand dropseed	CO Ecotype preferred	NPG-L	10	0.08

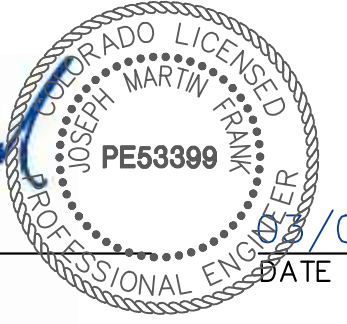


**EXHIBIT 1**  
**OVERALL RECLAMATION MAP**  
**120TH ESTATE PARTNERS, PERMIT NO. M-2001-085**



LEGEND	
	EXISTING GROUND WATER MONITORING WELL
	EXISTING FENCING
	EXISTING GRAVEL ENTRANCE/EXIT ROAD
	PERMIT BOUNDARY



  
JOSEPH MARTIN FRANK  
COLORADO P.E. 53399  
FOR AND ON BEHALF OF JR ENGINEERING, LLC  
 03/05/2025

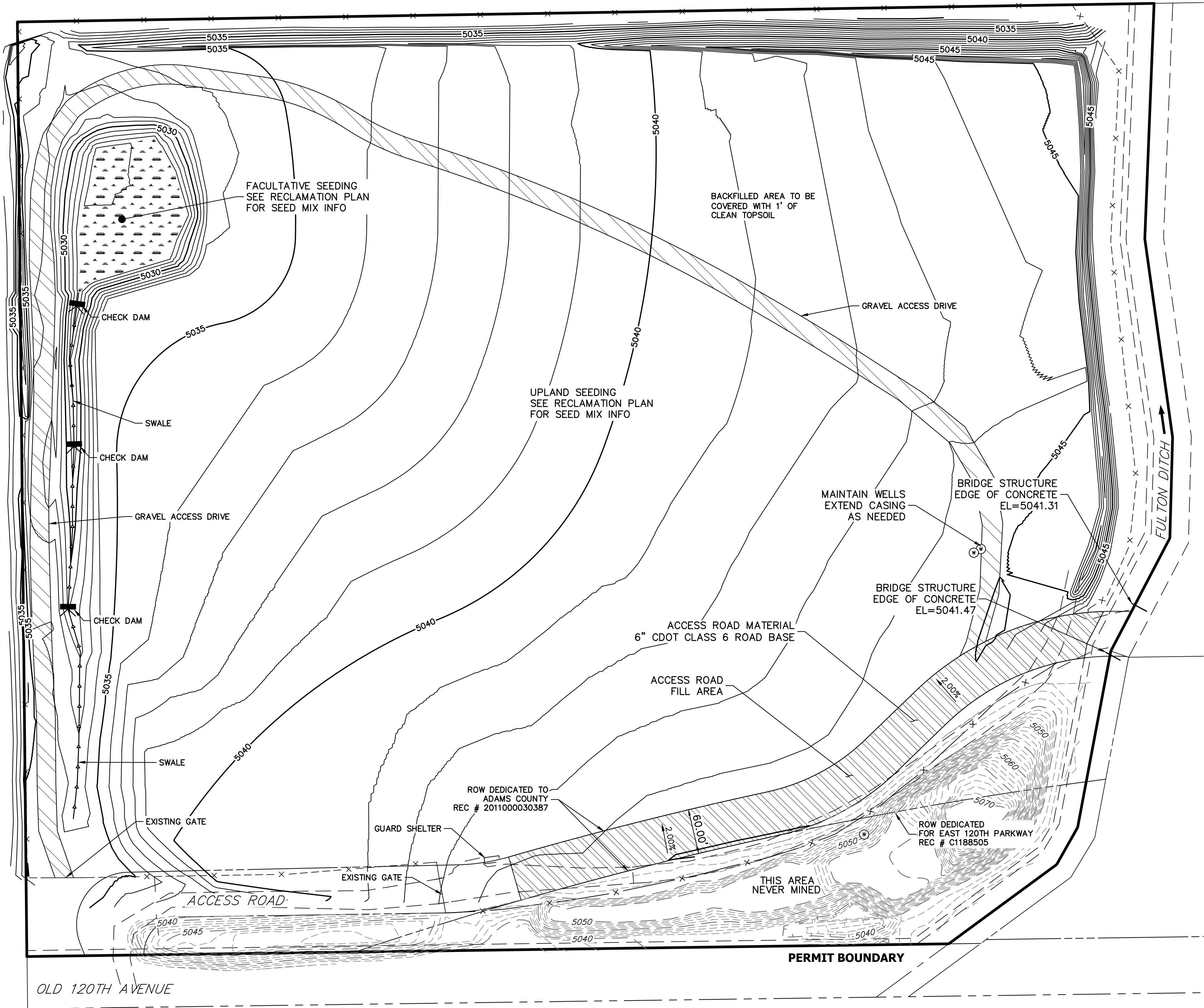
OVERALL RECLAMATION MAP  
HENDERSON PIT & ADJACENT AREAS  
JOB NO. 15694.00  
03/05/25  
SHEET 1 OF 2

 **J-R ENGINEERING**  
A Westrian Company

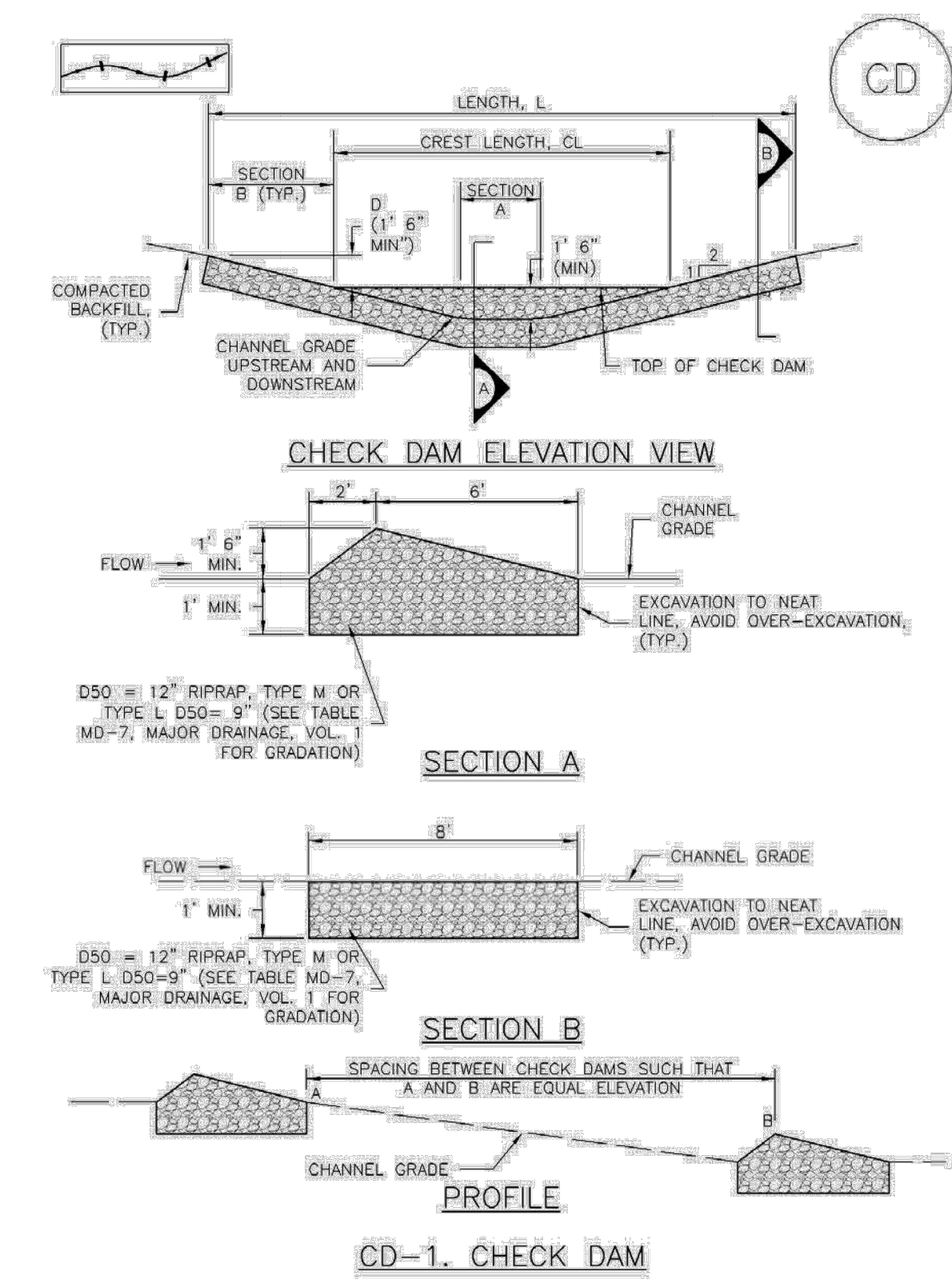
7200 S. Alton Way, Suite C100, Centennial, CO 80112  
303-740-9383 • Fax: 303-721-9019 • [www.jrengineering.com](http://www.jrengineering.com)



EXHIBIT 2  
CLOSURE PLAN/FINAL TOPOGRAPHY  
120TH ESTATE PARTNERS, PERMIT NO. M-2001-085

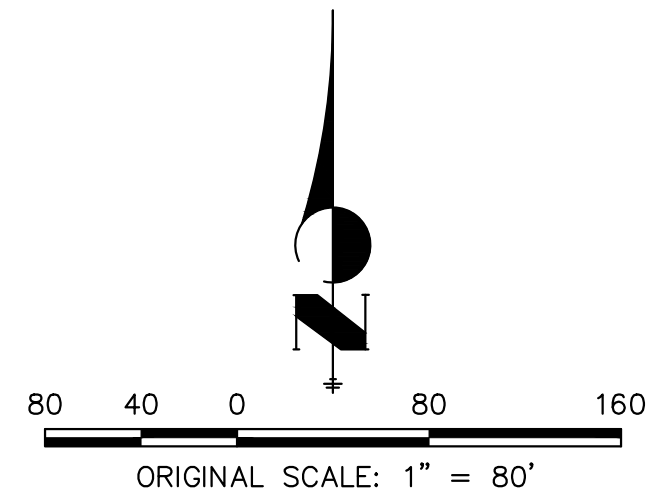


Check Dams (CD) EC-12



November 2010 Urban Drainage and Flood Control District CD-3  
Urban Storm Drainage Criteria Manual Volume 3

LEGEND	
	EXISTING GROUND WATER MONITORING WELL
	EXISTING STRUCTURES
	EXISTING FENCING
	EXISTING GRAVEL ENTRANCE/EXIT ROAD
	PERMIT BOUNDARY
	PROPOSED FENCING
	SWALE
	CHECK DAM
	ACCESS ROAD FILL AREA



JOSEPH MARTIN FRANK  
COLORADO P.E. 53399  
FOR AND ON BEHALF OF JR ENGINEERING, LLC  
DATE 03/05/2025  
CLOSURE PLAN/FINAL TOPOGRAPHY  
HENDERSON PIT-LOT 1 CORRIGAN SUB.  
JOB NO. 15694.00  
03/05/25  
SHEET 2 OF 2

J-R ENGINEERING  
A Westrian Company

7200 S. Alton Way, Suite C100, Centennial, CO 80112  
303-740-9393 • Fax: 303-721-9019 • www.jrengineering.com