



MINERALS PROGRAM INSPECTION REPORT
PHONE: (303) 866-3567

The Division of Reclamation, Mining and Safety has conducted an inspection of the mining operation noted below. This report documents observations concerning compliance with the terms of the permit and applicable rules and regulations of the Mined Land Reclamation Board.

MINE NAME: SPN Pit	MINE/PROSPECTING ID#: M-2020-006	MINERAL: Gravel	COUNTY: Huerfano
INSPECTION TYPE: Monitoring	WEATHER: Cloudy	INSP. DATE: February 11, 2025	INSP. TIME: 11:30
OPERATOR: Fremont Paving & Redi-Mix, Inc.	OPERATOR REPRESENTATIVE: None	TYPE OF OPERATION: 112c - Construction Regular Operation	
REASON FOR INSPECTION: Normal I&E Program	BOND CALCULATION TYPE: Partial Bond	BOND AMOUNT: \$79,395.00	
DATE OF COMPLAINT: NA	POST INSP. CONTACTS: None	JOINT INSP. AGENCY: None	
INSPECTOR(S): Amber M. Gibson	INSPECTOR'S SIGNATURE: 	SIGNATURE DATE: February 19, 2025	

GENERAL INSPECTION TOPICS

This list identifies the environmental and permit parameters inspected and gives a categorical evaluation of each. No problems or possible violations were noted during the inspection. The mine operation was found to be in full compliance with Mineral Rules and Regulations of the Colorado Mined Land Reclamation Board for the Extraction of Construction Materials and/or for Hard Rock, Metal and Designated Mining Operations. Any person engaged in any mining operation shall notify the office of any failure or imminent failure, as soon as reasonably practicable after such person has knowledge of such condition or of any impoundment, embankment, or slope that poses a reasonable potential for danger to any persons or property or to the environment; or any environmental protection facility designed to contain or control chemicals or waste which are acid or toxic-forming, as identified in the permit.

(AR) RECORDS----- <u>Y</u>	(FN) FINANCIAL WARRANTY----- <u>Y</u>	(RD) ROADS----- <u>N</u>
(HB) HYDROLOGIC BALANCE----- <u>N</u>	(BG) BACKFILL & GRADING----- <u>N</u>	(EX) EXPLOSIVES----- <u>N</u>
(PW) PROCESSING WASTE/TAILING---- <u>N</u>	(SF) PROCESSING FACILITIES----- <u>N</u>	(TS) TOPSOIL----- <u>N</u>
(MP) GENL MINE PLAN COMPLIANCE- <u>Y</u>	(FW) FISH & WILDLIFE----- <u>N</u>	(RV) REVEGETATION---- <u>N</u>
(SM) SIGNS AND MARKERS----- <u>Y</u>	(SP) STORM WATER MGT PLAN---- <u>N</u>	(RS) RECL PLAN/COMP-- <u>N</u>
(ES) OVERBURDEN/DEV. WASTE----- <u>N</u>	(SC) EROSION/SEDIMENTATION--- <u>N</u>	(ST) STIPULATIONS----- <u>N</u>
(AT) ACID OR TOXIC MATERIALS----- <u>N</u>	(OD) OFF-SITE DAMAGE----- <u>N</u>	

Y = Inspected / N = Not inspected / NA = Not applicable to this operation / PB = Problem cited / PV = Possible violation cited

OBSERVATIONS

The SPN Pit was inspected by Amber Gibson with the Division of Reclamation, Mining and Safety (Division/DRMS). The inspection was completed as part of the Division's routine monitoring inspection program. The site was previously inspected by the Division on May 26, 2021 as a routine monitoring inspection. The weather was windy, cool, and the skies were cloudy.

The SPN pit is permitted under a 112c Regular Operations Construction Materials permit. The entrance to the 36.8-acre site is 1.6 miles north on County Road 614 from the junction of 614 and CO-69. The SPN Pit is approximately 11.3 miles northwest of Walsenburg, CO and 4 miles east of Badito, CO. The pre-mining and post-mining land use is rangeland. The commodity to be mined at this site is gravel.

Availability of Records:

The annual report, map, and fee are paid through October 22, 2025. There are no outstanding infractions.

Financial Warranty:

At this time, there is no disturbance that needs to be reclaimed. Additionally, no new disturbance is planned for the near future. Therefore, the Division believes that the currently held \$79,395.00 financial warranty is adequate to reclaim disturbance that may occur prior to the next routine inspection.

General Compliance with the Mine Plan:

Operations have not yet begun at the SPN pit (Photo 1-3). No compliance concerns were observed at the time of the inspection.

Signs and Markers:

A mine sign is posted at the mine entrance pursuant to Rule 3.1.12(1) (Photos 1-3). The permit boundary was marked pursuant to Rule 3.1.12(2) with 2-inch PVC casing. The permit boundary markers are visible from the road and appear to be in the same locations they were in during the Division's 2020 pre-operation inspection (Map 1).

Conclusion:

This concludes the Division's Inspection Report; photographs that were taken during the time of the inspection, and a corresponding inspection map, are included below. If you need additional information or have any questions, please contact me by email at amber.gibson@state.co.us or by telephone at (720) 836-0967.

Inspection Contact Address

Fremont Paving & Redi-Mix, Inc.
839 Mackenzie Ave
Canon City, CO 81215

CC: Jared Ebert, DRMS

PHOTOGRAPHS



Photo 1: Looking east towards the north/central side of the permit area.



Photo 2: Looking east towards the south side of the permit area.



Photo 3: Looking east into the permit area from the road.

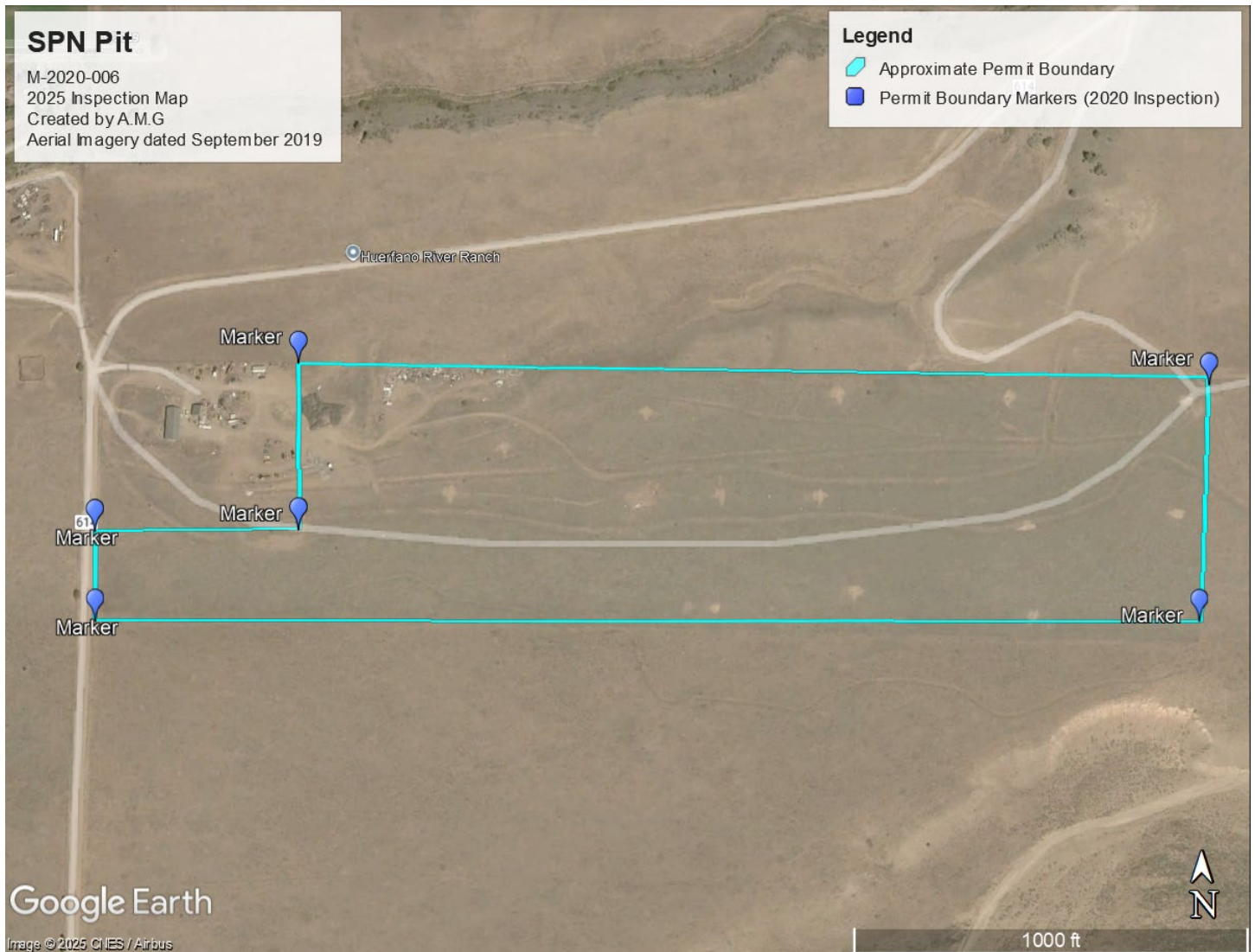

Map 1: Inspection map created in Google Earth Pro. Although the aerial imagery is dated September 2019, little appears to have changed since the photo was taken, as mining activity has not yet begun at the site.