



STATE OF
COLORADO

Gibson - DNR, Amber <amber.gibson@state.co.us>

Follow up objections from the Keirnes group

Gibson - DNR, Amber <amber.gibson@state.co.us>

Wed, Feb 19, 2025 at 9:30 AM

To: Tim Naylor <tnaylor@agpros.com>

Cc: Scott Cockroft <srccockroft@gmail.com>

Good morning,

Attached are additional concerns/objections raised by the landowners of the affected land for the Seeley Reservoir Stockpiles (M-2023-043) application, received on February 18, 2025, that will need to be addressed. The concerns are in addition to the ones forwarded on February 10, 2025.

Thank you,

Amber Michels Gibson
Environmental Protection Specialist I



COLORADO
Division of Reclamation,
Mining and Safety
Department of Natural Resources

P 720.836.0967 | F 303.832.8106 |
amber.gibson@state.co.us

Mailing: DRMS Room 215, 1001 E 62nd Ave, Denver, CO 80216

Physical: 1313 Sherman Street, Room 215, Denver, CO 80203

<https://drms.colorado.gov/>

[Quoted text hidden]



Follow up objections from the Keirnes group_submitted Feb 18_after adq review and phone call on Feb 6_attachm.pdf
1903K



STATE OF
COLORADO

Gibson - DNR, Amber <amber.gibson@state.co.us>

RE: Seeley Reservoir Stockpiles, File No. # M-2023-043, New 112c Application, Adequacy Review-1

charles keirnes <charles@keirnescompanies.com>
To: "Gibson - DNR, Amber" <amber.gibson@state.co.us>
Cc: "spencer@keirnesre.com" <spencer@keirnesre.com>

Tue, Feb 18, 2025 at 11:14 AM

Hi Amber,

We have an additional comment, which I noted during our call. Please see the attached, highlighting another area of concern related to the damn/structure.

Let me know if you have any questions. Thank you!

[Quoted text hidden]



Keirnes Comments -- Permit M2023043 Adequacy Review Additional Comments 2.18.25.pdf
1561K



Charles Keirnes
PO BOX 7
Eaton, CO, 80615
970-539-2204
Charles@keirnescompanies.com

February 18, 2025

Amber M. Gibson
Division of Reclamation, Mining and Safety
1313 Sherman Street, Room 215
Denver, CO 80203

RE: Seeley Reservoir Stockpiles, File No. M-2023-043 (Adequacy Review/Additional Application Comments)

Amber,

On behalf of the landowners of Lots' A and B of REC EXEMPT RE-5061 and Lot D of REC EXEMPT RECX15-0012, below is an additional comment/concern related to Permit # M-2023043 in relation to our noted affected properties.

1. Please see the image below, highlighting an emergency spillway that would have a detrimental impact to our property and was built in conjunction with the structure impacting our properties. I have also included via "Attachment B" the retroactively stamped plans related to this structure/area of concern noted in previous comments.



We appreciate your further consideration of our ongoing comments/questions/concerns related to the impacts this permit directly has on our subject properties. Please don't hesitate to reach out to me with any question.

Sincerely,

Charles Keirnes

Charles Keirnes

ATTACHMENT B

SEELEY RESERVOIR SEDIMENT BASIN CONSTRUCTION DRAWINGS

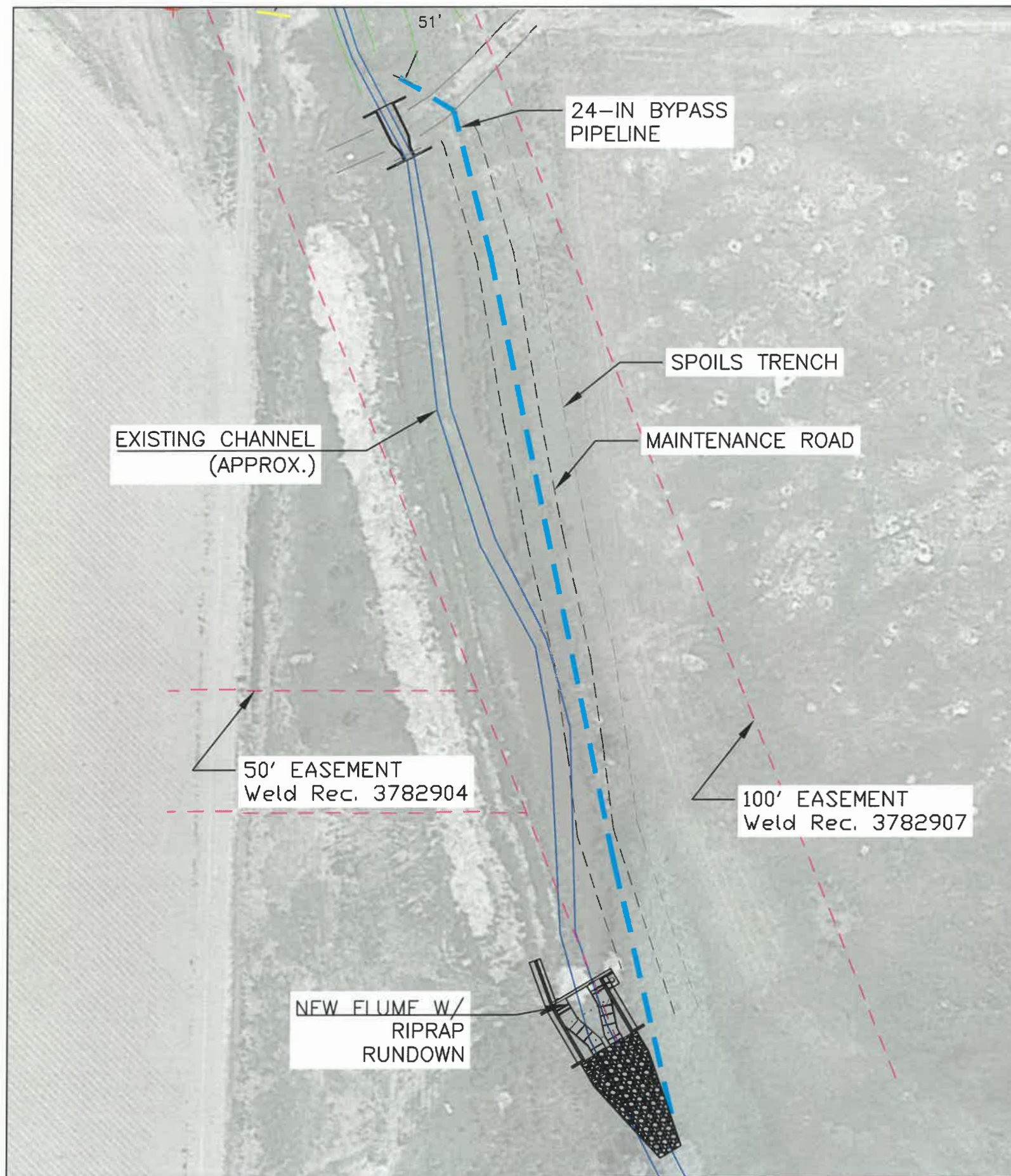

SEELEY LAKE RESERVOIR SEDIMENT BASIN PROJECT

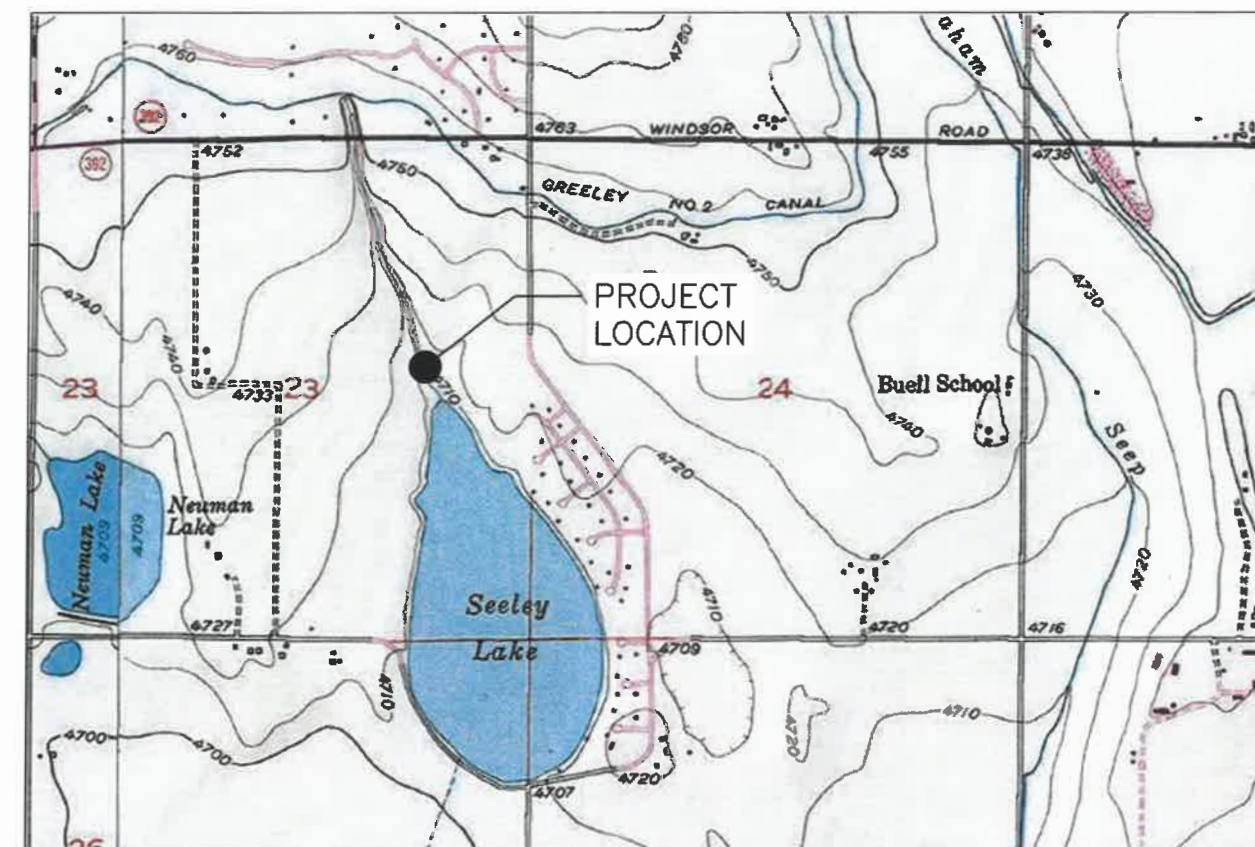

PROJECT VICINITY MAP



REVISIONS				NOCO ENGINEERING, INC. (970) 989-1459 FAX: (970) 352-8886 8309 W. 20TH ST., STE A GREELEY, CO 80634	Ogilvy Irrigating and Land Co.	SEELEY RESERVOIR SEDIMENT BASIN SITE PLAN	SHEET 1
NO.	DESCRIPTION	DATE	BY				
1	Preliminary Design - DRAFT	4/21/24	DCS				
1	Various revisions	6/28/24	DCS				
				DATE: 6/26/24			

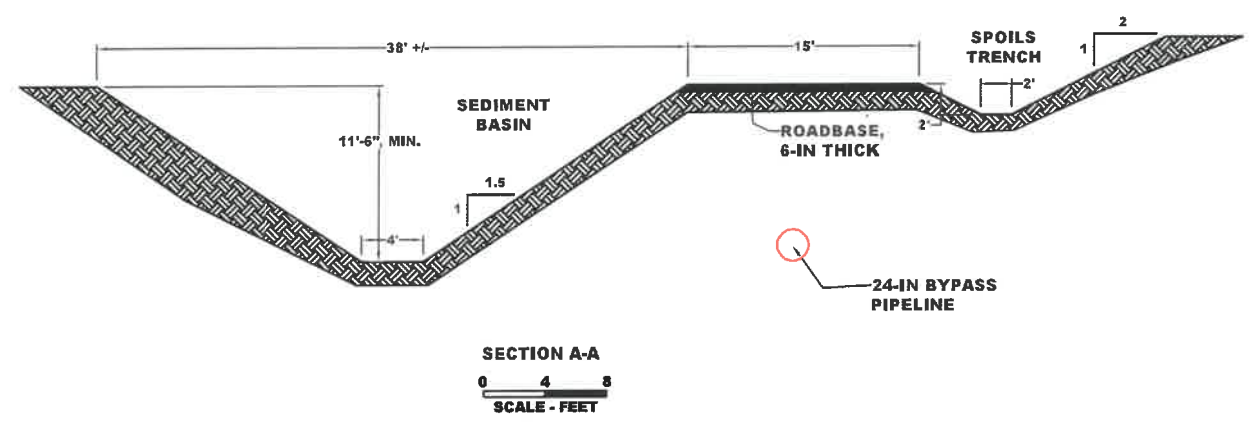
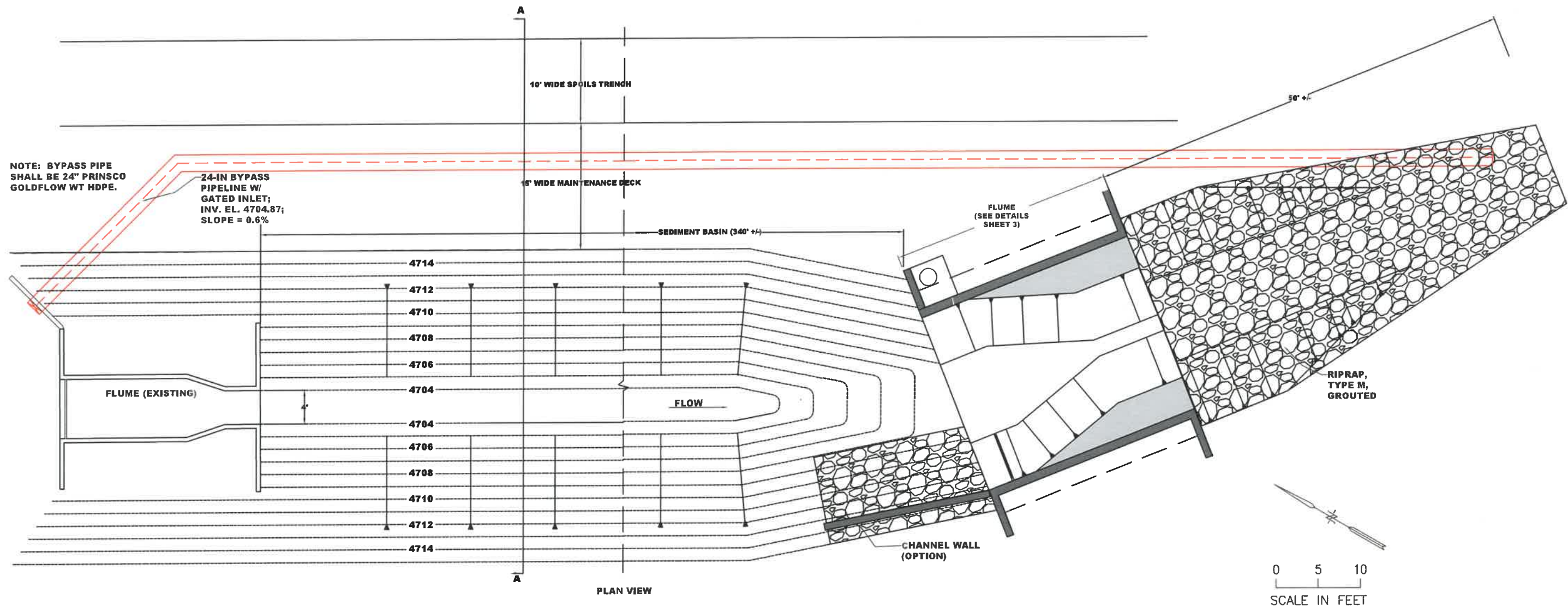

REVISIONS				NOCO ENGINEERING, INC. (970) 955-1459 FAX: (970) 352-4088 8209 W. 20TH ST., STE A GREELEY, CO 80634		Ogilvy Irrigating and Land Co.	SHEET 2
NO.	DESCRIPTION	DATE	BY	DATE: 6/26/24		SEELEY RESERVOIR SEDIMENT BASIN PLAN VIEW AND CROSS SECTION	
1	Preliminary Design - DRAFT	4/24/24	DCS				
2	Various revisions	6/24/24	DCS				
3							

STEEL ENCLOSURE W/ LOCKABLE CLASP

5' x 5' x 6-IN THICK CONCRETE PAD W/ STILLING WELL

WALL EXTENSION (BEYOND)

12-IN DIA. CMP STILLING WELL W/ WATER TIGHT END CAP AT BOTTOM

6-IN BASE SAND/GRAVEL

1-1/2-INCH PVC; SET INVERT 1/2-IN BELOW FLUME FLOOR; LOCATE 3' FROM ENTRANCE

FLOOR SURFACE (BEYOND)

24 BARS @ 12" E.W.

STAFF GAGE

WALL EXTENSION (BEYOND) PLACE MONOLITHICALLY WITH STEM WALLS;

SECTION C-C

0 4 8

SCALE - FEET

Dimensions: 22', 6', 6", 10', 6", 10", 3', 10", 3', 4'-6", 4'-8"

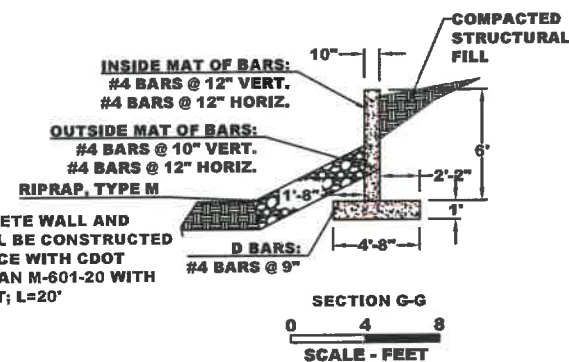
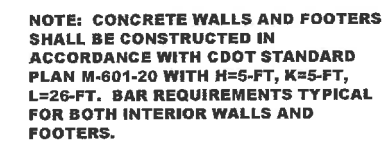

FLUME PLAN VIEW

0 4 8
SCALE - FEET

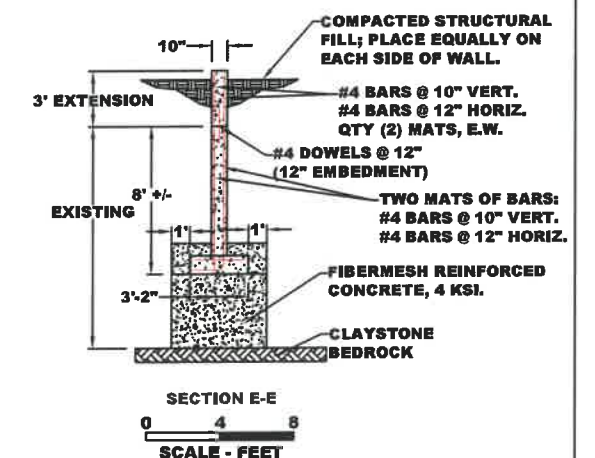
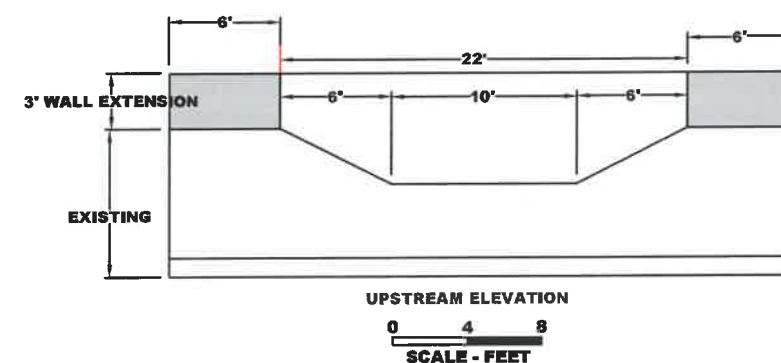
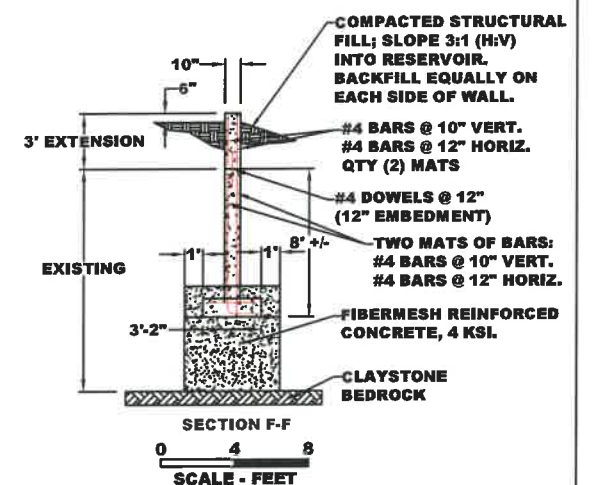
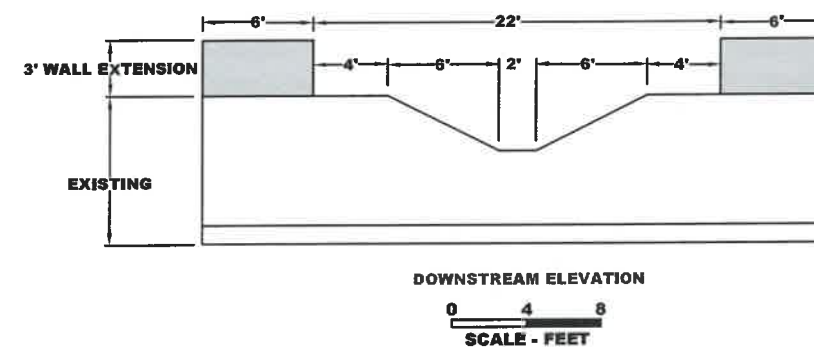

-
- A circular professional engineer seal for Douglas Chanley, Colorado. The seal contains the text "COLORADO REGISTERED PROFESSIONAL ENGINEER" around the perimeter and "DOUGLAS CHANLEY" in the center. The number "099893" is stamped below the name. A blue ink signature is written across the seal, and the date "6/26/24" is stamped in blue ink at the bottom.

REVISIONS				NOCO ENGINEERING, INC. (970) 988-1459 FAX: (970) 352-8668 8200 W. 20TH ST., STE A GREELEY, CO 80634	
NO.	DESCRIPTION	DATE	BY	DATE: 6/26/24	
1	Preliminary Design -- DRAFT	4/24/24	DCS		
2	Revised cutoff wall locations	4/25/24	DCS		
3	Increase wall height; flume capacity	6/12/24	DCS		
4	Various revisions	6/24/24	DCS		

Ogilvy Irrigating and Land Co.

SEELEY RESERVOIR
SEDIMENT BASIN
DETAILS

SHEET
3

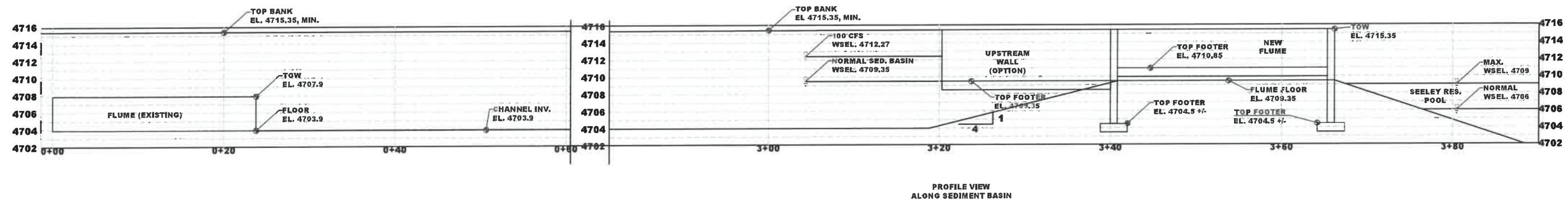
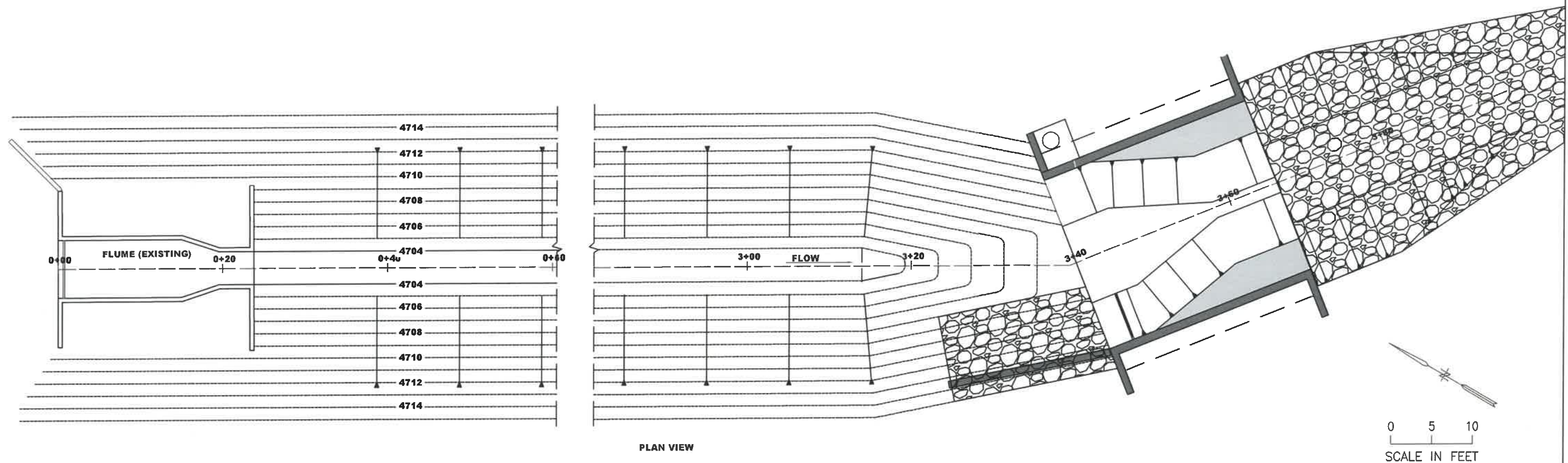

REVISIONS			
NO.	DESCRIPTION	DATE	BY
1	Various revisions	6/24/24	DCS
2			

NOCO ENGINEERING, INC.
(970) 968-1459 FAX: (970) 352-8869
8208 W. 20TH ST., STE A
GREELEY, CO 80634

DATE: 6/26/24

Ogilvy Irrigating and Land Co.

SEELEY RESERVOIR
SEDIMENT BASIN
CHANNEL PLAN AND PROFILE

SHEET
4

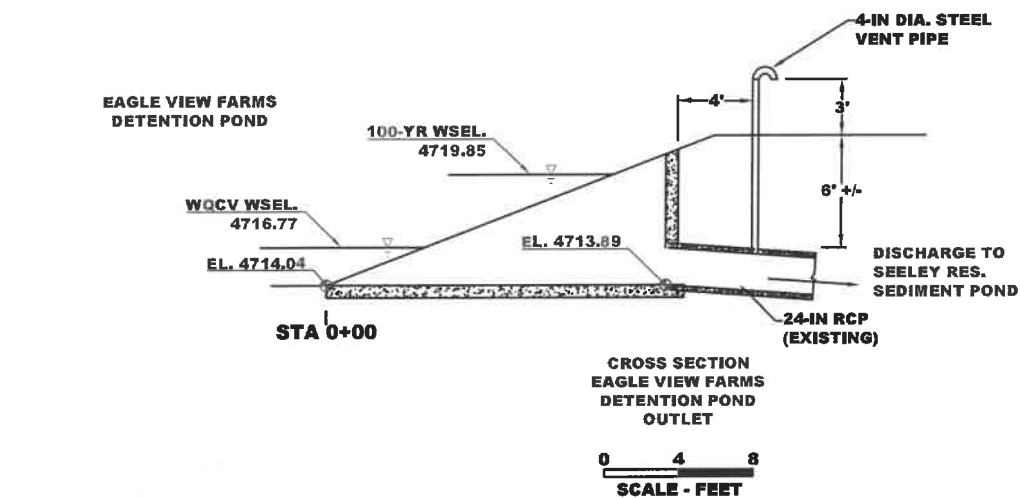

NOTES:

1. RCP SHALL BE CORE DRILLED FOR 4-IN STEEL PIPE CONNECTION USING SADDLE CONNECTOR.
2. PIPE SHALL BE PAINTED W/ CORROSION RESISTANT PAINT, BLACK COLOR.
3. BACKFILL SHALL BE COMPACTED AND FINISHED TO ORIGINAL GRADE.

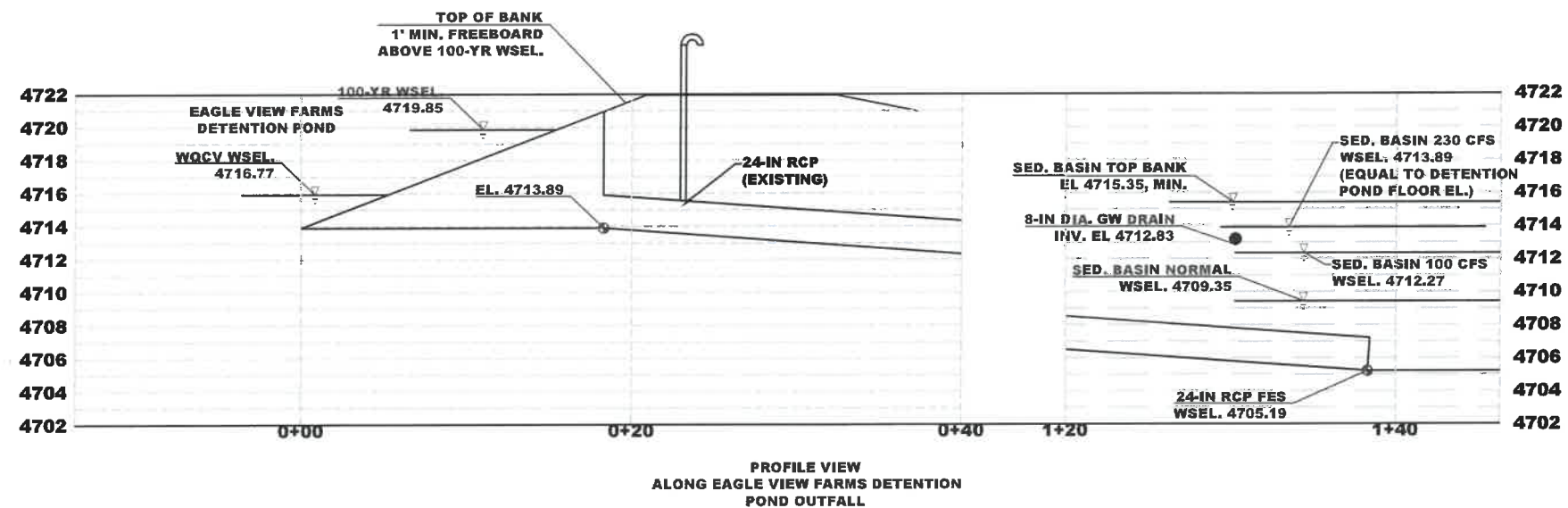

REVISIONS			
NO.	DESCRIPTION	DATE	BY
1			
2			

NOCO ENGINEERING, INC.
(970) 866-1459 FAX: (970) 362-8866
8209 W. 20TH ST., STE A
GREELEY, CO 80634

DATE: 6/25/24

Ogilvy Irrigating and Land Co.

SEELEY RESERVOIR
SEDIMENT BASIN
EAGLE VIEW FARMS DETENTION POND

SHEET
5