



STATE OF
COLORADO

Gibson - DNR, Amber <amber.gibson@state.co.us>

RE: Seeley Reservoir Stockpiles, File No. # M-2023-043, New 112c Application, Adequacy Review-1

charles keirnes <charles@keirnescompanies.com>
To: "Gibson - DNR, Amber" <amber.gibson@state.co.us>
Cc: "spencer@keirnesre.com" <spencer@keirnesre.com>

Tue, Feb 18, 2025 at 11:14 AM

Hi Amber,

We have an additional comment, which I noted during our call. Please see the attached, highlighting another area of concern related to the damn/structure.

Let me know if you have any questions. Thank you!

[Quoted text hidden]



Keirnes Comments -- Permit M2023043 Adequacy Review Additional Comments 2.18.25.pdf
1561K



Charles Keirnes
PO BOX 7
Eaton, CO, 80615
970-539-2204
Charles@keirnescompanies.com

February 18, 2025

Amber M. Gibson
Division of Reclamation, Mining and Safety
1313 Sherman Street, Room 215
Denver, CO 80203

RE: Seeley Reservoir Stockpiles, File No. M-2023-043 (Adequacy Review/Additional Application Comments)

Amber,

On behalf of the landowners of Lots' A and B of REC EXEMPT RE-5061 and Lot D of REC EXEMPT RECX15-0012, below is an additional comment/concern related to Permit # M-2023043 in relation to our noted affected properties.

1. Please see the image below, highlighting an emergency spillway that would have a detrimental impact to our property and was built in conjunction with the structure impacting our properties. I have also included via "Attachment B" the retroactively stamped plans related to this structure/area of concern noted in previous comments.



We appreciate your further consideration of our ongoing comments/questions/concerns related to the impacts this permit directly has on our subject properties. Please don't hesitate to reach out to me with any question.

Sincerely,

Charles Keirnes

Charles Keirnes

ATTACHMENT B

SEELEY RESERVOIR SEDIMENT BASIN CONSTRUCTION DRAWINGS

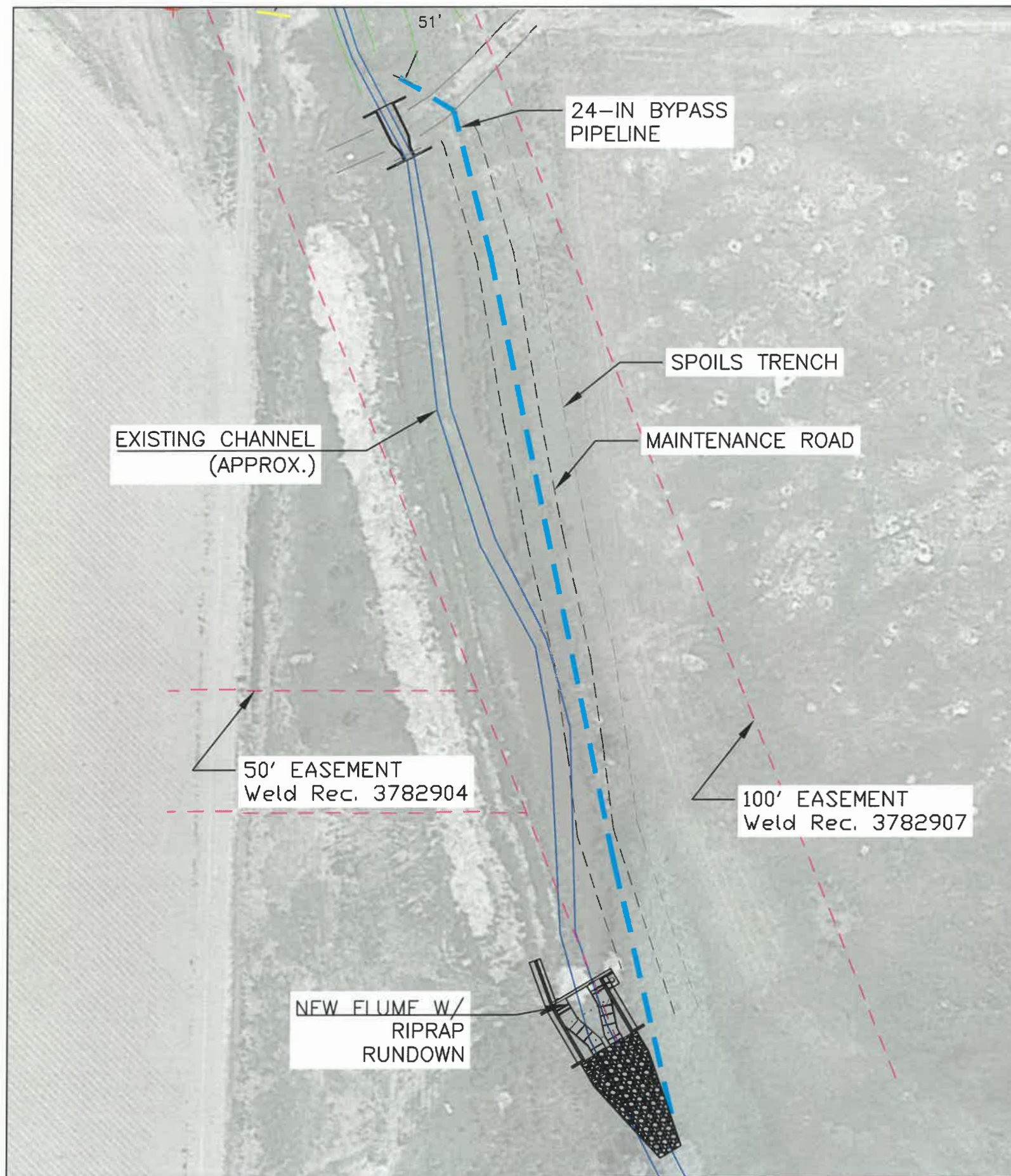

SEELEY LAKE RESERVOIR SEDIMENT BASIN PROJECT

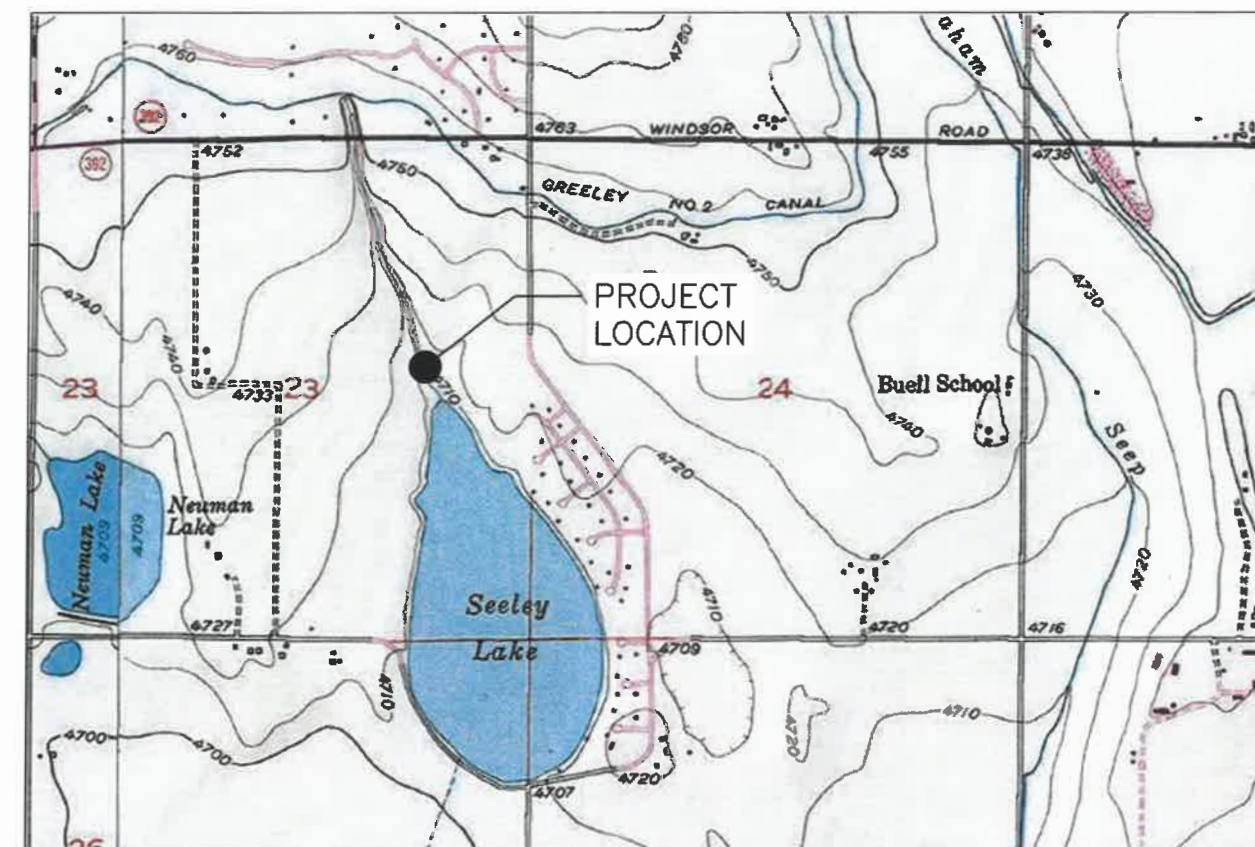

PROJECT VICINITY MAP



REVISIONS				NOCO ENGINEERING, INC. (970) 988-1459 FAX: (970) 352-8886 8309 W. 20TH ST., STE A GREELEY, CO 80634	Ogilvy Irrigating and Land Co.	SEELEY RESERVOIR SEDIMENT BASIN SITE PLAN	SHEET 1
NO.	DESCRIPTION	DATE	BY				
1	Preliminary Design - DRAFT	4/21/24	DCS				
1	Various revisions	6/28/24	DCS				
				DATE: 6/26/24			

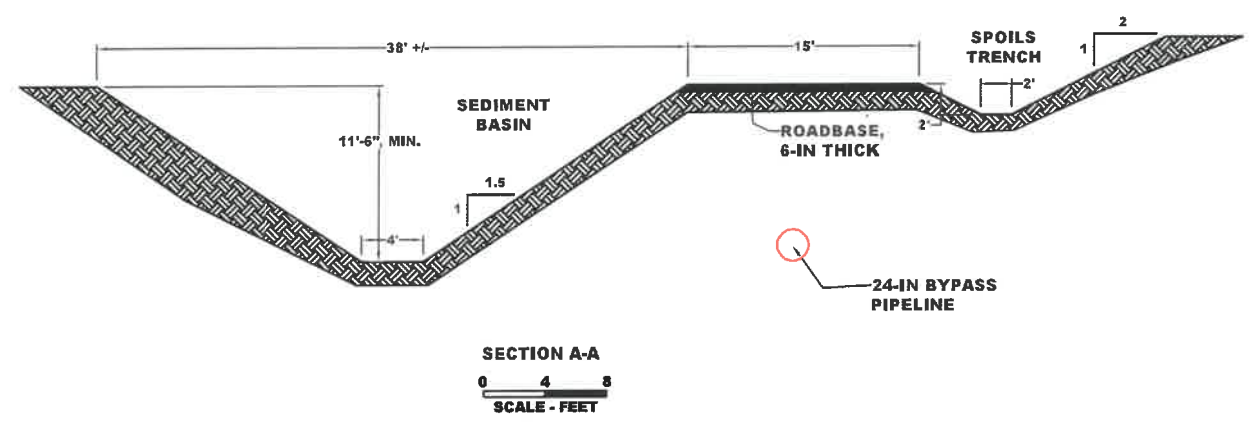
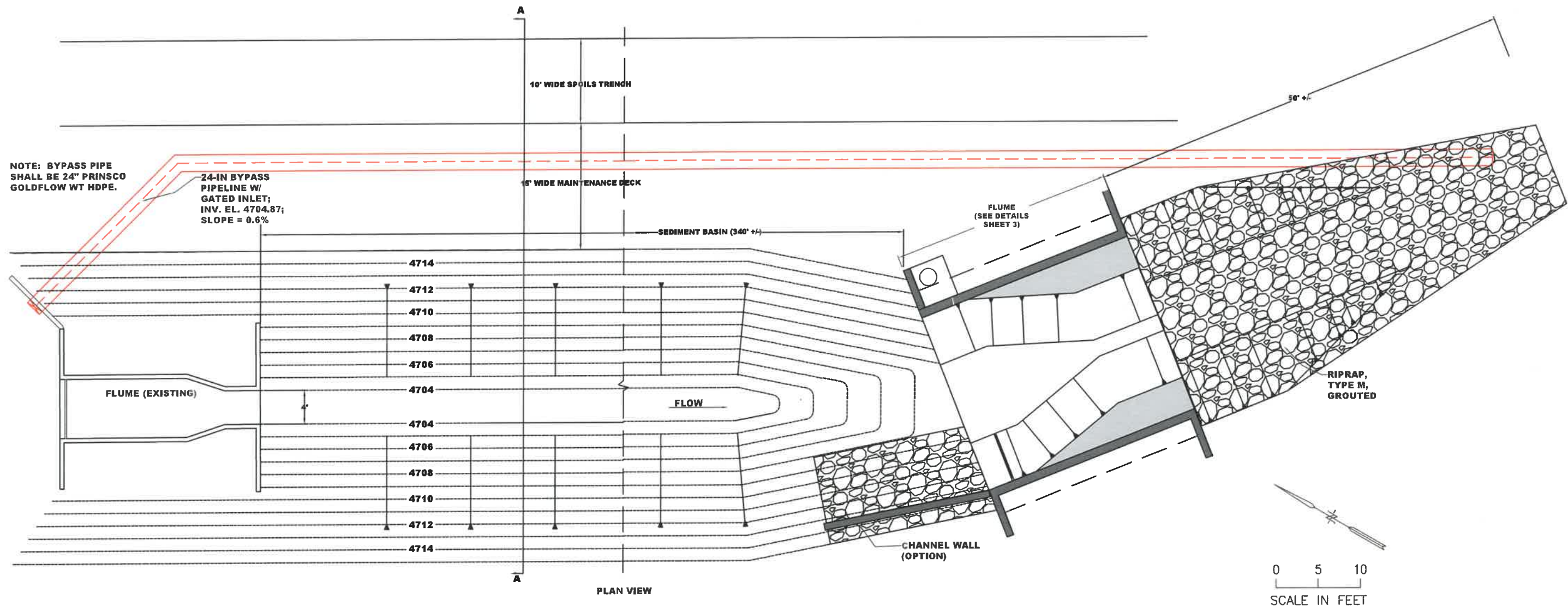

REVISIONS				NOCO ENGINEERING, INC. (970) 955-1459 FAX: (970) 352-4088 8209 W. 20TH ST., STE A GREELEY, CO 80634		Ogilvy Irrigating and Land Co.	SHEET 2
NO.	DESCRIPTION	DATE	BY				
1	Preliminary Design - DRAFT	4/24/24	DCS	DATE: 6/26/24		SEELEY RESERVOIR SEDIMENT BASIN PLAN VIEW AND CROSS SECTION	
2	Various revisions	6/24/24	DCS				
3							

STEEL ENCLOSURE W/ LOCKABLE CLASP

5' x 5' x 6-IN THICK CONCRETE PAD W/ STILLING WELL

WALL EXTENSION (BEYOND)

12-IN DIA. CMP STILLING WELL W/ WATER TIGHT END CAP AT BOTTOM

6-IN BASE SAND/GRAVEL

1-1/2-INCH PVC; SET INVERT 1/2-IN BELOW FLUME FLOOR; LOCATE 3' FROM ENTRANCE

22'

6'

6"

10'

6"

10"

FLOOR SURFACE (BEYOND)

24 BARS @ 12" E.W.

STAFF GAGE

4'-6"

WALL EXTENSION (BEYOND) PLACE MONOLITHICALLY WITH STEM WALLS;

4'-8"

SECTION C-C

0 4 8

SCALE - FEET

NOTE: CONCRETE WALLS AND FOOTERS SHALL BE CONSTRUCTED IN ACCORDANCE WITH CDOT STANDARD PLAN M-601-20 WITH H=5-FT, K=5-FT, L=26-FT. BAR REQUIREMENTS TYPICAL FOR BOTH INTERIOR WALLS AND FOOTERS.

INSIDE MAT OF BARS:
#4 BARS @ 12" VERT.
#4 BARS @ 12" HORIZ.

OUTSIDE MAT OF BARS:
#4 BARS @ 10" VERT.
#4 BARS @ 12" HORIZ.

RIPRAP, TYPE III

CONCRETE WALL AND
TO BE CONSTRUCTED
WITH CDOT
PLAN M-601-20 WITH
R: L=20'

D BARS:
#4 BARS @ 9"

SECTION G-G

SCALE - FEET

SECTION G-G

0 4 8

SCALE - FEET

3' WALL EXTENSION

EXISTING

6' 4' 6' 2' 6' 4' 6'

22'

DOWNSTREAM ELEVATION

0 4 8

SCALE - FEET

EXISTING

3' EXTENSION

COMPACTED STRUCTURAL FILL; SLOPE 3:1 (H:V) INTO RESERVOIR. BACKFILL EQUALLY ON EACH SIDE OF WALL.

#4 BARS @ 10" VERT. #4 BARS @ 12" HORIZ. QTY (2) MATS

#4 DOWELS @ 12" (12" EMBEDMENT)

TWO MATS OF BARS: #4 BARS @ 10" VERT. #4 BARS @ 12" HORIZ.

FIBERMESH REINFORCED CONCRETE, 4 KSI.

CLAYSTONE BEDROCK

SECTION F-F

0 4 8

SCALE - FEET

3' WALL EXTENSION

EXISTING

UPSTREAM ELEVATION

0 4 8
SCALE - FEET

SECTION E-E

0 4 8
SCALE - FEET

10"

3' EXTENSION

8' +/-

EXISTING

1"

1"

3'-2"

COMPACTED STRUCTURAL FILL; PLACE EQUALLY ON EACH SIDE OF WALL.

**#4 BARS @ 10" VERT.
#4 BARS @ 12" HORIZ.
QTY (2) MATS, E.W.**

**#4 DOWELS @ 12"
(12" EMBEDMENT)**

**TWO MATS OF BARS:
#4 BARS @ 10" VERT.
#4 BARS @ 12" HORIZ.**

FIBERMESH REINFORCED CONCRETE, 4 KSI.

CLAYSTONE BEDROCK

NOTES AND SPECIFICATIONS:

- 1. ALL REINFORCING STEEL SHALL BE GRADE 60.**
- 2. STRUCTURAL CONCRETE SHALL HAVE A COMPRESSIVE STRENGTH OF 4,500 PSI.**
- 3. REINFORCING BARS IN BOTTOM MAT OF FOOTERS AND FLOOR SHALL HAVE 3-IN COVER; ALL OTHER BARS SHALL HAVE 2-IN COVER.**
- 4. EXPOSED CORNERS SHALL HAVE 3/4-IN CHAMFER.**
- 5. INTERIOR STEM WALLS SHALL HAVE #4 BARS DOWELED INTO EXTERIOR WALLS AT 6-IN SPACING.**
- 6. THE 3' WALL EXTENSION SHALL BE PLACED MONOLITHICALLY.**
- 7. SPLICE LENGTH FOR #4 BARS SHALL BE 1'-6".**
- 8. STAFF GAGE SHALL FABRICATED WITH A SCALE ADJUSTED FOR 2:1 (H:V) SLOPE.**
- 9. OVER-EXCAVATE 1-FT MIN. BELOW STRUCTURE TO REMOVE ORGANIC AND SILT MATERIAL; BACKFILL AND COMPACT WITH GRANULAR FILL OR, ALTERNATIVELY, PLACE CONCRETE (MIN. 3,000 PSI).**
- 10. STRUCTURAL FILL SHALL BE COMPACTED AND RE-GRADED TO DRAIN PLACE FILL IN 8-IN MAX. LIFTS, EQUAL HEIGHT SHALL BE MAINTAINED ON BOTH SIDES OF THE FLUME HEADWALLS DURING BACKFILL.**
- 11. STRUCTURAL FILL SHALL BE COMPACTED TO 95% STANDARD PROCTOR AND 2% OPTIMUM MOISTURE CONTENT.**
- 12. ALL DISTURBED AREAS TO BE RE-SEED.**

FLUME PLAN VIEW

0 4 8

SCALE - FEET



REVISIONS				NOCO ENGINEERING, INC. (970) 988-1459 FAX: (970) 352-8666 8200 W. 20TH ST., STE A GREELEY, CO 80634	
NO.	DESCRIPTION	DATE	BY	DATE: 6/26/24	
1	Preliminary Design -- DRAFT	4/24/24	DCS		
2	Revised cutoff wall locations	4/25/24	DCS		
3	Increase wall height; flume capacity	6/12/24	DCS		
4	Various revisions	6/24/24	DCS		

Ogilvy Irrigating and Land Co.

SEELEY RESERVOIR
SEDIMENT BASIN
DETAILS

SHEET
3

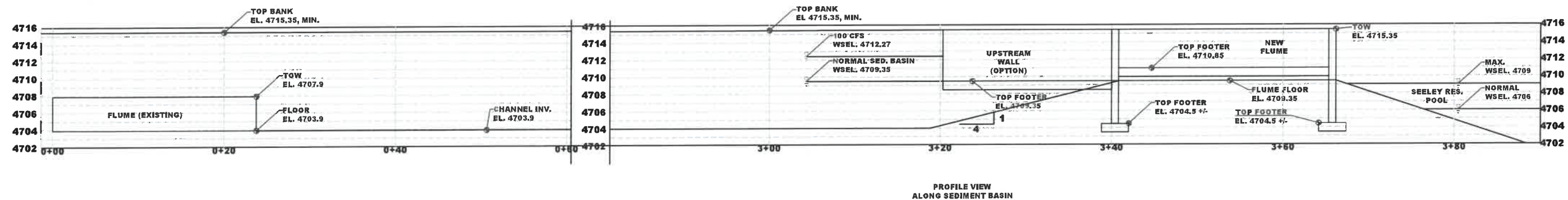
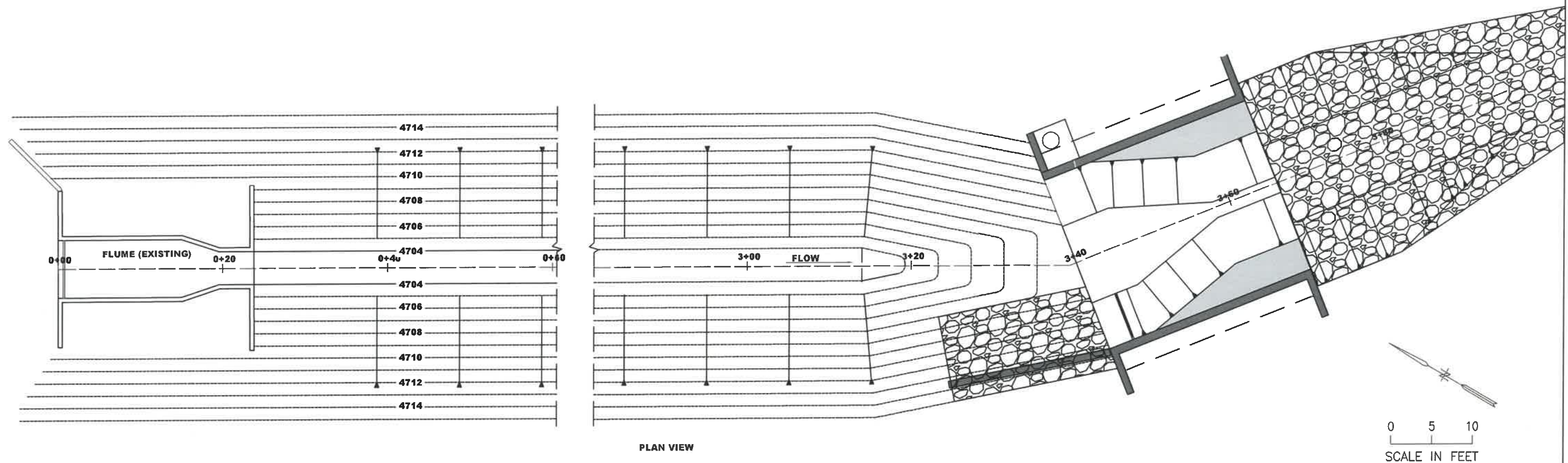

REVISIONS			
NO.	DESCRIPTION	DATE	BY
1	Various revisions	6/24/24	DCS
2			

NOCO ENGINEERING, INC.
(970) 968-1459 FAX: (970) 352-8869
8208 W. 20TH ST., STE A
GREELEY, CO 80634

DATE: 6/26/24

Ogilvy Irrigating and Land Co.

SEELEY RESERVOIR
SEDIMENT BASIN
CHANNEL PLAN AND PROFILE

SHEET
4

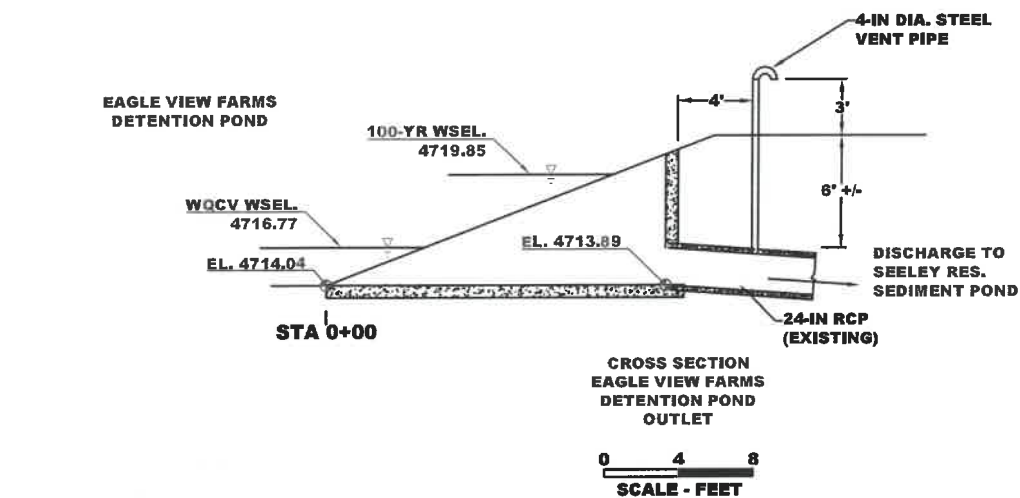

NOTES:

1. RCP SHALL BE CORE DRILLED FOR 4-IN STEEL PIPE CONNECTION USING SADDLE CONNECTOR.
2. PIPE SHALL BE PAINTED W/ CORROSION RESISTANT PAINT, BLACK COLOR.
3. BACKFILL SHALL BE COMPACTED AND FINISHED TO ORIGINAL GRADE.

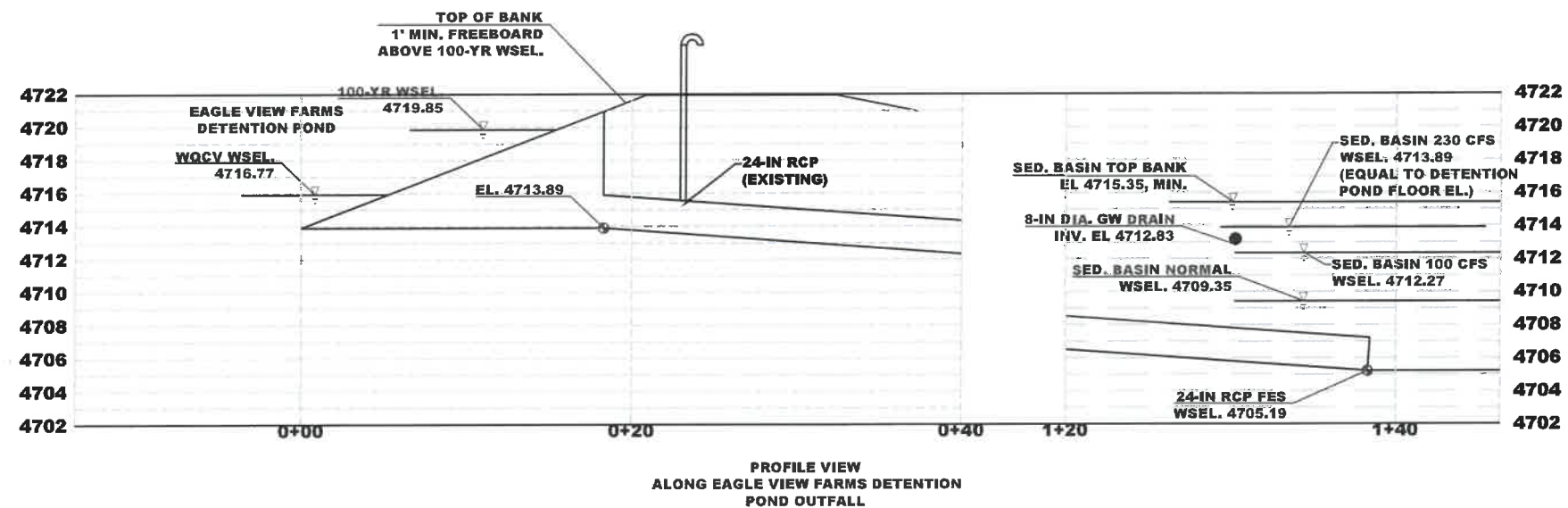

REVISIONS			
NO.	DESCRIPTION	DATE	BY
1			
2			

NOCO ENGINEERING, INC.
(970) 866-1459 FAX: (970) 362-8866
8209 W. 20TH ST., STE A
GREELEY, CO 80634

DATE: 6/25/24

Ogilvy Irrigating and Land Co.

SEELEY RESERVOIR
SEDIMENT BASIN
EAGLE VIEW FARMS DETENTION POND

SHEET
5



STATE OF
COLORADO

Gibson - DNR, Amber <amber.gibson@state.co.us>

RE: Seeley Reservoir Stockpiles, File No. # M-2023-043, New 112c Application, Adequacy Review-1

Gibson - DNR, Amber <amber.gibson@state.co.us>
To: charles keirnes <charles@keirnescompanies.com>

Wed, Feb 19, 2025 at 9:26 AM

Hi Charles,

I received your comment/objection, and am both sending a copy to the Applicant and uploading it to the permit file.

Thank you,

Amber Michels Gibson
Environmental Protection Specialist I



COLORADO
Division of Reclamation,
Mining and Safety
Department of Natural Resources

P 720.836.0967 | F 303.832.8106 |
amber.gibson@state.co.us

Mailing: DRMS Room 215, 1001 E 62nd Ave, Denver, CO 80216
Physical: 1313 Sherman Street, Room 215, Denver, CO 80203

<https://drms.colorado.gov/>

[Quoted text hidden]