

MORGAN SAND AND GRAVEL, INC.
21215 HWY. 52
FORT MORGAN, CO 80701
970-867-8074
PLANT 3 MILES NORTH OF FORT MORGAN ON HIGHWAY 52

December 19, 2024

Division Reclamation, Mining & Safety
1313 Sherman Street, Room 215
Denver, CO. 80203

Morgan Sand & Gravel
Permit # 1977 094
E Permit # 190639
Fort Morgan, CO. 80701
Morgan County

Annual Report

Morgan Sand & Gravel stripped off the South side of phase 4 the North side of phase 5. Top soil was placed in the Top Soil area , not much overburden was used to level the draw up so we could move to the North side of phase 5.

All of the Class 6 base and Class 7 was stocked piled in the original pit South of phase 1. The Crusher is now set up in phase 4 area. We are crushing Rock so not many stock piles we are hauling rock to office and different jobs. The sand is in a stock pile in the original pit.

If the Spring weather is wet going to reseed around 4-5 Acres Have enough top soil and overburden to level .

The Green lines on map show what we have mined out to this year.

Respectfully, Morgan Sand & Gravel

Greg Westhoff
Owner
970-867-8074 Office
970-768-0781 Cell

morgansandandgravel@kci.net

Pre-mine/Mine PlanMap, Phases 1-6

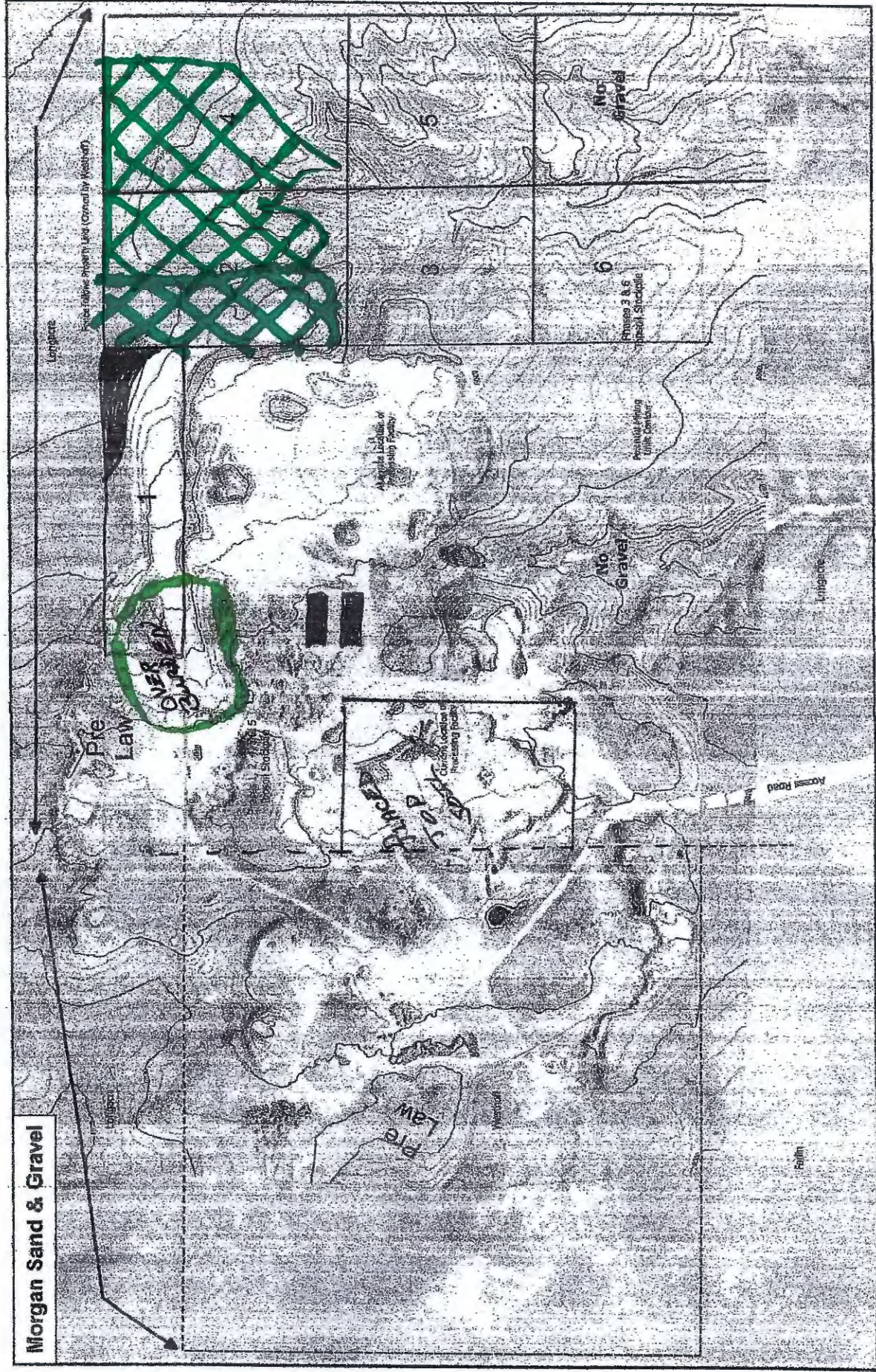

Legend

- 5 Foot Contours (Original)
- 20 Ft Contours (Original)
- Water
- Permit Boundary
- Phase Boundary
- Property Line

20 April 2017
 Prepared by: Robert L. Dunsen