

BYRON & LALANI WEATHERS

WEATHERS MINE #1 Permit # M-1999-089

ANNUAL REPORT - 2024

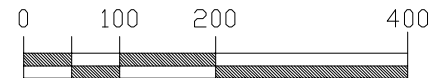
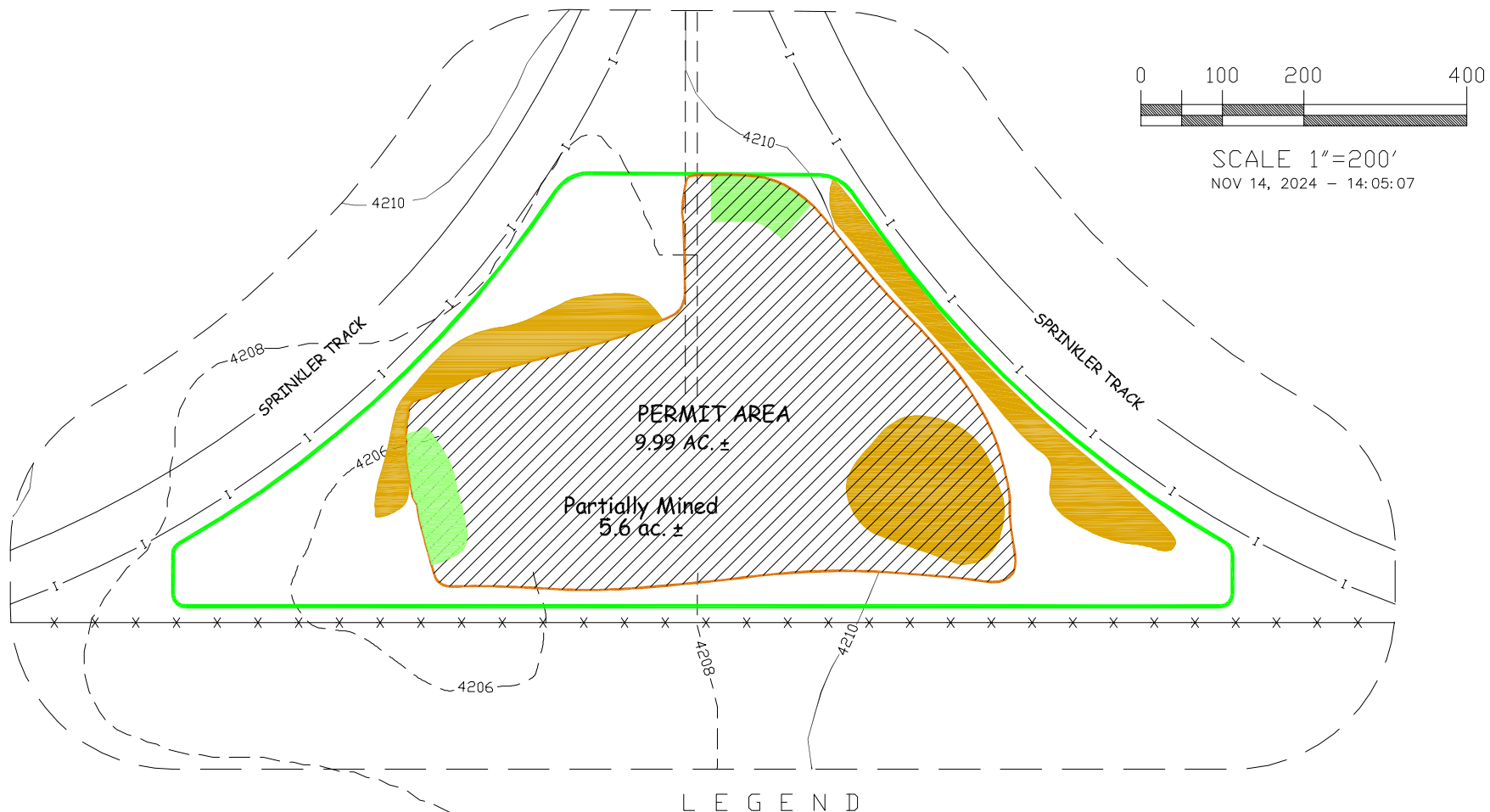

SCALE 1"=200'

NOV 14, 2024 - 14:05:07

LEGEND

- AFFECTED LANDS/PERMIT AREA
- 200 FOOT LINE
- - - EDGE OF IRRIGATED FIELD
- == == ROAD
- x - x FENCE



TOPSOIL/OVERBURDEN PILE



3:1 SLOPE AREA - 270 FEET



STRIPPED & PARTIALLY MINED
AND STOCKPILE AREA

PART OF THE SW/4NE/4 AND SE/4NW/4 SECTION 9,
TOWNSHIP 1 SOUTH, RANGE 48 WEST, 6th P.M.,
YUMA COUNTY, COLORADO

PREPARED BY: *ENVIRONMENT, INC.*
7905 VANCE DR., # 205A
ARVADA, CO 80003
(303) 423-7297

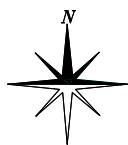

DATE	REVISION	BY