

Report Year: 2023

Approved seed mix: 2014 BLM custom seed mix for pre-2007 Shell sites.

Status of pad and road for DRMS and BLM Annual Reports:

The single installed borehole P&A'd 12/2003. Pit closed, pad and access road re-contoured and seeded 03/2004 (phase 2 interim reclamation). Remainder of Pad seeded in 2010 (final reclamation phase). Weed control conducted annually 2012 through 2023. Noxious weed monitoring conducted each year. Ongoing spot seeding. Reduction in wild horses in the area.

2023 Weed Control Observations: Annuals and minor Downy Brome

Treatment: Escort XP @ 1.5 oz/acre, Cornbelt LV6-2,4-D @ 24 oz./acre 1# A.I./acre), Vista @ 1.1 oz/acre, Round Up Pro Max @ 1.0 oz/acre 1# A.I./acre, Sun Wet @ 2 at/100 gal, Hi-lite Dye @ 24 oz./100 gal.. (A.I. = Active Ingredients.)

Treatment Method and Date: Handgun 05/20/23, 07/14/23 & 09/21/23

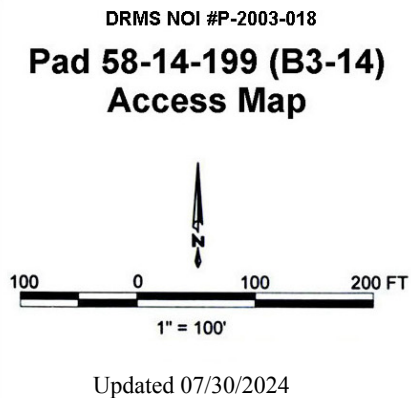
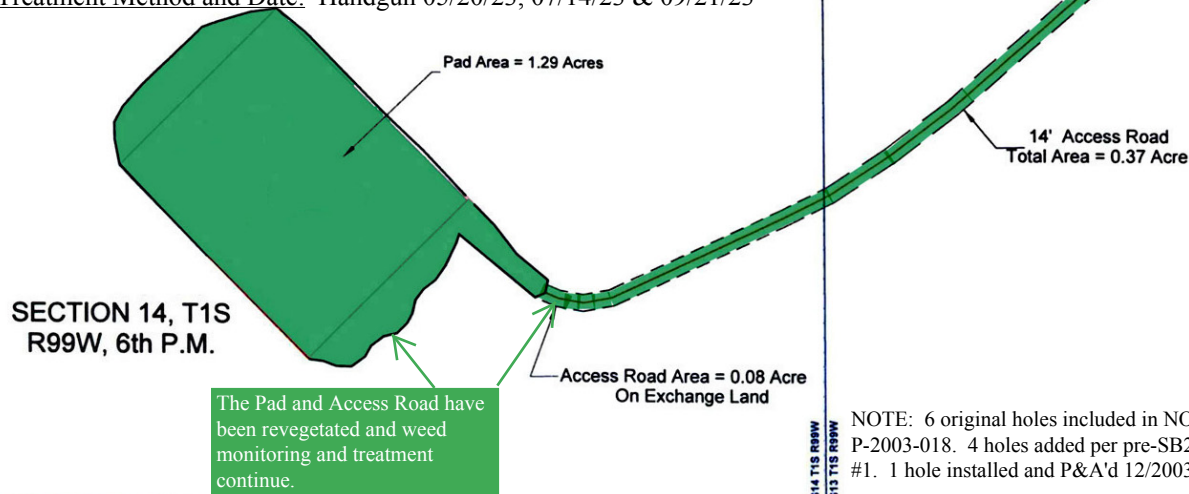

NOTE: 6 original holes included in NOI # P-2003-018. 4 holes added per pre-SB228 Mod #1. 1 hole installed and P&A'd 12/2003.

Report Year: 2023

Approved seed mix: 2014 BLM custom seed mix for pre-2007 Shell sites.

Status of pad and road for DRMS and BLM Annual Reports:

The single installed borehole P&A'd 12/2003. Pit closed, pad and access road recontoured and seeded 03/2004 (phase 2 interim reclamation). Remainder of Pad seeded in 2010 (final reclamation phase). Weed control conducted annually 2012 through 2023.

Noxious weed monitoring conducted each year.

2023 Weed Control Observations:
Annuals and Downy Brome

Treatment: Escort XP @ 1.5 oz/acre, Cornbelt LV6-2,4-D @ 24 oz./acre 1# A.I./acre), Vista @ 1.1 oz/acre, Round Up Pro Max @ 1.0 oz/acre 1# A.I./acre, Sun Wet @ 2 at/100 gal, Hi-lite Dye @ 24 oz./100 gal.. (A.I. = Active Ingredients.)

Treatment Method and Date:
Handgun 05/20/23, 07/14/23 & 09/21/23

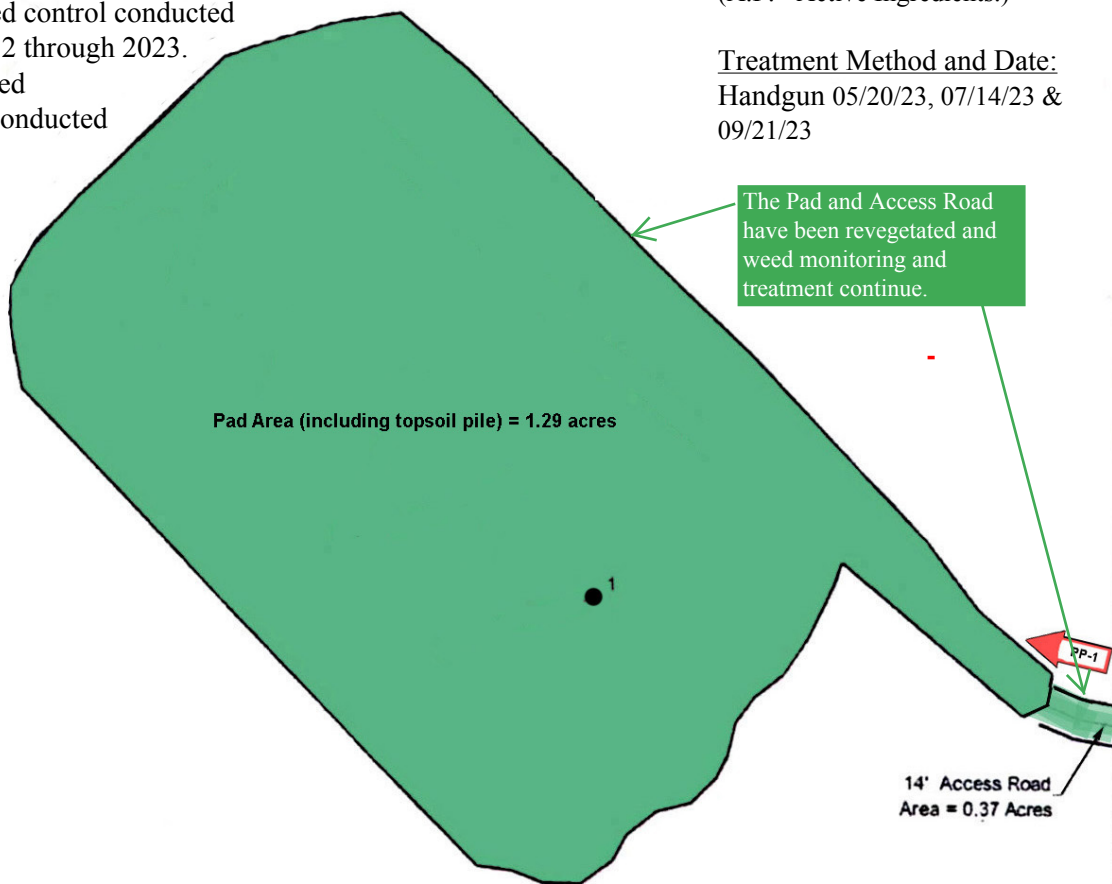

DRMS NOI #P-2003-018

**Pad 58-14-199 Site Map
(prev. Pad B3-14)**

Permanent Photo Point 

NOTE: 6 original holes included in NOI # P-2003-018. 4 holes added per pre-SB228 Mod #1. 1 hole installed and P&A'd 12/2003.

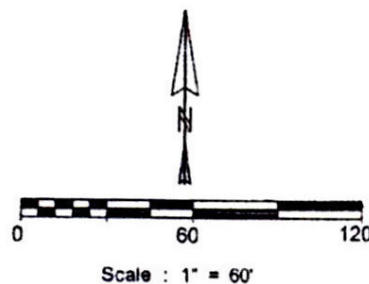

County : Rio Blanco County

Township : 1S Range : 99W P.M. : 6th

Section : 14 Quarter : SENE

Chuck Whiteman & Associates

320 3rd Street, P.O. Box 957
Meeker Colorado

Shell Frontier Oil & Gas Inc.

Sheet : ___ of ___ Date : 06 - 15 - 2006
Job No. : 001-06 Updated 07/30/2024

MRP-Wide Reclamation Plan - Map 121d
P-2003-018 Annual Report - Map 05b
COC65458 Annual Report - Map 03b

Report Year: 2020

Approved seed mix: 2014 BLM custom seed mix for pre-2007
Shell sites.

Status of pad and road for DRMS and BLM Annual Reports:

The 8 installed boreholes P&A'd 09/2007, 05/2008, 05/2009, and 10/2014. Soil stockpile seeded 03/2004. Pad downsized 06/2009 and seeded 10/2009 (phase 2 interim reclamation). Pit closed. Remainder of Pad seeded in 2010 (final reclamation phase). Weed control conducted annually 2012 through 2020. 2020- DRMS & BLM released the pad per regulation standards.

2020 Weed Control Observations:

Treatment:

Treatment Method and Date: Handgun 05/22/2020

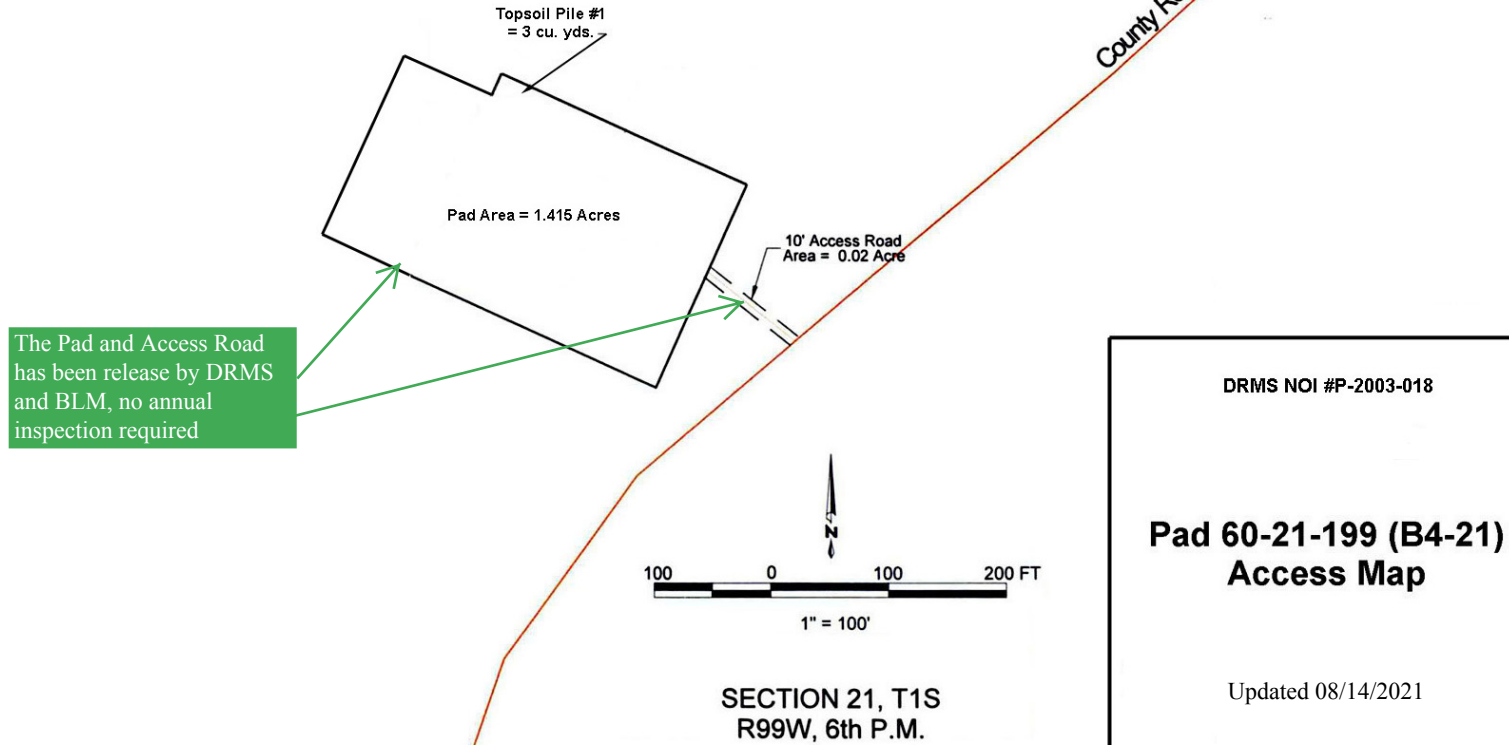

Report Year: 2020

2020 Weed Control Observations:

Approved seed mix: 2014 BLM custom seed mix for pre-2007 Shell sites.

Treatment:

Treatment Method and Date:

Status of pad and road for DRMS and BLM Annual Reports: The 8 installed boreholes P&A'd 09/2007, 05/2008, 05/2009, and 10/2014. Soil stockpile seeded 03/2004. Pad downsized 06/2009 and seeded 10/2009 (phase 2 interim reclamation). Pit closed. Remainder of Pad seeded in 2010 (final reclamation phase). Weed control conducted annually 2012 through 2020. 2020- DRMS & BLM released the pad per regulation standards.

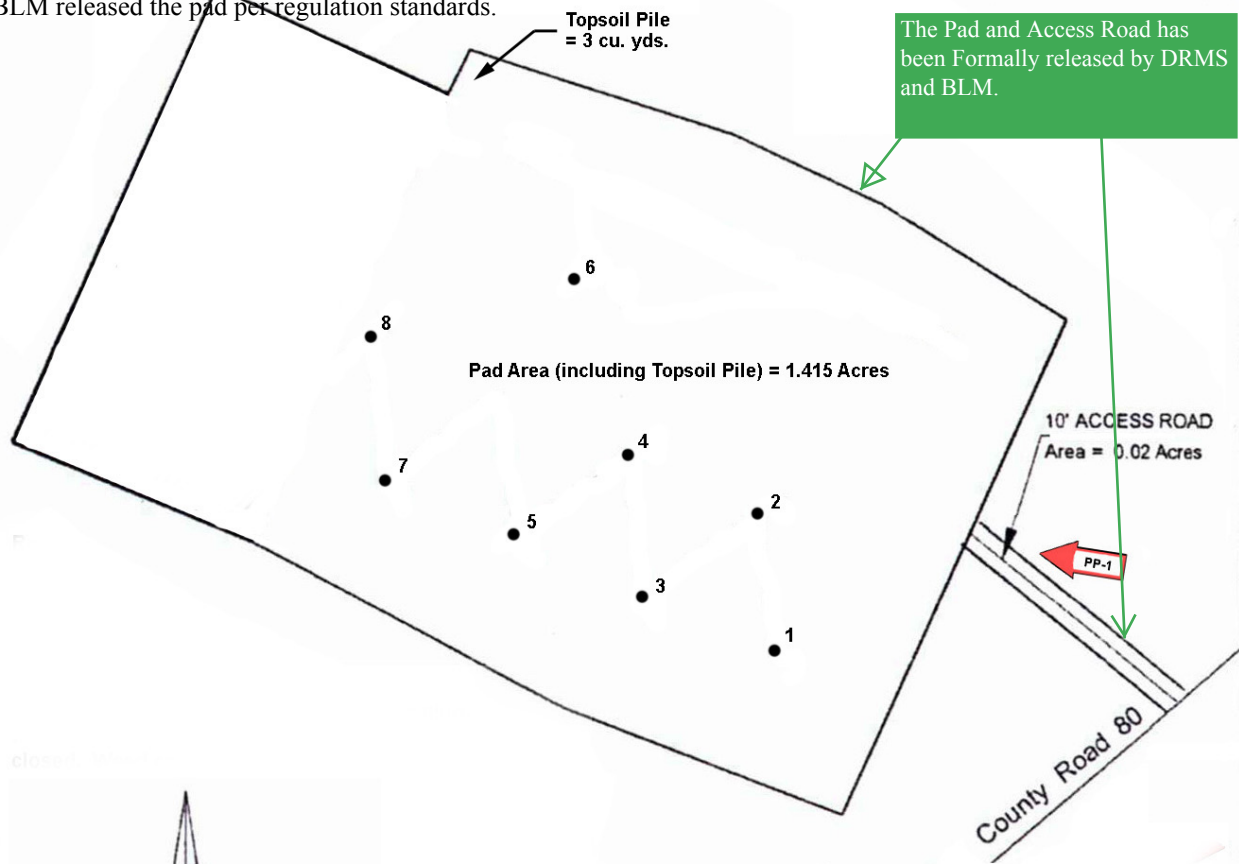

Scale : 1" = 60'

SECTION 21, T1S
R99W, 6th P.M.

NOTE: 6 original holes included in P-2003-015. 4 additional holes included in P-2003-018, mod. #1 (includes expanded pad area).

DRMS NOI #P-2003-018

**Pad 60-21-199 Site Map
(prev. Pad B4-21)**

Permanent Photo Point **PP-1**

County : Rio Blanco County

Township : 1S Range : 99W P.M. : 6th

Section : 21 Quarter : SWSW

Chuck Whiteman & Associates
320 3rd Street, P.O. Box 957
Meeker Colorado

Shell Frontier Oil & Gas Inc.

Sheet : ___ of ___ Date : 06 - 15 - 2006
Job No. : 001-06 Updated 07/30/2022

MRP-Wide Reclamation Plan - Map 122d
P-2003-015 Annual Report - Map 03b
P-2003-018 Annual Report - Map 06b
COC65458 Annual Report - Map 04b

DRMS NOI #P-2003-018

Pad 61-22-199 (B5-22) Access Map

DRMS NOI #P-2003-015 (orig. 6 holes)
DRMS NOI #P-2003-018 (4 addit. holes)

Updated 08/14/2022

SECTION 22, T1S
R99W, 6th P.M.

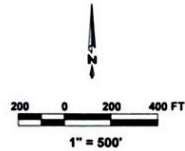

The Pad and Access Road have been released by DRMS and BLM.

Pad Area = 1.01 Acres

Topsoil Pile #2
= 138 cu. yds.

Topsoil Pile #1
= 52 cu. yds.

12' Access Road
Area = 0.18 Acre

12 Bladed Road
Area = 1.93 Acres

Report Year: 2020

Approved seed mix: 2014 BLM custom seed mix for pre-2007 Shell sites.

Status of pad and road for DRMS and BLM Annual Reports: The single installed borehole P&A'd 12/2007. Pit closed, pad and access road recontoured and seeded in 2004 (phase 2 interim reclamation). Site rebuilt in anticipation of drilling MZ well. Did not drill. Site and pad again recontoured and seeded along with access road 09/2008. Remainder of Pad seeded in 2010 (final reclamation phase). Weed control conducted annually 2012 through 2020. DRMS/BLM approved final reclamation release of pad in 2020

2021 Weed Control Observations: NA

Treatment: NA

Treatment Method and Date: NA



MRP-Wide Reclamation Plan - Map 123a
P-2003-015 Annual Report - Map 04a
P-2003-018 Annual Report - Map 07a
COC65458 Annual Report - Map 05a

SECTION 22, T1S
R99W, 6th P.M.

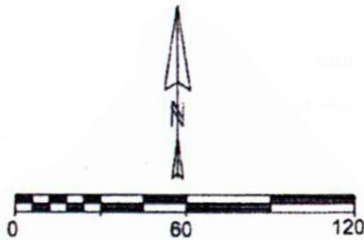

Topsoil Pile #2
= 138 cu. yds.

Pad Area (including Topsoil Pile) = 1.01 Acres

L1 (P&A'd)

Topsoil Pile #1
= 52 cu. yds.

The Pad and Access Road
have been released by
DRMS and BLM

12' ACCESS ROAD
Area = 0.18 Acres

2020 Weed Control Observations:

Treatment:

Treatment Method and Date:

NOTE - 6 original holes included in
NOI #P-2003-015. 4 additional holes
permitted in P-2003-018, Mod. #1.
Only 1 hole installed and P&A'd.

DRMS NOI #P-2003-018

**Pad 61-22-199 Site Map
(prev. Pad B5-22)**

Permanent Photo Point **PP-1**

County : Rio Blanco County

Township : 1S Range : 99W P.M. : 6th

Section : 22 Quarter : SWSE

Chuck Whiteman & Associates

320 3rd Street, P.O. Box 957
Meeker Colorado

Shell Frontier Oil & Gas Inc.

Sheet : of Date : 06 - 15 - 2008
Job No. : 001-06 Updated 08/14/2022

MRP-Wide Reclamation Plan - Map 123d
P-2003-015 Annual Report - Map 04b
P-2003-018 Annual Report - Map 07b
COC65458 Annual Report - Map 05b

DRMS NOI #P-2003-018

Pad 62-23-199 (B6-23) Access Map

DRMS NOI #P-2003-015 (orig. 6 holes)
DRMS NOI #P-2003-018 (4 addit. holes)

Updated 08/14/2022

SECTION 23, T1S
R99W, 6th P.M.

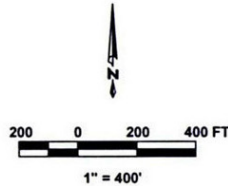

County Road 24X

S13 T1S R99W
S23 T1S R99W

S14 T1S R99W
S24 T1S R99W

2023 Weed Control Observations: Annuals and Downy Brome (fall/spg treatments)

Treatment: Escort XP @ 1.5 oz./acre, Cornbelt LV6-2,4-D @ 24 oz./acre 1# A.I./acre, Vista @ 1.1 oz./acre, Round Up Pro Max @ 1.0 oz./acre 1# A.I./acre, Sun Wet @ 2 at/100 gal, Hi-lite Dye @ 24 oz./100 gal.. (A.I. = Active Ingredients.)

Treatment Method and Date: Handgun 05/20/23, 07/14/23 & 09/21/23

The Pad and Access Road has been revegetated and weed monitoring and treatment continue.

Topsoil pile #1 = 22 cu. yds.
Topsoil pile #2 = 11 cu. yds.
Topsoil pile #3
Access Road Area = 0.13 Acres On Exchange Land
Pad Area = 1.00 Acre

11' Access Road
Total Area = 1.12 Acres

Access Road Area = 0.99 Acre
On Public Land

Report Year: 2023

Approved seed mix:
2014 BLM custom seed mix for pre-2007 Shell sites.

Status of pad and road for DRMS and BLM Annual Reports: The 3 installed boreholes P&A'd 06/2008 and 10/2014. Soils stockpiled seeded 03/2004, pit closed 09/2008. Pad downsized and seeded 09/2009 (phase 2 interim reclamation). Remainder of Pad seeded in 2010 (final reclamation phase). Weed control conducted annually 2012 through 2023. Noxious weed monitoring conducted each year.

Report Year: 2023

Approved seed mix: 2014 BLM custom seed mix for pre-2007 Shell sites.

Status of pad and road for DRMS and BLM Annual Reports:

The 3 installed boreholes P&A'd 06/2008 and 10/2014. Soils stockpiled seeded 03/2004, pit closed 09/2008. Pad downsized and seeded 09/2009 (phase 2 interim reclamation). Remainder of Pad seeded in 2010 (final reclamation phase). Weed control conducted annually 2012 through 2023. Noxious weed monitoring conducted each year.

2023 Weed Control Observations:

Annuals and Downy Brome treatments

Treatment: Escort XP @ 1.5 oz/acre, Cornbelt LV6-2,4-D @ 24 oz./acre 1# A.I./acre), Vista @ 1.1 oz/acre, Round Up Pro Max @ 1.0 oz/acre 1# A.I/acre, Sun Wet @ 2 at/100 gal, Hi-lite Dye @ 24 oz./100 gal.. (A.I. = Active Ingredients.)

Treatment Method and Date: Handgun 05/17/23, 07/14/23 & 09/21/23

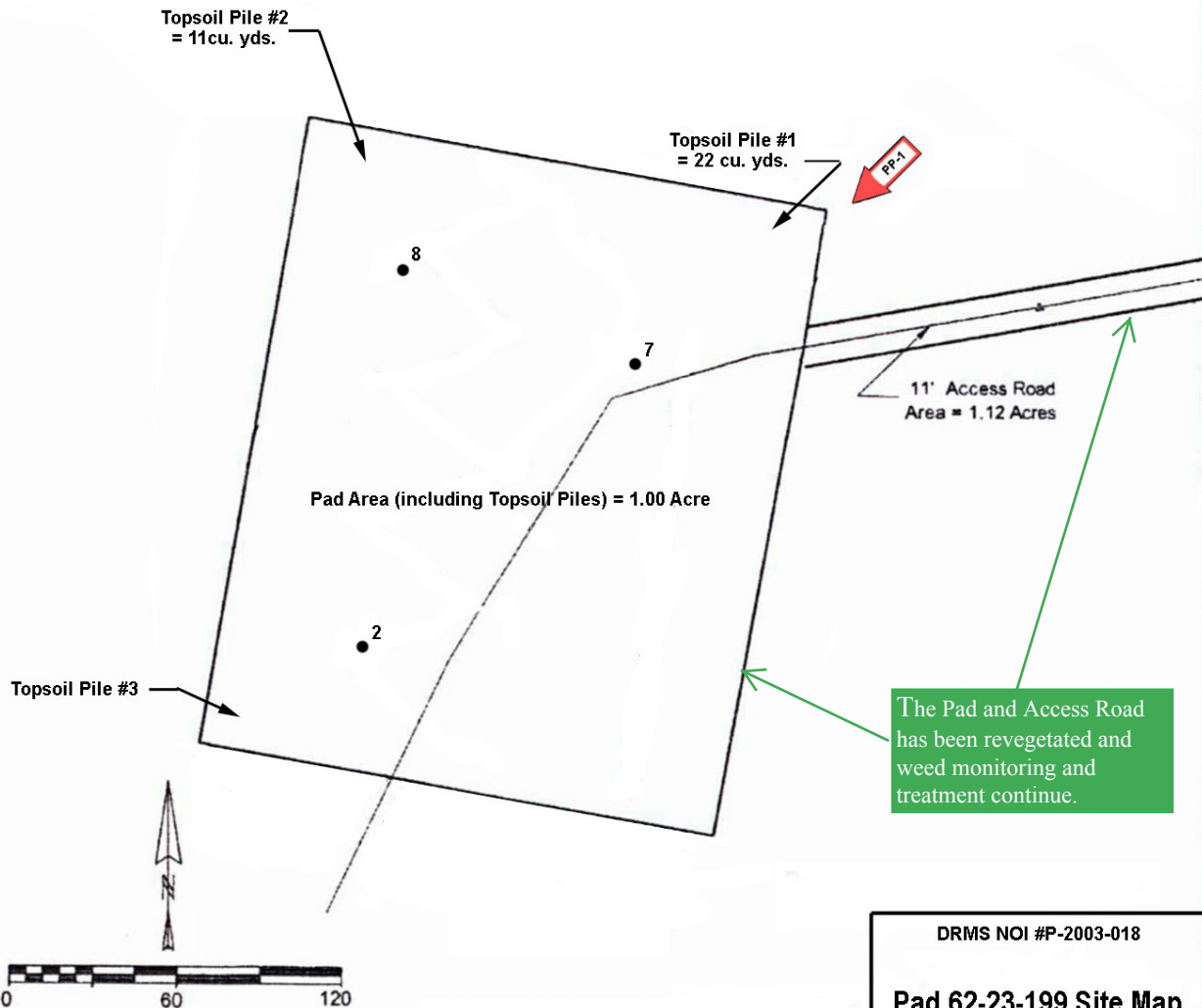

Scale : 1" = 60'

SECTION 23, T1S
R99W, 6th P.M.

NOTE: 6 original holes included in DRMS P-2003-015. 4 additional holes included in P-2003-018 mod #1. 3 holes installed, all holes P&A'd.

DRMS NOI #P-2003-018

**Pad 62-23-199 Site Map
(prev. Pad B6-23)**

Permanent Photo Point **PP-1**

County : Rio Blanco County

Township : 1S Range : 99W P.M. : 6th

Section : 23 Quarter : SENE

Chuck Whiteman & Associates
320 3rd Street, P.O. Box 957
Meeker Colorado

Shell Frontier Oil & Gas Inc.

Sheet : ___ of ___ Date : 06 - 15 - 2006
Job No. : 001-06 Updated 08/14/2024

MRP-Wide Reclamation Plan - Map 124d
P-2003-015 Annual Report - Map 05b
P-2003-018 Annual Report - Map 08b
COC65458 Annual Report - Map 06b

Report Year: 2020 - RELEASED

Approved seed mix:

2014 BLM custom seed mix for pre-2007 Shell sites.

Status of pad and road for DRMS and BLM Annual Reports:

The 5 installed boreholes P&A'd 06/2008 and 10/2010. Pit closed, Pad downsized (07/2009) and seeded 10/2009 (phase 2 interim reclamation). Access road and portions of Pad, redisturbed during 2010 P&A work, were regraded, soil Material was replaced, and the site was seeded in Fall 2010. Remainder of Pad seeded in 2010 (final reclamation phase). Weed control conducted annually 2012 through 2020. DRMS/BLM approved final reclamation release of pad in 2020

2020 Weed Control Observations:

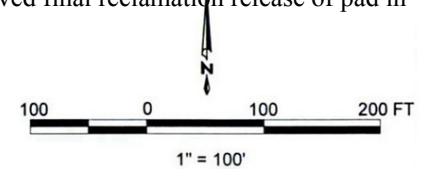

SECTION 28, T1S
R99W, 6th P.M.

Exchange Land (BLM)

Non-Exchange Land (also BLM)

Treatment:

Treatment Method and Date: Handgun
05/22/2020

NOTE - 6 original holes permitted in P-2003-018. 4 holes added per pre-SB228 Mod. #1. Portion of access road permitted in NOI #P-2003-015.

DRMS NOI #P-2003-018

**PAD 64-28-199 (B7-28)
Access Map**

DRMS NOI #P-2003-015 (exchange portion of road)
DRMS NOI #P-2003-018 (pad & non-exchange rd.)

Updated 08/14/2020

TO CR 80

TO CORRAL GULCH
FACILITY

Access Road Area = 0.13 Acre
On Exchange Land
(NOI #P-2003-015)

12' Access Road
Total Area=0.20 Acre

Access Road Area = 0.07 Acre
On Public Land

DRMS/BLM approved
final reclamation release
of pad in 2020

Topsoil pile #2
= 20 cu. yds.

Topsoil pile #1
= 4 cu. yds.

Pad Area = 1.03 Acres

Report Year: 2020

2020 Weed Control Observations:

Approved seed mix: 2014 BLM custom seed mix for pre-2007 Shell sites.

Treatment:

Status of pad and road for DRMS and BLM Annual Reports:

Treatment Method and Date: Handgun

The 5 installed boreholes P&A'd 06/2008 and 10/2010. Pit closed, Pad downsized (07/2009) and seeded 10/2009 (phase 2 interim reclamation). Access road and portions of Pad, redisturbed during 2010 P&A work, were regraded, soil material was replaced, and the site was seeded in Fall 2010 (final reclamation phase). Weed control conducted annually 2012 through 2020. DRMS/BLM approved final reclamation release of pad in 2020

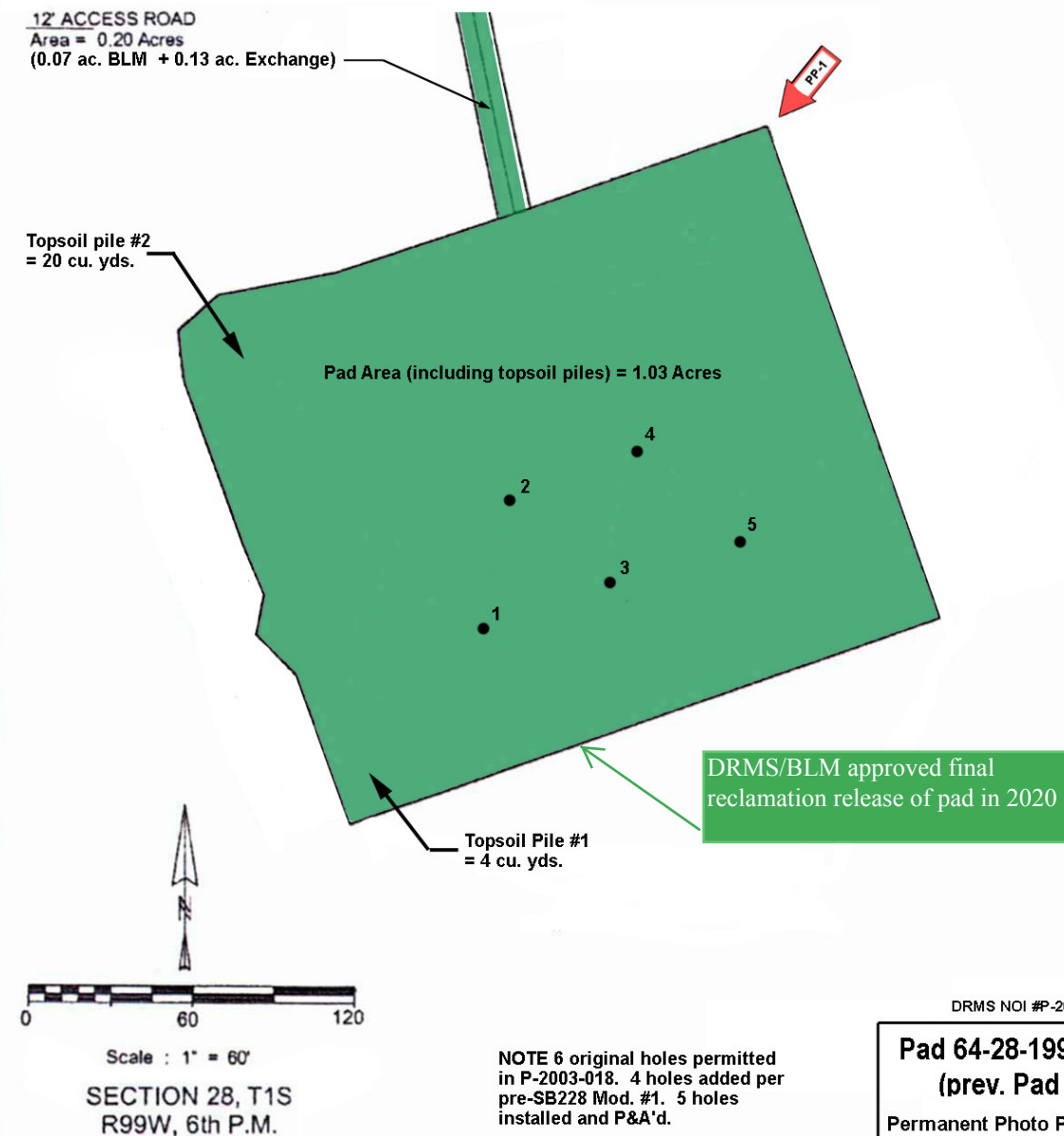

County : Rio Blanco County
Township : 1S Range : 99W P.M. : 6th
Section : 28 Quarter : SWSW

Chuck Whiteman & Associates
320 3rd Street, P.O. Box 957
Meeker Colorado

Shell Frontier Oil & Gas Inc.	
Sheet : ___ of ___	Date : 06 - 15 - 2006
Job No. : 001-06	Updated 08/14/2022

MRP-Wide Reclamation Plan - Map 126d
P-2003-018 Annual Report - Map 09b
COC65458 Annual Report - Map 07b

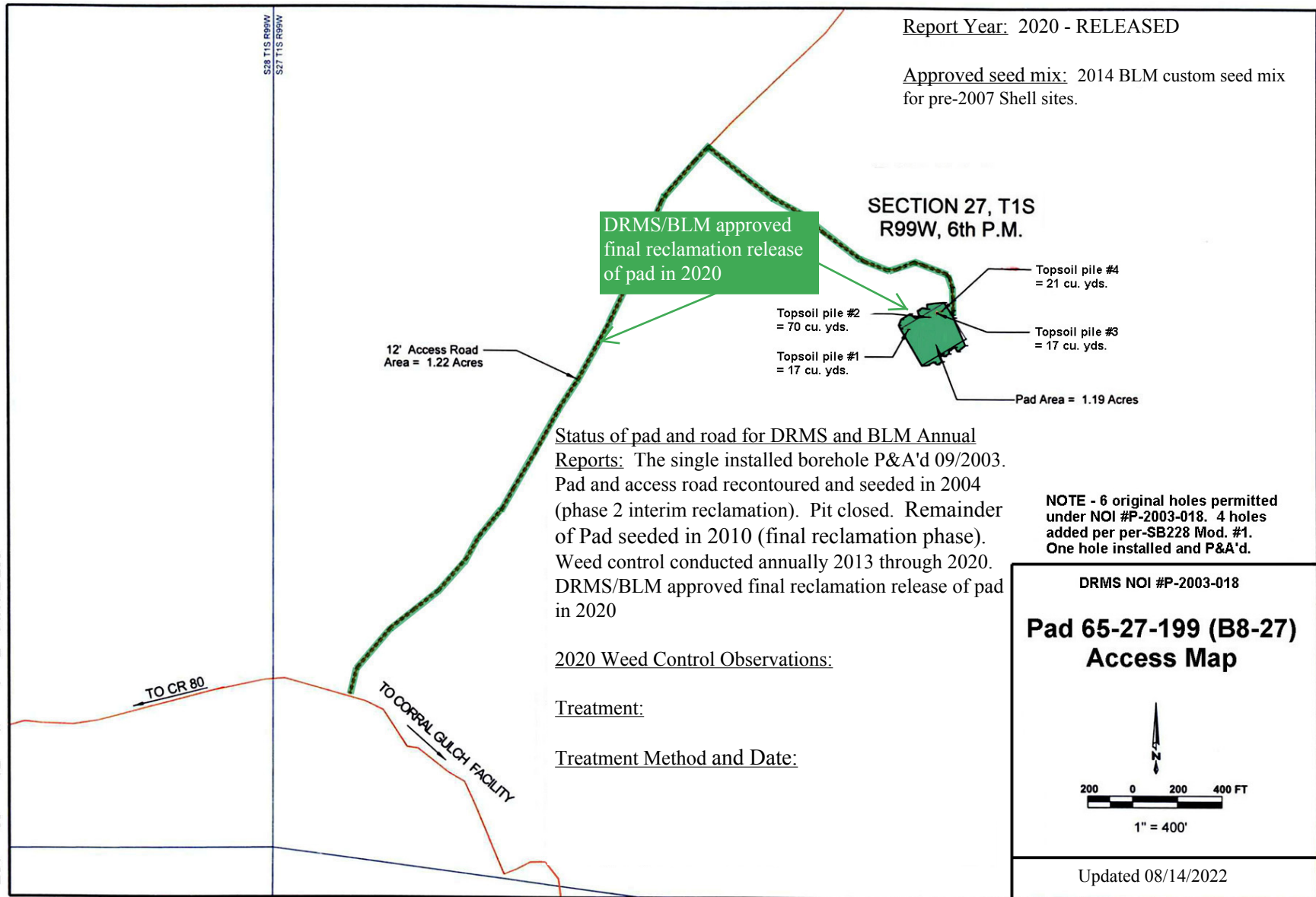

Report Year: 2020

Approved seed mix: 2014 BLM custom seed mix for pre-2007 Shell sites.

Status of pad and road for DRMS and BLM Annual Reports:

The Single installed borehole P&A'd 09/2003. Pad and access road recontoured and seeded in 2004 (phase 2 interim reclamation). Pit closed. Remainder of Pad seeded in 2010 (final reclamation phase). Weed control conducted annually 2013 through 2020. DRMS/BLM approved final reclamation release of pad in 2020

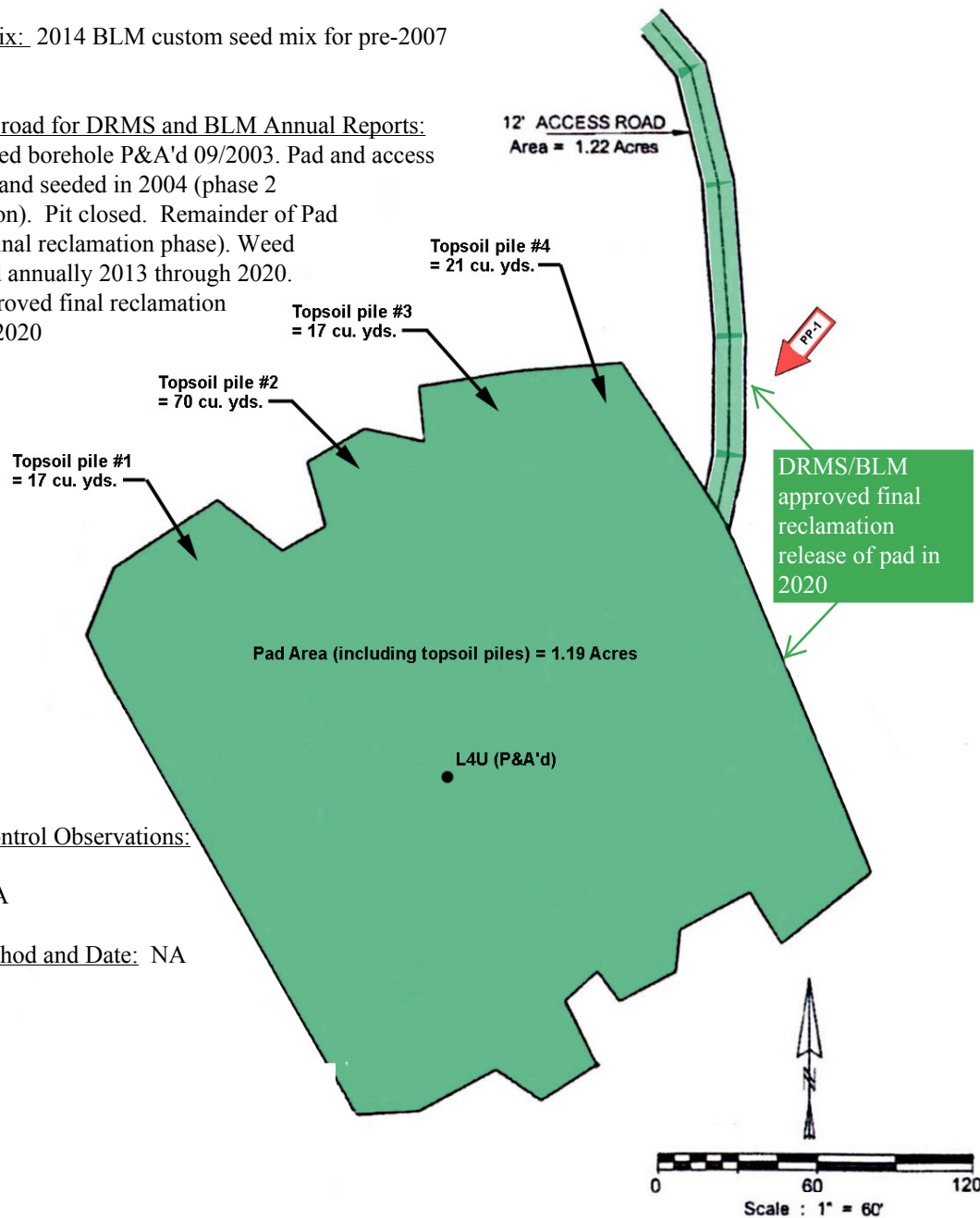

2020 Weed Control Observations:

Treatment: NA

Treatment Method and Date: NA

SECTION 27, T1S
R99W, 6th P.M.

NOTE - 6 holes included in original NOI
#P-2003-018. 4 holes added per pre-SB228
Mod. #1. 1 hole installed and P&A'd.

DRMS NOI #P-2003-018

**Pad 65-27-199 Site Map
(prev. Pad B8-27)**

Permanent Photo Point 

County : Rio Blanco County

Township : 1S Range : 99W P.M. : 6th

Section : 27 Quarter : NWSE

Chuck Whiteman & Associates
320 3rd Street, P.O. Box 957
Meeker Colorado

Shell Frontier Oil & Gas Inc.

Sheet : of Date : 06 - 15 - 2006
Job No. : 001-06 Updated 08/14/2022

MRP-Wide Reclamation Plan - Map 127d
P-2003-018 Annual Report - Map 10b
COC65458 Annual Report - Map 08b

Report Year: 2023

Approved seed mix: 2014 BLM custom seed mix for pre-2007 Shell sites.

Status of pad and road for DRMS and BLM Annual Reports:
The 4 installed boreholes P&A'd 09/2010 and 10/2014. Soil stockpiled seeded 03/2004. Pad downsized 11/2009 (phase 2 interim reclamation). Pit closed. Remainder of Pad seeded in 20106(final reclamation phase). Weed control conducted annually 2012 through 2023. Noxious weed monitoring conducted each year.

2023 Weed Control Observations: annuals and Downy Brome treatment

Treatment: Escort XP @ 1.5 oz/acre, Cornbelt LV6-2,4-D @ 24 oz./acre 1# A.I./acre), Vista @ 1.1 oz/acre, Round Up Pro Max @ 1.0 oz/acre 1# A.I./acre, Sun Wet @ 2 at/100 gal, Hi-lite Dye @ 24 oz./100 gal.. (A.I. = Active Ingredients.)

Treatment Method and Date: Handgun 05/17/23, 07/14/23 & 09/21/23

Pad 66-26-199 (B9-26) Access Map

Updated 08/14/2024

DRMS NOI #P-2003-018

NOTE: 6 holes included in original NOI #P-2003-018. 4 holes added per pre-SB228 Mod. #1. 4 holes installed and P&A'd.

11' Access Road
Total Area = 1.99 Acres

Pad Area = 0.96 Acre
Spur Road Area = 0.15 Acre
Topsoil pile #1 = 40 cu. yds.
4' Wide Ditch Area = 0.01 Acre
Topsoil pile #2 = 29 cu. yds.

The Pad and Access Road have been revegetated and weed monitoring and treatment continue.

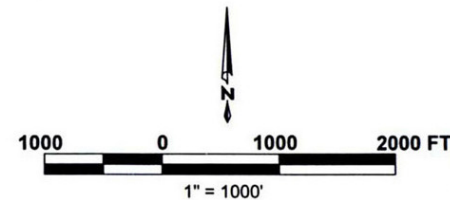

SECTION 26, T1S
R99W, 6th P.M.

Report Year: 2023

Approved seed mix: 2014 BLM custom seed mix for pre-2007 Shell sites.

Status of pad and road for DRMS and BLM Annual Reports:

The 4 installed boreholes P&A'd 09/2010 and 10/2014. Soil stockpiled seeded 03/2004. Pad downsized 11/2009 (phase 2 interim reclamation). Pit closed. Remainder of Pad seeded in 2010 (final reclamation phase). Weed control conducted annually 2012 through 2023. Noxious weed monitoring conducted each year.

2023 Weed Control Observations:
annuals and Downy Brome treatment

Treatment: Escort XP @ 1.5 oz/acre, Cornbelt LV6-2,4-D @ 24 oz./acre 1# A.I./acre), Vista @ 1.1 oz/acre, Round Up Pro Max @ 1.0 oz/acre 1# A.I./acre, Sun Wet @ 2 at/100 gal, Hi-lite Dye @ 24 oz./100 gal.. (A.I. = Active Ingredients.)

Treatment Method and Date:
Handgun 05/17/23, 07/14/23 & 09/21/23

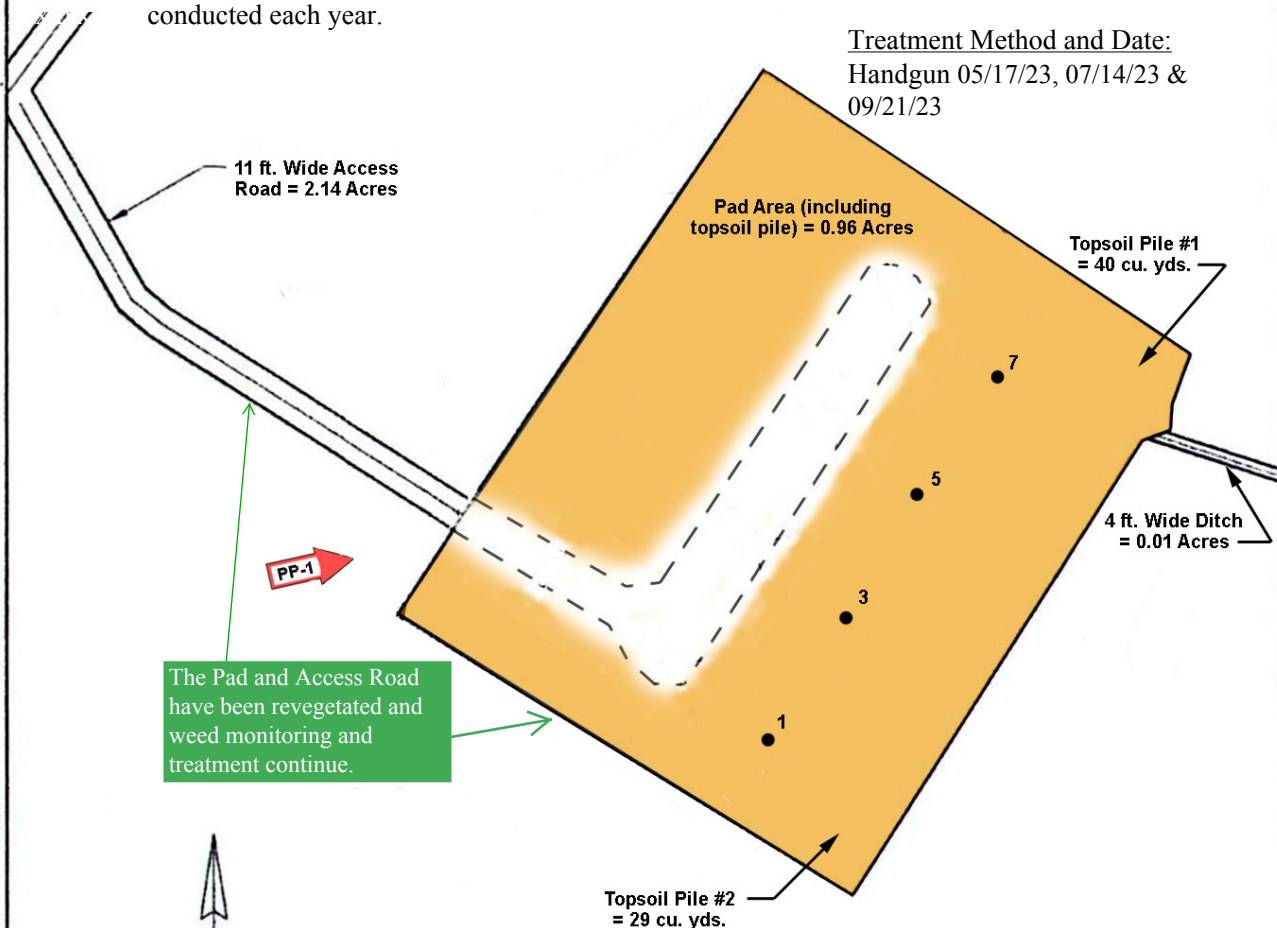

SECTION 26, T1S
R99W, 6th P.M.

NOTE: 6 holes included in original #P-2003-015. 4 additional holes added per P-2003-018 mod #1. 4 holes installed and P&A'd.

DRMS NOI #P-2003-018

Pad 66-26-199 Site Map
(prev. Pad B9-26)

Permanent Photo Point

County : Rio Blanco County

Township : 1S Range : 99W P.M. : 6th

Section : 26 Quarter : SWNE

Chuck Whiteman & Associates
320 3rd Street, P.O. Box 957
Meeker Colorado

Shell Frontier Oil & Gas Inc.

Sheet : _ of _ Date : 06 - 15 - 2006
Job No. : 001-06 Updated 08/14/2024

MRP-Wide Reclamation Plan - Map 128b
P-2003-018 Annual Report - Map 11b
COC65458 Annual Report - Map 09b

Report Year: 2019 - RELEASED

Approved seed mix: 2014 BLM custom seed mix for pre-2007

Shell sites.

Status of pad and road for DRMS and BLM Annual Reports:

The 9 installed boreholes P&A'd 05/2004 and 09/2014.

Seeding and Curlex application on portion of pad, soil stockpile 04/2007 (phase 2 interim reclamation).

Pit closed 09/2008. Pad regrading and soil replacement work completed, seeding work completed in Fall 2014 (final reclamation phase). Weed control conducted annually 2012 through 2019. Noxious weed monitoring conducted each year. DRMS/BLM approved final reclamation release of pad in 2019.

2019 Weed Control Observations: No weed observed

Treatment: E

Treatment Method and Date: NA

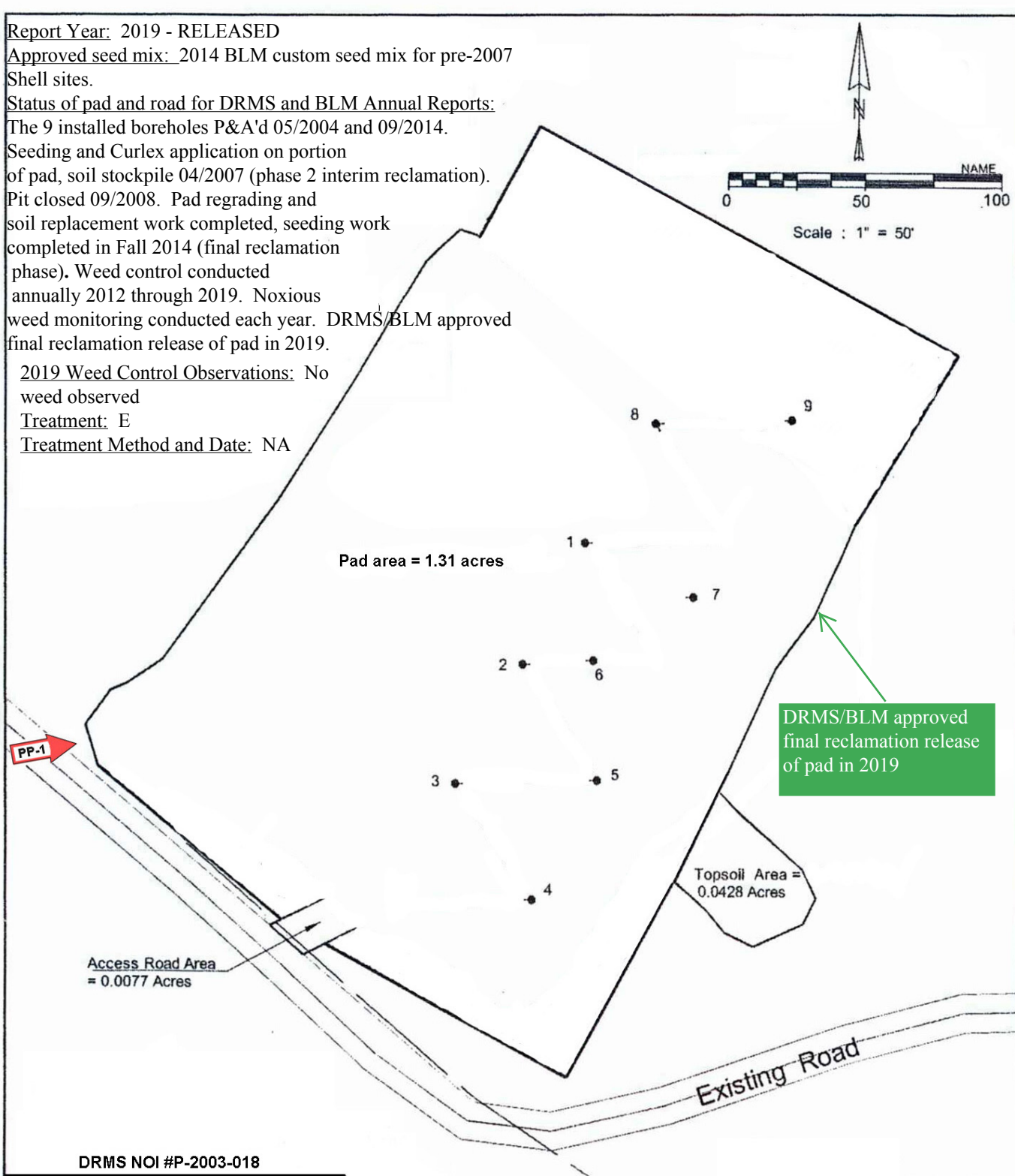

DRMS/BLM approved final reclamation release of pad in 2019

DRMS NOI #P-2003-018

Pad 1-11-299 Site Map

Permanent Photo Point



NOTE - Original 2 holes included in DRMS NOI #P-2003-018. Six additional holes permitted in NOI #P-2005-001, plus 3 additional holes per pre-SB228 Mod. #1.

County : Rio Blanco County		
Township : 2S	Range : 99W	P.M. : 6th
Section : 11	Quarter : NwNE	

Chuck Whiteman & Associates
320 3rd Street, P.O. Box 957
Meeker Colorado

Shell Frontier Oil & Gas Inc.

Sheet : ___ of ___ Date : 06 - 15 - 2006
Job No. : 001-06 Updated 08/14/2021

MRP-Wide Reclamation Plan - Map 074
P-2003-018 Annual Report - Map 12
P-2005-001 Annual Report - Map 02
COC67069 Annual Report - Map 01

Report Year: 2019 - RELEASED

Approved seed mix: 2014 BLM custom seed mix for pre-2007 Shell sites

Status of pad and road for DRMS and BLM Annual Reports: The 10 installed boreholes P

05/2007, and 09/2014. Seedling and Curlex application on soil stockpiles 04/2007 (phase 2 interim reclamation). Pit closed 09/2009. Pad regrading and soil replacement work completed, seeding work completed in Fall 2014 (final reclamation phase). Weed control conducted annually 2012 through 2019. Noxious weed monitoring conducted each year. DRMS/BLM approved final reclamation release of pad in 2019.

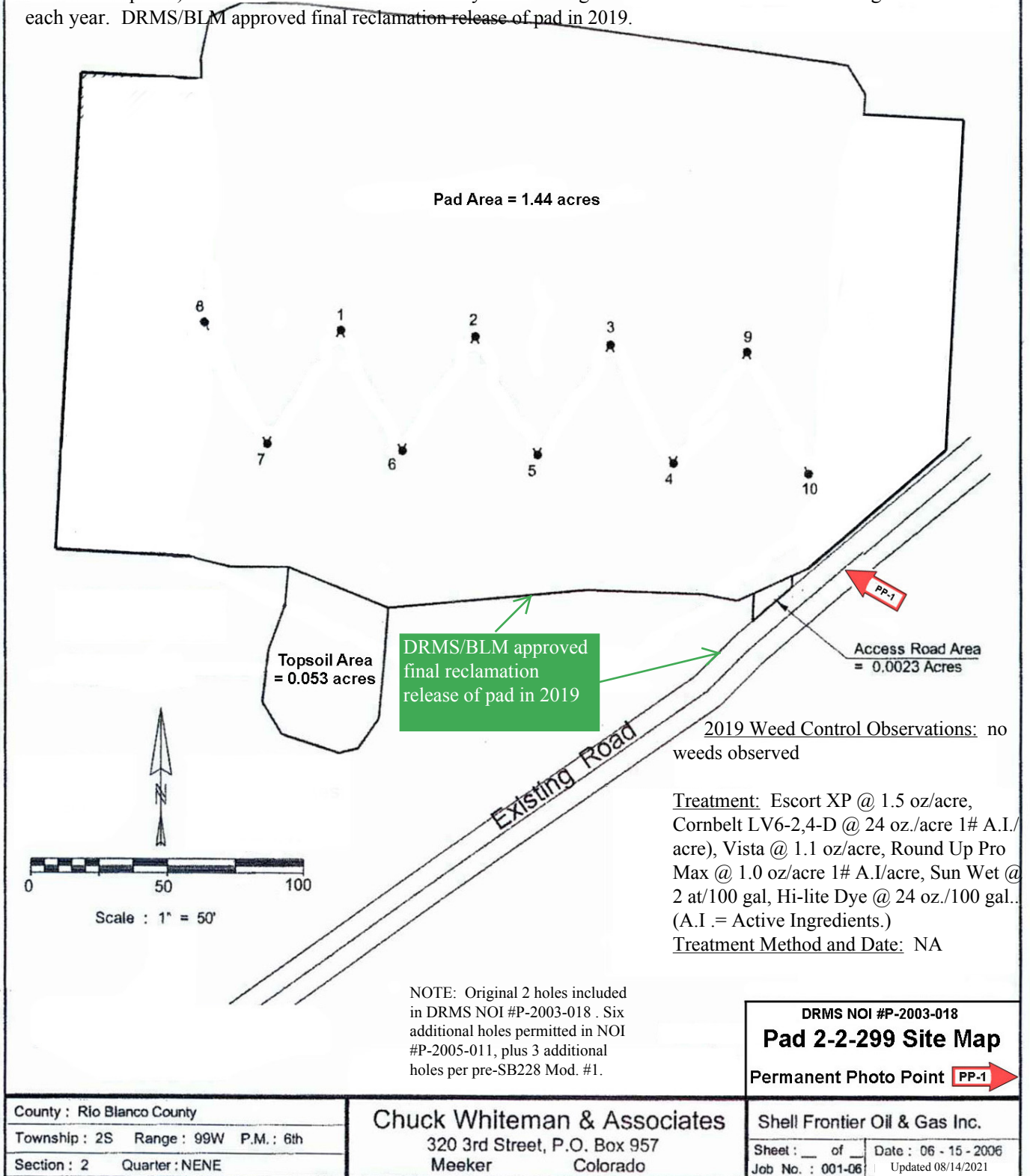

MRP-Wide Reclamation Plan - Map 075
P-2003-018 Annual Report - Map 13
P-2005-001 Annual Report - Map 03
COC67069 Annual Report - Map 02

NOTE - Original 2 holes included in DRMS NOI #P-2003-018. Six additional holes permitted in NOI #P-2005-001, plus 3 additional holes per pre-SB228 Mod. #1.

Report Year: 2019 - RELEASED

Approved seed mix: 2014 BLM custom seed mix for pre-2007 Shell sites.

Status of pad and road for DRMS and BLM Annual Reports:

1 of 8 installed boreholes P&A'd 11/2003. Pit closed, partial seeding for ground cover 09/2008 (phase 2 Interim reclamation). Remaining borehole P&A'd 09/2015, grading and seeding conducted in Fall 2015 (final reclamation phase). Weed control conducted annually 2012 through 2019. Noxious weed monitoring conducted each year. DRMS/BLM approved final reclamation release of pad in 2019.

2019 Weed Control Observations: No weeds observed

Treatment: NA

Treatment Method and Date: NA

DRMS NOI #P-2003-018

Pad 3-1-299 Site Map

Permanent Photo Point

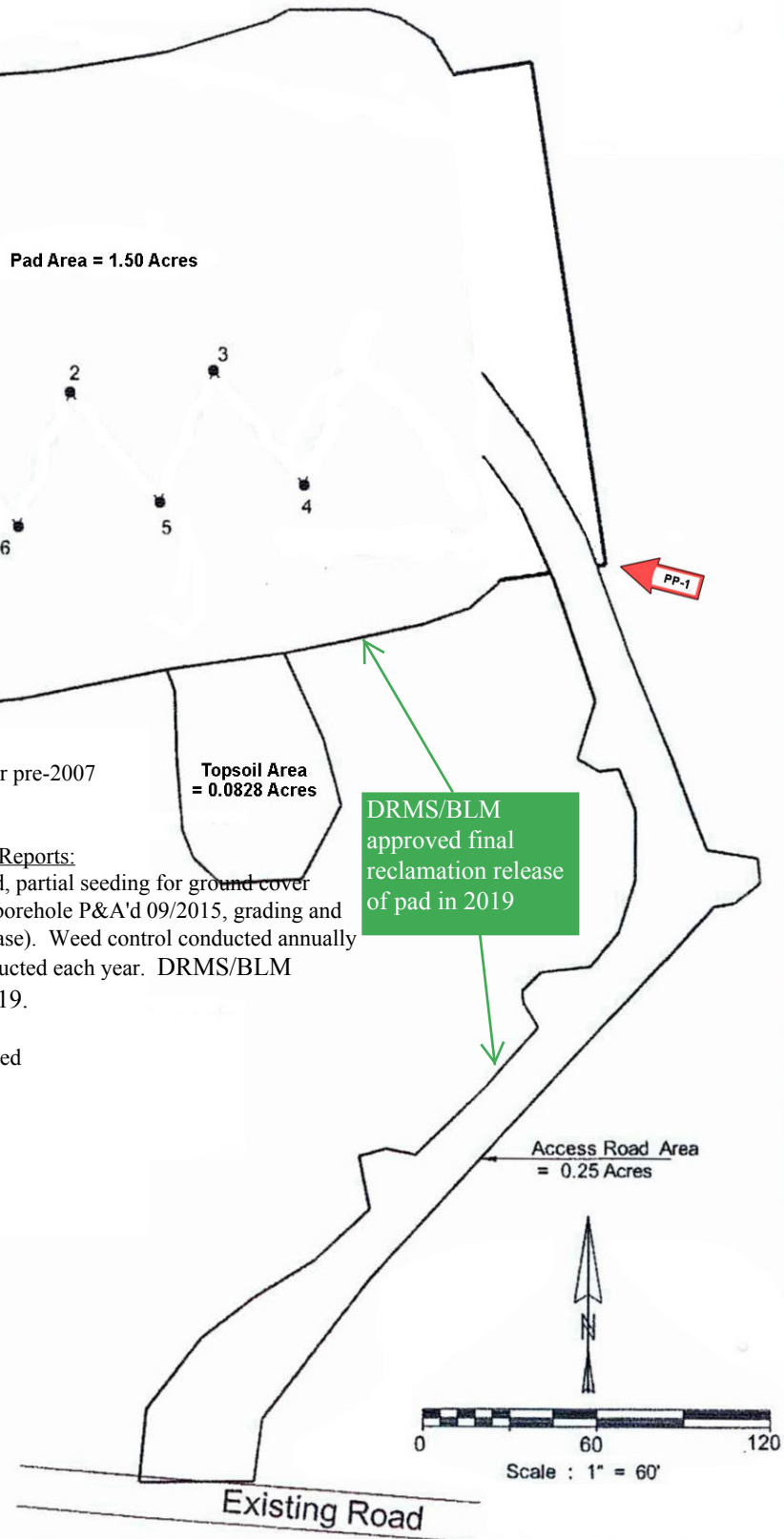

County : Rio Blanco County

Township : 2S Range : 99W P.M. : 6th

Section : 1 Quarter : SENE

Chuck Whiteman & Associates

320 3rd Street, P.O. Box 957
Meeker Colorado

Shell Frontier Oil & Gas Inc.

Sheet : ___ of ___ Date : 06 - 15 - 2006
Job No. : 001-06 Updated 08/14/2021

MRP-Wide Reclamation Plan - Map 077
P-2003-018 Annual Report - Map 14
P-2005-001 Annual Report - Map 04
COC67069 Annual Report - Map 03