

MRP-Wide Reclamation Plan - Map 078a
P-2003-018 Annual Report - Map 15
P-2004-011 Annual Report - Map 02
COC67069 Annual Report - Map 04
COC68010 Annual Report - Map 06

Report Year: 2023

Approved seed mix: 2014 BLM custom mix for pre-2007
Shell sites.

Status of site for DRMS and BLM Annual Reports:

2 of 7 installed boreholes P&A'd 05/2004 and 11/2007. Pad downsized, some soil material re-spread, and site seeded 09/2007 (phase 2 interim reclamation). Portion of soil not re spread was seeded and Curlex applied. Remaining 5 boreholes P&A'd 10/2015. Remaining disturbed areas graded and seeded Fall 2015 (final reclamation phase). Weed control conducted annually 2012 through 2023. Noxious weed monitoring conducted each year. Ongoing spot re-seeding to establish vegetation growth. 2023: amended the site with wood chips and organic mulch, reseed.

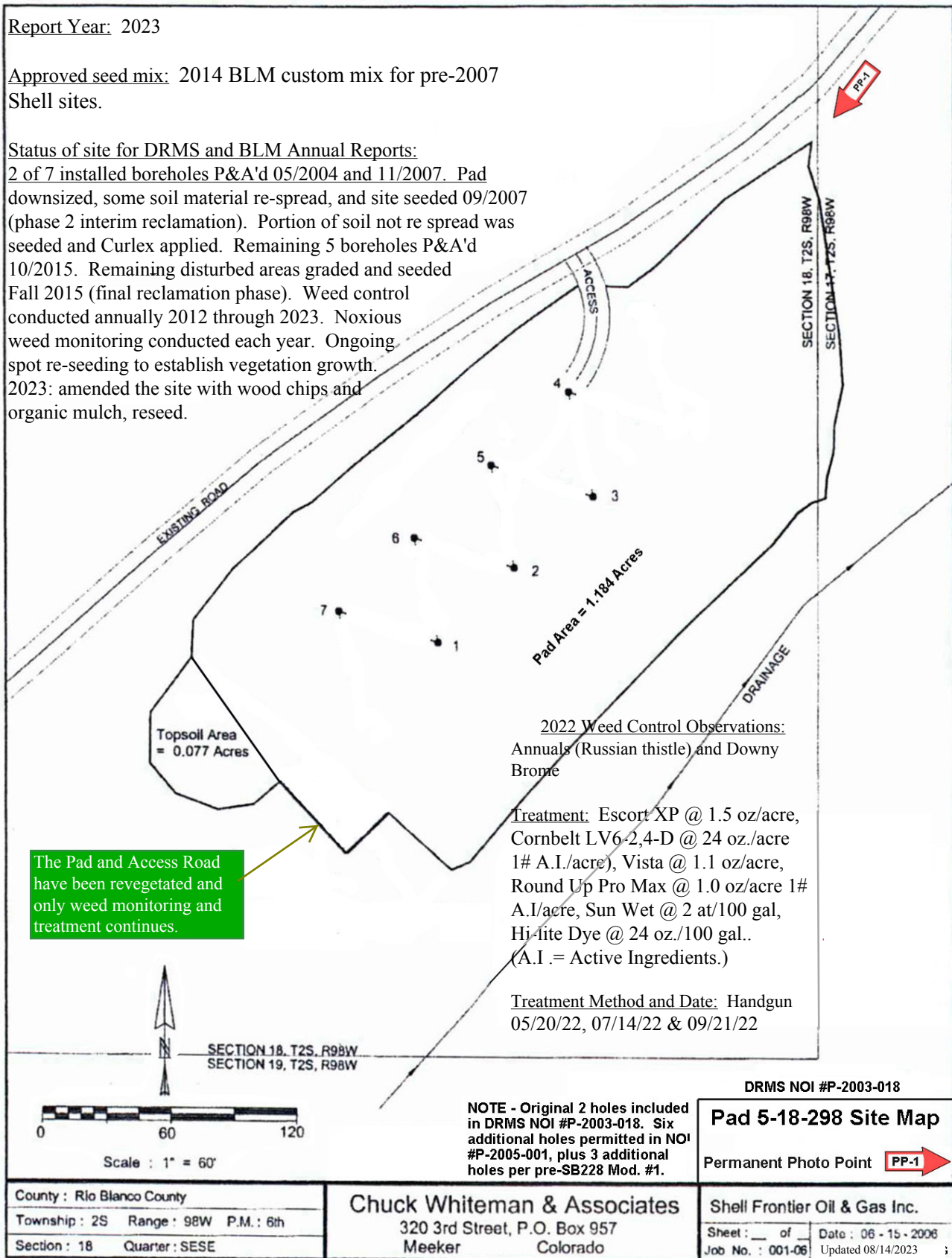

MRP-Wide Reclamation Plan - Map 079b
P-2003-018 Annual Report - Map 16
P-2005-001 Annual Report - Map 05
COC67069 Annual Report - Map 05

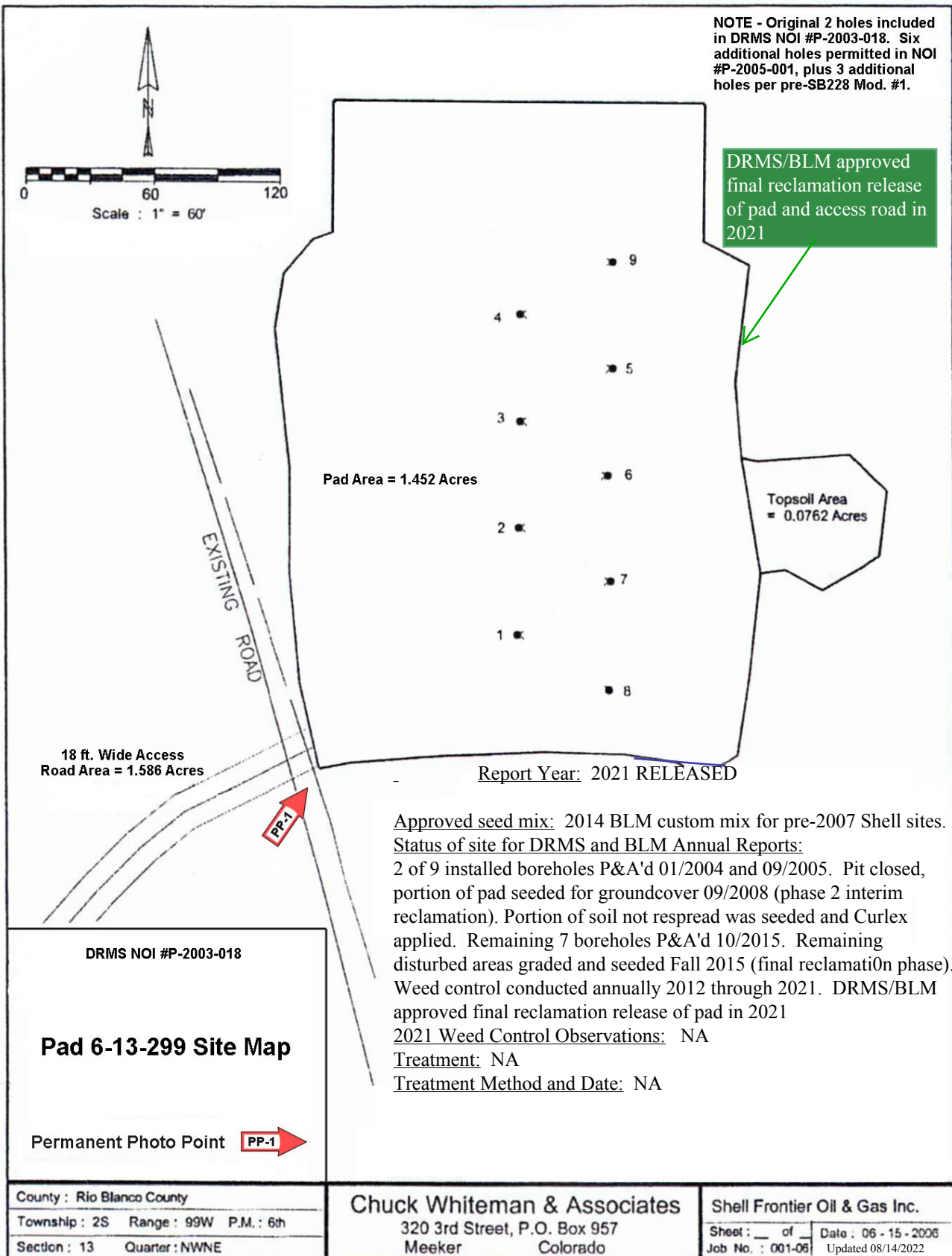

MRP-Wide Reclamation Plan - Map 080b
 P-2003-018 Annual Report - Map 17
 P-2005-001 Annual Report - Map 06
 COC67069 Annual Report - Map 06

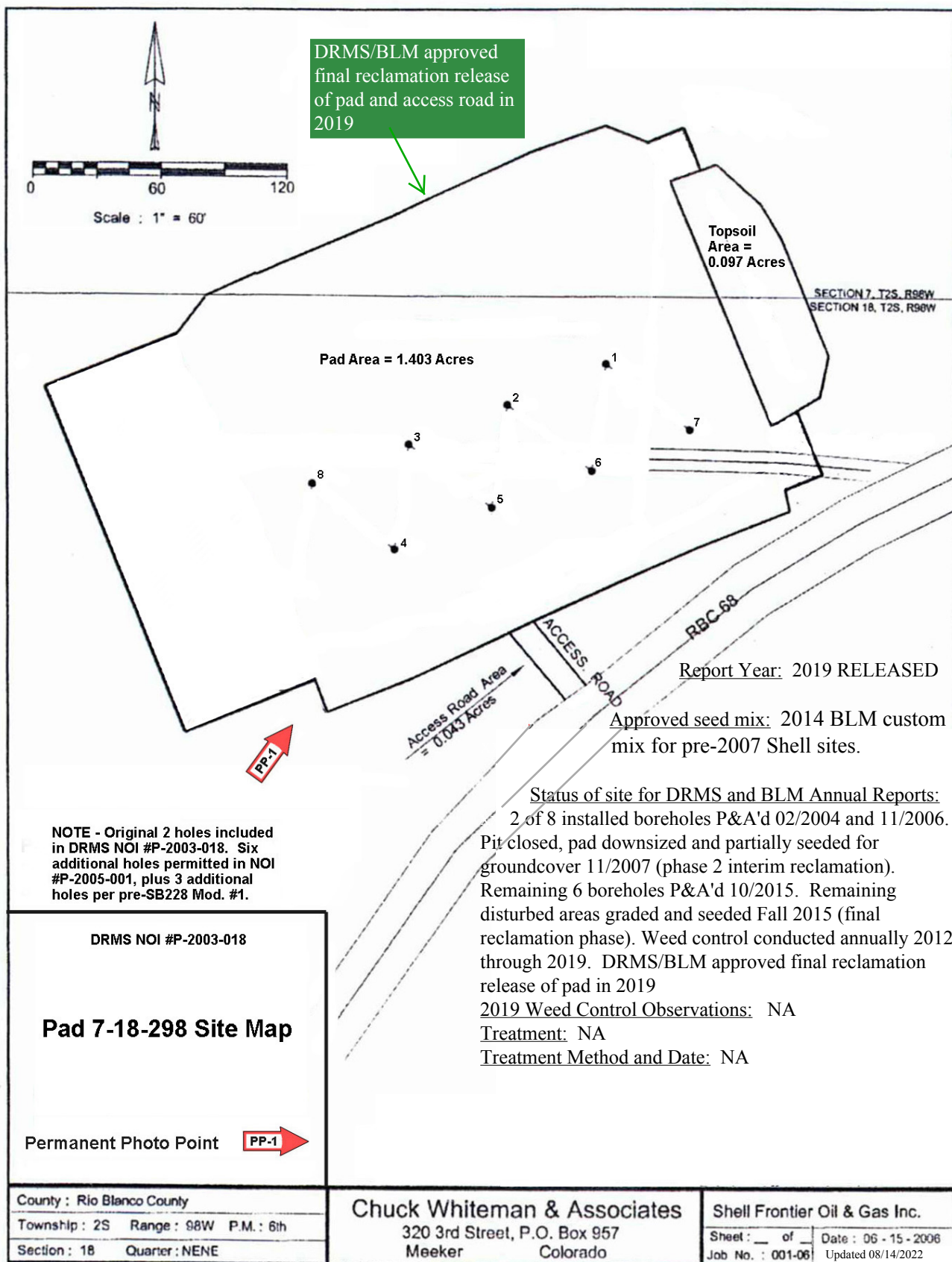

MRP-Wide Reclamation Plan - Map 082b
 P-2003-018 Annual Report - Map 18
 P-2005-001 Annual Report - Map 07
 COC67069 Annual Report - Map 07

NOTE - Original 2 holes included in DRMS NOI #P-2003-018. Six additional holes permitted in NOI #P-2005-001, plus 3 additional holes per pre-SB228 Mod. #2.

The Pad and Access Road have been revegetated and only weed monitoring and treatment continues.

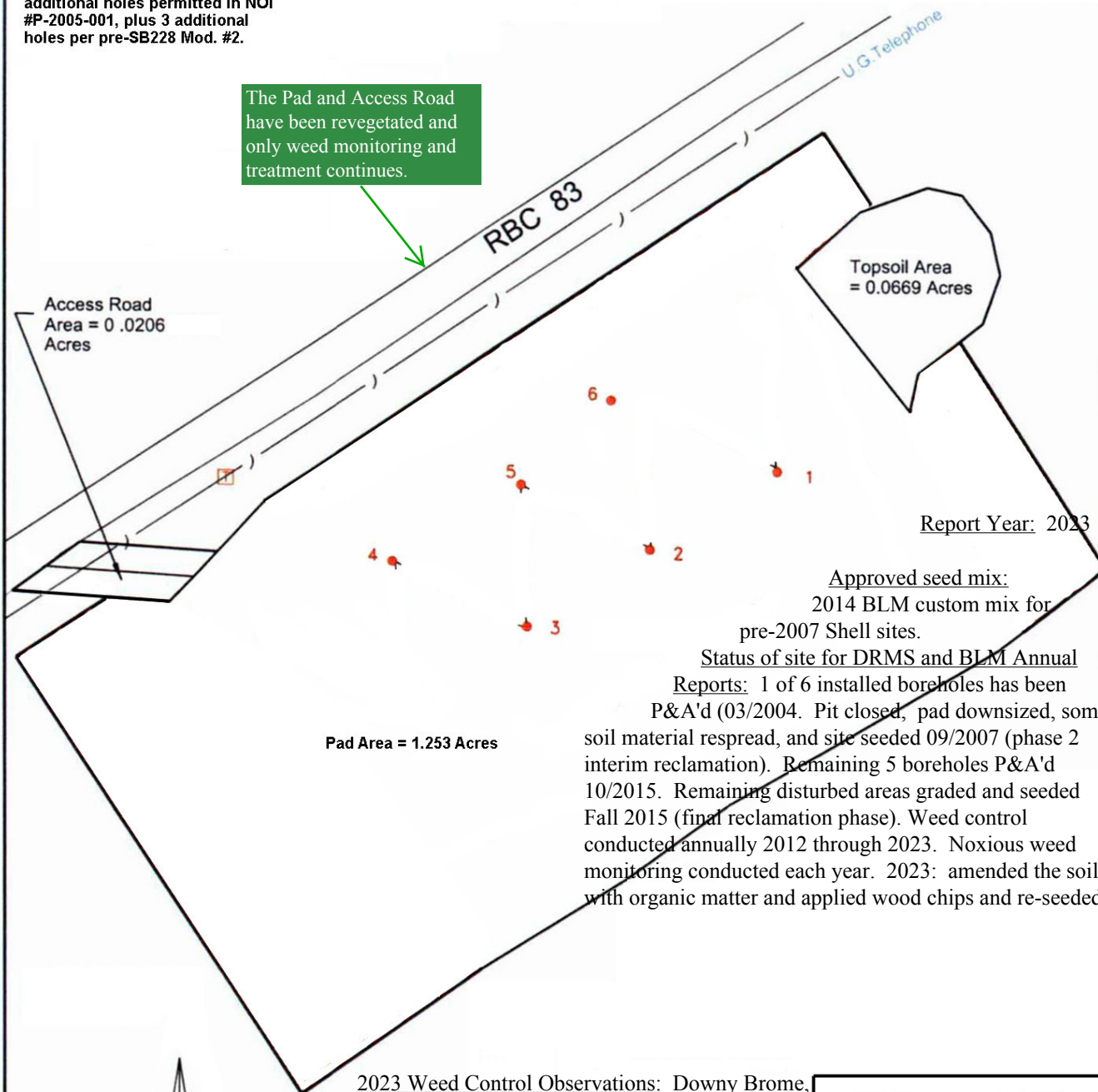

Report Year: 2023

Approved seed mix:
2014 BLM custom mix for
pre-2007 Shell sites.

Status of site for DRMS and BLM Annual
Reports: 1 of 6 installed boreholes has been
P&A'd (03/2004). Pit closed, pad downsized, some
soil material respread, and site seeded 09/2007 (phase 2
interim reclamation). Remaining 5 boreholes P&A'd
10/2015. Remaining disturbed areas graded and seeded
Fall 2015 (final reclamation phase). Weed control
conducted annually 2012 through 2023. Noxious weed
monitoring conducted each year. 2023: amended the soil
with organic matter and applied wood chips and re-seeded.

2023 Weed Control Observations: Downy Brome,
Russian thistle & annuals.

Treatment: Escort XP @ 1.5 oz/acre, Cornbelt
LV6-2,4-D @ 24 oz./acre 1# A.I./acre), Vista @
1.1 oz/acre, Round Up Pro Max @ 1.0 oz/acre 1#
A.I./acre, Sun Wet @ 2 at/100 gal, Hi-lite Dye @
24 oz./100 gal.. (A.I. = Active Ingredients.)

Treatment Method and Date:
Handgun 05/20/23, 07/14/23 & 09/21/23

DRMS NOI #P-2003-018

Pad 8-3-298 Site Map

Permanent Photo Point **PP-1**

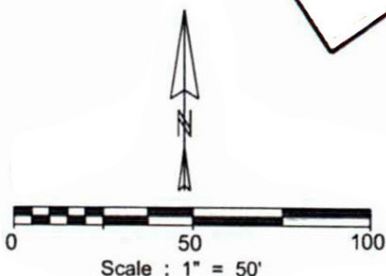

County: Rio Blanco County
Township: 2S Range: 98W P.M.: 6th
Section: 3 Quarter: NWNW

Chuck Whiteman & Associates
320 3rd Street, P.O. Box 957
Meeker, Colorado

Shell Frontier Oil & Gas Inc.
Sheet: ___ of ___ Date: 06-30-2006
Job No.: 001-06 Updated 08/14/2023

MRP-Wide Reclamation Plan - Map 083
P-2003-018 Annual Report - Map 19
P-2005-001 Annual Report - Map 08
COC67069 Annual Report - Map 08

NOTE - Original 2 holes included in DRMS NOI #P-2003-018. Six additional holes permitted in NOI #P-2005-001, plus 3 additional holes per pre-SB228 Mod. #1.

The Pad and Access Road have been revegetated and only weed monitoring and treatment continues.

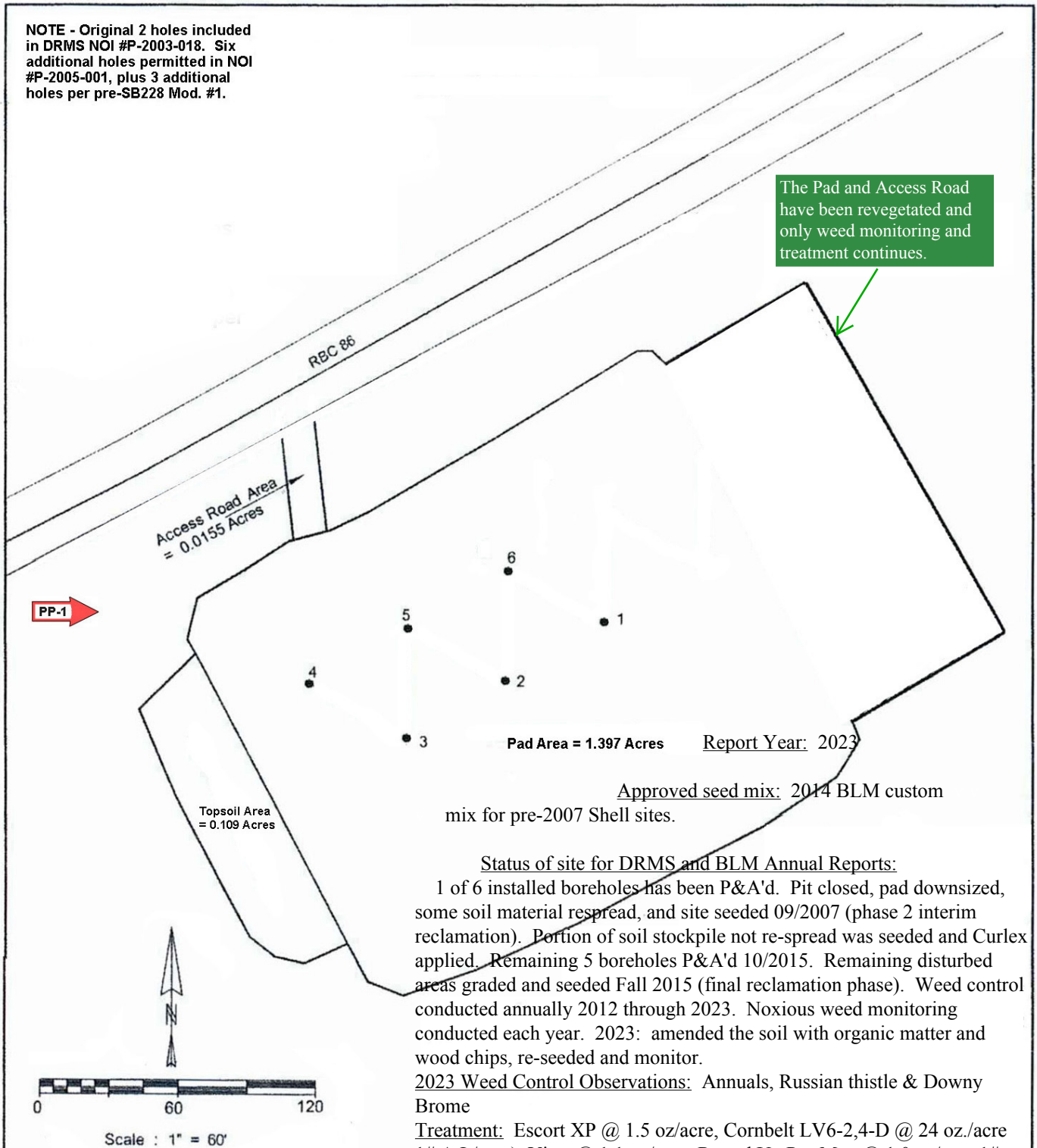

Approved seed mix: 2014 BLM custom mix for pre-2007 Shell sites.

Status of site for DRMS and BLM Annual Reports:

1 of 6 installed boreholes has been P&A'd. Pit closed, pad downsized, some soil material respread, and site seeded 09/2007 (phase 2 interim reclamation). Portion of soil stockpile not re-spread was seeded and Curlex applied. Remaining 5 boreholes P&A'd 10/2015. Remaining disturbed areas graded and seeded Fall 2015 (final reclamation phase). Weed control conducted annually 2012 through 2023. Noxious weed monitoring conducted each year. 2023: amended the soil with organic matter and wood chips, re-seeded and monitor.

2023 Weed Control Observations: Annuals, Russian thistle & Downy Brome

Treatment: Escort XP @ 1.5 oz/acre, Cornbelt LV6-2,4-D @ 24 oz./acre 1# A.I./acre), Vista @ 1.1 oz/acre, Round Up Pro Max @ 1.0 oz/acre 1# A.I./acre, Sun Wet @ 2 at/100 gal, Hi-lite Dye @ 24 oz./100 gal.. (A.I. = Active Ingredients.)

Treatment Method and Date: Handgun 05/20/23, 07/14/23 & 09/21/23

DRMS NOI #P-2003-018

Pad 9-9-298 Site Map

Permanent Photo Point



County : Rio Blanco County

Township : 2S Range : 98W P.M. : 6th

Section : 9 Quarter : NWSE

Chuck Whiteman & Associates

320 3rd Street, P.O. Box 957
Meeker Colorado

Shell Frontier Oil & Gas Inc.

Sheet : ___ of ___ Date : 06 - 15 - 2006
Job No. : 001-06 Updated 08/14/2024

MRP-Wide Reclamation Plan - Map 084
P-2003-018 Annual Report - Map 20
P-2005-001 Annual Report - Map 09
COC67069 Annual Report - Map 09

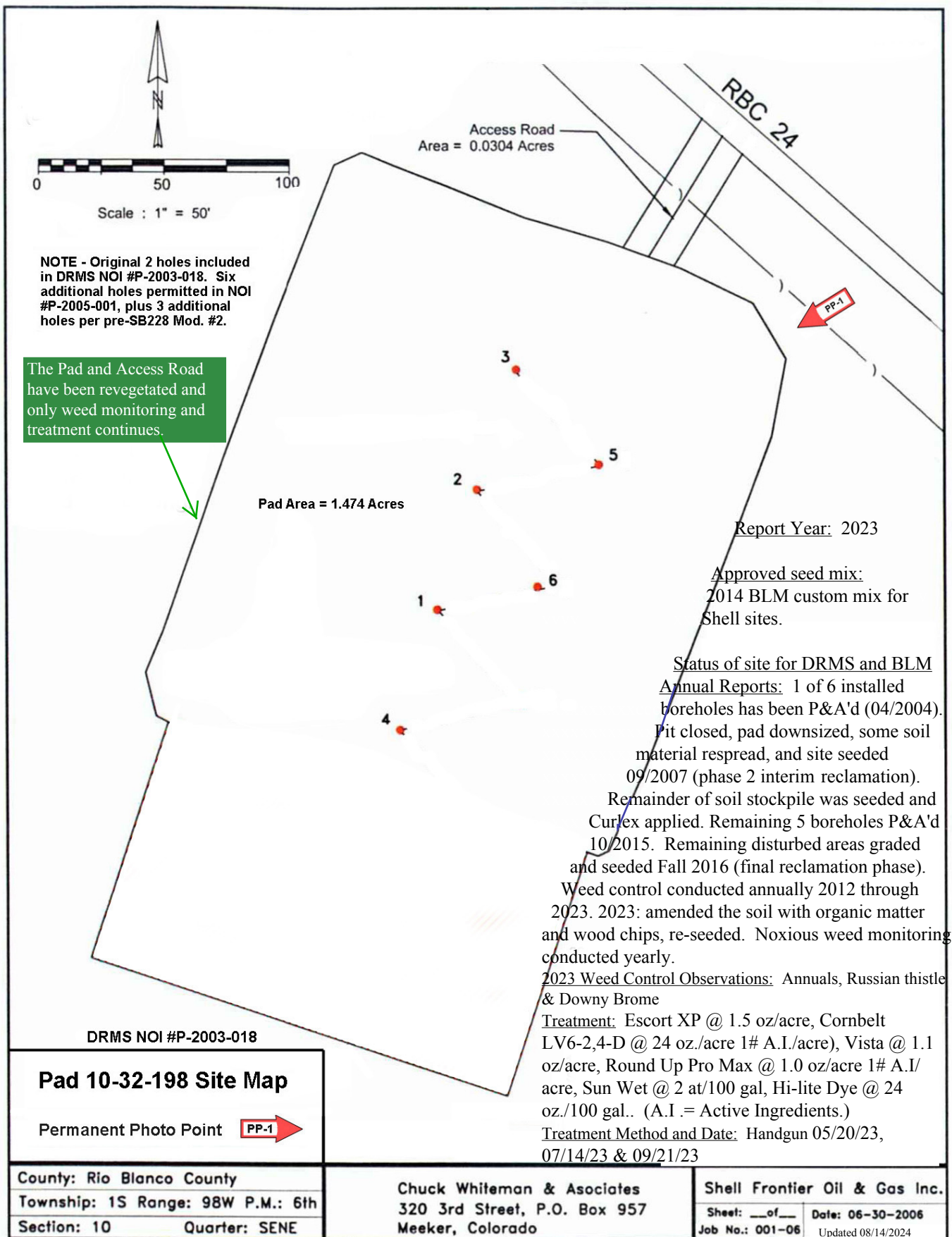

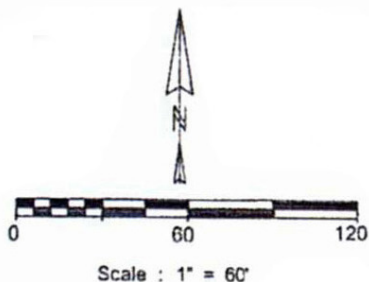

NOTE - Original 2 holes included in DRMS NOI #P-2003-018. Six additional holes permitted in NOI #P-2005-001, plus 3 additional holes per pre-SB228 Mod. #1.

DRMS/BLM approved final reclamation release of pad & access road in 2019

Topsoil Area
= 0.0164 Acres

PP-1

EXISTING ROAD

Pad Area = 1.292 Acres

Report Year: 2019

Approved seed mix:
BLM native mix #6 (1997 RMP).

Status of site for DRMS and BLM
Annual Reports: 2 of 7 installed boreholes

P&A'd 06/2004 and 11/2006. Pit closed 10/2008 (phase 2 interim reclamation). Remaining 6 boreholes P&A'd 10/2015. Remaining disturbed areas graded and seeded Fall 2015 (final reclamation phase). Weed control conducted annually 2012 through 2020. DRMS/BLM approved final reclamation release of pad in 2019.

2019 Weed Control Observations: NA

Treatment: NA

Treatment Method and Date: NA

DRMS NOI #P-2003-018

Pad 11-16-298 Site Map

Permanent Photo Point

PP-1

County : Rio Blanco County

Township : 2S Range : 98W P.M. : 6th

Section : 16 Quarter : SESW

Chuck Whiteman & Associates
320 3rd Street, P.O. Box 957
Meeker Colorado

Shell Frontier Oil & Gas Inc.

Sheet : ___ of ___ Date : 06 - 15 - 2006
Job No. : 001-06 Updated 08/14/2022

MRP-Wide Reclamation Plan - Map 087b
P-2003-018 Annual Report - Map 22
P-2005-001 Annual Report - Map 11
COC67069 Annual Report - Map 11

2019 Weed Control Observations: annuals

Treatment: Escort XP @ 1.5 oz/acre,
Cornbelt LV6-2,4-D @ 24 oz./acre 1# A.I./
acre), Vista @ 1.1 oz/acre, Round Up Pro
Max @ 1.0 oz/acre 1# A.I/acre, Sun Wet @
2 at/100 gal, Hi-lite Dye @ 24 oz./100 gal..
(A.I. = Active Ingredients.)

Treatment Method and Date: NA

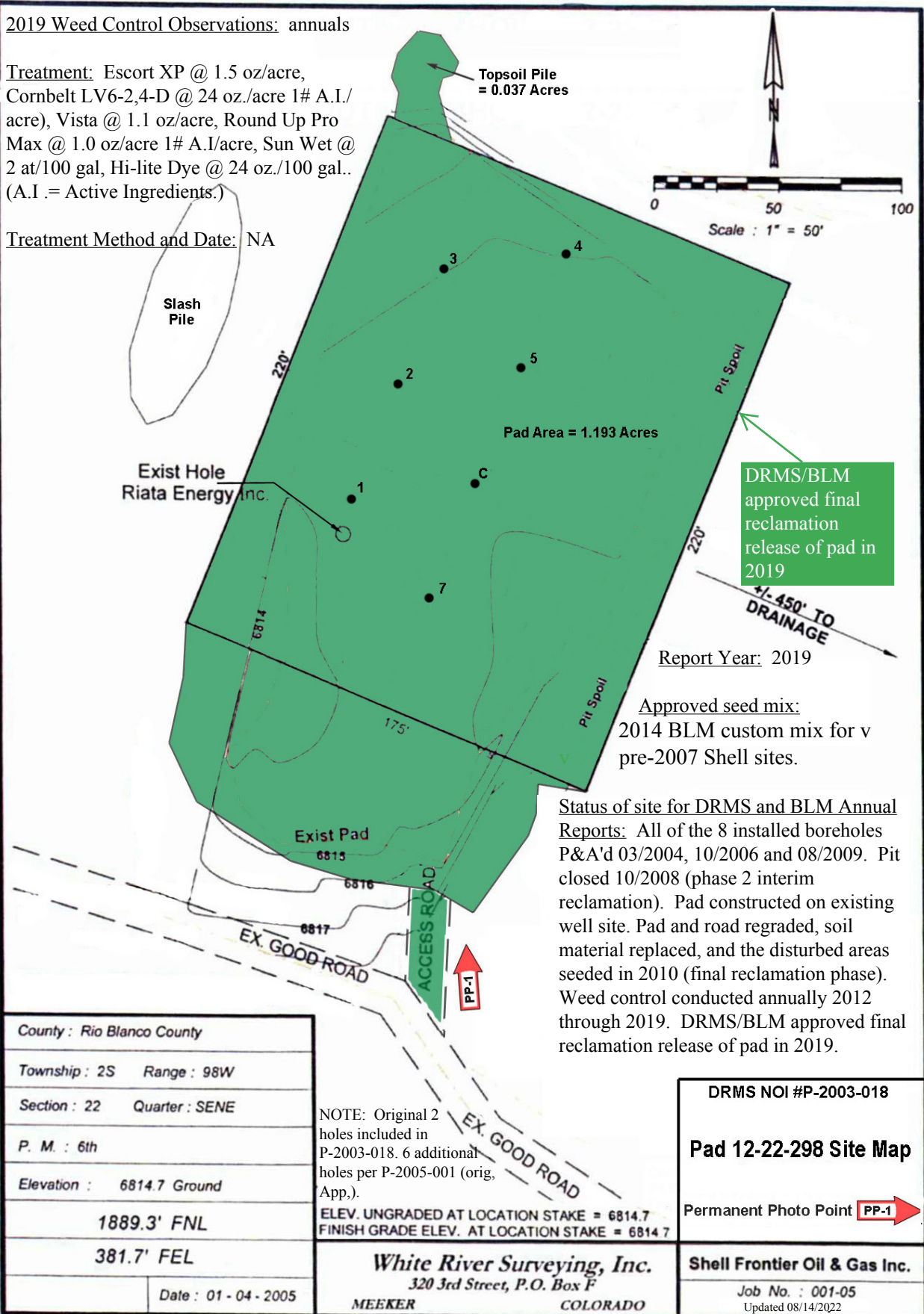

MRP-Wide Reclamation Plan - Map 088
P-2003-018 Annual Report - Map 23
P-2005-001 Annual Report - Map 12
COC67069 Annual Report - Map 12

Note - Original 2 holes included in P-2003-018.
6 additional holes per P-2005-001.



2023 Weed Control Observations:
Annuals and Downy Brome

Treatment: Escort XP @ 1.5 oz/acre, Cornbelt LV6-2,4-D @ 24 oz./acre 1# A.I./acre, Vista @ 1 oz./acre, Round Up Pro Max @ 1 oz./acre 1# A.I./acre, Sun Wet @ 1 qt/100 gal, Hi-lite Dye @ 24 oz./100 gal.. (A.I. = Active Ingredients.)

Treatment Method and Date:
Handgun 05/20/23, 07/14/23 & 09/21/23

Report Year: 2023

Approved seed mix: 2014 BLM custom mix for pre-2007 Shell sites.

Status of site for DRMS and BLM Annual Reports: Site in final reclamation phase. All 4 installed holes P&A'd (04/2004 and 08/2009). Remaining portion of pad and road regraded and soil material replaced, and seeding completed Fall 2010 (final reclamation phase). Weed control conducted annually 2012 through 2023. Noxious weed monitoring conducted each year. Spot reseeded around the wellhead area.

County : Rio Blanco County
Township : 2S Range : 98W
Section : 14 Quarter : NWSE
P. M. : 6th
Elevation : 6567.5 Ground
2352.4' FSL
2148.5' FEL
Date : 12 - 31 - 2004

Permanent Photo Point



DRMS NOI #P-2003-018

Pad 13-14-298 Site Map

Shell Frontier Oil & Gas Inc.

Job No. : 001-05

Updated 08/14/2024

MRP-Wide Reclamation Plan - Map 089
P-2003-018 Annual Report - Map 24
P-2005-001 Annual Report - Map 13
COC67069 Annual Report - Map 13

Report Year: 2023

Approved seed mix:

2014 BLM custom mix for pre-2007 Shell sites.

Status of site for DRMS and BLM Annual Reports:

Phase 1 interim reclamation completed during Construction. Roadway is maintained on an as-needed basis. Weed control conducted annually 2012 through 2022. Noxious weed monitoring conducted each year. DRMS/BLM approved final reclamation release of pad in 2023

2023 Weed Control Observations: annuals and Downy Brome Spring/Fall treatment

Treatment: Escort XP @ 2 oz//ac., Cornbelt LV6-2,4-D @ 24 oz./acre 1# A.I./acre, Sun Wet @ 2 qt/100 gal., Hi-Lite Dye @ 24 oz./100 gal.. (A.I. = Active Ingredients.)

Treatment Method and Date: Handgun 05/20/23, 07/14/23 & 09/21/23

MRP-Wide Reclamation Plan - Map 035a
P-2003-018 Annual Report - Map 25a
COC59309* Annual Report - Map 01a
* also permitted under COC60385

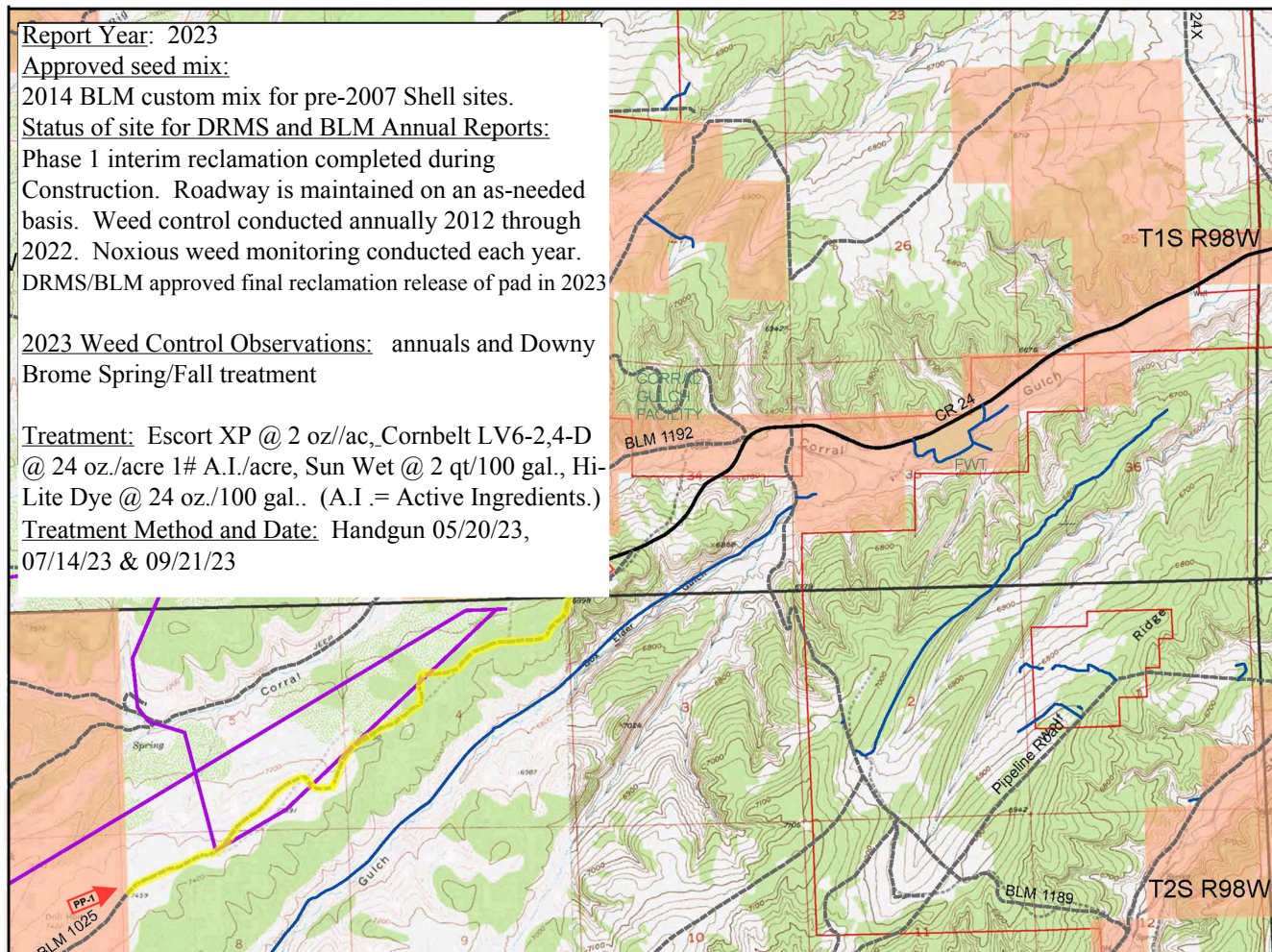

Airplane Ridge Road Access Map (portion situated on BLM land)

Legend

- Power Line (to Remain)
- Power Line (To Be Removed)
- Existing Access Road
- Unpaved Road
- Paved Road
- Portion of Airplane Ridge Road covered under BLM ROW Grants COC59309 and COC60385, and DRMS NOI #P-2003-018.

Land Ownership

- Shell
- State
- Private
- BLM

Disturbed Area

BLM Surface
= 13.18 Acres
(P-2003-018)

Private Surface
= 19.44 Acres
(P-2003-022)

PP-1 Permanent Photo Point

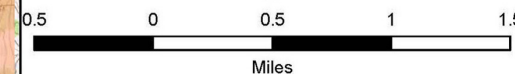
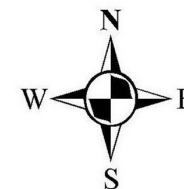

Updated 08/14/2023

Airplane Ridge Road Disturbed Acreages

										Access Road					Telephone		Water Line			
	Mile Marker						Segment Length (ft)	Original Road Width (ft)	MFE Affected Area (ac)	Left Side (ft)	Travel Width (ft)	Right Side (ft)	Total Road Width (ft)	Total (acres)	Telephone Line Width* (ft)	Total (acres)	Water Line Width (ft)	Total (acres)	Mile Marker	
Public Land	0										16		16		0				0	End Asphalt-Begin New Affected Area
	0.25						1320	11	0.33	2	21	4	27	0.65	0	0.00			0.25	
	0.5						1320	11	0.33	6	19	3	28	0.83	0	0.00			0.5	
	0.75						1320	11	0.33	1	21	3	25	0.80	0	0.00			0.75	
	1						1320	11	0.33	2	19	3	24	0.74	0	0.00			1	
	1.25						1320	11	0.33	6	19	3	28	0.79	0	0.00			1.25	
	1.5						1320	11	0.33	7	19	3	29	0.86	0	0.00			1.5	
	1.75						1320	11	0.33	6	19	4	29	0.88	0	0.00			1.75	
	2						1320	11	0.33	8	19	5	32	0.92	0	0.00			2	
	2.15						792	11	0.20	7	19	3	29	0.55	11	0.10			2.15	Telephone not adjacent to road
	2.25						528	11	0.13	7	19	4	30	0.36	11	0.13			2.25	Telephone not adjacent to road
	2.3						264	11	0.07	7	19	4	30	0.18	11	0.07			2.3	Telephone not adjacent to road
	2.35						264	11	0.07	4	19	5	28	0.18	0	0.03			2.35	
	2.45						528	11	0.13	4	19	6	29	0.35	0	0.00			2.45	
2.5						264	11	0.07	3	21	0	24	0.16	8	0.02			2.5		
2.75						1320	11	0.33	3	19	0	22	0.70	5	0.20			2.75		
Totals on Public Land							14,520		3.67					8.96		0.55				
SFOGI Land	3						1320	11	0.33	3	19	0	22	0.67	6	0.17			3	
	3.25						1320	11	0.33	3	21	0	24	0.70	5	0.17			3.25	
	3.35						528	11	0.13	4	18	0	22	0.28	4	0.05	3	0.02	3.35	Location of Well 2-7
	3.5						792	11	0.20	4	18	0	22	0.40	3	0.06	3	0.05	3.5	
	3.75						1320	11	0.33	4	19	0	23	0.68	7	0.15	7	0.15	3.75	
	4						1320	11	0.33	4	18	0	22	0.68	9	0.24	8	0.23	4	
	4.25						1320	11	0.33	2	19	0	21	0.65	5	0.21	5	0.20	4.25	
	4.5						1320	11	0.33	3	20	0	23	0.67	8	0.20	7	0.18	4.5	
	4.75						1320	11	0.33	2	17	0	19	0.64	6	0.21	5	0.18	4.75	
	5						1320	11	0.33	2	19	0	21	0.61	7	0.20	6	0.17	5	
	5.25						1320	11	0.33	2	17	0	19	0.61	6	0.20	6	0.18	5.25	
	5.35						528	11	0.13	3	17	11	31	0.30	5	0.07	6	0.07	5.35	Old Jeep Trail
	5.5						792	11	0.20	6	20	12	38	0.63	5	0.09	5	0.10	5.5	Old Jeep Trail
	5.75						1320	11	0.33	5	20	12	37	1.14	6	0.17	5	0.15	5.75	Old Jeep Trail
	5.85						528	11	0.13	5	20	11	36	0.44	5	0.07	5	0.06	5.85	Old Jeep Trail
	6						792	11	0.20	5	22	0	27	0.57	5	0.09	5	0.09	6	
	6.25						1320	11	0.33	4	21	0	25	0.79	0	0.08	0	0.08	6.25	
Totals on SFOGI Land							18,480		4.67					10.44		2.42		1.91		
							Total Acres		8.33					19.40		2.97		1.91		

Original 11 foot width of road improved for Mahogany Field Experiment (MFE) on Public Land = 3.67 ac
 Original 11 foot width of road improved for MFE on SFOGI Land = 4.67 ac
 Total original road improvement for MFE = 8.33 ac

Additional road widening for Mahogany Field Experiment/Mahogany Demo. Proj./Mahogany Test Experiment
 Monitoring Program (MFE/MDP/MTE Mon. Program) on Public Land (8.96 ac - 3.67 ac) = 5.29 ac
 Additional road widening for MFE/MDP/MTE Mon. Program on SFOGI land (10.44 ac - 4.67 ac) = 5.77 ac
 Total additional road widening for MFE/MDP/MTE Mon. Program = (5.29 ac + 5.77 ac) = 11.06 ac

Notes:

* Split with Water Line where applicable