

Note: Map permit boundary and map features are illustrative and not based on a survey.

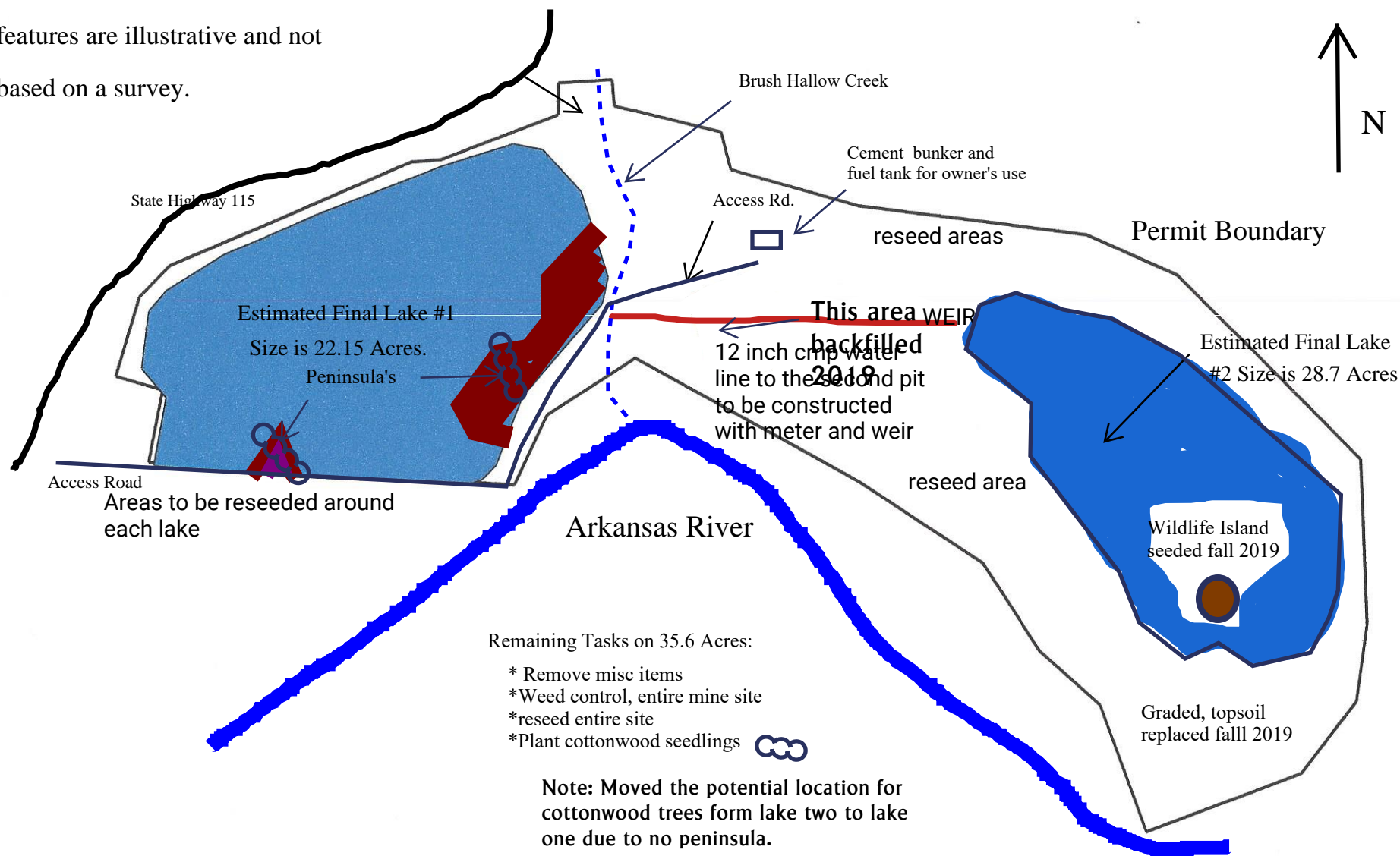

Remaining Tasks on 35.6 Acres:

- * Remove misc items
- * Weed control, entire mine site
- * reseed entire site
- * Plant cottonwood seedlings

Note: Moved the potential location for cottonwood trees from lake two to lake one due to no peninsula.

The pipeline to lake #2 is added by Water resource engineers to be constructed by Castle Aggregate

M2001-005 Grisenti Farms Gravel Pit

July 12, 2024

5/23/2023

Scale: 1 inch= 500 feet

File: Permit boundry with ponds.ndp

Operator: Continental Materials, Inc.

Permit Area 115.3 Acres Gravel pit located in Fremont County