

J:\Hatch\Mapera_10310104_Thunderbird\Public\Copy\DRMS\Drawings_Site\Mining Plan.dwg, MARIETTA, 1/26/2024 10:32:34 AM

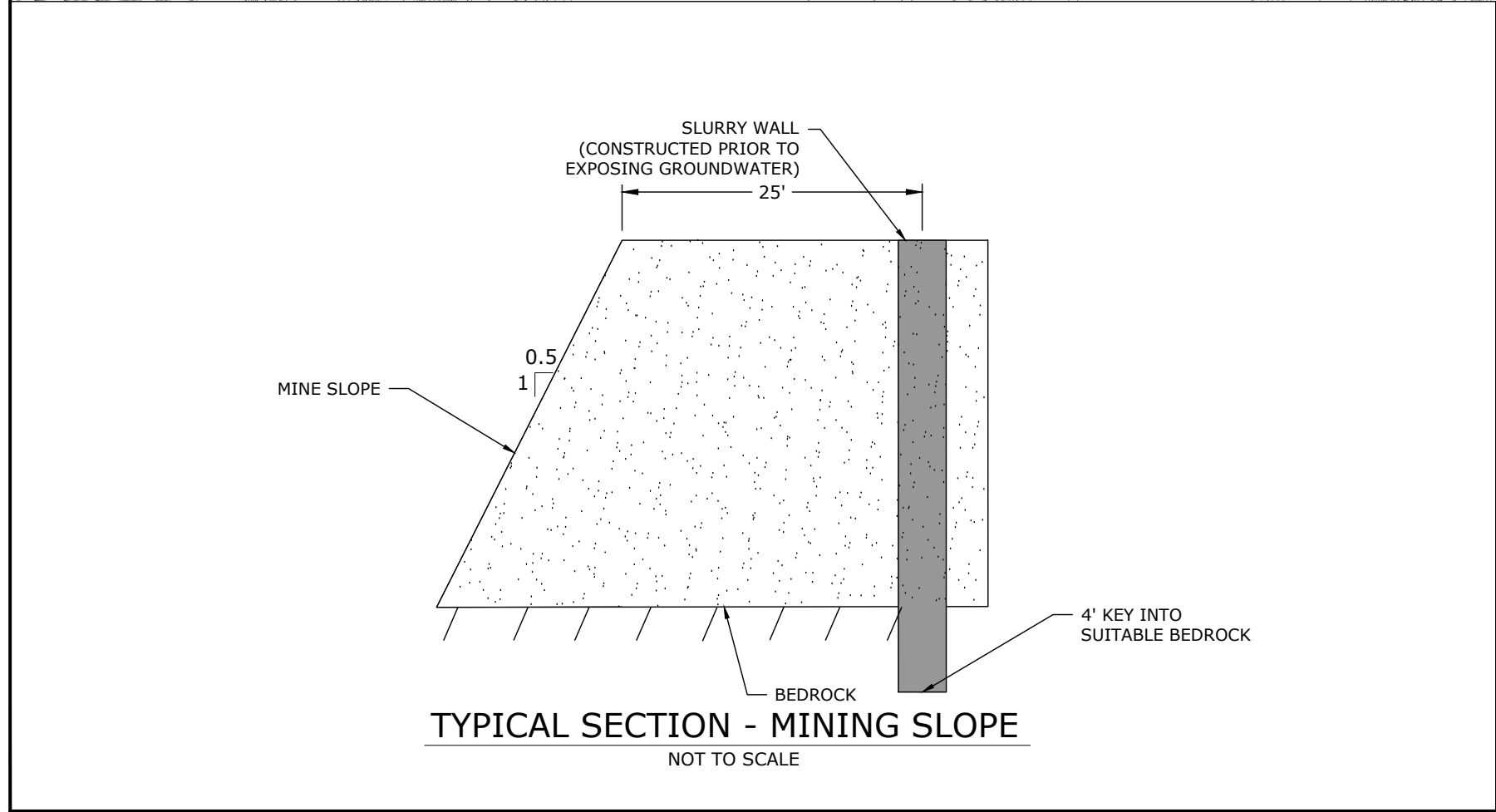
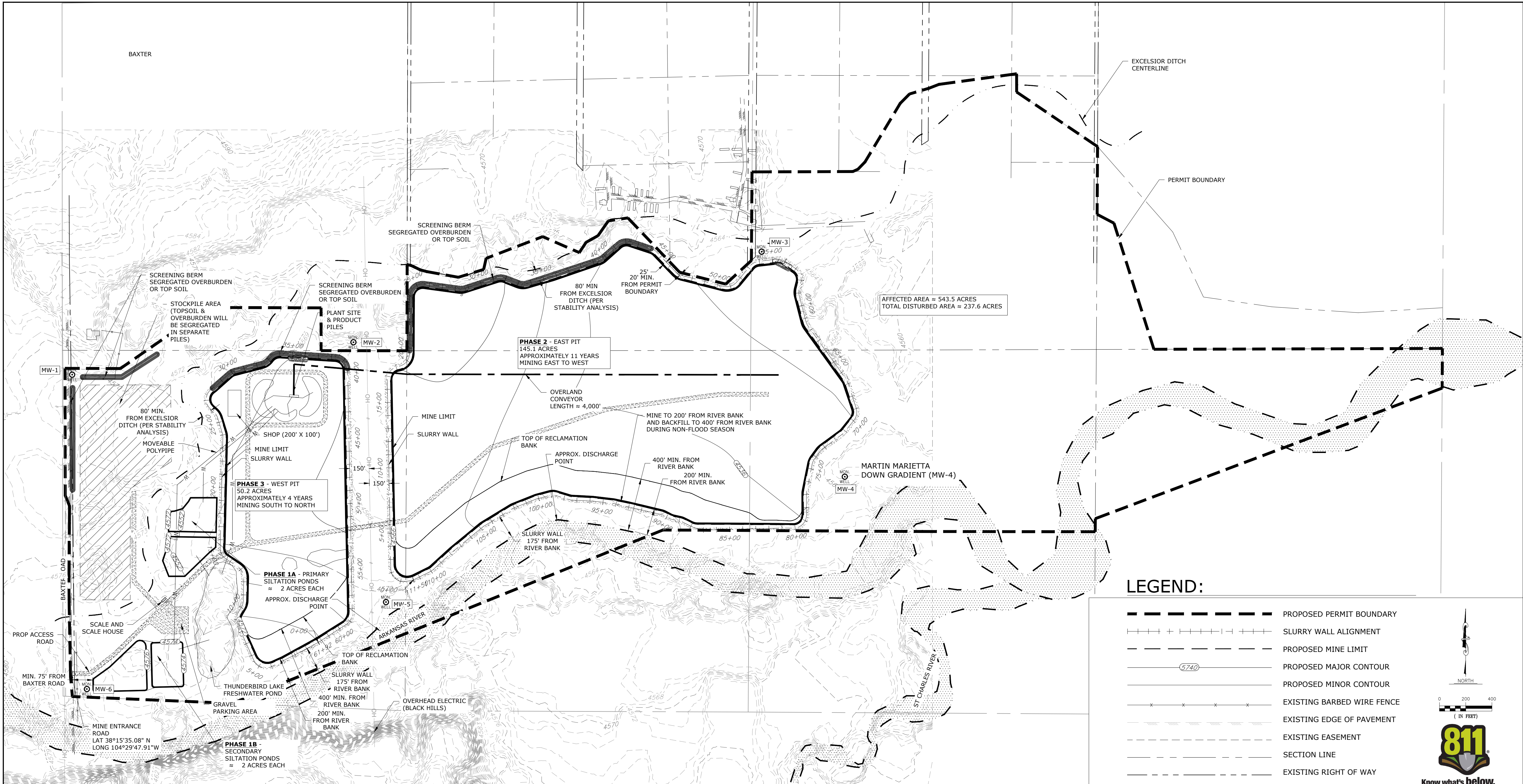

NOTES:
1. RIVER BANK LOCATION WILL BE SURVEYED PRIOR TO MINING.
2. MINE LIMIT MAY ENCR OACH TO A MINIMUM OF 200 FEET FROM THE RIVER BANK IN THE NON-FLOOD SEASON SEPTEMBER 30 THROUGH APRIL 1. THESE ENCROACHMENT AREAS WILL BE BACKFILLED TO A DISTANCE OF 400 FEET FROM TOP OF RIVER BANK BY THE FOLLOWING APRIL 1.

PHASE AREAS:
PHASE 1:
A: SILT POND S ≈ 4 ACRES
B: ROADS & PARKING AREA ≈ 8 ACRES
C: PLANT AREA ≈ 5 ACRES
D: STOCKPILE AREA ≈ 20 ACRES
E: BERMS ≈ 4.5 ACRES

PHASE 2:
A: EAST PIT ≈ 145.1 ACRES

PHASE 3:
A: WEST PIT ≈ 50.2 ACRES

PREPARED UNDER THE SUPERVISION OF:
[Signature] 9/13/22
NAME Kyle S. Regan P.G. DATE
QUALIFIED AS A PROFESSIONAL GEOLOGIST AS DEFINED BY COLORADO STATUTE.

LEGEND:

- PROPOSED PERMIT BOUNDARY
- SLURRY WALL ALIGNMENT
- PROPOSED MINE LIMIT
- PROPOSED MAJOR CONTOUR
- PROPOSED MINOR CONTOUR
- EXISTING BARBED WIRE FENCE
- EXISTING EDGE OF PAVEMENT
- EXISTING EASEMENT
- SECTION LINE
- EXISTING RIGHT OF WAY
- PROPOSED CONVEYOR
- EXISTING GAS LINE
- MOVEABLE POLYPIPE
- PROPOSED ACCESS ROAD
- FLOOD PLANE
- EXISTING BURIED ELECTRICAL
- EXISTING OVERHEAD ELECTRICAL
- EXISTING FIBER OPTIC
- WATERWAY
- MONITORING WELLS
- ELECTRICAL BOX
- OVERHEAD ELECTRIC POLE
- STOCKPILE AREA (SEGREGATED TOPSOIL & OVERBURDEN)
- SCREENING BERM WITH SEGREGATED TOPSOIL & OVERBURDEN

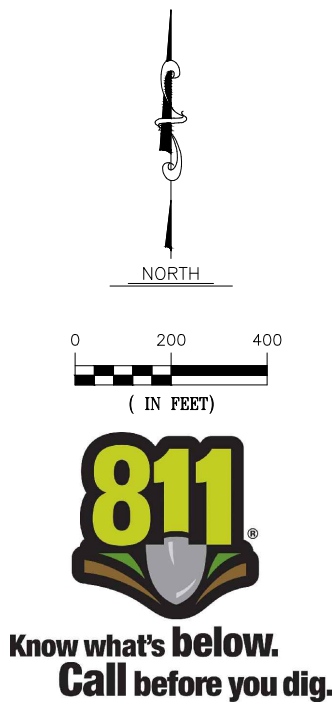

CIVIL RESOURCES

8308 COLORADO BLVD, SUITE 200
FIRESTONE, CO 80504
303.833.1416
WWW.CIVILRESOURCES.COM

MARTIN MARIETTA

1627 COLE BLVD. SUITE 200
LAKEWOOD, CO 80401

THUNDERBIRD SAND AND GRAVEL
DRMS 112C PERMIT APPLICATION
PUEBLO COUNTY, COLORADO

REVISIONS		
NO.	DESCRIPTION	DATE
1	DRMS ADEQUACY 1	1/24/24

DESIGNED BY: GL	DATE: 24/01/2024
DRAWN BY: KR	SCALE: AS NOTED
CHECKED BY: GL	AS NOTED
JOB NO.: 296.001.04	
DWG NAME: Mining Plan.dwg	

MINING PLAN

SHEET:
EXHIBIT-C2