

No Changes for 2023

- Permanently resurfaced with Roadbase
- Reclaimed Reservoir with Approved Leak Test
- Previously Affected areas seeded waiting on vegetative cover

No newly affected area in 2021

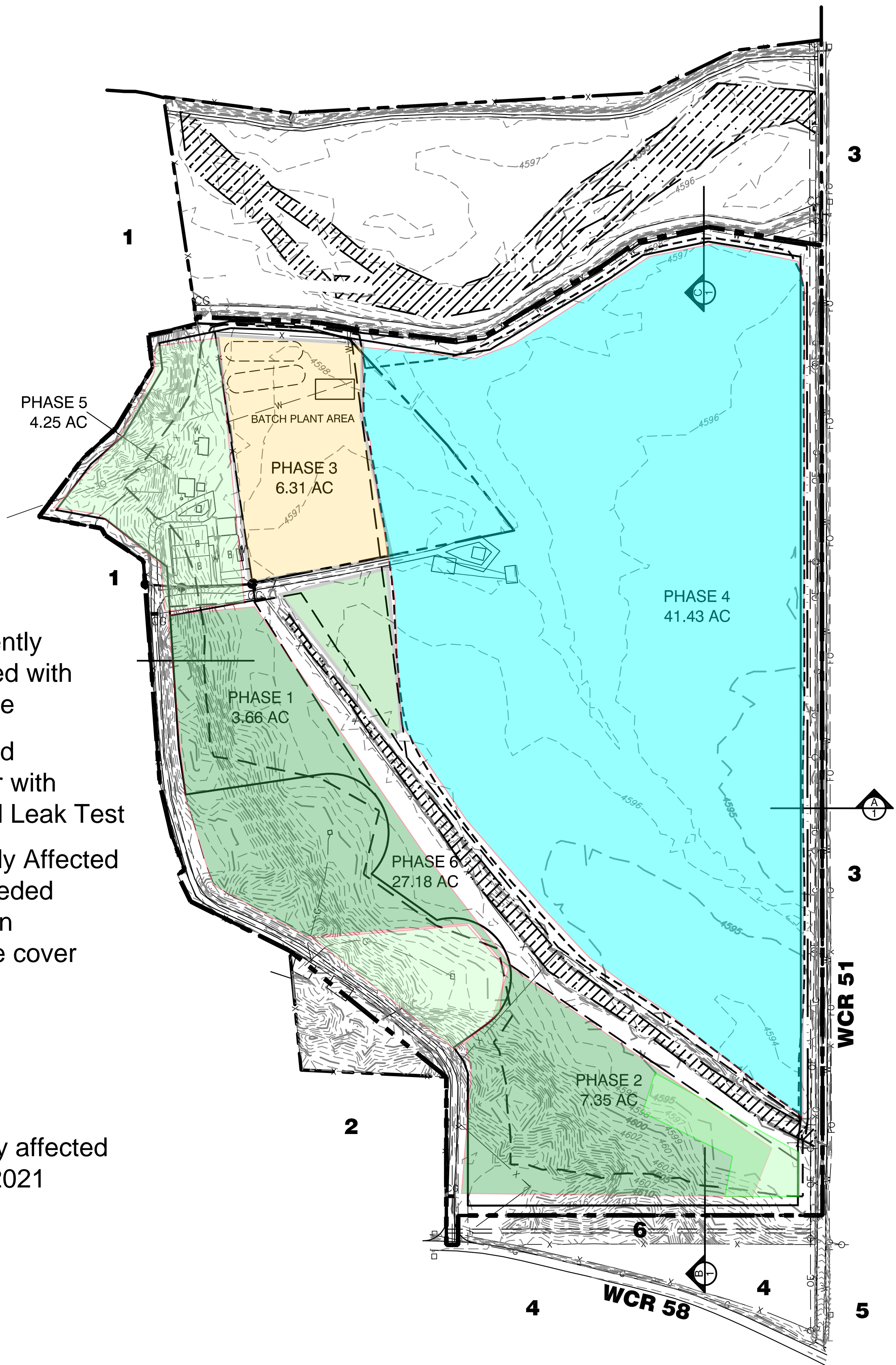

VEGETATION NOTE:
ALL NON-WETLAND AREAS ARE HISTORICALLY IRRIGATED PASTURE GRASSES. VEGETATIVE SPECIES ARE PRIMARILY WESTERN WHEATGRASS, SALT GRASS, SWEET CLOVER, AND KOCHIA.

TOTAL PERMIT AREA = 83.00 AC
TOTAL MINING AREA = 68.61 AC

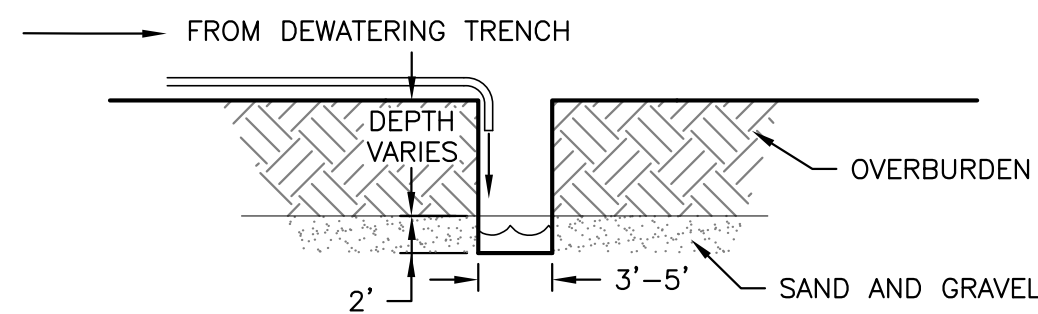
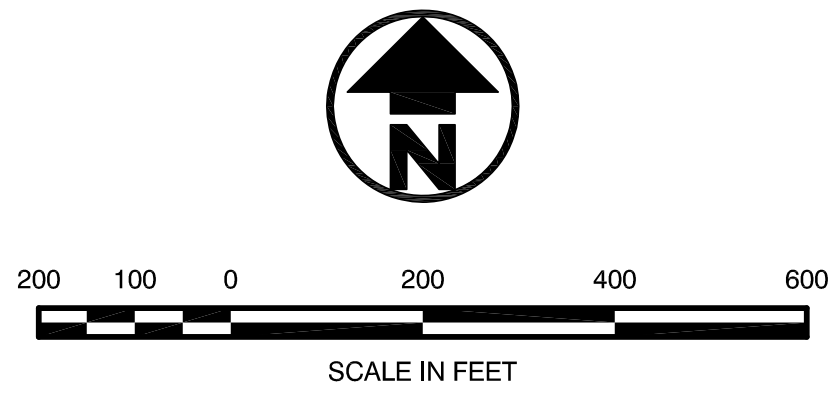

RECHARGE DITCH DETAIL

RECHARGE NOTE:
RECHARGE DITCH TO BE INSTALLED / OPERATED AROUND PERIMETER OF OPEN MINING AREA(S) AS NEEDED TO RECHARGE SURROUNDING ALLUVIAL AQUIFER.

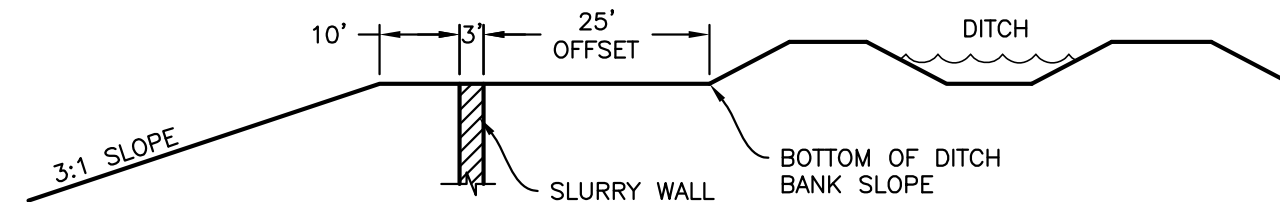

SOUTH BRANCH PLUMB DITCH OFFSET DETAIL

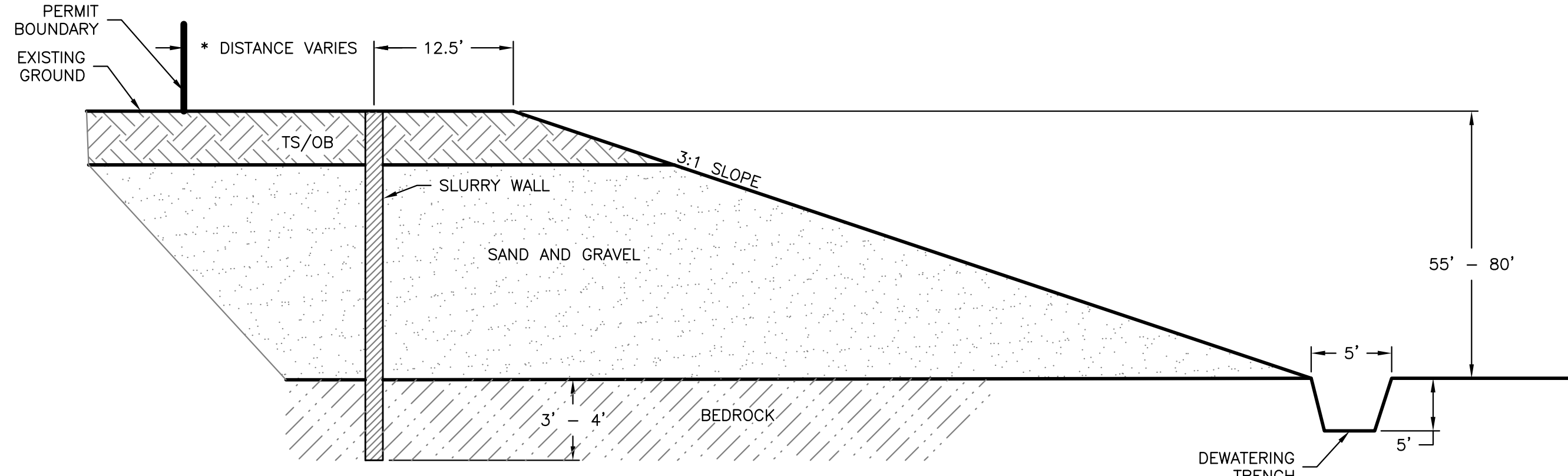

TYPICAL MINING SECTION
N.T.S.

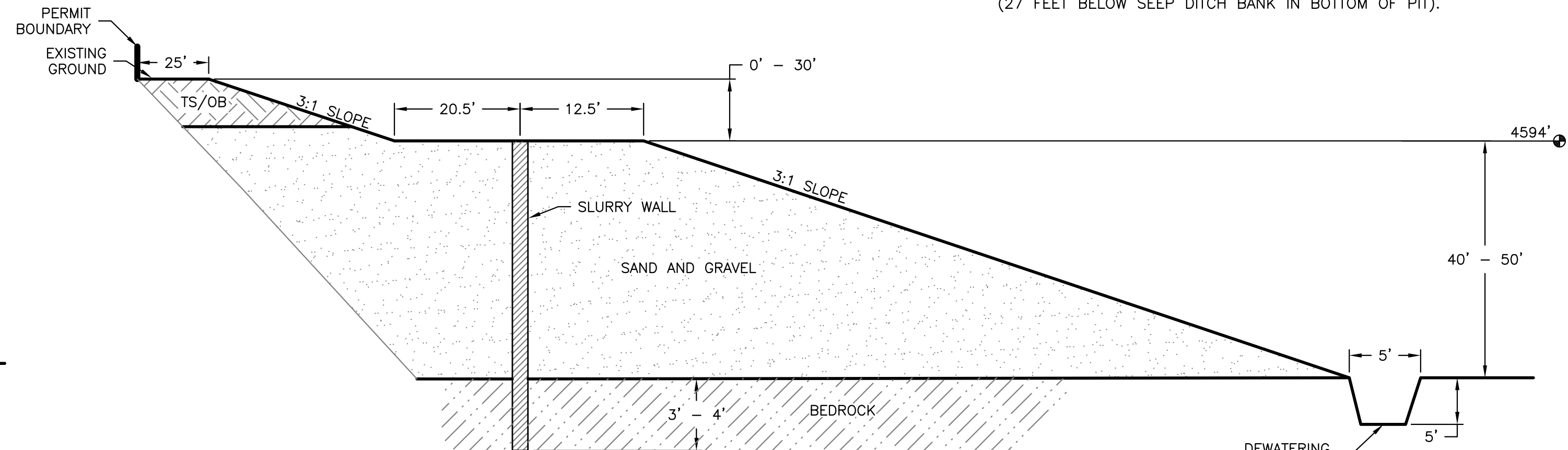

TYPICAL MINING SECTION
N.T.S.

LEGEND:

- UTILITY POLE
- GUY WIRE
- GAS LINE MARKER
- GAS VALVE
- WELL
- WATER METER
- WATER FAUCET
- WATER LINE MARKER
- ELECTRIC TRANSFORMER
- TREE
- TELEPHONE PEDESTAL
- TELEPHONE LINE MARKER
- PROPERTY LINE
- EXISTING FENCE LINE
- EXISTING GAS
- EXISTING WATER LINE (CENTRAL WELD COUNTY WATER DISTRICT)
- EXISTING FIBER OPTIC
- EXISTING OVERHEAD ELECTRIC
- EXISTING CONTOURS (1' INTERVALS)
- GRAVEL ROAD
- PROPOSED PERMIT BOUNDARY
- PROPOSED MINING LIMIT
- CONSTRUCTED SLURRY WALL
- PROPOSED SLURRY WALL
- PHASE LIMIT
- STOCK PILE AREA
- RECHARGE DITCH
- WETLAND BOUNDARY

PROPERTY OWNERS WITHIN 200 FEET: ASSESSORS I.D. NO.

| | | |
|---|---|------------------------------|
| 1 | JAMES DAVID & BETSY ANN KLEIN 28465 WELD COUNTY ROAD 49.5 GREELEY, CO 80631 | 096307200024 096307400023 |
| 2 | SCOTT HUFF 24725 WELD COUNTY ROAD 58 GREELEY, CO 80631 | 096307400022 |
| 3 | LOWER LATHAM RESERVOIR COMPANY P.O. BOX 398 KERSEY, CO 80644 | 096308000022 096308000023 |
| 4 | HELEN D PUYPE 24566 WELD COUNTY ROAD 58 GREELEY, CO 80631 | 096318000023 |
| 5 | PATRICIA H SCHAUMBERG - TRUST NO 1 P.O. BOX 2414 CAREFREE, AZ 85377 | 096317000046 |
| 6 | ARCHAEOLOGICAL CONSERVANCY 1717 GIRARD BLVD NE ALBUQUERQUE, NM 87106-1718 | 096307400003 |

NOTES:

- THE MINING LOCATIONS ARE CONCEPTUAL, THEIR SIZE AND SHAPE MAY VARY SLIGHTLY DUE TO SITE CONDITIONS.
- PHASES 1, & 11A WILL CONSIST OF MINING 5.81 AC TO ELEVATIONS OF 4592 AND 4597 RESPECTIVELY. GROUNDWATER WILL NOT BE EXPOSED DURING PHASES 1 & 11A.
- PHASE 2 WILL CONSIST OF MINING TO AN ELEVATION OF 4568 (27 FEET BELOW SEEP DITCH BANK IN BOTTOM OF PIT).

| REVISONS | | Description | |
|----------|---------|-------------|-----|
| No | Date | By | Chk |
| 1 | 3.19.15 | TPY | JCY |
| 2 | 9.11.15 | TPY | JCY |
| 3 | 9.12.16 | TPY | JCY |

| | |
|-------------|-----------|
| Job # | 07113 |
| Date | 9/15/08 |
| Drawn By | WSS |
| Designed By | TPY |
| Checked By | JCY |
| File | JT-Mining |
| Scale | 1" = 200' |