



STATE OF
COLORADO

Reilley - DNR, Robin <robin.reilley@state.co.us>

Adq Preliminary SL25 trapper Mine

1 message

Reilley - DNR, Robin <robin.reilley@state.co.us>

Wed, Jan 10, 2024 at 9:25 AM

To: Graham Roberts <graham.roberts@trappermine.com>, Robin Reilley - DNR <robin.reilley@state.co.us>

Graham,

Please find the attached preliminary adequacy questions for Trapper's SL25 phase I bond release application.

Thank you

Robin Reilley, M.S. GISP
Environmental Protection Specialist II



COLORADO
Division of Reclamation,
Mining and Safety
Department of Natural Resources

P [303.866.3567](tel:303.866.3567) ext 8105 |

F [303.832.8106](tel:303.832.8106)

Physical Address: 1313 Sherman Street St., Suite 215, Denver, CO 80203

Mailing Address: DRMS Room 215, 1001 E 62nd Ave, Denver, CO 80216

robin.reilley@state.co.us | <http://mining.state.co.us>



ADQ#1_Trapper_SL25_2024Jan.pdf

375K



COLORADO
Division of Reclamation,
Mining and Safety
Department of Natural Resources

Graham Roberts
Environmental Supervisor
Trapper Mining Inc.
P.O. Box 187
Craig, CO 81626

10 January 2024

Re: Trapper Mine Inc; Permit C1981010
DRMS Preliminary Adequacy Review of Bond Release Request SL25

Dear Mr. Roberts:

The Division has completed its preliminary adequacy review of Trapper Mine's SL25 bond release request received by the Division on 21 December 2023. The adequacy review comprised a review of pertinent rules, the submitted application and maps.

Adequacy issues are numbered in italics below. Analysis of the the rules and maps provided with the bond release application generated the following questions.

Rule 3.03.2(1) Notice to Entities

Copies of certified notice of mailings were submitted with the application.

Map1 sheets 1 and 2

1. *Acres for parcel DAB23 is listed as 284.9 acres in the text portion of the submission and as 294.8 acres on Map 1. Please clarify the acreage and submit any revised pages or maps as required reflecting the correct acreage.*

DRMS was unable to locate a depiction of parcel EAB08 (listed as 1.2 acres in the application text) on the map as referenced in the text.

2. *Please depict this parcel on the applicable map and provide as a revised map.*
3. *The following illustration highlights a parcel that is unidentifiable to DRMS as it lands on the seam between the two map sheets. Please clarify the parcel nomenclature on Map sheet 1 and associated acres with a revised map, possibly utilizing a call out block for visibility.*



4. Please describe the reason for the cutout of parcel DAB23.
5. Please address the backfilling, grading and topsoiling timeline of this cutout and the plan for utilization of the E79-6 22B topsoil pile.

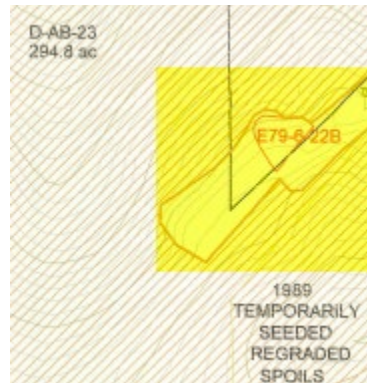

Rule 3.03.2(1)(b)(c) Publication

DRMS notes that the newspaper publication as presented in the application references the publication associated with the SL24 application as to the dates published, the type of phased bond release and the description of the specific location of the parcels requested for release.

6. Please submit the proof/ republish of publication that corresponds to the example public notice submitted with the application that was proposed to be published between 10 November and 1 December 2023.

DRMS received the correct notice of publication from the operator.

Please respond to these preliminary adequacy questions at your earliest convenience so that the inspection data for an aerial inspection can be prepared in advance of the inspection.

Sincerely,

Robin Reilley, M.S. GISP
Environmental Protection Specialist II
Robin.reilley@state.co.us