

C-2 Mining Map
Ewing Gravel Pit

DRMS Permit Number: N/A

BURNCO dba Bestway Concrete

Mine Entry Location:	Latitude: -104.810927	Longitude: -104.810927
State: COLORADO	County: Weld	Nearest Town: Fort Lupton
Section: 36	Township: 2N	Range: 68W
Major Watershed:	South Platte River	MSHA ID: ---

Map Scale: 1"=200'

Map Georeferencing Information: Datum: NAD83 Projection: CO NORTH

Survey Source: ---	Drawn by: SAC	Date: 01/18/23
Imagery Source: GoogleEarth	Checked by: BEL	Date: ---
Survey Date: ---	Approved by: BEL	Date: ---
Imagery Date: 6/9/2017		

File Name: Ewing Gravel-Maps 231031

L Lewicki & Associates

3375 West Powers Circle
Littleton, CO USA 80123

(303)-346-5196 info@lewicki.biz

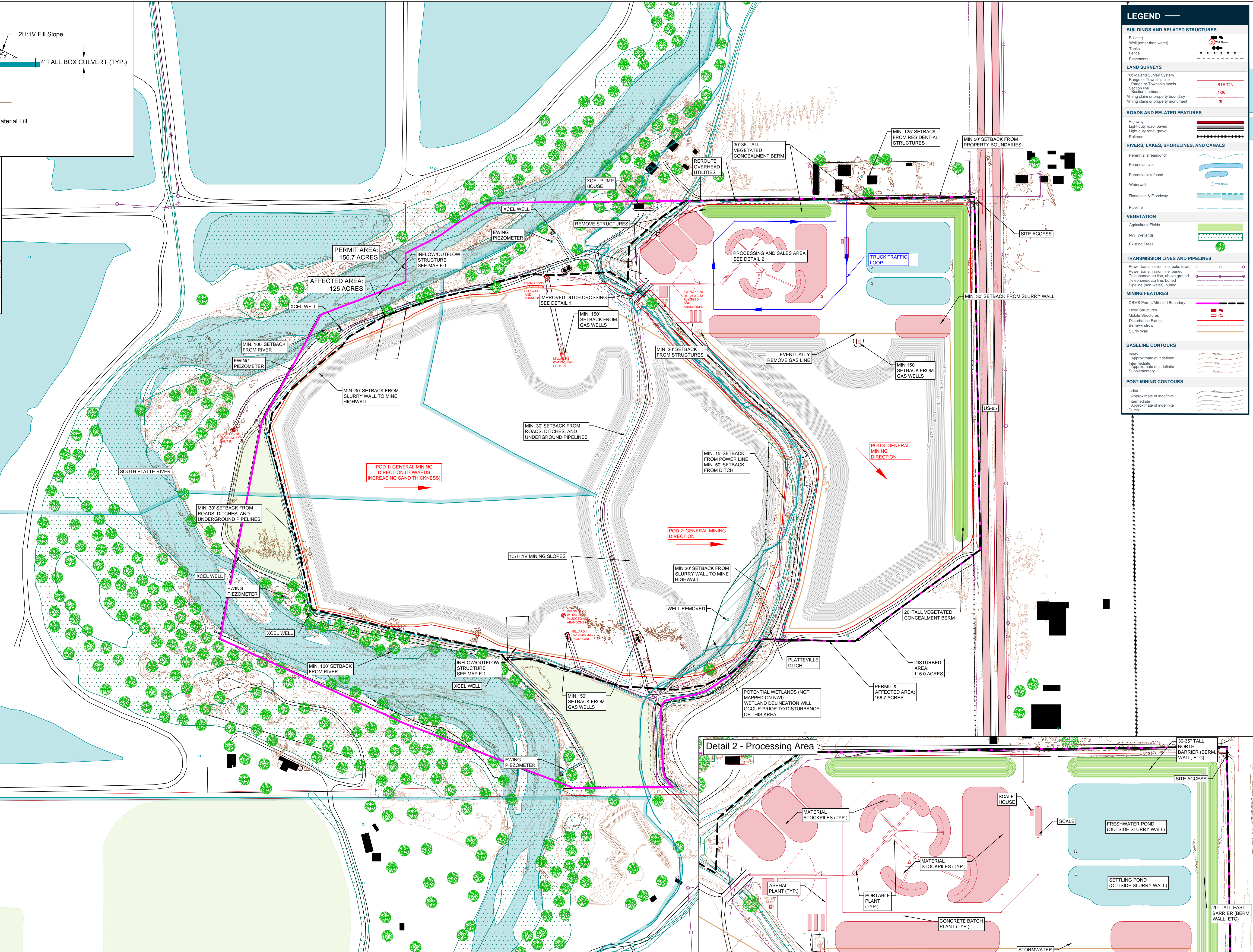

LEGEND

BUILDINGS AND RELATED STRUCTURES

- Building
- Well (other than water)
- Tanks
- Fence
- Easements

LAND SURVEYS

- Public Land Survey System
- Range or Township line
- Range or Township labels
- Section line
- Section numbers
- Mining claim or property boundary
- Mining claim or property monument

ROADS AND RELATED FEATURES

- Highway
- Light duty road, paved
- Light duty road, gravel
- Railroad

RIVERS, LAKES, SHORELINES, AND CANALS

- Perennial stream/ditch
- Perennial river
- Perennial lake/pond
- Waterwell
- Floodplain & Floodway
- Pipeline

VEGETATION

- Agricultural Fields
- NWI Wetlands
- Existing Trees

TRANSMISSION LINES AND PIPELINES

- Power transmission line, pole, tower
- Power transmission line, buried
- Telephone/data line, above ground
- Telephone/data line, buried
- Pipeline (non-water), buried

MINING FEATURES

- DRMS Permit/Affected Boundary
- Fixed Structures
- Mobile Structures
- Disturbance Extent
- Berm/windrow
- Slurry Wall

BASELINE CONTOURS

- Index
- Approximate of indefinite
- Intermediate
- Approximate of indefinite
- Supplementary

POST-MINING CONTOURS

- Index
- Approximate of indefinite
- Intermediate
- Approximate of indefinite
- Dune

RPTR 2
T-1 LINES

NOTICE

THIS SITE IS THE LOCATION OF A PROPOSED CONSTRUCTION MATERIALS OPERATION. BURNCO COLORADO, LLC, WHOSE ADDRESS AND PHONE NUMBER IS 10100 DALLAS STREET, HENDERSON, CO 80640, (720) 682-1124, HAS APPLIED FOR A REGULAR 112 CONSTRUCTION MATERIALS OPERATION RECLAMATION PERMIT AMENDMENT WITH THE COLORADO MINED LAND RECLAMATION BOARD.

ANYONE WISHING TO COMMENT ON THE APPLICATION MAY VIEW THE APPLICATION AT THE WELD COUNTY CLERK AND RECORDER'S OFFICE; 1250 H STREET, GREELEY, CO 80631, AND SHOULD SEND COMMENTS PRIOR TO THE END OF THE PUBLIC COMMENT PERIOD TO THE DIVISION OF RECLAMATION, MINING, AND SAFETY, 1313 SHERMAN ST., ROOM 215, DENVER, COLORADO 80203.