

MORGAN SAND AND GRAVEL, INC.
21215 HWY. 52
FORT MORGAN, CO 80701
970-867-8074
PLANT 3 MILES NORTH OF FORT MORGAN ON HIGHWAY 52

December 5, 2023

Division of Reclamation, Mining & Safety
1313 Sherman Street, Room 215
Denver, CO. 80203

Morgan Sand & Gravel
Permit # M 1977 094
E-Permit # 190639
Fort Morgan, CO. 80701
Morgan County

Annual Report

Morgan Sand & Gravel stripped off around 10,000 yards of overburden in phase2 And all of phase 4, some of phase 1 on the South end of pit. MS&G crushed around 250,000 ton of Class 6 base with 83,000 ton of that amount going to Class 7 base. All of Class 7 base is in A stockpile in phase 1. Most of Class 6 was sold for different job's .

MS&G will crush around not as much in 2024 just depends on different jobs that come in. We are to the property line on phase 4 so in the proses of purchasing land. Looking at around 25-30 acers to the North and East.

Going to try and reseed some of the pit on the West side. Have and see if weather will Help out.

The Green lines on map show the arear we crushed this year
Burde

All Top Soil and Overburden was seeded

Respectfully, Morgan Sand And Garvel

Greg Westhoff
Owner
970-867-8074 Office
970-768-0781 Cell

morgansandandgravel@kci.net

Pre-mine/Mine PlanMap, Phases 1-6

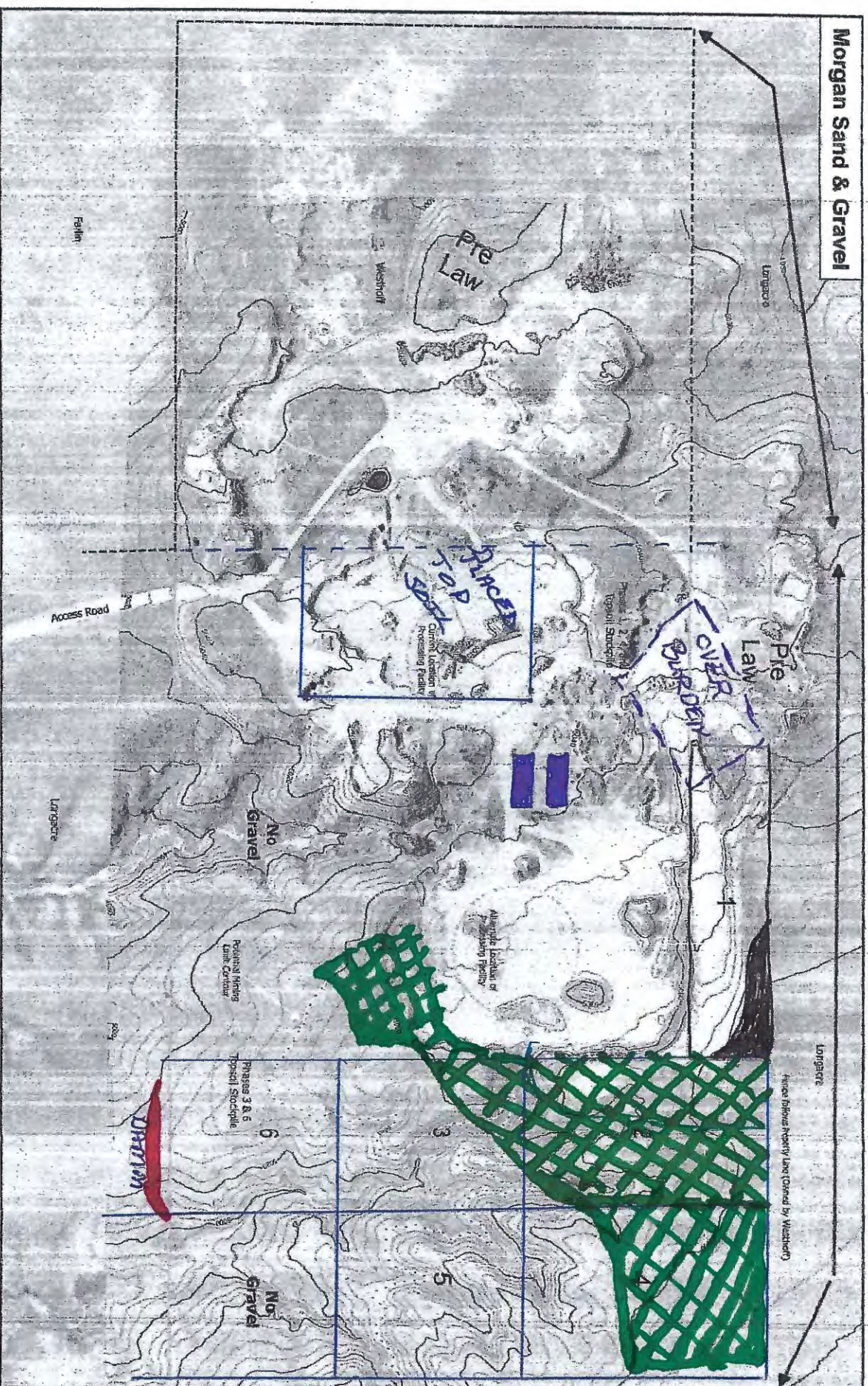

Legend

- 5 Foot Contours (Original)
- 20 ft Contours (Original)
- Water
- Fences
- Permit Boundary
- Phase Boundary
- Property Line

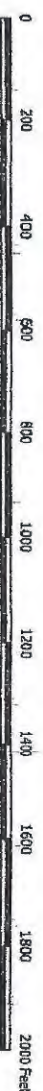

Phase 1-6
 Westhoff
 Longacre
 20 April 2017