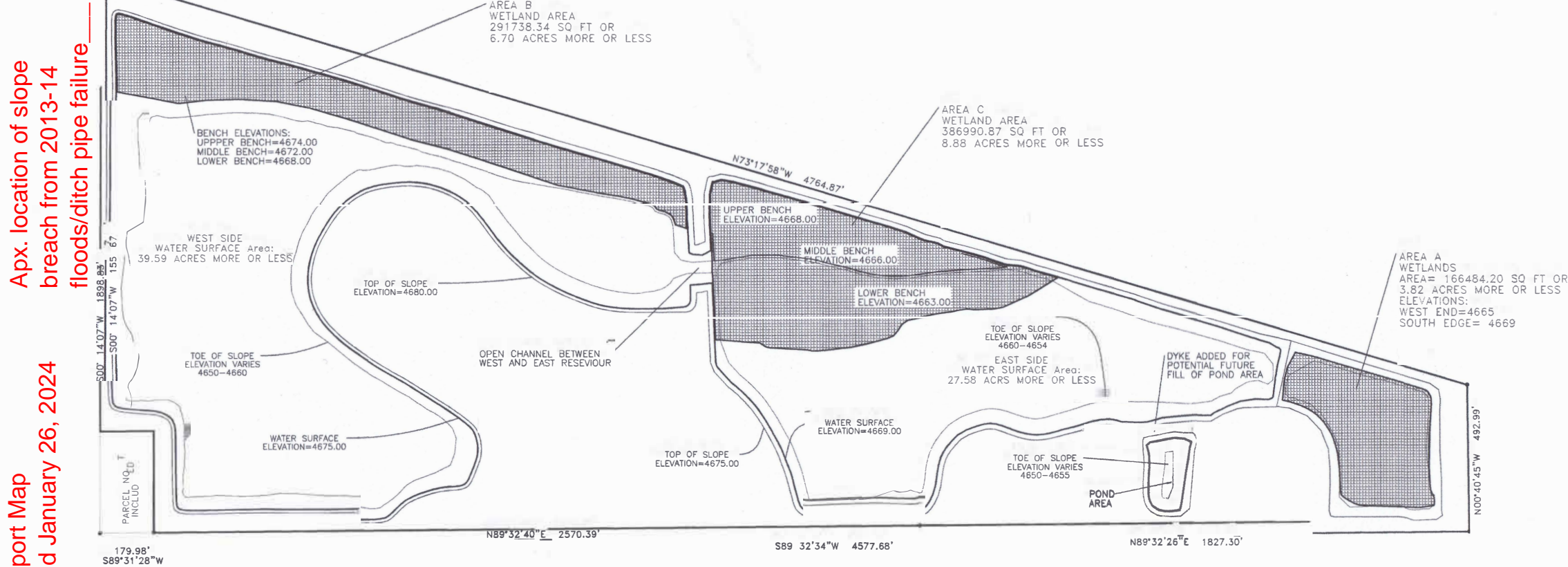

Exhibit F - Reclamation Plan
M-1992-069 - 83rd Joint Venture
Technical Revision

FOR A PARCEL OF LAND LOCATED
IN THE SOUTH HALF OF
SECTION 35, TOWNSHIP 6 NORTH,
RANGE 66 WEST OF THE 6TH P.M.
COUNTY OF WELD
STATE OF COLORADO.



TOTAL SITE ACREAGE: 124.09 +/-
WATER SURFACE ACRES: 67.17 +/-
WETLAND MITIGATION ACRES: 19.40 +/-
UPLAND (site perimeters and
future development areas): 37.52 +/-

PREPARED FOR:
AGGREGATE INDUSTRIES
1707 COLE BLVD. SUITE 100
GOLDEN, CO

PREPARED BY:
PHILIP THULLEY
PROFESSIONAL SURVEYOR
38006

This map is not intended to be used as a survey plat,
and the information shown hereon may not be used
for any other purpose beyond that
for which it was prepared and may not be used by
any party other than those to which it is certified.

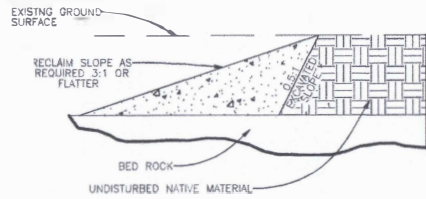

TYPICAL CROSS SECTION
(PRIOR TO BACKFILL)

NTS



Exhibit F
Reclamation Plan
M-1992-069 - 83rd
Joint Venture
Weld County



NO	DATE	BY	CHK'D	ON	REVISIONS
1	02MAR09	KPT			ADJ FOR 1A17 PLOT
2	11JUL11	KPT			DO TOE AND BRECH. RESCALE
3	07L11	KPT			REVISE AREA STATEM ENT

Date: 23SEP08
Job No:
Drawn: K. THULLEY
Checked:
Scale: 1:200