

# EXHIBIT C – PRE-MINING & MINING PLAN MAPS

Meeker Sand & Gravel: M-1976-038

Mining has been active in the current permitted area since 1976, under several different owners. Mining was begun prior to initiation of reclamation laws in 1977 and for much of the disturbance of the original permitted area, topsoil and overburden were stripped together. No accurate map was made of the pre-mining site, however Map C-1 shows the site as it was surveyed and drawn in the 1990's based on mapping at that time.

Map C-2 shows all mining which has occurred through May 2023 and what is planned for continued mining to extract all possible reserves remaining along the edges. Currently, 49.85 acres are affected. To date 20.59 acres have been released. The map also shows 11.51 acres we are requesting to be left un-reclaimed following completion of mining for use of the batch plant, office/scales, shop, equipment/truck/vehicle parking and ancillary buildings. We had previously received approval through TR-1 to allow 11 acres to remain for industrial use following mining. We are requesting an additional 0.51 acres through this amendment to allow for us to align the area in a way that makes sense for continued, long-term use of the area and allows for adequate room for continued operations.

Map C-3 shows the proposed expansion section in its current pre-mining state. It includes adjoining surface owners, topography, power lines, roads, fences and other structures within 200' as well as acreages. It should be noted that mining did occur in the new section nearly a century ago by another entity on the far west side of the proposed expansion section. There have also been some piles that were removed which existed from when Bob Dearman operated the mine. These areas are indicated on the map. Exhibit C-4 shows evidence of some mining that has occurred in the past when pit was under ownership of previous operators. These areas where mining had occurred previously are also shown on Map C-3. One area is outside the mine permit boundary to the west and will remain in its current condition.

Existing vegetation on the proposed site falls within several range sites and appears to be presently in a relatively native condition. The dominant species found on the site was western wheatgrass. Other principal species found on the site were Sandberg bluegrass, Nevada Bluegrass, Letterman needle grass, big sagebrush and snakeweed. Other species found on the site include fringe sage, phlox and numerous forbs. Vegetation cover is approximately 25 percent, with an annual production of about 1200 pounds/acre air dry.

Exhibit C-5 shows vegetation in its current, natural state on the proposed site. Vegetation is sporadic, with minimal topsoil naturally available in some areas. Current vegetation map is included as Exhibit C-6.

## Meeker Sand &amp; Gravel: M-1976-038

*Mining Plan  
Meeker Sand And Gravel  
Meeker, Colorado*

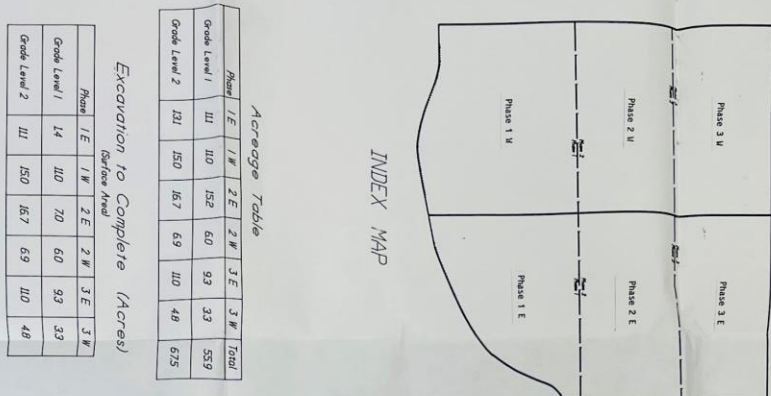

Base Elevations	
Grade Level 1 -	6575.0 55.9 Acres
Grade Level 2 -	6565.0 67.5 Acres

Scale 1" = 200'

CHUCK WHITEMAN AND ASSOCIATES  
LAND SURVEYORS  
P.O. BOX 997 1107 MARKET  
MEEBER COLORADO 81641

*Mining Plan  
Meeker Sand and Gravel  
Meeker, Colorado  
Exhibit "C"*

**EXHIBIT C-2 – CURRENT MINING MAP**

Meeker Sand & Gravel: M-1976-038

**EXHIBIT C-3 – PRE-MINING MAP OF PROPOSED EXPANSION**  
Meeker Sand & Gravel: M-1976-038



### **EXHIBIT C-3 – PRE-MINING / CURRENT VEGETATION**

Photos showing proposed expansion area in its current, pre-mining state.



### **EXHIBIT C-3**

Meeker Sand & Gravel: M-1976-038

Photos showing proposed expansion area in its current, pre-mining state.





## **EXHIBIT C-4**

Meeker Sand & Gravel: M-1976-038

Photos showing evidence of historical mining that has previously occurred under different operatorship.





## **EXHIBIT C-4**

**Meeker Sand & Gravel: M-1976-038**

Photos showing evidence of historical mining that has previously occurred under different operatorship.





## EXHIBIT C-5

Meeker Sand & Gravel: M-1976-038

Photos showing vegetation in current, natural state. Vegetation is sporadic, with minimal topsoil naturally available in some areas.



**EXHIBIT C-6**

Meeker Sand & Gravel: M-1976-038

**VEGETATION MAP**