

OWNERSHIP WITHIN 200 FEET
AND AFFECTED LANDS

COLORADO ROSE RED, INC.
148 CHEYENNE CT.
LYONS, CO 80540

COLORADO ROSE RED, INC.

COLORADO ROSE RED STONE RESOURCE

PERMIT # M-1978-332

ANNUAL REPORT MAP 2023

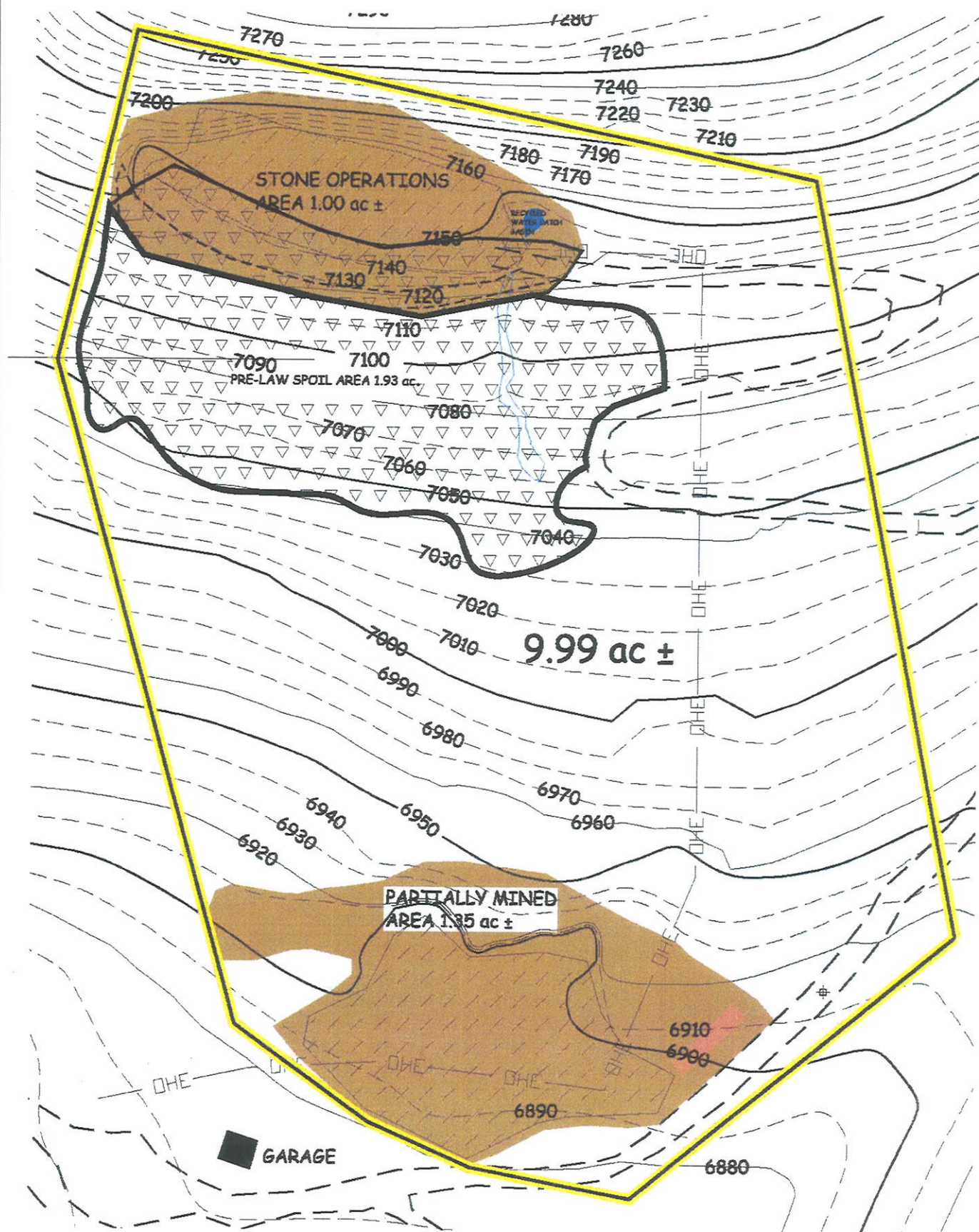

LEGEND

- PERMIT LINE/AFFECTED LANDS
- ROADS
- OHE OVERHEAD POWER LINE
- PARTIALLY MINED AREA
- PRE-LAW SPOIL AREA
- PROCESSING AREAS
- SOIL PILE



SCALE 1"=100'
CONTOUR INTERVAL: 10 FEET

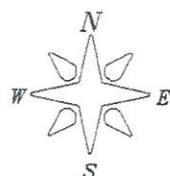

PREPARED BY: ENVIRONMENT, INC.
7985 VANCE DR., # 205A
ARVADA, CO 80003
(303) 423-7297

VERSION DATE: OCT 13, 2022 - 10:22:16

PART OF THE SE/4 NE/4, SECTION 33, TOWNSHIP 4 NORTH,
RANGE 71 WEST, 6TH P.M., LARIMER COUNTY, COLORADO