

**FORREST MINING PROJECT  
AMAZONITE MINING, LLC**

**HARD ROCK / METAL MINING  
LIMITED IMPACT OPERATION (110(2))  
RECLAMATION PERMIT**

**2023  
ANNUAL REPORT MAP**

**PERMIT NUMBER M-2017-012**

**LEGEND**

- == == == == FOREST SERVICE ROAD 273
- ACCESS ROUTE CURRENTLY USING
- ..... ACCESS ROUTE PROPOSED
- DRMS PERMIT BOUNDARY
- ▨ ACTIVE MINING AREA
- ▩ OVERBURDEN SPOIL PILE
- TOPSOIL SPOIL PILE
- ▧ GROWTH MEDIUM SPOIL PILE
- ▲▲▲▲ SILT FENCE PLACEMENT
- ▩ RECLAIMED AND REVEGETATED AREA

**NOTES:**  
1. PORTIONS OF AREA 4 AND AREA 5 WILL BE RE-SEEDED THIS FALL.

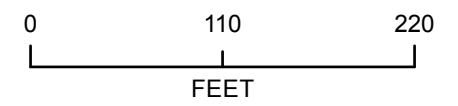
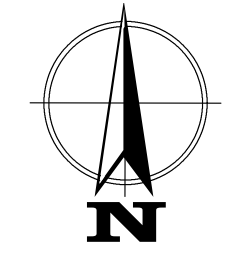
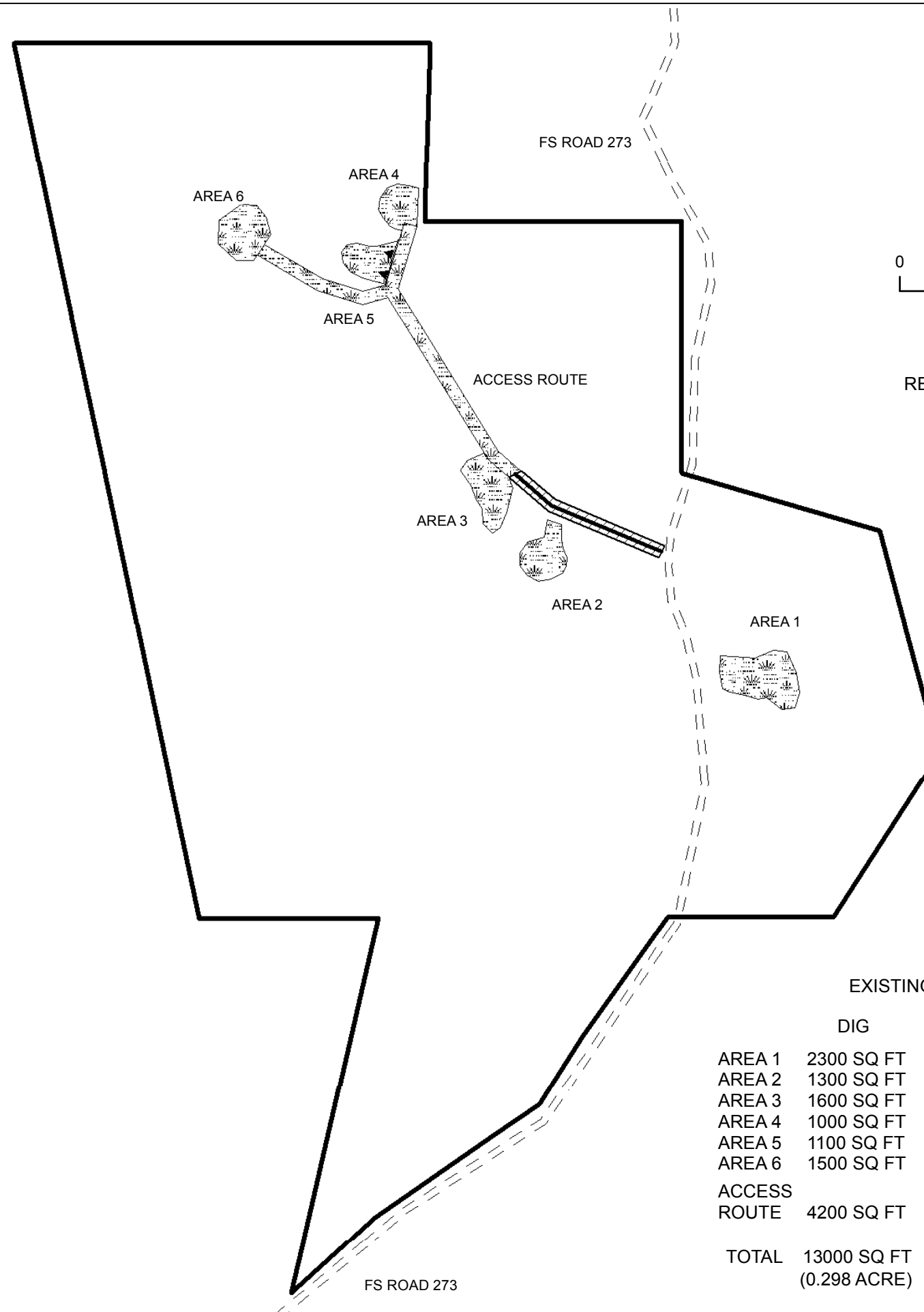

1 INCH = 110 FEET

REVISED SEPTEMBER 6, 2023

	EXISTING DISTURBANCES			
	DIG	OVER BURDEN	GROWTH MEDIUM	TOPSOIL
AREA 1	2300 SQ FT	000 SQ FT	000 SQ FT	000 SQ FT
AREA 2	1300 SQ FT	000 SQ FT	000 SQ FT	000 SQ FT
AREA 3	1600 SQ FT	000 SQ FT	000 SQ FT	000 SQ FT
AREA 4	1000 SQ FT	000 SQ FT	000 SQ FT	000 SQ FT
AREA 5	1100 SQ FT	000 SQ FT	000 SQ FT	000 SQ FT
AREA 6	1500 SQ FT	000 SQ FT	000 SQ FT	000 SQ FT
ACCESS ROUTE	4200 SQ FT			
<b>TOTAL</b>	<b>13000 SQ FT</b>	<b>0000 SQ FT</b>	<b>0000 SQ FT</b>	<b>0000 SQ FT</b>
	(0.298 ACRE)			