



COLORADO

Division of Reclamation,
Mining and Safety

Department of Natural Resources

MINERALS PROGRAM INSPECTION REPORT

PHONE: (303) 866-3567

The Division of Reclamation, Mining and Safety has conducted an inspection of the mining operation noted below. This report documents observations concerning compliance with the terms of the permit and applicable rules and regulations of the Mined Land Reclamation Board.

MINE NAME: Sheehan Pit	MINE/PROSPECTING ID#: M-2007-058	MINERAL: Sand and gravel	COUNTY: Moffat
INSPECTION TYPE: Monitoring	WEATHER: Clear	INSP. DATE: August 28, 2023	INSP. TIME: 14:00
OPERATOR: C&B Sand and Gravel Inc.	OPERATOR REPRESENTATIVE: Donald Corson	TYPE OF OPERATION: 110c - Construction Limited Impact	

REASON FOR INSPECTION: Citizen Complaint	BOND CALCULATION TYPE:	BOND AMOUNT: \$51,470.00
DATE OF COMPLAINT: NA	POST INSP. CONTACTS: None	JOINT INSP. AGENCY: None
INSPECTOR(S): Zach Trujillo	INSPECTOR'S SIGNATURE: 	SIGNATURE DATE: September 8, 2023

The following inspection topics were identified as having Problems or Possible Violations. OPERATORS SHOULD READ THE FOLLOWING PAGES CAREFULLY IN ORDER TO ASSURE COMPLIANCE WITH THE TERMS OF THE PERMIT AND APPLICABLE RULES AND REGULATIONS. If a Possible Violation is indicated, you will be notified under separate cover as to when the Mined Land Reclamation Board will consider possible enforcement action.

INSPECTION TOPIC: Gen. Compliance With Mine Plan

PROBLEM: The current mine plan needs to be updated and clarified pursuant to C.R.S. 34-32.5-112(1)(c)(VI). The operator must provide sufficient information to describe or identify how the operator intends to conduct the operation.

CORRECTIVE ACTIONS: The operator shall submit a Technical Revision, with the required \$216 revision fee, to update and clarify the current approved mine plan to reflect existing and proposed activities by the corrective action date. Specifically, the updated mine plan must describe what measures will be taken to stabilize the slope within the permit area and prevent off-site damage from occurring due to rock falls. If the proposed measures include the addition of any features or structures, an updated mining plan map showing the location of these features/structures must also be provided with the revision. The updated mining plan map must meet all requirements of Rules 6.2.1(2) and 6.3.5(2). Additionally, if any of the proposed features/structures are proposed to remain for reclamation, the operator will need to provide an updated reclamation plan and map addressing these features/structures. The updated reclamation plan map must meet all requirements of Rules 6.2.1(2) and 6.3.5(3).

CORRECTIVE ACTION DUE DATE: 10/08/23

GENERAL INSPECTION TOPICS

The following list identifies the environmental and permit parameters inspected and gives a categorical evaluation of each

(AR) RECORDS----- <u>N</u>	(FN) FINANCIAL WARRANTY----- <u>N</u>	(RD) ROADS----- <u>Y</u>
(HB) HYDROLOGIC BALANCE----- <u>N</u>	(BG) BACKFILL & GRADING----- <u>N</u>	(EX) EXPLOSIVES----- <u>N</u>
(PW) PROCESSING WASTE/TAILING---- <u>N</u>	(SF) PROCESSING FACILITIES----- <u>N</u>	(TS) TOPSOIL----- <u>N</u>
(MP) GENL MINE PLAN COMPLIANCE- <u>PB</u>	(FW) FISH & WILDLIFE----- <u>N</u>	(RV) REVEGETATION---- <u>N</u>
(SM) SIGNS AND MARKERS----- <u>Y</u>	(SP) STORM WATER MGT PLAN---- <u>N</u>	(RS) RECL PLAN/COMP-- <u>N</u>
(ES) OVERBURDEN/DEV. WASTE----- <u>N</u>	(SC) EROSION/SEDIMENTATION--- <u>Y</u>	(ST) STIPULATIONS----- <u>N</u>
(AT) ACID OR TOXIC MATERIALS----- <u>N</u>	(OD) OFF-SITE DAMAGE----- <u>Y</u>	

Y = Inspected / N = Not inspected / NA = Not applicable to this operation / PB = Problem cited / PV = Possible violation cited

OBSERVATIONS

This inspection was conducted by Zach Trujillo of the Colorado Division of Reclamation, Mining and Safety (Division) in response to a Citizen Complaint, CT-1. The Sheehan Pit is a 110c permitted site that includes a total of 8.76 acres in two parcels. The site located six and half miles southwest of Savory, WY and is accessed from Moffat County Road 1. Donald Corson (Operator) attended the inspection on behalf of the CB Sand and Gravel Inc. According to the Operator, the mine site prior to the inspection date had been inactive since the previous year.

The Division received the public complaint on August 15, 2023 by Moffat County. The nature of the complaint as provided is in regards to Off-Site Damage, Property Damage and Roads. The following is the detailed description of the potential issues as provided within the complaint:

"The mine is in a narrow canyon. As the rock is blasted and excavated there is an area where the material slides down the hill onto Moffat County Road 1. There are frequently 2 to 3 foot boulders falling onto the road. The road is also only 1 lane wide due to rocks sliding down the hill. I have contacted the owners numerous times and they have done nothing to alleviate the problem. The narrow road and falling boulders create a danger to the public traveling CR 1."

Prior to the inspection, the approved permit and associated maps were reviewed along with previous inspection reports (2018 and 2022). The Division georeferenced the approved Mining Plan Map (Figure 1.) within ArcGIS and uploaded to ArcGIS Field Maps (Field Maps) for use during the inspection. Field Maps is an all-in-one app that uses data-driven maps and mobile forms to help workers perform data capture and editing, find assets and information, and report their real-time locations with the use of GPS. This allowed the inspector to ensure he was able to document his location and any potential issues during the inspection with

respect to the approved limits of the disturbance boundary and permit boundary.

Based on surface observations during the inspection, the Sheehan Pit is located in a steep narrow canyon along Slater Creek comprised mostly of underlying weathered and erosive soils especially noted along the slope intersection with the County Road 1. Overlying these soils is loose rock at approximately angle of repose (Photo 1). Comparing the area of concern to native undisturbed adjacent areas within the canyon (Photo 2), it appears to the Division that the loose rock is from previously created disturbances with some degree of contribution from natural weathering and erosion. Overall, the site location is very steep and erosive. For use within this inspection report, the area observed during this inspection that had the potential for immediate sloughing and/or rock fall in relation to County Road 1 as noted by the Division will be called the "Area of Concern" (AoC). Please refer to Figure 2 of this report for the location of the AoC.

During the inspection, the Operator discussed maintenance and repair work that occurred to County Road 1 as a result of cutting from Slater Creek. On August 30, 2023, the Operator provided photo documentation of the cutting that occurred along the outer creek embankment along County Road 1 (Photo 3). Based on the provided photos, it appears that the erosion impacted a portion of County Road 1. The Operator stated that during the road maintenance, road grading cut into the slope at the AOC which potentially compounded the issue and may have caused additional sloughing to occur. At the time of this inspection, road maintenance had concluded at County Road 1 (Photo 4).

The Division inspected the entire permit boundary along its intersection of Moffat County Road 1, mining limit boundary ("disturbance boundary" on Figures 1 and 2), and the current excavation areas for potential issues or violations associated with the complaint. Using Field Maps, the mentioned approved boundaries were traversed where safely possible and inspected for loose material and/or rock on Moffat County Road 1 and along the slope that has the potential to impact the road. At the time of the inspection, there was no rock located on Moffat County Road 1 however, rock was observed along the intersection of the slope and road ditch within the AoC (Photo 5). These rocks will need to be removed, which the Operator committed to doing during the inspection. At the request of the Division, the Operator also stated that any rocks immediately above the slope and road intersection that had the potential to impact the road would be removed as well.

Using Field Maps, the Division compared the AoC with the approved mining permit (Figures 1 and 2). The Division also inspected the active mining locations along with the review of previous Division inspection reports. Based on this inspection and previous inspection reports, no mining activity outside of the mining limits was or could be observed. Additionally, based on discussions with the Operator, the site has been inactive since 2022. Comparing this information along with the location of the AoC, it does not appear to the Division that the rock fall or sloughing is caused directly from current mining activities but from the current loose conditions of the slope along with seasonal precipitation and snow melt. With that said, the AoC is within the limits of the approved mining permit (Photos 6 and 7) and needs to be stabilized. Per Rule 3.1.6(3), all surface areas of the affected land, including spoil piles, shall be stabilized and protected so as to effectively control erosion. Additionally, per Rule 6.3.3(I), [the mining plan must] describe what measures will be taken to minimize disturbance to the hydrologic balance, prevent off-site damage, and provided for a stable configuration of the reclaimed area consistent with the proposed future land use. Based on the observations of this inspection, additional measures are necessary within the permit to ensure all Rules and Requirements are met by the Sheehan Pit. Therefore, a problem is cited in this report (see page 1), requiring the operator to submit a Technical Revision with an updated mining plan that describes what measures will be taken to stabilize the slope within the permit area and prevent off-site damage from occurring due to rock falls.

Figures

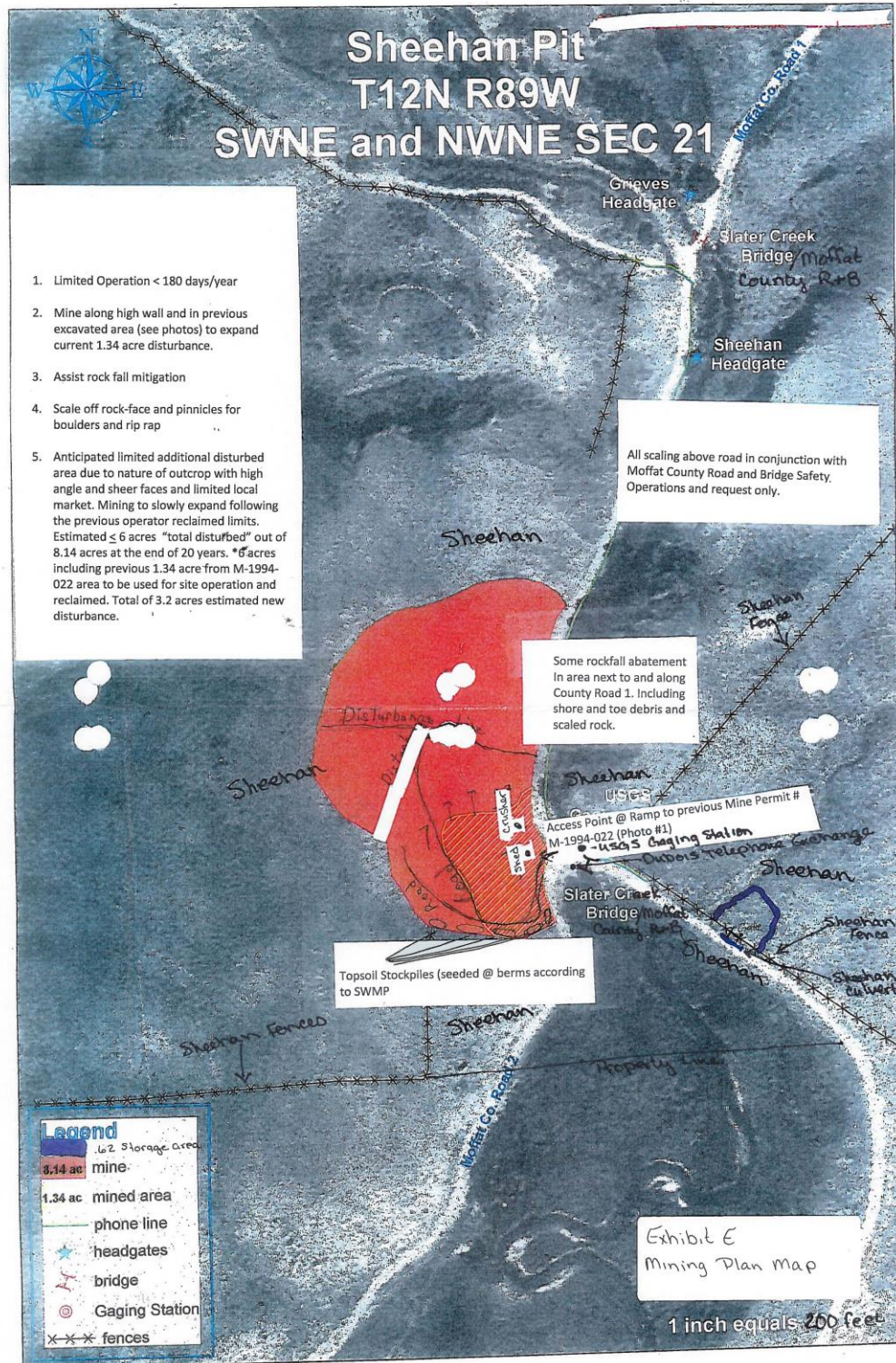

Figure 1. Approved Exhibit E – Mining Plan Map

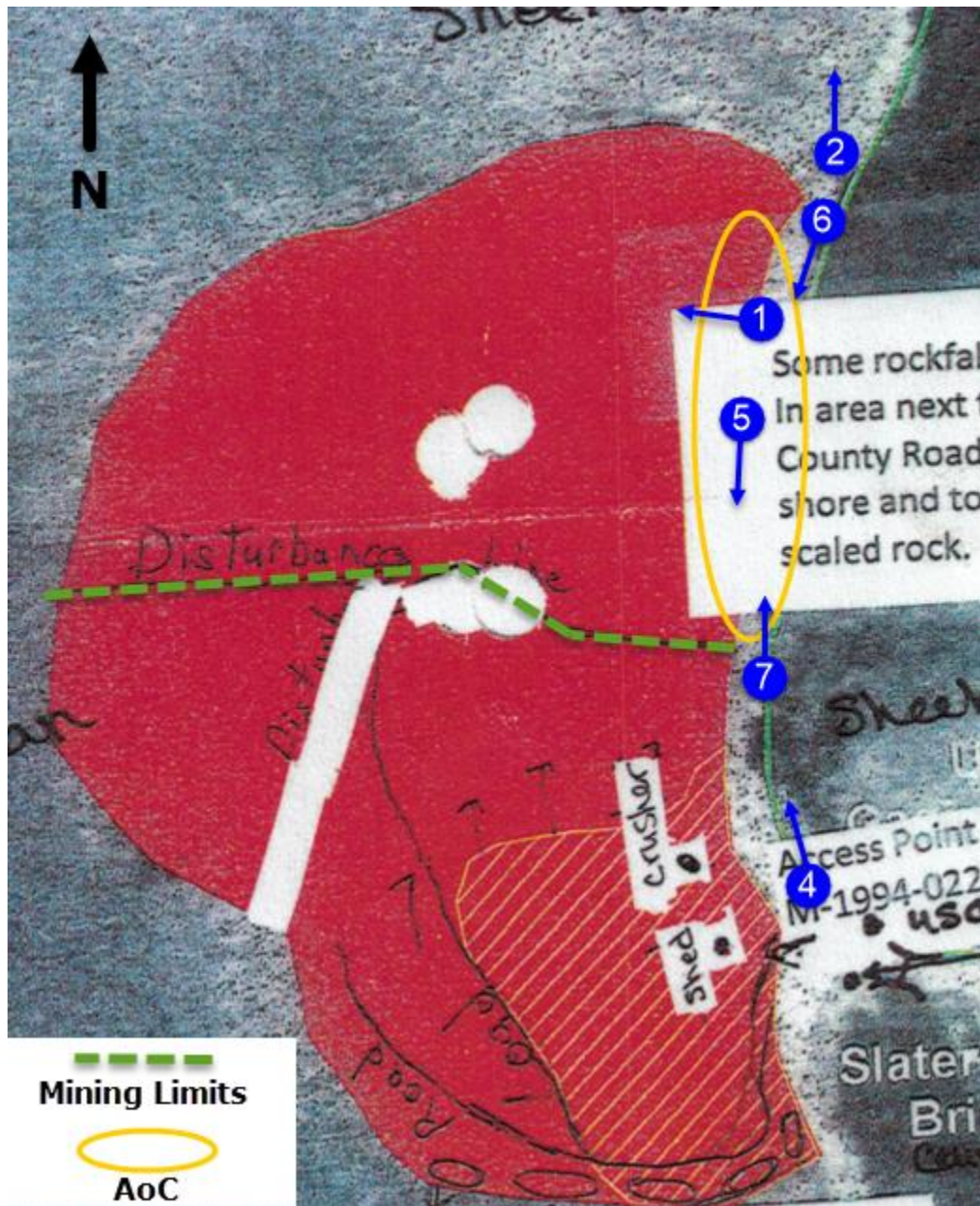

Figure 2. Photo location and direction.

Photographs



Photo 1.



Photo 2.



Photo 3.



Photo 4.



Photo 5.



Photo 6.



Photo 7.

Inspection Contact Address

Donald Corson
C&B Sand and Gravel Inc.
PO Box 147
Baggs, WY 82321

Enclosure

CC: Amy Eschberger, DRMS
Dan Miller, Moffat County