



STATE OF  
COLORADO

Wein - DNR, Clayton <clayton.wein@state.co.us>

---

## Roadside Mine, C-1981-041, June Complete Inspection Report

1 message

---

**Wein - DNR, Clayton** <clayton.wein@state.co.us>  
To: Tonya Hammond <tonya.snowcap@bresnan.net>

Fri, Jul 7, 2023 at 10:14 AM

Good morning Tonya,

Attached is the Division's report for the complete inspection of the Roadside Mine conducted on June 22, 2023. Please feel free to contact me if you have any questions.

Sincerely,  
**Clayton Wein**  
Environmental Protection Specialist



**COLORADO**  
Division of Reclamation,  
Mining and Safety  
Department of Natural Resources

P 303.866.3567 x 8185 | F 303.832.8106  
1313 Sherman Street, Room 215, Denver, CO 80203  
[clayton.wein@state.co.us](mailto:clayton.wein@state.co.us) | <https://www.drms.colorado.gov>



**Roadside Mine, C-1981-041, June Complete Inspection Report.pdf**

710K



**PERMIT INFORMATION**

<b>Permit Number:</b> C-1981-041 <b>Mine Name:</b> Roadside Portals <b>Operator:</b> Snowcap Coal Company, Inc. <b>Operator Address:</b> MS Tonya Hammond P.O. Box 1430 Palisade, CO 81526	<b>County:</b> Mesa <b>Operation Type:</b> Underground <b>Permit Status:</b> Active <b>Ownership:</b> Private
	<b>Operator Representative Present:</b>  Tonya Hammond
<b>Operator Representative Signature: (Field Issuance Only)</b>  	

**INSPECTION INFORMATION**

<b>Inspection Start Date:</b> June 22, 2023 <b>Inspection Start Time:</b> 12:30 <b>Inspection End Date:</b> June 22, 2023 <b>Inspection End Time:</b> 13:50		<b>Inspection Type:</b> Coal Complete Inspection <b>Inspection Reason:</b> Normal I&E Program <b>Weather:</b> Clear	
<b>Joint Inspection Agency:</b>  None		<b>Joint Inspection Contacts:</b>  None	
<b>Post Inspection Agency:</b>  None		<b>Post Inspection Contacts:</b>  None	
<b>Inspector(s):</b>  Clayton Wein	<b>Inspector's Signature:</b>  <i>Clayton Wein</i>		<b>Signature Date:</b>  7/7/2023

**Inspection Topic Summary**

NOTE: Y=Inspected N=Not Inspected R=Comments Noted V=Violation Issued NA=Not Applicable

N - Air Resource Protection

R - Availability of Records

N - Backfill &amp; Grading

N - Excess Spoil and Dev. Waste

N - Explosives

N - Fish &amp; Wildlife

R - Hydrologic Balance

Y - Gen. Compliance With Mine Plan

N - Other

N - Processing Waste

N - Roads

R - Reclamation Success

N - Revegetation

N - Subsidence

N - Slides and Other Damage

N - Support Facilities On-site

R - Signs and Markers

N - Support Facilities Not On-site

N - Special Categories Of Mining

N - Topsoil

**COMMENTS**

This report documents the observations taken during a complete inspection of the Roadside Portals Mine on June 22, 2023. The inspection was completed by Clayton Wein of the Division. Tonya Hammond represented Snowcap Coal Company (SCC) during the inspection. The weather was clear with a temperature of 89 degrees F. The ground conditions were dry.

**AVAILABILITY OF RECORDS – Rule 5.02.4(1):**

The records for the Roadside Mine are located in Grand Junction, CO at the mine office. The records were well kept and up to date. Please see the Availability of Records form Attached to the end of this report for more details.

**HYDROLOGIC BALANCE - Rule 4.05**

Drainage Control 4.05.1, 4.05.2, 4.05.3; Siltation Structures 4.05.5, 4.05.6; Discharge Structures 4.05.7, 4.05.10; Diversions 4.05.4; Effluent Limits 4.05.2; Ground Water Monitoring 4.05.13; Surface Water Monitoring 4.05.13; Drainage – Acid and Toxic Materials 4.05.8; Impoundments 4.05.6, 4.05.9; Stream Buffer Zones 4.05.18:

The water monitoring point 016 was visited during the inspection. The operator had recently installed a solar powered meter on the discharge outlet (Photo 1). The outlet was discharging at a rate of 134 gallons per minute. This value is within the historical seasonal range of data collected at this site. The outfall discharge pipe was in good condition and no obstructions were observed.

The Division visited the permittee's new pump house located just off of the Cameo exit from Interstate 70. The pump house was installed to assist the operator with implementing their water augmentation plan as required by the Division of Water Resources. The pump house is located outside the current permitted boundary and is not a part of the permittee's mining permit with the Division. The permittee was required to update their mining permit text through a Minor Revision to document that the water augmentation plan was a requirement of another state agency. The pumps had been installed and were soon going to be tested for the first time.

No water was observed flowing in the landowner's trenches on the southern part of the Tract 70 Mesa. The trenches were dry indicating that there has been no recent water application to the area. The landowner's middle

Number of Partial Inspection this Fiscal Year: 9

Number of Complete Inspections this Fiscal Year: 4

field was also dry (Photo 2). The water conveyance pipes were not hooked up at the time of the inspection. The landowner's pipe at the head of the Tract 71 trench was not hooked up. The east (Photo 3) and north portions of the trench were dry indicating that there has been no recent water application to the ditch. The Carey pit, located in the southwestern portion of the permit area was also dry (Photo 4). There was no evidence of recent flow from the landowner's buried pipeline into the pit.

**RECLAMATION SUCCESS - Rule 4.15, Rule 3:**

The remaining disturbed area permitted at the Roadside Mine is approximately 0.4 acres located within the northwestern part of what is referred to as Tract 71. The reclamation and seeding of the area was completed in the fall of 2019. The site was stable with vegetative cover (Photo 5). There were no indications of erosional features. The straw waddle placed along the down gradient portion of the site were in good condition. There were no off-site impacts observed. The disturbed boundary is marked by several T-posts. The T-posts were intact and remained in the correct locations.

**SIGNS AND MARKERS – Rule 4.02:**

Mine Identification signs were observed marking the entrances to the permit area. The signs were posted in clearly visible locations. Information regarding the permit, the permittee and the Division were posted on the signs.

**DOCUMENTS RECEIVED: None**

**OTHER (SPECIFY): None**

Number of Partial Inspection this Fiscal Year: 9

Number of Complete Inspections this Fiscal Year: 4

**ENFORCEMENT ACTIONS/COMPLIANCE**

No enforcement actions were initiated as a result of this inspection, nor are any pending.

Number of Partial Inspection this Fiscal Year: 9

Number of Complete Inspections this Fiscal Year: 4

## **PHOTOGRAPHS**

Photo 1: The permittee's new solar powered meter for the 016 discharge point.



Photo 2: The Landowner's middle field. The photo was taken looking to the west.



Number of Partial Inspection this Fiscal Year: 9

Number of Complete Inspections this Fiscal Year: 4



Photo 3: The Landowner's east trench on Tract 71.

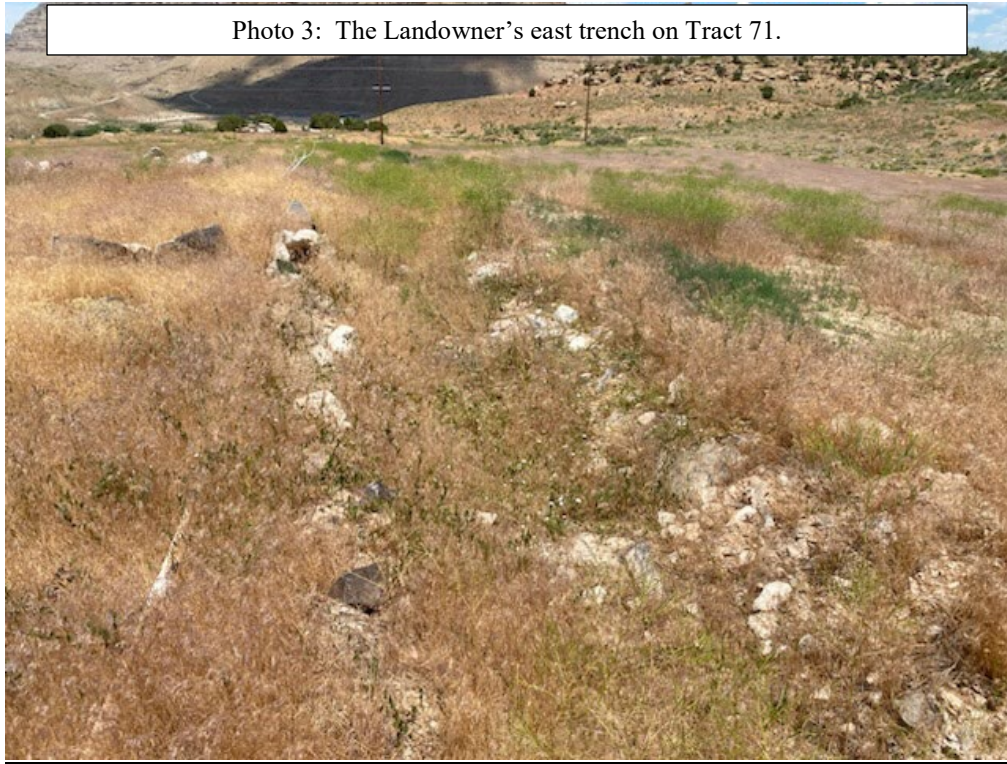

Photo 4: The Carey Pit.



Number of Partial Inspection this Fiscal Year: 9

Number of Complete Inspections this Fiscal Year: 4

Photo 5: The TR-69 Repair area consists of 0.4 acres of permitted area.

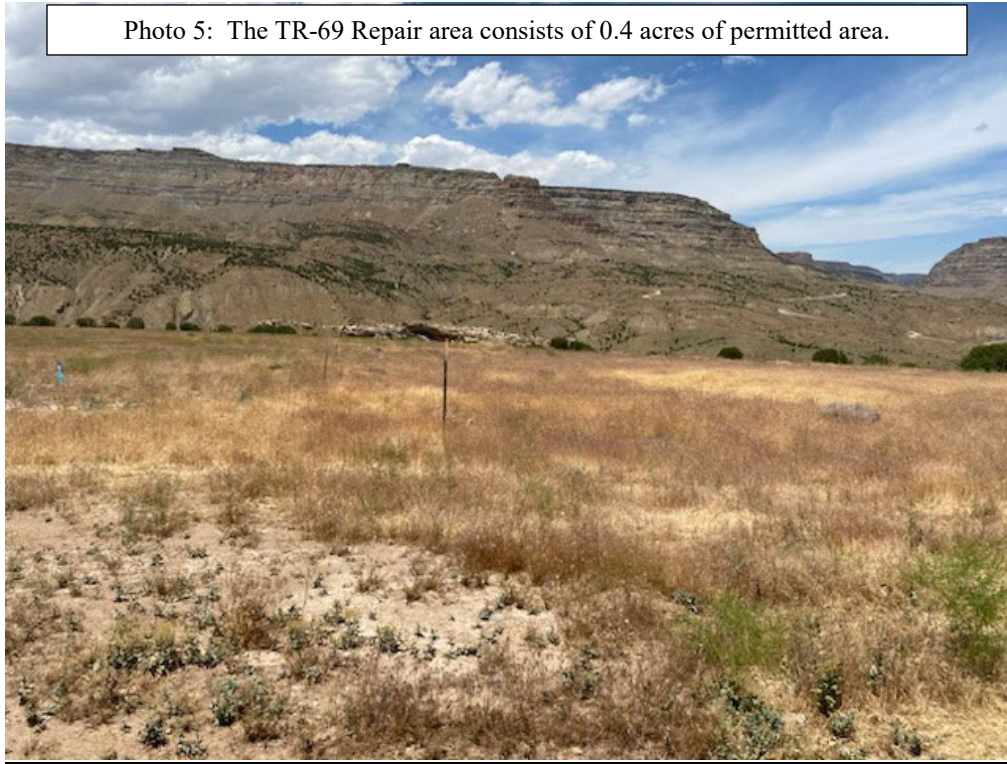

Number of Partial Inspection this Fiscal Year: 9

Number of Complete Inspections this Fiscal Year: 4



**AVAILABILITY OF RECORDS****PERMIT RECORDS**

DRMS Permit	RN-8
Permit Application w/Revisions	OK
Findings Document	OK
Insurance Certificate	Exp. 7/1/2024
Bond Document	OK
Phased Bond Release	OK SL-11
Documents/Findings	
Air Emission Permits	NA
County Special Use Permits	NA
UG Mining Landowner Notification	OK
Subsidence Monitoring Reports	NA
Subsidence Monitoring Data	PAP
Rill & Gully Survey	OK

Vegetation Monitoring Data	2022 ARR
Specific Variance Approvals	NA
Annual Reclamation Reports	2022
Midterm Review Documents	MT-8
DRMS/OSM Inspection Reports/Enforcement Actions (3 Years)	Up to Date May 2023
Transfers/Succession of Operator	SO-2
Temporary Cessation Notification	NA
Reclamation Cost Estimate	MT-8, RN-8 Laserfiche

**CERTIFICATIONS**

Pond Certifications	OK/Released
Annual Certifications for Impoundments	NA
Fill Certifications for Excess Spoil or Underground Development Waste	NA
• Quarterly Inspections	NA
• Compaction Testing	NA
• Final Certification	2008/2011
Coal Processing Waste Banks	Released
Haul Road Certifications	OK
Access Road Certifications	OK

**HYDROLOGIC RECORDS**

NPDES Permit	COR-0027146
NPDES Records	1 <sup>st</sup> Q 2023
Stormwater Management Plan	OK
SPCC Plan	NA
MSHA Pond Inspections	NA
	NA
State Engineer's Pond Inspection	
Quarterly Pond Inspections	NA
Annual Hydrology Reports	2022
• Ground Water Monitoring	AHR
• Surface Water Monitoring	AHR
• Spring & Seep Monitoring	NA
• Mine Water Discharge Monitoring	AHR
• Mine Inflow Study	AHR
• Water Consumption Records	NA
Well Permits	All Reclaimed

**BLASTING RECORDS**

Blasting Publication	>3 years
Blasting Records (3 years)	>3 Years
ATFE Explosives Permit	NA
Blasting Variances	NA
Pre-Blast Surveys	NA

**ADDITIONAL RECORDS (specify)**

**COMMENTS:**

---



---



---



---

Number of Partial Inspection this Fiscal Year: 9Number of Complete Inspections this Fiscal Year: 4