



MINERALS PROGRAM INSPECTION REPORT
PHONE: (303) 866-3567

The Division of Reclamation, Mining and Safety conducted an inspection of the mining operation noted below. This report documents observations concerning compliance with the terms of the permit and applicable rules and regulations of the Mined Land Reclamation Board.

MINE NAME: Riverview Resource	MINE/PROSPECTING ID#: M-1999-098	MINERAL: Sand and gravel	COUNTY: Weld
INSPECTION TYPE: Monitoring	WEATHER: Raining	INSP. DATE: June 30, 2023	INSP. TIME: 11:00
OPERATOR: Holcim - WCR, Inc.	OPERATOR REPRESENTATIVE: None	TYPE OF OPERATION: 112c - Construction Regular Operation	
REASON FOR INSPECTION: Normal I&E Program	BOND CALCULATION TYPE: Partial Bond	BOND AMOUNT: \$11,300,000.00	
DATE OF COMPLAINT: NA	POST INSP. CONTACTS: None	JOINT INSP. AGENCY: None	
INSPECTOR(S): Peter Hays	INSPECTOR'S SIGNATURE: 	SIGNATURE DATE: July 6, 2023	

GENERAL INSPECTION TOPICS

This list identifies the environmental and permit parameters inspected and gives a categorical evaluation of each. No problems or possible violations were noted during the inspection. The mine operation was found to be in full compliance with Mineral Rules and Regulations of the Colorado Mined Land Reclamation Board for the Extraction of Construction Materials and/or for Hard Rock, Metal and Designated Mining Operations. Any person engaged in any mining operation shall notify the office of any failure or imminent failure, as soon as reasonably practicable after such person has knowledge of such condition or of any impoundment, embankment, or slope that poses a reasonable potential for danger to any persons or property or to the environment; or any environmental protection facility designed to contain or control chemicals or waste which are acid or toxic-forming, as identified in the permit.

(AR) RECORDS----- <u>Y</u>	(FN) FINANCIAL WARRANTY----- <u>N</u>	(RD) ROADS----- <u>N</u>
(HB) HYDROLOGIC BALANCE----- <u>N</u>	(BG) BACKFILL & GRADING----- <u>Y</u>	(EX) EXPLOSIVES----- <u>N</u>
(PW) PROCESSING WASTE/TAILING---- <u>N</u>	(SF) PROCESSING FACILITIES----- <u>N</u>	(TS) TOPSOIL----- <u>N</u>
(MP) GENL MINE PLAN COMPLIANCE- <u>Y</u>	(FW) FISH & WILDLIFE----- <u>N</u>	(RV) REVEGETATION---- <u>N</u>
(SM) SIGNS AND MARKERS----- <u>Y</u>	(SP) STORM WATER MGT PLAN---- <u>N</u>	(RS) RECL PLAN/COMP-- <u>N</u>
(ES) OVERBURDEN/DEV. WASTE----- <u>N</u>	(SC) EROSION/SEDIMENTATION--- <u>N</u>	(ST) STIPULATIONS----- <u>N</u>
(AT) ACID OR TOXIC MATERIALS----- <u>N</u>	(OD) OFF-SITE DAMAGE----- <u>N</u>	

Y = Inspected / N = Not inspected / NA = Not applicable to this operation / PB = Problem cited / PV = Possible violation cited

OBSERVATIONS

The Riverview Resource site was inspected by Peter Hays with the Division of Reclamation, Mining and Safety (Division/DRMS) in response to a technical revision (TR3) submitted by the Operator on June 29, 2023. Mr. Wyatt Webster with Holcim – WRC, Inc. (Holcim) was informed of the inspection, but was not present during the inspection.

The Operator submitted technical revision no. 3 (TR3) on June 29, 2023. The technical revision proposes to import inert fill to backfill the southern portions of Cell 3 and Cell 5. A copy of the map submitted with TR3 is inserted below for reference. The Division is required by Rule 1.9 to act on a technical revision within thirty (30) days after being filed with the Division.

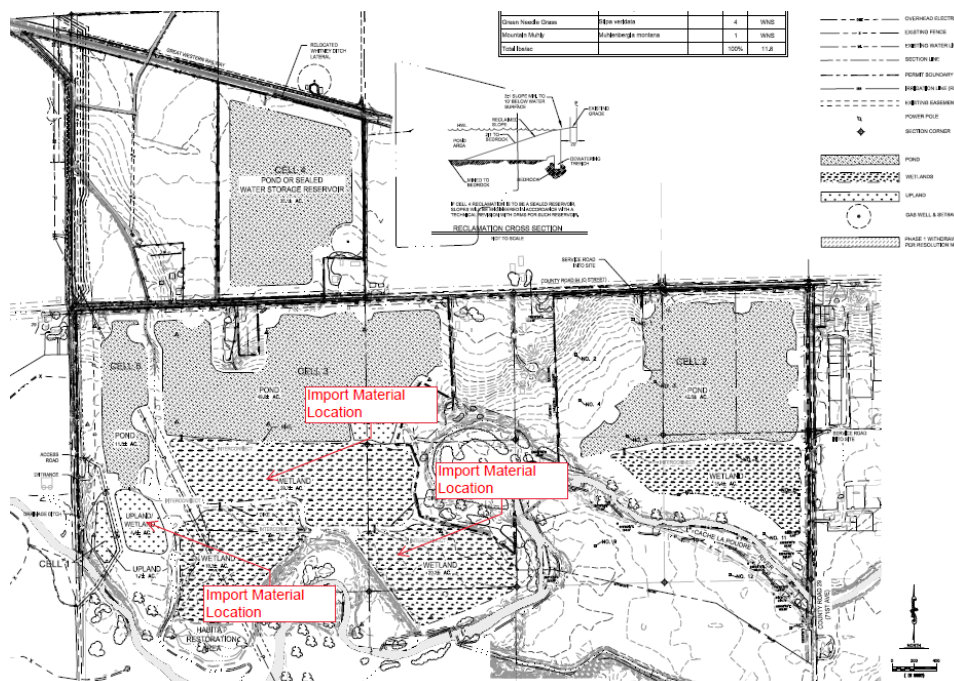

The site is an 112c Regular Construction Materials Operation permitted for 433 acres with 190 acres of mining disturbance. The site is divided into five (5) mining cells; Cells 1 – 5. The site was amended in 2008 to add 156 acres to the site. An acreage reduction request (AR1) was approved by the Division in 2018 to remove the 63 acre - Cell 4, Phase 1 from the permit boundary.

The site was active during the inspection. The operation of the site was consistent with the observations from the previous inspection conducted on December 7, 2022. Please see the 2022 inspection report for details.

Reclamation Plan:

The approved post-mining land use for the site is wildlife habitat consisting of open-water ponds, wetlands and upland pastures. The southern portion of Cell 3 was reclaimed to wetlands years ago. The wetlands in Cell 3 and the planned wetlands in Cells 2 and 5 were intended to be used for mitigation banking credits. Cell 4 will be reclaimed to either an open water pond or a lined reservoir. The Operator committed to submitting a technical revision for Division review and approval prior to the reservoir construction.

The Operator previously stated, the post-mining land use would be revised from open-water lakes and wetland in Cells 1, 3 and 5 to rangeland by backfilling all of the exposed groundwater in the cells with inert fill.

The Division considers a change in the post-mining land use a significant revision to the approved Reclamation Plan. Pursuant to Rule 1.1(6), an "Amendment" means a change in the permit or an application which increases the acreage of the affected land, or which has a significant effect upon the approved or proposed Mining Plan or Reclamation Plan. The Division will require the Operator to submit an amendment application to revise the post-mining land use from wildlife habitat to rangeland with developed water resources.

The Division currently holds a financial warranty in the amount of \$11,030,000.00. The warranty amount includes the cost to backfill the exposed groundwater and install the Cell 4 slurry wall.

Photographs taken during the inspection are attached. If you need additional information or have any questions, please contact me at the Division of Reclamation, Mining and Safety, 1313 Sherman Street, Room 215, Denver, CO 80203, by telephone at 303.866.3567 x 8124, or by email at peter.hays@state.co.us.

Inspection Contact Address

Wyatt Webster
Aggregate Industries - WCR, Inc.
1687 Cole Blvd.
Golden, CO 80401

Ec: Jared Ebert, DRMS

PHOTOGRAPHS



Riverview Resources mine sign



View of the southern portion of Cell 5 from the north side looking south



View of the southern portion of Cell 3 from the southwest shoreline looking southeast



View of the southern portion of Cell 3 from the southwest shoreline looking east



View of the southern portion of Cell 3 from the southwest shoreline looking northeast