

Treatment Method and Date: Handgun 07/15-16/2020



Report year: 2022

Approved Seed Mix: BLM native mix #2 (1997 RMP) with Needle and Thread substituted for Green needlegrass, Fourwing saltbrush and Prostrate alfalfa added.

Status of Site for DRMS and BLM Annual Reports: Pad downsized and partially re-contoured and soil stockpiles seeded 11/2007. Pit closed and a portion of the Pad area seeded to establish ground cover 10/2008 (phase 2 interim reclamation). Single installed borehole P&A'd 09/2015. Remaining disturbed area regraded, soil material spread, and site seeded Fall 2015 (final reclamation phase). Weed control conducted annually 2012 through 2022. Noxious weed monitoring conducted each year.

2022 Weed Control Observed: Annuals & Downy Brome

Treatment: Escort XP @ 1.5 oz./acre, Cornbelt LV6-2,4-D @ 24 oz./acre, Vista @ 1.1 oz/acre, Round Up Pro Max @ 1.0 oz/acre 1# A.I./acre(A.I. = Active Ingredients.)

Treatment Method and Date:

Handgun 05/19/22, 07/13-14/2022  
& 09/21/22

#### Total Affected Acreage

Pad Area = 1.607 Acres  
Access Road Area = 0.025 Acres  
Topsoil Area = 0.133 Acres  
Total = 1.765 Acres

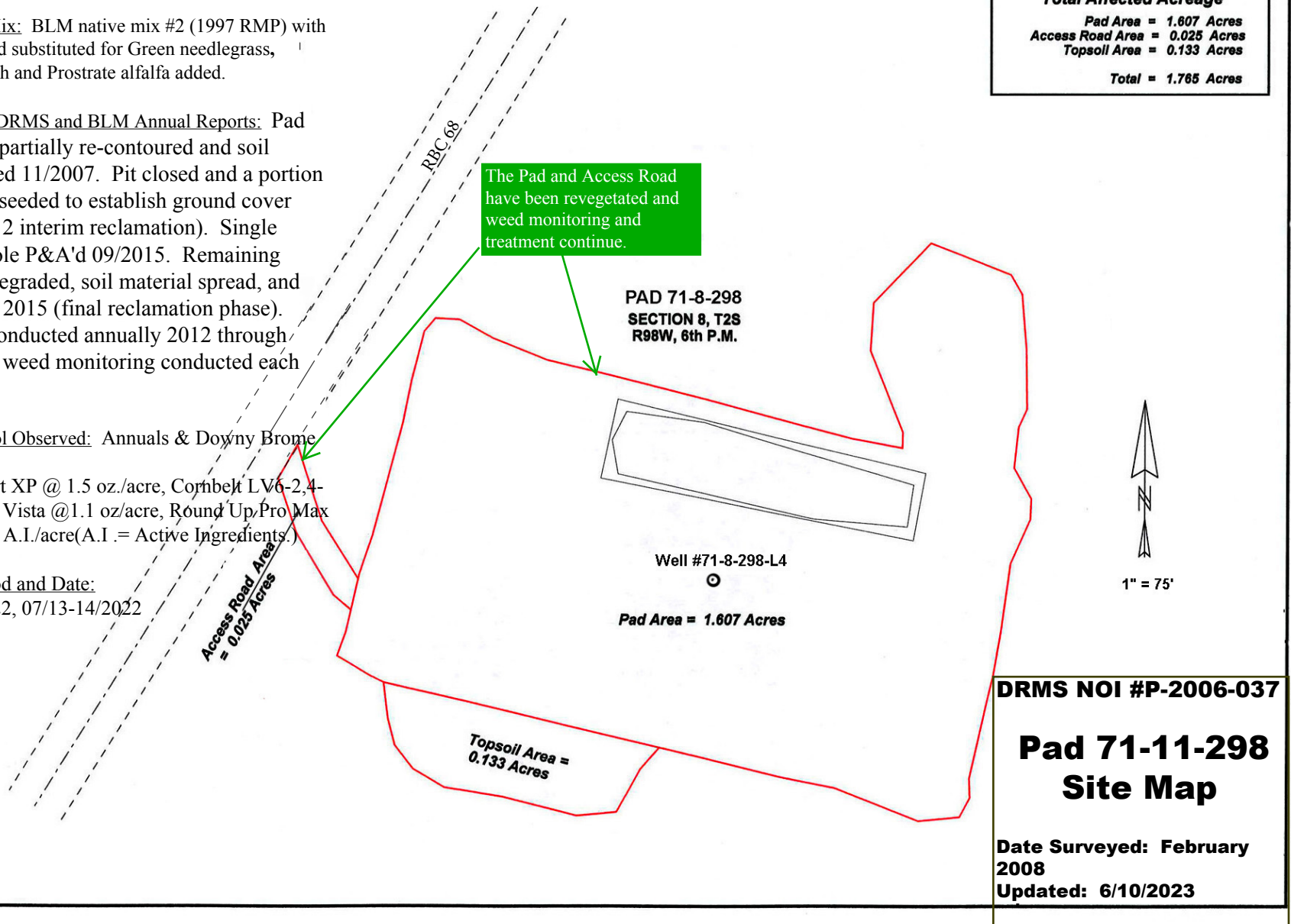

DRMS NOI #P-2006-037

## Pad 71-11-298 Site Map

Date Surveyed: February  
2008

Updated: 6/10/2023

PAD 77-11-299  
SECTION 11, T2S  
R99W, 6th P.M.

Topsoil Area  
= 0.223 Acres

Well #77-11-299-UT  
○

Pad Area = 1.809 Acres

The Pad and Access Road  
have been revegetated and  
weed monitoring and  
treatment continue.

Access Road Area  
= 0.080 Acres



**Total Affected Acreage**

Pad Area = 1.809 Acres  
Access Road Area = 0.080 Acres  
Topsoil Area = 0.223 Acres

Total = 2.112 Acres

**DRMS NOI #P-2006-037**

**Pad 77-11-299  
Site Map**

**Date Surveyed: February 2008  
Updated: 6/10/2023**

Report year: 2022

Approved Seed Mix: BLM native mix #2 (1997 RMP) with Needle and Thread substituted for Green needlegrass, Fourwing saltbrush and Prostrate alfalfa added.

Status of Site for DRMS and BLM Annual Reports:  
Soil stockpiles seeded 11/2007. Pit closed and part of Pad seeded and Curlex applied for interim stabilization 09/2008. Pad downsized and part of Pad regraded 08/2009. Portion of Pad site seeded 10/2009 (phase 2 interim reclamation). The single installed borehole P&A'd 10/2014. Site regraded, surfaces roughened, and all topsoil replaced. Site seeded and stabilized with straw mulch (crimped in and secured with a tackifier) Fall 2014 (final reclamation phase). Weed control conducted annually 2012 thru 2022. Noxious weed monitoring conducted each year.

2022 Weed Control Observed: Annuals, Downy Brome & Russia Thistle and Kocha.

Treatment: Escort XP @ 1.5 oz./acre, Cornbelt LV6-2,4-D @ 24 oz./acre, Vista @ 1.1 oz/acre, Round Up Pro Max @ 1.0 oz/acre 1# A.I./acre(A.I. = Active Ingredients.)

Treatment method & date: Handgun.  
Handgun 05/19/22, 07/13-14/2022  
&09/21/22