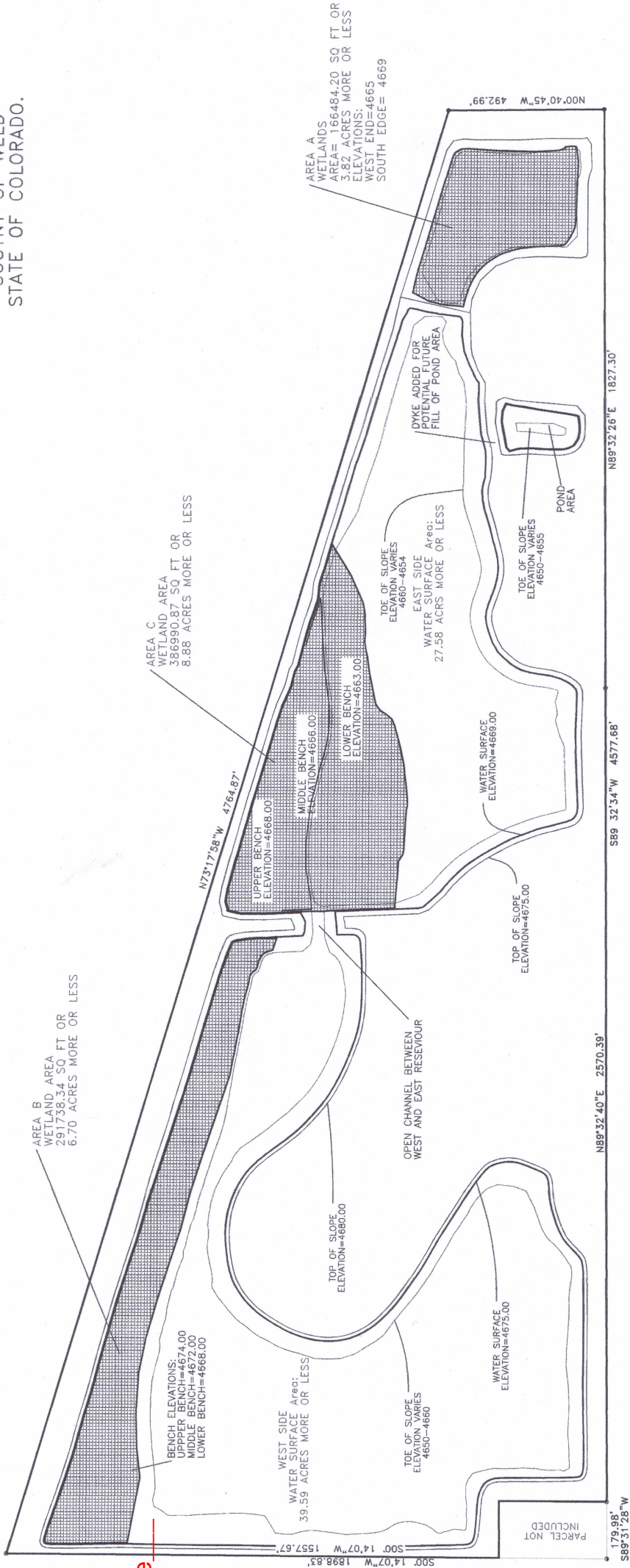

Exhibit F – Reclamation Plan
M-1992-069 – 83rd Joint Venture
Technical Revision

FOR A PARCEL OF LAND LOCATED
IN THE SOUTH HALF OF
SECTION 35, TOWNSHIP 6 NORTH,
RANGE 66 WEST OF THE 6TH P.M.
COUTNY OF WELD
STATE OF COLORADO.



Apx. location of slope
breach from 2013-14
floods/ditch pipe failure

TOTAL SITE ACREAGE: 124.09 +/-
WATER SURFACE ACRES: 67.17 +/-
WETLAND MITIGATION ACRES: 19.40 +/-
UPLAND (site perimeters and
future development areas): 37.52 +/-

Annual Report Map
Year Ended January 26, 2023

PREPARED FOR:
AGGREGATE INDUSTRIES
1507 COLE BLVD., SUITE 100
GOLDEN, CO 80640

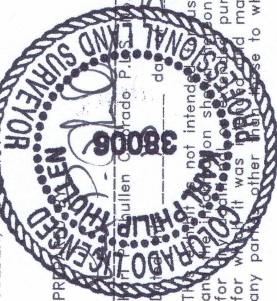

This plan was prepared by the undersigned and is not intended to be used as a survey plat, and no representation shall be made by the undersigned for any purpose beyond that for which it was prepared. The undersigned is not responsible for any other use to which it is put, or for any other use to which it is put, or for any other use to which it is put.

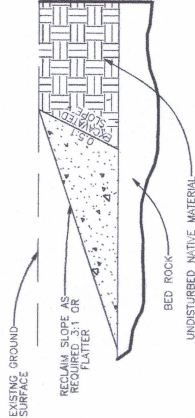

TYPICAL CROSS SECTION
(PRIOR TO BACKFILL)

NIS

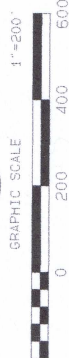

REVISIONS			
NO	DATE	BY	CHK'D
1	02MAR09	KPT	
2	11JUL11	KPT	
3	18JUL11	KPT	
RESCALE			
REVISE AREA STATEMENT			
DESCRIPTION			

DATE: 23SEP08
DRAWN: K. THULLEN
CHECKED:
SCALE: 1/200

Sheet:

1

Of:

1

Exhibit F
Reclamation Plan
M-1992-069 – 83rd
Joint Venture
Weld County

