



**Weber Sand & Gravel, Inc.**  
2980 E. Highway 160  
Pagosa Springs, Colorado 81147  
Phone 970-264-4568

**Weber Pit #2 M-1995-056**

We were able to extend our lease for another year and possibly two years. We were unable to do much work last fall and winter due to winter weather and shortage of employees. We still have about 20-30,000 tons of gravel we can mine and then we will start reclamation of Phase Three in earnest. We have already begun early stages of reclamation in Phase Three where we can.

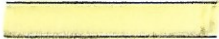
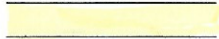

Map Legend for Weber Pit #2 Phase 1&2

September 15, 2022

-  Approximately 18 acres unaffected land which will never be affected –Phase 1&2.  
(Dark Yellow)
-  Approximately 18 acres used for a processing area in Phase 1 & 2 (light Yellow)
-  Approximately 14.94 acres that have been reclaimed with partial seeding.

The area in Yellow is being used for processing (access roads, stock piling, crushing site). We have reclaimed about 20 Acres along the back wall with some seeding, but the processing site will be the last to be reclaimed.

Map Legend for Phase 3

-  Approximately one acre of land encompassing the road into Phase 3.
-  Approximately 15 acres that will never be disturbed.
-  Approximately 48.7 acres. Reclamation will be resumed sometime during 2023.

With the extension of our lease, we will be crushing between 20-30,000 tons of material this fall and next spring, and then reclamation will begin in earnest for Phase Three.

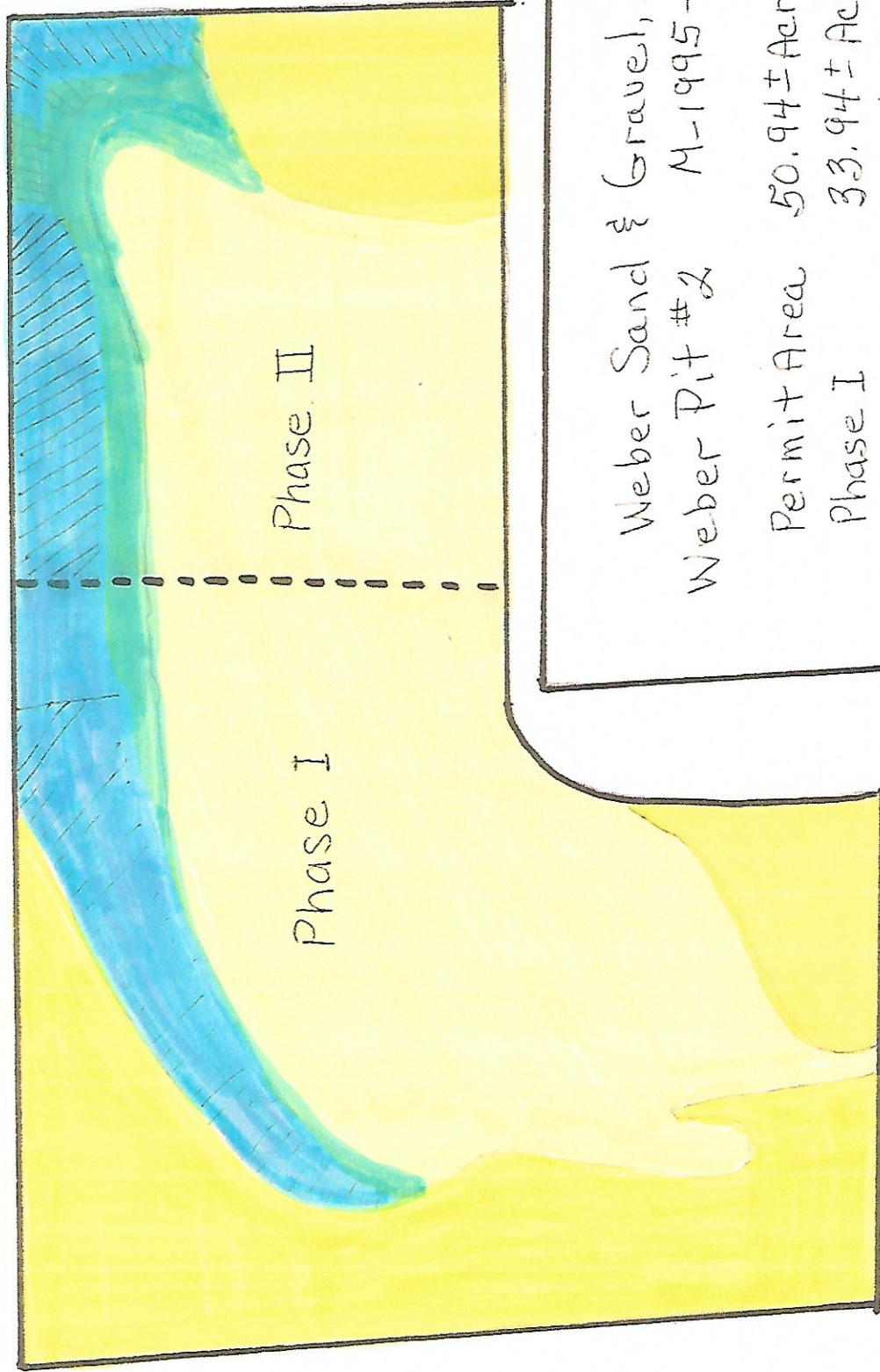

Weber Sand & Gravel, Inc  
Weber Pit #2 M-1995-056

Permit Area	50.94 ± Acres
Phase I	33.94 ± Acres
Phase II	17 ± Acres

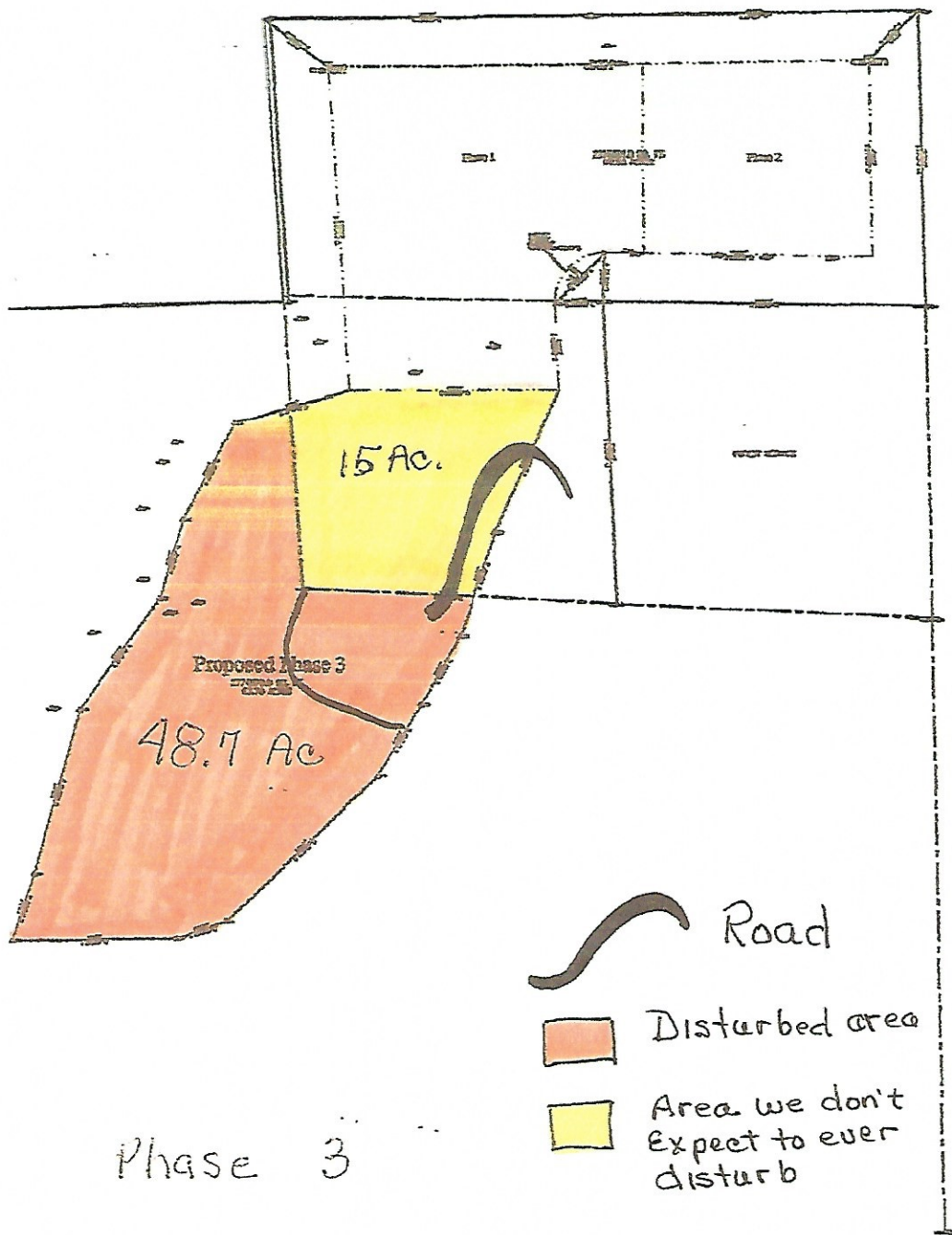

Weber Sand & Gravel, Inc.  
Weber Pit #2 & Extension  
Permit # M-1995-056