







**Land Status as of March 14, 2022**

-  Current Affected Land where no reclamation has yet been applied, but will be in the near future. (11.3 acres)
-  Current affected land that has been backfilled, graded, and topsoiled and is ready for planting. (31.1 acres)
-  Current affected land that has been backfilled, graded. (13.5 acres)
-  Roadway that will remain after reclamation (7.7 acres)

**TOTAL AFFECTED LAND DISTURBED = 63.6 ACRES**

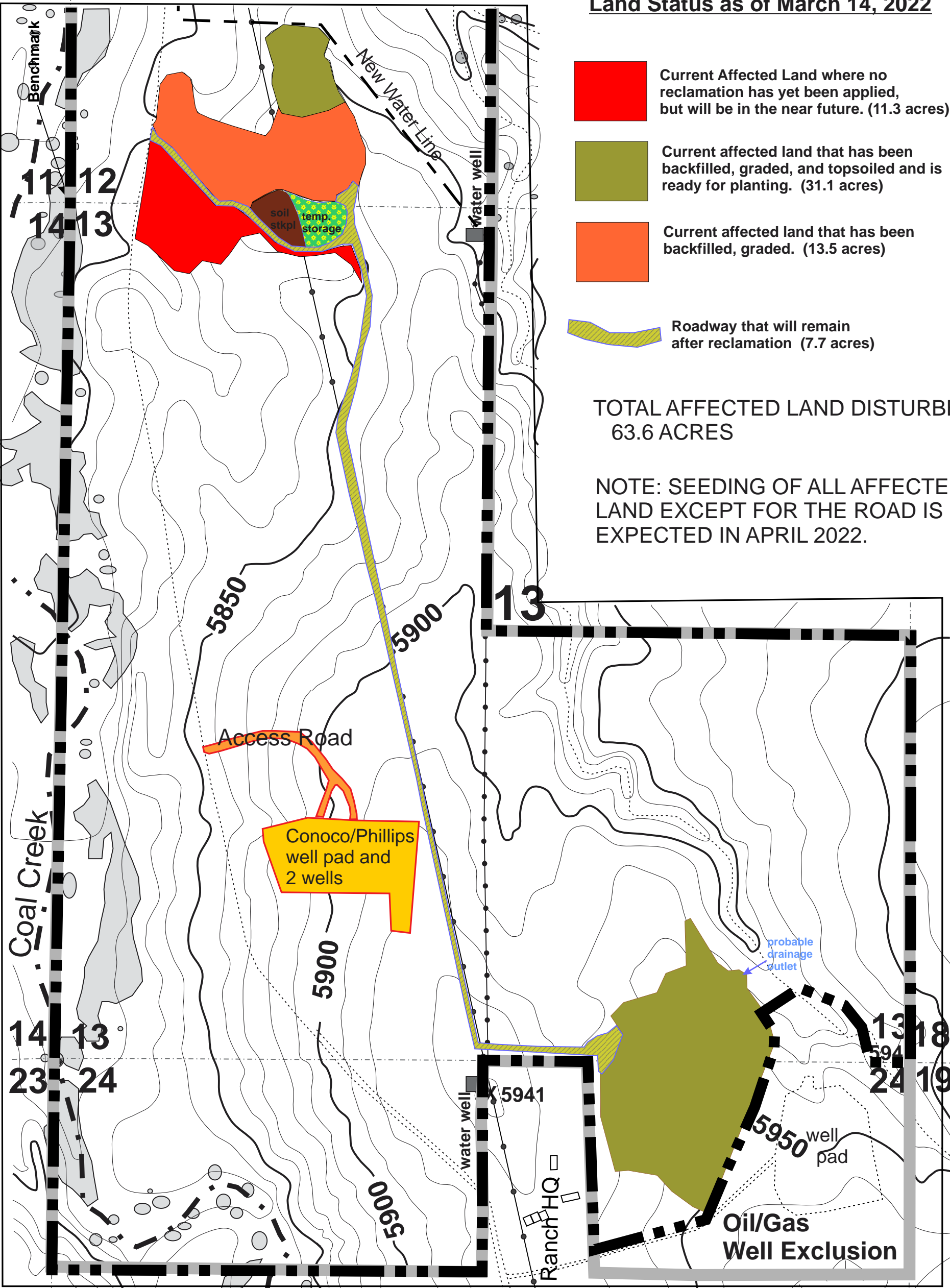
**NOTE: SEEDING OF ALL AFFECTED LAND EXCEPT FOR THE ROAD IS EXPECTED IN APRIL 2022.**



 **NEW PERMIT BOUNDARY**  
 **Current Lease Boundary 5th Amendment (860 acres)**

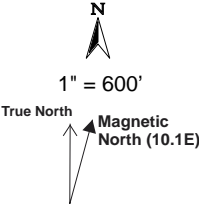

Coal Creek Resources  
Schmidt Construction Co.  
permit: M-1988-044  
Arapahoe County

2022 Annual Report	
DETAIL MAP	
By MAH base date: Jan '05 modified in March 2016 to adjust for TR-07	March 2022