

# LANDSCAPE BUFFER SECTION A-A'

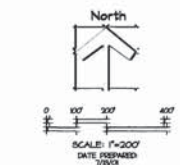
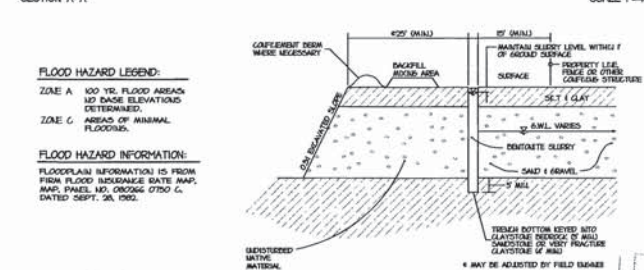

- LEGEND:**
- PERMIT BOUNDARY
  - 100 YEAR FLOODPLAIN
  - EXISTING DITCH
  - EXISTING CONTOURS
  - EXISTING OVERHEAD POWER
  - EXISTING RAILROAD
  - EXISTING GAS LINE
  - EXISTING FENCE
  - EXISTING TREE
  - EXISTING STRUCTURES
  - LIMITS OF MINING AREAS
  - MINING SEQUENCE
  - ON-SITE MAIL ROAD
  - PROPOSED ACCESS
  - SLURRY WALL
  - PROPOSED PIEZOMETER
  - PROPOSED TREE
  - PROPOSED SHED

## NOTES:

1. THERE SHALL BE A MINIMUM 100' MINING DETACK ON ONE SIDE OF OIL AND GAS WELLS AND A MINIMUM 10' DETACK ON THE REMAINING SIDES.
2. THERE SHALL BE A MINIMUM MINING DETACK OF 40' FEET FROM GAS LINES.
3. THE MINING RIGHTS OWNERS AND LESSEES SHALL HAVE 24 HOUR ACCESS TO THEIR OIL AND GAS FACILITIES.
4. AGGREGATE INDUSTRIES - WCR, INC. SHALL LIMIT DRILLING OVER FLOW LINES.
5. THE MINING POOL CONTOURS ARE FOR ILLUSTRATION ONLY. AGGREGATE INDUSTRIES WILL MINE AT 21 HORIZONTAL TO VERTICAL MINIMUM SLOPE.

## NOTE:

THIS MAP WAS PREPARED BY ROCKY MOUNTAIN CONSULTANTS, INC. IN COOPERATION WITH AGGREGATE INDUSTRIES - WCR, INC. THE EXACT CONFIGURATION OF THE MINING POOL AND RECLAIMED POOLS MAY CHANGE TO RESPOND TO FIELD CONDITIONS. AGGREGATE INDUSTRIES - WCR, INC. WILL KEEP THE DIVISION OF MINERALS AND GEOLOGY INFORMED OF ANY CHANGES THROUGH ANNUAL REPORTS AND FILE TECHNICAL REVISIONS AND AMENDED APPLICATIONS AS NECESSARY THROUGHOUT THE LIFE OF THE MINE.

*Wanda Ortiz*  
DANIEL ORTIZ  
ROCKY MOUNTAIN CONSULTANTS, INC.  
DATE 11/12/2021

**ANNUAL REPORT MAP-1**  
**JANUARY 12, 2022**  
**- NO DISTURBANCES TO DATE.**  
**- DRILLED 8 MONITORING WELLS IN 2021**

## REVISIONS

NO.	DESCRIPTION	DATE	BY
1	DATE REVISION	11/12/2021	Wanda Ortiz
2	DATE REVISION	11/12/2021	Wanda Ortiz
3	DATE REVISION	11/12/2021	Wanda Ortiz

AMENDMENT TO MLRB 112 PERMIT #M-2000-087  
MILLIKEN RESOURCE MINING PLAN  
AGGREGATE INDUSTRIES - WCR, INC.

PLOTTED: 11/14/01	DESIGNED BY: BB
DRAWN BY: BB	CHECKED BY: BB
JOB NUMBER: 80-3919.007.00	
SHEET: 3 of 6	



RECEIVED  
NOV 21 2021  
Division of Minerals and Ecology  
ROCKY MOUNTAIN CONSULTANTS, INC.  
850 DELAWARE AVE., SUITE 300, LONGMONT, CO 80501  
(303) 775-3022 FAX (303) 775-4595

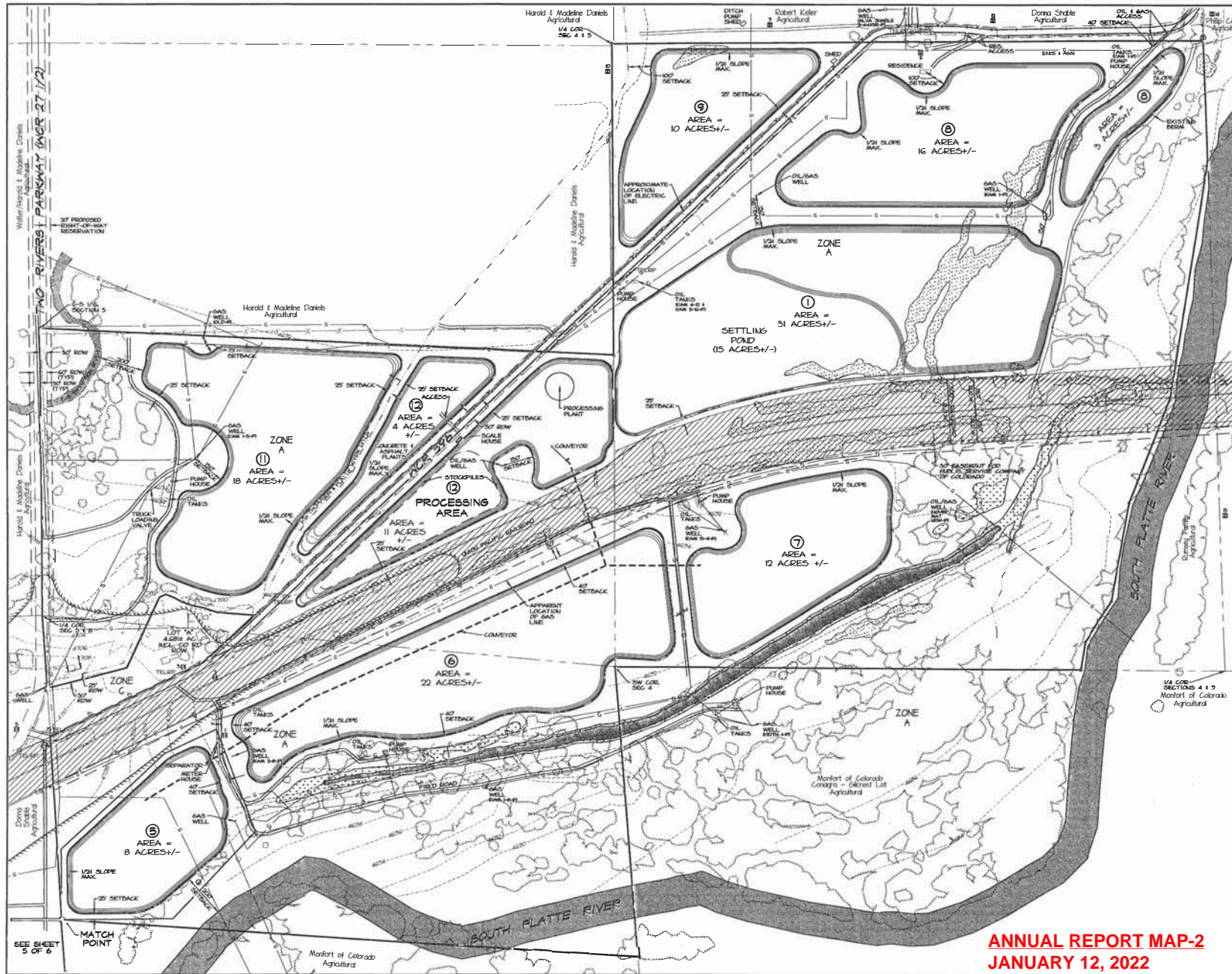

**RECEIVED**  
11/20/01

**NOTE:** THIS MAP WAS PREPARED BY ROCKY MOUNTAIN CONSULTANTS, INC. IN COOPERATION WITH AGGREGATE INDUSTRIES, INC. THE EXACT CONTOUR OF THE MINING POND AND RECLAIMED POND MAY CHANGE TO RESPOND TO FIELD CONDITIONS. AGGREGATE INDUSTRIES - INC. WILL KEEP THE DIVISION OF MINERALS AND GEOLOGY INFORMED OF ANY CHANGES THROUGH ANNUAL REPORTS AND FILE TECHNICAL REVISIONS AND AMENDED APPLICATIONS AS NECESSARY THROUGHOUT THE LIFE OF THE MINE.

**DATE:** 11/20/01

**NOTE:**

1. WETLAND INFORMATION FROM SAVANNAH SAVANNAH WETLAND DELINEATION APPROVED ACTION BY THE U.S. ARMY CORPS OF ENGINEERS.
2. THE MINING POND CONTOURS ARE FOR INFORMATION ONLY. AGGREGATE INDUSTRIES WILL MINE AT 1/2:1 ANGLE TO THE BOTTOM OF THE RECLAMATION.
3. AGGREGATE INDUSTRIES WILL DETEST THROUGHOUT MINE WASTE WITHIN 200' OF ANY STRUCTURE NOT INCLUDED IN THE STABILITY ANALYSIS.
4. THERE SHALL BE A MINIMUM 100' MINING SETBACK ON ONE SIDE OF THE MINING POND AND A MINIMUM 20' SETBACK ON THE REMAINING SIDE.
5. THERE SHALL BE A MINIMUM MINING SETBACK OF 30 FEET FROM GAS LINES.
6. THE MINING RIGHTS CHARGES AND LESSEES SHALL HAVE 24 HOUR ACCESS TO THEIR OIL AND GAS FACILITIES.
7. AGGREGATE INDUSTRIES - INC. SHALL MAINTAIN FLOODING OVER FLOW LINES.

**FLOOD HAZARD LEGEND:**

ZONE A 100 YR FLOOD AREAS  
NO BASE ELEVATIONS DETERMINED.

ZONE C AREAS OF MINIMAL FLOODING.

**FLOOD HAZARD INFORMATION:**  
FLOODPLAIN INFORMATION IS FROM FIRM FLOOD INSURANCE RATE MAP, MAP NO. 02-02-001-A, DATED SEPT. 28, 1992.

**LEGEND:**

- PERMIT BOUNDARY
- 100 YEAR FLOODPLAIN
- EXISTING DITCH
- EXISTING CONTOURS
- EXISTING OVERHEAD POWER
- EXISTING RAILROAD
- EXISTING GAS LINE
- EXISTING FENCE
- EXISTING TREE
- EXISTING STRUCTURES
- LIMITS OF MINING AREAS
- MINING SEQUENCE
- ON-SITE HAIL ROAD
- PROPOSED ACCESS
- SLOPE WALL
- WATER WELL WITH WELL ID & DEPTH
- WELL INFORMATION
- PROPOSED PIEZOMETER
- RAILROAD ROW
- JURISDICTIONAL WETLANDS
- WETLANDS

**ANNUAL REPORT MAP-2**  
**JANUARY 12, 2022**