



Cazier - DNR, Tim <tim.cazier@state.co.us>

M1987-131 Penrose Pit

1 message

Jodi Schreiber <jodi@arycorp.com>
To: "Cazier - DNR, Tim" <tim.cazier@state.co.us>

Thu, Dec 16, 2021 at 8:12 AM

Good morning Tim.

Attached are the updated maps that remove the mined out portion of the site along the south side of the permit. Please let me know if these address the questions we had during our discussion with the site visit.

Thank you,



Jodi Schreiber

839 Mackenzie Ave., Canon City, CO 81212

Office (719) 275-3264 | Mobile (719) 529-0916

jodi@arycorp.com

"Success is not final, failure is not fatal; it is the courage to continue that counts. "

-Winston Churchill

4 attachments

R4 - Exhibit E.pdf
432K

R 4- Exhibit C.10.pdf
622K

R4 - Phase map C.2.pdf
349K

R4 - Exhibit D.pdf
392K

Penrose Pit Reclamation Map Exhibit F

Scale
← 600'-0" →

Typical Reclamation Section

+/- 3" Topsoil
+/- 3" Overburden

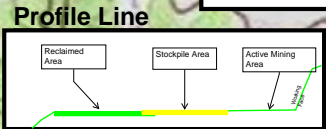

Native Vegetation:
Bouteloua dactyloides,
Pascopyrum smithii,
Opuntia fragilis
Cylindropuntia imbricata

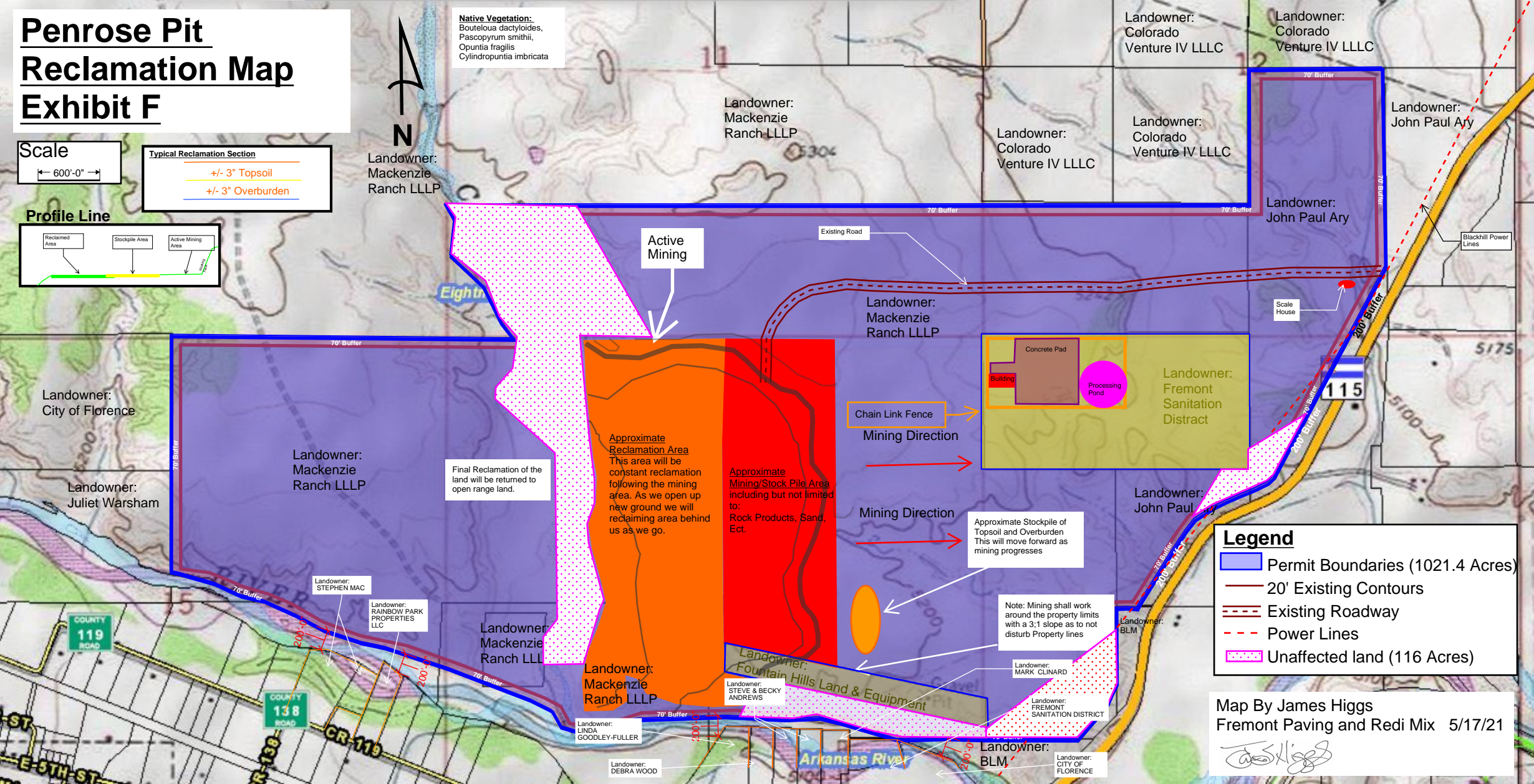

Legend

- Permit Boundaries (1021.4 Acres)
- 20' Existing Contours
- Existing Roadway
- Power Lines
- Unaffected land (116 Acres)

Map By James Higgs
Fremont Paving and Redi Mix 5/17/21

Penrose Pit

Existing Conditions

Exhibit C.1

Scale

1,200'-0"



Legend

- Pit Boundaries
- Active Wells
- Active Structure

Structure Ditch DOOLEY DITCH
Name = DOOLEY DITCH
WDID = 1200592
Current-in-Use = Inactive structure which physically exist, but no diversion records are maintained (I)
Water Source = EIGHTMILE CREEK [30191318]
Assoc Permit =
Assoc Case No = 84CW0125, CA3035

No Structure Found

Structure Ditch BRUSH HOLLOW DITCH NO 1
Name = BRUSH HOLLOW DITCH NO 1
WDID = 1200910
Current-in-Use = Historical structure only - no longer exists or has records, but has historical data (H)
Water Source = BRUSH HOLLOW CREEK [30192032]
Assoc Permit =
Assoc Case No = CA2557

Structure Ditch BRUSH HOLLOW DITCH NO 2
Name = BRUSH HOLLOW DITCH NO 2
WDID = 1200587
Current-in-Use = Historical structure only - no longer exists or has records, but has historical data (H)
Water Source = BRUSH HOLLOW CREEK [30192032]
Assoc Permit =
Assoc Case No = CA2622, CA3036

Structure Ditch BRAGG DITCH
Name = BRAGG DITCH
WDID = 1200905
Current-in-Use = Historical structure only - no longer exists or has records, but has historical data (H)
Water Source = ARKANSAS RIVER [30078956]
Assoc Permit =
Assoc Case No = CA2622, CA4969

No Structure Found

Structure Reach PENROSE (PLEASANT VALLEY) PUEBLO RES EXCH
Name = PENROSE (PLEASANT VALLEY) PUEBLO RES EXCH
WDID = 1202814
Current-in-Use = Inactive structure which physically exist, but no diversion records are maintained (I)
Water Source = ARKANSAS RIVER [30078956]
Assoc Permit =
Assoc Case No = 06CW0012

Structure Pump FREMONT PAVING/REDI-MIX PUMP
Name = FREMONT PAVING/REDI-MIX PUMP
WDID = 1201149
Current-in-Use = Active Structure with contemporary diversion records (A)
Water Source = ARKANSAS RIVER [30078956]
Assoc Permit =
Assoc Case No =

Map By James Higgs
Fremont Paving and Redi Mix 5/17/21

Penrose Pit

Existing Conditions

Exhibit C.2

Native Vegetation:
Bouteloua dactyloides,
Pascopyrum smithii,
Opuntia fragilis
Cylindropuntia imbricata

The current effected area will be mined out before starting east into phase 1. This will continue east through the phases until phase 4. At which point the mining operation will use the Texas crossing to begin west starting at phase 5 working through to phase 7. Phases 8 and 9 will be evaluated at a later date to see if they will or will not be mined.

Scale
← 600'-0" →

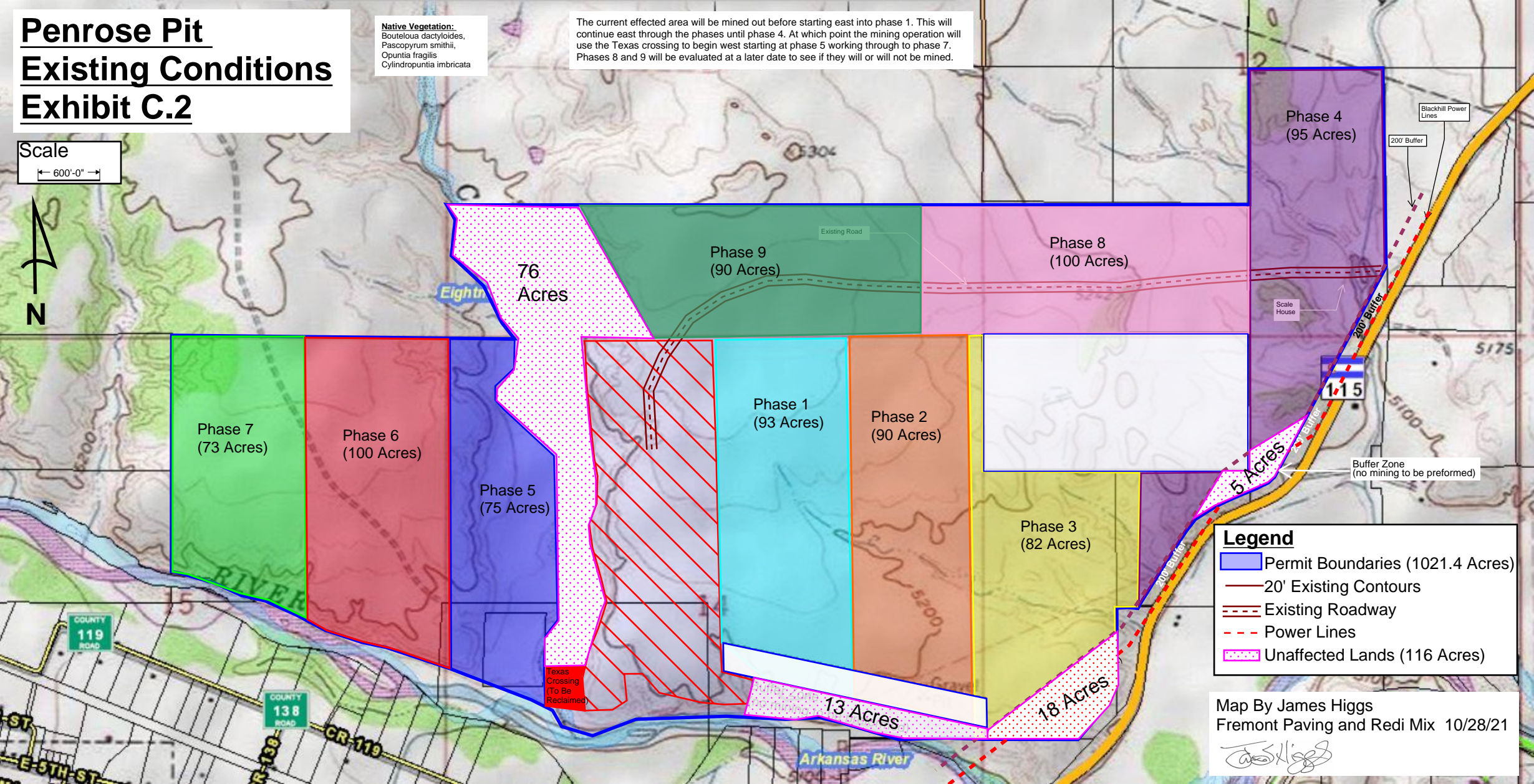

Legend

- Permit Boundaries (1021.4 Acres)
- 20' Existing Contours
- Existing Roadway
- Power Lines
- Unaffected Lands (116 Acres)

Map By James Higgs
Fremont Paving and Redi Mix 10/28/21

25/11/23