

McATEE CONSTRUCTION CO.

HARLEY PIT #1 - M-1986-147

ANNUAL REPORT 2020-2021

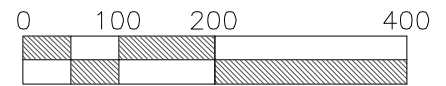
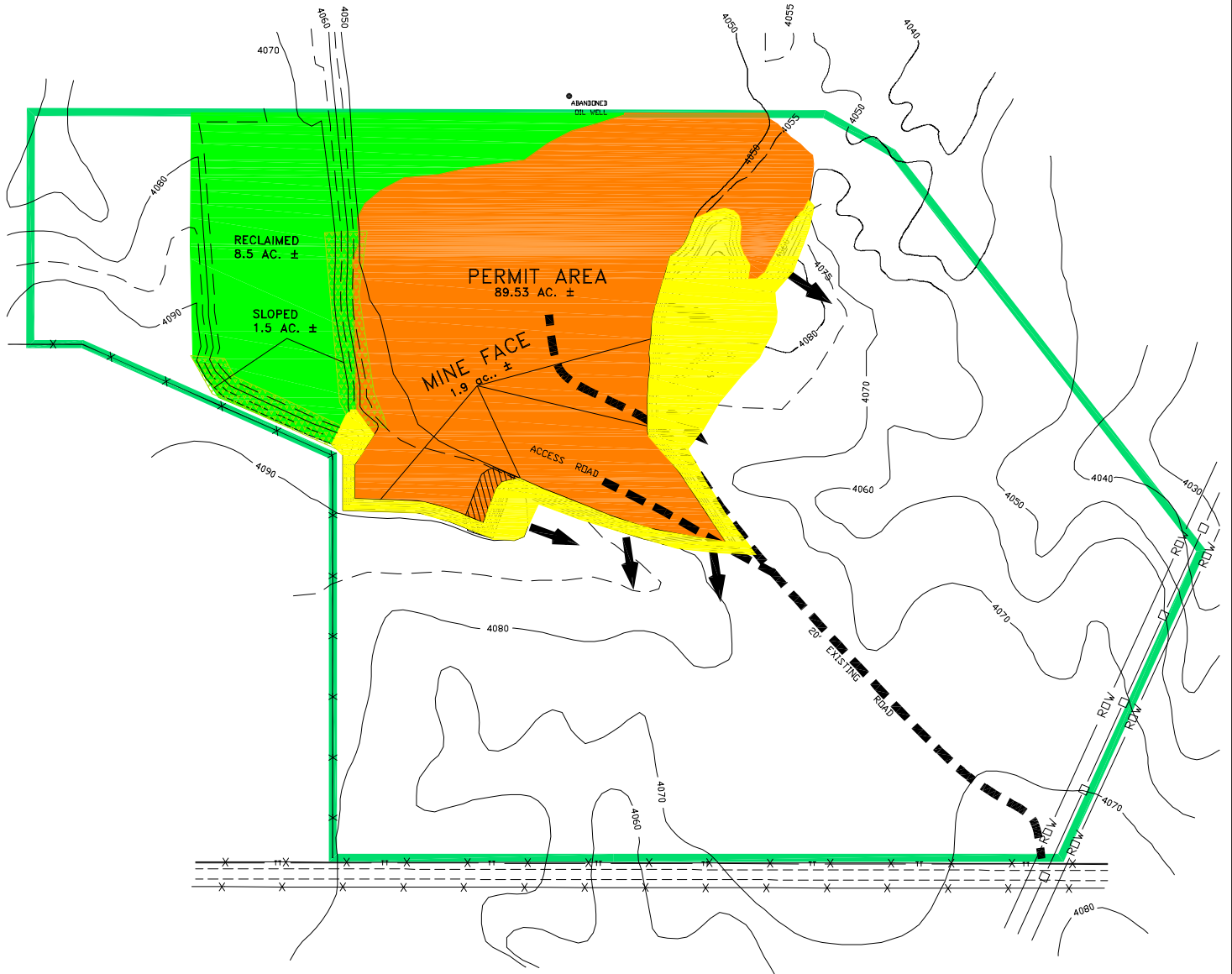

SCALE 1"=200'

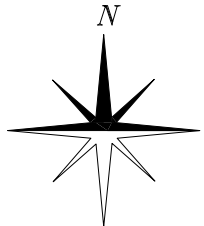

NOV 19, 2021 - 12:02:10

PREPARED BY: *ENVIRONMENT, INC.*
7985 VANCE DR., # 205A
ARVADA, CO 80003
(303) 423-7297

- ← MINING DIRECTION
- MINE FLOOR AREA - 17.6 AC. ±
 - PARTIALLY MINED 2021 - 0.30 AC. ±
 - STRIPPED & PARTIALLY MINED - 4.7 AC. ±
 - RECLAIMED & SEEDED AREA - 8.5 AC. ±

LEGEND

- AFFECTED LANDS
- ROADS
- ABANDONED OIL WELL
- WINDMILL
- FENCE