

Voluntary – 43 CFR 3809 Exploration Notice Form

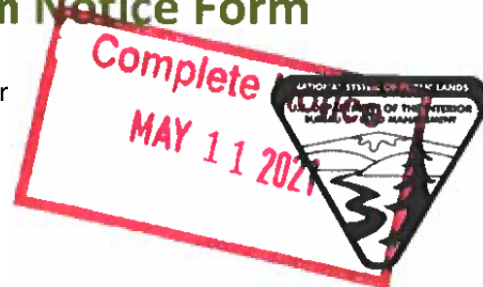

United States Department of the Interior
BUREAU OF LAND MANAGEMENT
Royal Gorge Field Office
3028 East Main Street
Cañon City, Colorado 81212



DATE FILED:

**Please indicate any fields you feel are confidential information.*

Fields highlighted in yellow are not likely to be applicable to a small miner (dredge/highbank).

Section 1: Operator/Claimant Information

Pursuant to 43 CFR 3809.301(b)(1).

1. Operator Information

Operator Name: _____

Mailing Address: _____

City: State: ZipCode: _____

Phone #: _____ Alternate Phone #: _____

Operator Tax Payer Identification Number: _____

2. Claimant/Claim Information, if applicable; if open minerals check here ☐

Primary Claimant: _____

Mailing Address: _____

City: State: ZipCode: _____

Phone #: _____ Alternate Phone #: _____

Additional claimant name(s), if applicable: _____

Claims Information: Please list the CMC numbers, claim names, and claim type (i.e. placer, lode, mill site, tunnel site) for all claims involved in the proposed operations.

| CMC | Claim Name | Claim Type |
|-----|------------|------------|
| | | |
| | | |
| | | |
| | | |
| | | |
| | | |

Voluntary – 43 CFR 3809 Exploration Notice Form

Section 2: Location

Pursuant to 43 CFR 3809.301(b)(2).

1. Legal Description

| Principal Meridian | Township (North or South) | Range (East or West) | Section | Quarter Section (NE, SE, SW, NW) | Quarter Quarter Section (NE, SE, SW, NW) |
|--------------------|------------------------------|-------------------------|---------|-------------------------------------|---------------------------------------------|
| | | | | | |
| | | | | | |
| | | | | | |
| | | | | | |

County: _____

2. Surface Ownership:

☐ Private ☐ BLM ☐ USFS ☐ State Other

3. Access: Please identify the intended access to work sites. Describe in writing and on the location map.

4. Maps & Drawings of Operations: Please include an accurate topographic base map showing the location of the proposed project with this form. The prospector may submit a U.S.G.S 7.5 minute quadrangle or similar map of adequate scale that:
- Provides a general location in relation to major roads, towns, etc.
 - Identifies the proposed prospecting site(s) or activity areas involving surface disturbance. Activity areas include, but are not limited to, all drill holes, mud pits, excavations, trenches, adits, shafts, tunnels, rock dumps, stockpiles, impoundments, prospecting roads, etc.; and
 - Includes sufficient detail to identify and locate known prospecting features and facilities that may be affected and those that are not anticipated to be affected. This includes, but is not limited to, the location of all drill holes, mud pits, excavations, trenches, adits, shafts, tunnels, rock dumps, stockpiles, impoundments, prospecting roads, etc. Color photographs, adequately labeled (including date, orientation and location), of the prospecting site may be used to fulfill this requirement if included with this form.

Voluntary – 43 CFR 3809 Exploration Notice Form



Voluntary – 43 CFR 3809 Exploration Notice Form

Section 3: Description of Operations (i.e., Proposed Action)

Pursuant to 43 CFR 3809.301(b)(2).

1. Proposed Disturbance: _____ acres
2. Commodity:
Primary _____ Secondary _____ Others _____
3. Period of Operation:
Beginning: _____ Ending: _____
4. General Schedule of Operations: Please describe the different parts of operation (Site Development, Operational Phases, Reclamation Phases). Describe each phase of the exploration operation including design, operations, timeframe for completion, and reclamation.

5. Access and other roads: include information such as, but not limited to, the type (haul, light vehicle, access), location(s), length, maintenance, upgrades, uses, temporary, permanent, etc. Indicate any part of the access that is in current existence and the current condition. Indicate these items on the location map(s) in section 2.3.

6. Equipment: Please list all vehicles, equipment and devices that will be used Notice level operations.

| Activities | General Type | Size |
|------------------------|--------------|------|
| Site Development | | |
| Exploration Operations | | |
| Reclamation | | |
| Other | | |

7. Exploration Operations: In the table below, identify the type or method of prospecting proposed and the quantity to be extracted including, but not limited to, dredging, high banking, cuts, pits, trenches, shafts, tunnels, adits, declines, air drilling, fluid drilling, blasting, etc. In the open comments box, describe any additional exploration activities including but not limited to: water source, pipelines, generator/pump, storage containers, etc. Indicate items listed in the table and comments on the location map(s) in section 2.3.

| Type or Method of Prospecting | Quantity of Material Removed (tons) | Estimated Area of Surface Disturbance (acres) |
|-------------------------------|-------------------------------------|-----------------------------------------------|
| | | |
| | | |
| | | |
| | | |
| TOTAL | | |

Voluntary – 43 CFR 3809 Exploration Notice Form

| |
|--|
| |
|--|

a. **Drilling (if applicable):**

| | Quantity | Average Width (ft) | Average depth (ft) | Average length (ft) | Diameter (in) |
|-------------|----------|-----------------------|-----------------------|------------------------|------------------|
| Mud Pits | | | varies | | N/A |
| Drill Pads | | | N/A | | N/A |
| Drill Holes | | | | | |

- b. **Underground Operations (if applicable):** Describe the proposed underground exploration work including reopening of old workings, advancement of adits or shafts, trenches, pits, cuts, rock dumps, or other types of disturbance. Further describe dimensions if necessary:

| |
|--|
| |
|--|

- c. **Scope of Operation:** Clearly state the objective for this operation. Then, describe in detail the type and extent of the operation to be performed. Provide detailed information for any surface excavation or other land disturbance including roads, pits, trenches, waste piles, drill pads and collar areas of underground workings, ponds, etc. For placer type exploration include the amount of material to be processed from each test site, and the dimension of test sites (Section 3.5). Indicate the different types and locations of disturbance on the location map(s) in section 2.3.

| |
|--|
| |
|--|

8. **Use and Occupancy (if applicable):**

The following information must be included in the proposed Notice in order to comply with the 43 CFR 3715, Use and Occupancy under the Mining Laws, when use or occupancy exceeds 14-days in a 30-day period. The definitions of terms are found in 43 CFR 3715.0-5. These regulations apply to public lands administered by the BLM. A written description of the proposed occupancy that describes in detail: (see 43 CFR 3715.3-2):

- How the proposed occupancy is reasonably incident;
- How the proposed occupancy meets the conditions specified in 43 CFR 3715.2 and 43 CFR 3715.2-1
- Where you will place temporary or permanent structures for occupancy;

Voluntary – 43 CFR 3809 Exploration Notice Form

- d. The location of and reason you need enclosures, fences, gates, and signs intended to exclude the general public;
- e. The location of reasonable public passage or access routes through or around the area to adjacent public lands; and
- f. The estimated period of use of the structures, enclosures, fences, gates and signs, as well as, the schedule for removal and reclamation when operations end.
- g. Indicate these items on the location map(s) in section 2.3.

9. **Hazardous Substances, *if applicable*:** Indicate if chemicals and/or fuel are to be used on site. Include information such as, but not limited to, type of generator, chemicals, fuels, quantities, disposal, storage, etc. Indicate locations of use and storage on location map(s) in section 2.3. Include a spill contingency plan if chemicals and fuel are to be used or stored on site.

10. **Water Management Plan:**

- a. Describe anticipated relationship to surface water and groundwater (proximity to streams, penetration of ground water aquifers, known water depth of lenses, major watershed, storm water plan per CDPHE regulations, etc.).

- b. If the use of water is required, describe the location of source and quantity to be used. Please include any necessary permits in Section 3.12 below.

11. Please list any and all permits associated with the proposed operations:

| Issuing Agency | Permit Type | Permit # | Date of Expiration |
|----------------|-------------|----------|--------------------|
| | | | |
| | | | |
| | | | |
| | | | |

Voluntary – 43 CFR 3809 Exploration Notice Form

Section 4: Cultural and Paleontological Resources, & Fish, Wildlife, and Plant Habitats

Pursuant to 43 CFR 3809.420.

Cultural and Paleontological Resources:

1. Operators shall not knowingly disturb, alter, injure, or destroy any scientifically important paleontological remains or any historical or archaeological site, structure, building or object on Federal lands.
2. Operators shall immediately bring to the attention of the authorized officer any cultural and/or paleontological resources that might be altered or destroyed on Federal lands by his/her operations, and shall leave such discovery intact until told to proceed by the authorized officer. The authorized officer shall evaluate the discoveries brought to his/her attention, take action to protect or remove the resource, and allow operations to proceed within 10 working days after notification to the authorized officer of such discovery.
3. The Federal Government shall have the responsibility and bear the cost of investigations and salvage of cultural and paleontology values discovered after a Notice has been approved, or where a Notice is not involved.

Fish, Wildlife, and Plant Habitat:

The operator shall take such action as may be needed to prevent adverse impacts to threatened or endangered species, and their habitat which may be affected by operations.

Section 5: Reclamation Plan

Pursuant to 43 CFR 3809.301(b)(3).

1. A plan for reclamation, per 43 CFR 3809.401, to meet the standards in 43 CFR 3809.420 is required with this application. The disturbance created under this mining plan will dictate the reclamation plan. The cost of implementing the reclamation plan will dictate the bond amount.

The reclamation plan should include, but is not limited to, a description of the equipment and devices, practices you propose to use, a timeline for completion, etc.

- a. It is suggested that a photographic record of the pre-prospecting and post-prospecting conditions be kept by the prospector. These photos should be taken from the same location and by the same method to clearly show the pre-site conditions of the land and the reclamation efforts. Upon completion of reclamation and request for bond or surety release, the photos may be considered as evidence of adequate reclamation, and thus, aid the BLM to act more quickly on the request for release.

- b. Period of Reclamation:

Beginning: _____

Ending: _____

- c. Provide a description of the native vegetation of the area to be disturbed, including tree, shrub, and grass communities of the area. Color photographs, sufficient to adequately represent the ecology of the site and adequately labeled (including date, orientation and location), may be used in lieu of a written description.

Voluntary – 43 CFR 3809 Exploration Notice Form

- d. Describe the estimated topsoil depth and how topsoil will be salvaged, stockpiled, managed during operations, and redistributed for the re-establishment of vegetation at final reclamation. Specify approximate redistribution depth.

- e. Describe how drill holes will be plugged. (Refer to Colorado Division of Reclamation and Mining Safety (CDRMS) and State of Colorado regulations for required abandonment procedures):

- f. Describe how portals, adits, shafts, ponds, excavations, or other disturbances will be reclaimed (refer to Colorado Division of Reclamation and Mining Safety (CDRMS) for specific reclamation performance standards). You may wish to contact other State and Federal Agencies for closure specifications. *If not applicable write N/A.*

- g. Describe how roads will be reclaimed or returned to their pre-prospecting (or better) condition. *If not applicable write N/A.*

- h. List the seed mixture to be used in the re-establishment of vegetation. For assistance with formulating seed mixtures and rates, contact the local NRCS.

Provide Plant name and seeding rate

| Plant Name | Seeding Rate (PLS/Acre) | Seeding Method |
|------------|-------------------------|----------------|
| | | |
| | | |
| | | |
| | | |
| | | |
| | | |

Voluntary – 43 CFR 3809 Exploration Notice Form

2. Reclamation Cost Estimate: required by 43 CFR 3809.552.

The reclamation cost estimate must ensure:

1. the estimated costs as if reclamation work was contracted with a third party to reclaim the operations according to the reclamation plan, including construction and maintenance costs for any treatment facilities necessary to meet Federal and State environmental standards.
2. The Cost of Equipment Rental, Operation and Labor Appropriate for the Geographic Area

Enter those values in the cost estimate that are appropriate to this project. Attach sources/information used in cost estimate (examples: Caterpillar Performance Handbook, contractor's estimate, etc.). Some line items may not apply.

| A. Earthwork/Recontouring | Labor ⁽¹⁾ | Equipment ⁽²⁾ | Materials | Total |
|--------------------------------------|----------------------|--------------------------|-----------|-------|
| Exploration | \$ | \$ | \$ | \$ |
| Exploration Roads & Drill Pads | | | | |
| Roads | | | | |
| Drill Hole Abandonment | | | | |
| Pits | | | | |
| Underground Openings | | | | |
| Waste Rock Dumps | | | | |
| Foundation & Buildings Area | | | | |
| Lay down/storage yards, Etc. | | | | |
| Drainage & Sediment Control | | | | |
| Other | | | | |
| Mobilization/Demobilization | | | | |
| Subtotal "A" | | | | |
| B. Revegetation/Stabilization | Labor ⁽¹⁾ | Equipment ⁽²⁾ | Materials | Total |
| Exploration | \$ | \$ | \$ | \$ |
| Exploration Roads & Drill Pads | | | | |
| Roads | | | | |
| Drill Hole Abandonment | | | | |
| Pits | | | | |
| Underground Openings | | | | |
| Waste Rock Dumps | | | | |
| Foundation & Buildings Area | | | | |
| Lay down/storage yards, Etc. | | | | |
| Drainage & Sediment Control | | | | |
| Mobilization/Demobilization | | | | |
| Other | | | | |
| Subtotal "B" | | | | |
| C. Structure, Equipment and Facility | Labor ⁽¹⁾ | Equipment ⁽²⁾ | Materials | Total |
| Foundation & Buildings Area | \$ | \$ | \$ | \$ |
| Other Demolition | | | | |
| Equipment Removal | | | | |

Voluntary – 43 CFR 3809 Exploration Notice Form

| | | | | |
|-------------------------------------------------------------------|----------------------------|--------------------------------|------------------|--------------|
| Fence Removal | | | | |
| Pipe & culvert Removal | | | | |
| Rip-Rap, rock lining, gabions | | | | |
| Subtotal "C" | | | | |
| D. Monitoring | Labor⁽¹⁾ | Equipment⁽²⁾ | Materials | Total |
| Reclamation Monitoring & Maintenance | \$ | \$ | \$ | \$ |
| Ground and Surface Water Monitoring | | | | |
| Subtotal "D" | | | | |
| E. Construction Management & Support | Labor⁽¹⁾ | Equipment⁽²⁾ | Materials | Total |
| Construction Management | \$ | \$ | \$ | \$ |
| Road Maintenance | | | | |
| Other | | | | |
| Subtotal "E" | | | | |
| F. Operation & Maintenance Costs | Labor⁽¹⁾ | Equipment⁽²⁾ | Materials | Total |
| Subtotal A through E | \$ | \$ | \$ | \$ |
| G. Indirect Costs (see text below for further information) | | | | |
| 1. Engineering, Design and Construction (ED&C) Plan (6.1) | | | | |
| 4. Bond (6.2) | | | | |
| 5. Contractor Profit (6.3) | | | | |
| 6. Contract Administration (6.4) | | | | |
| Subtotal Add-on Costs | | | | |
| GRAND TOTAL | | | | |

RECLAMATION COST ESTIMATION SUMMARY SHEET FOOTNOTES

1. Federal construction contracts require Davis-Bacon wage rates for contracts over \$2,000. Wage rate estimates may include base pay, payroll loading, overhead and profit. (NOTE – Depending on type of operations, it may be issued as a service contract.)

2. The reclamation cost estimate must include the estimated plugging cost for holes utilizing the most reliable assumption of total depth.

3. Miscellaneous items should be itemized on accompanying worksheets.

4. Management plans for hazardous material to include petroleum products

5. Any mitigation measures identified in the Notice must be included in the reclamation cost estimate. Mitigation may include measures to avoid, minimize, rectify and reduce or eliminate the impact, or compensate for the impact.

6. Details in reference to section “G – Indirect Costs” of the table above.

(1) Engineering, design and construction (ED&C) plans are often necessary to provide details on the reclamation needed to contract for the required work. To estimate the cost to develop an ED&C plan use 4. 8% of the operations and maintenance cost. Inclusion of a line item for the development of an ED&C plan may not be necessary for small operations, such as notice-level exploration. With small, uncomplicated reclamation efforts contracting may be able to proceed without developing an ED&C plan.

Voluntary – 43 CFR 3809 Exploration Notice Form

(2) Federal construction contracts exceeding \$100,000 require both a performance and a payment bond (Miller Act, 40 U.S.C. 270 et seq.). Each bond premium is figured at 1.5% of the O&M cost. Enter the sum of both premium costs on this line, as applicable.

(3) For Federal construction contracts, use 7% of estimated O&M cost for the contractor's profit.

(4) To estimate the contract administration cost, use 6 to 10% of the operational and maintenance (O&M) cost.

Comments:

Section 6: Terms and Conditions for Notice Level Operations

Complete Filing and Starting Exploration Operations:

1. If BLM does not take any of the actions described in § 3809.313, you may begin operations no sooner than 15 calendar days after the appropriate BLM office receives your complete notice. BLM may send you an acknowledgement that indicates the date we received your notice. If you don't receive an acknowledgement or have any doubt about the date we received your notice, contact the office to which you sent the notice. This subpart does not require BLM to approve your notice or inform you that your notice is complete.
2. If BLM completes our review sooner than 15 calendar days after receiving your complete notice, we may notify you that you may begin operations.
3. A financial warranty must be provided for the cost of reclamation of the disturbance described in this Notice, pursuant to 43 CFR 3809.500-599. The financial warranty must be submitted prior to entry upon lands for the purpose of prospecting in a manner greater than casual use. Information on additional financial warranties can be found in the regulations. (www.ecfr.gov; title 43, subpart 3809)
4. Your operations may be subject to BLM approval under part 3710, subpart 3715, of this title relating to use or occupancy of unpatented mining claims.
5. Performance standards outlined in 43 CFR 3809.420 must be met during all aspects of the exploration operations. Failure to comply may result in enforcement per 43 CFR 3809.600-605.

Section 7: Departmental Use Only

Case File # _____

Reviewed By: _____

Received on: _____

Response Due by: _____

Remarks:

Notice of Operation

6th PM, T9S, R75W, Sec. 17
Casey Evans
CPD Explorations LLC

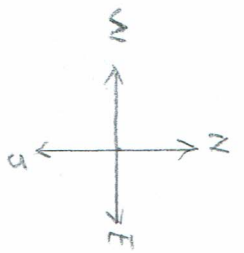

• - proposed pits

Disturbance
Boundary

• 4.68 acres

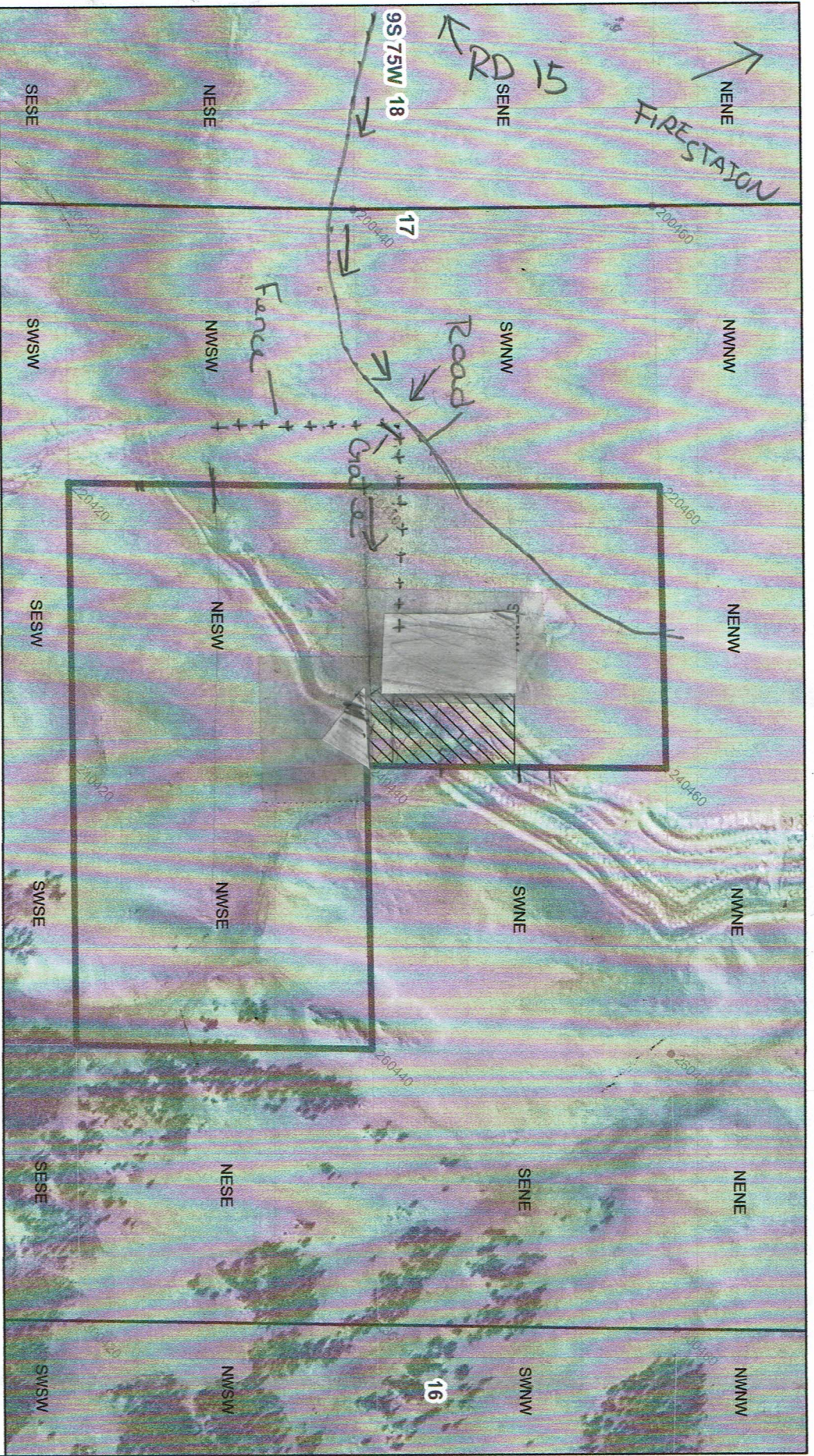

Legend

 Mining Claims Boundary



Disturbance Boundary (4.68 acres)



Bureau of Land Management

Private



State

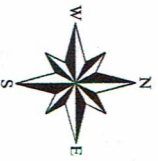

CPD Exploration LLC *Notice of Operation*

6th PM, T9S, R75W, Sec. 17



NOTE TO MAP USERS
No warranty is made by the Bureau of Land Management as to the accuracy, reliability, or completeness of the data layers shown on this map. The official land records of the data providers should be checked or current status on any specific tract of land.

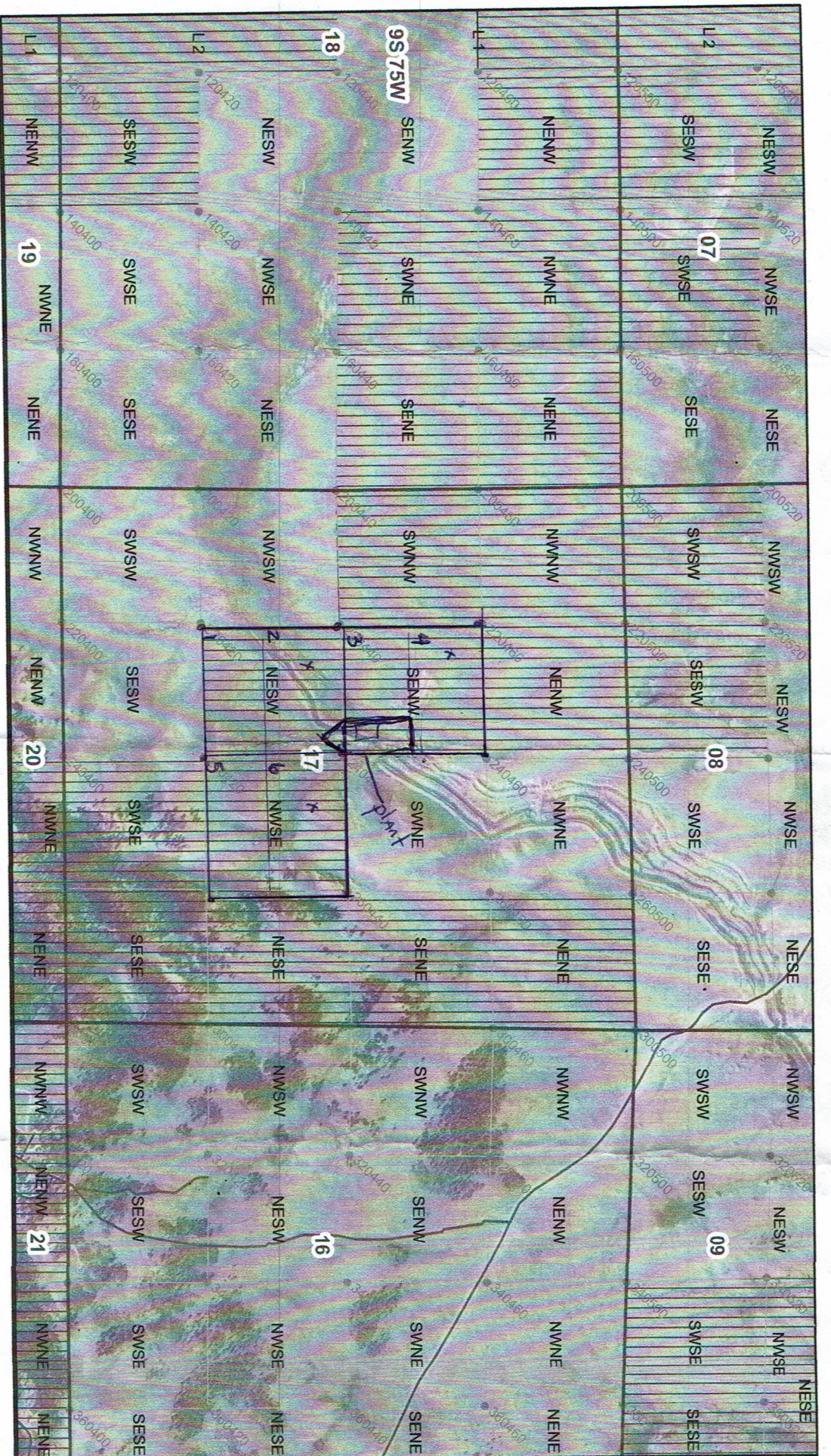

Legend

Overview Map of Region of Interest

Park County - 6th PM, T9S, R75W, Sec. 17

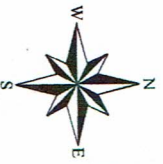

- County & Main Roads
- All Minerals
- No Minerals
- Bureau of Land Management
- Private
- State

0 0.25 0.5 1 Miles

NOTE TO MAP USERS
No warrantee is made by the Bureau of Land Management as to the accuracy, reliability, or completeness of the data layers shown on this map. The official land records of the data providers should be checked or current status on any specific tract of land.

4/19/2021

BLM Additional Information Needed

Received from BLM on 4/2/2021

Casey Evans

CPD Explorations LLC

700 Rosalie Rd

Bailey, Co 80421

720-292-4781

Desert Gold 2-CO105233179 / Desert Gold 3-CO105233180

6th PM, T. 09 S., R. 75 W., Sec. 17

Notice of Operation Additional Information

Everything on Notice of Operation is Max Operations

Photo's will be taken of all work performed for records of time and dates of all activities

1. Mining Plan

a. See Exhibit A Pit - 15 foot Radius x 10 to 12 foot deep max

b. See Exhibit A and C No noise fencing needed, no houses within 1.75 miles. 25 gallon hazardous waste bags/tubs for all tractors trucks 2 inch water pump no oil spills

c. -Monitoring Plan - All pits will be self sufficient, no dam needed. I will only dig one pit at a time, to make sure pits and ponds can overflow by staging pits in appropriated areas. These pits can overflow from flood excess rain etc. to go back into preexisting ditches. I will pump out water if needed. If I encounter water in excavation pit I will immediately fill pit back in and move from that excavation pit. I will pump out water from rain with 2 in pump back to ditch. If any water overflows from ponds, water will overflow into preexisting ditch, next to pond 1-2 shown on EXHIBIT C. Pits will always be safe for all uses, Ponds will be shallow depth tapered at 10 % grad on all sides, max depth of 4 feet. During the time I am not on site all pits/ponds will be as other pits on site. If site is dusty I will water with my 350 gallon water tank to keep wet. I will keep top soil water for long life during pits. No blasting ever.

d. See Exhibit C All equipment will have mufflers for noise level ,there is not a lot of animals near site besides cows. some deere, elk ,crows, very flat area.

e. See Exhibit D- Excavator 2010 model 50G Deere 4.5ton 10,560lb HP 35.9 rubber track ,rental/ 2010 model Kubota KX91 2.5-3 ton mini excavator town in total weight with trailer 10,315lb/ 2006 New Holland LX665 rubber wheels 5,000lb-.72"LP bucket HP 50- 0.6 cu. yds bucket 2500 Chevy Duramax truck 2011 Personal truck/Camper pop-up 2008-rubber wheels 1,900lb total weight/2009 Trailer with 350 gallon water tank on board 1,800lb rubber wheels/ Two Honda 2 in. water pump 2020 Champion

f. ALL Water will be brought in from off site as stated in this Notice of Operation . Each time I will fill up ponds with my own water from Bailey Water Station, I will pay 3\$ every 350 gallons of water. I have a 350 gallon water tank on my trailer. Every day I will fill up on my way to the mine. Ponds will be backfilled in every 14 days a month if required . Then I will dig out and refill every 14 days if necessary

g. I will not be on site for more than 14 days a month, Every 14 day Everything will be removed from site including wash plant, pumps, tractors. Excavation pit will be refilled every 14 days leavening the site with no unnecessary disturbance

h. Dirt Removal from site, max will be 6,000lb pounds of dirt of site concentrate only ever max Every 1,000 tons of dirt /rock will be ran through wash plant only 700 lb. will concentrate and will be moved off site. I will only take out 700 lb. of concentrate every 14 days in a one month period. 80 tons of dirt ran per day for 14 days = 700lb of concentrate. 1,000 lb of dirt ran/per 14 days

I will never excide offsite 100 tons of concentrate on Notice of Operation which is 2 year permit. All other dirt will be put in back in the way it come out every 14 days a month for 6 months a year intel Plan of Operation is completed (May- Nov.) Depending on whether

** I will keep pitcher/records of 5 gallon buckets full of concentrate every 14 days, to keep records. I will not ever be able to run more than 100 tons concentrate in 2 years, off site gold, black sands, rear earth. 700 lbs. concentrate every 14 days will be in 5 gallon buckets. 50lb per bucket 14 - 5 gallon buckets every 14 days a month tell "PoO" is approved or permit expires in 2 years

2. Reclamation Plan

a. I will clean out ponds , left over dirt/rock from 1,000 yards through plant and then place back in to the pit. Then push all dirt back in pit from stockpiled dirt next to pit. Then I will push the top soil back over the top of pit. I will seed top soil 12" deep as I fill and smooth out top soil. Then I will put down hay and water good. Then I will backfill ponds, smooth out, tell next 14 day run. I will run 8-10 hr shifts Nothing will be left on site when I leave every month after 14 days. I will smooth out ponds, top soil, no seeding necessary on ponds will refill 14 days, I will need to dig out again in 14 days if required.** If we cant leave ponds in. All water will be pump into existing ditch next to pond to settle naturally. I will rehabilitate the mine/pits and restore the site to its original or better condition. no contaminants ever, all oils will be cleaned and disposed , I will periodically monitor all possible leaks on equipment. all roads will be reseed ,put hay / straw down if necessary for all top surface disturbances. leave no trash always, make sure I periodically check all land reclaimed by me make sure grass plants are growing. I will always stir up stocked dirt clean rock so that good dirt will be evenly mixed for up good growth longevity of time. If for any reason there is not enough topsoil to support growth I will bring in good top soil if i cant find any ,this area is very river rocky in places ,i want to make ass good ass possible.

-Extra-

Each pit I will dig out 7,000 tons of dirt to remove 1,000 tons of gravel and sand, then bring to wash plant. 700lbs will be concentrate to bring off site. 10 pits total. The 10 pits will be dug on a 5 acre lot. Each pit will be as follows- push 6" of top soil ,stockpile next to pit. Pit will be 15' foot Radius by 10' feet deep see exhibit A. All dirt will be stockpiled next to pit. ready to reclaim after I reach a deep of 10'-12' feet deep. All pits have ditches next to all pits left behind by previous miner. They north to south, they used the ditch to move water for the old floating dredge. This notice of operations mainly for the testing spot/pits to see if its economical to mine my hole 120 acres land "BLM", and what tool /equipment to do so. In the long run "PoO" save all future digging to bar minimum.

EXHIBIT A PIT

$1/8 = 1 \text{ FOOT}$

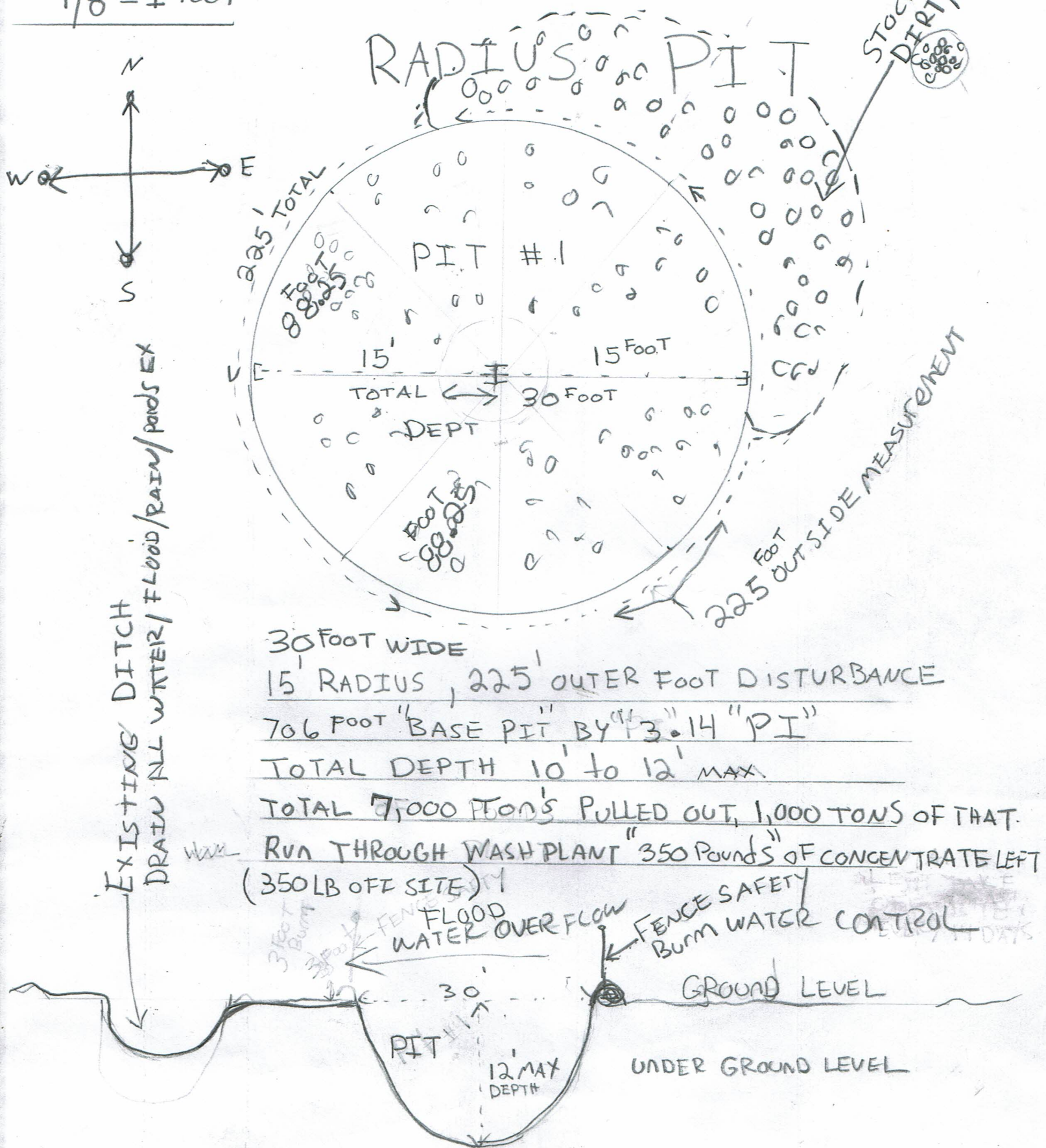

1" 1/2 = 100 feet Exhibit B Site w/ Pits 5 acres

CPD Exploration

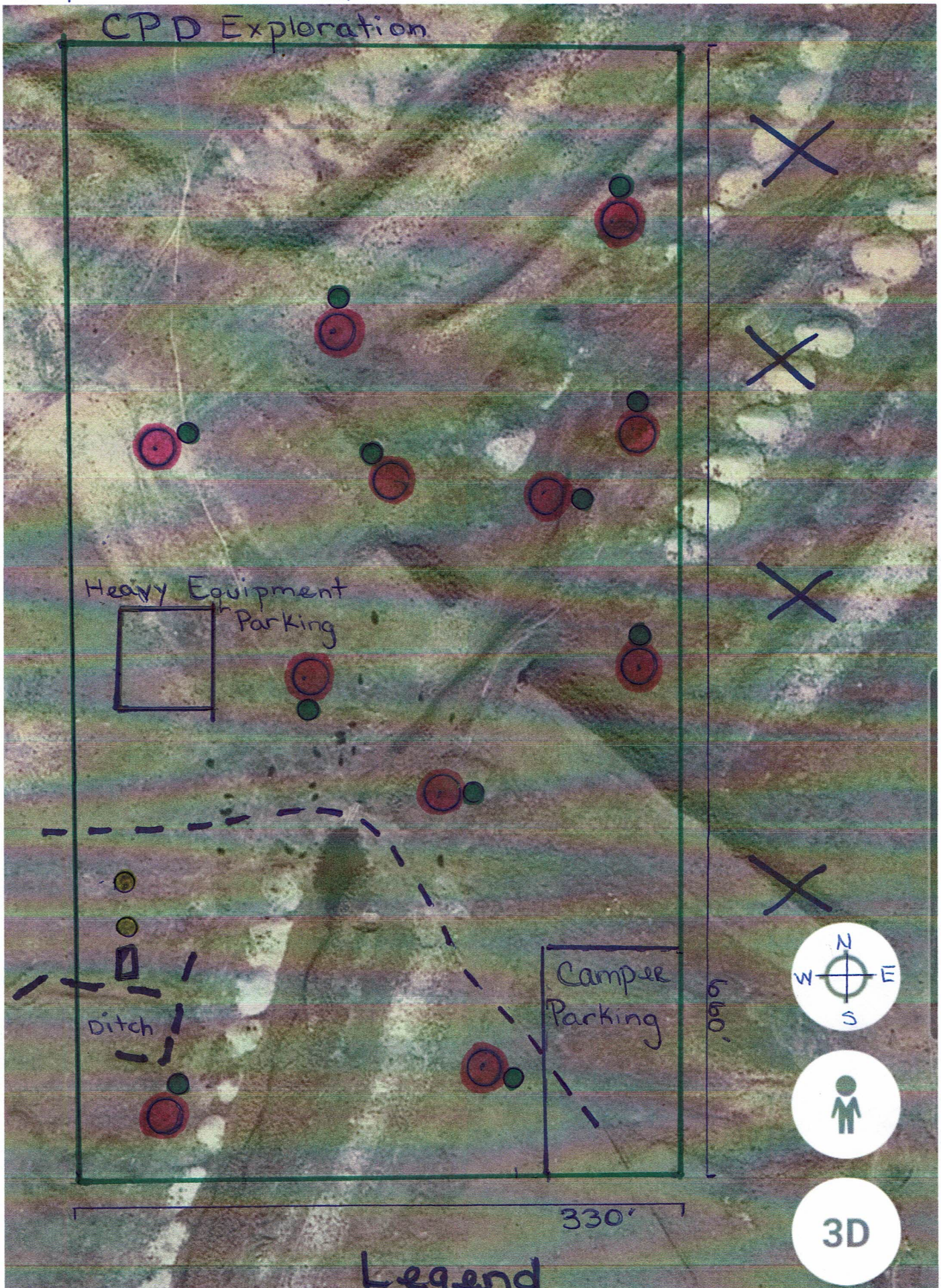

X - Private Land - Dont Dig

Exhibit B.1

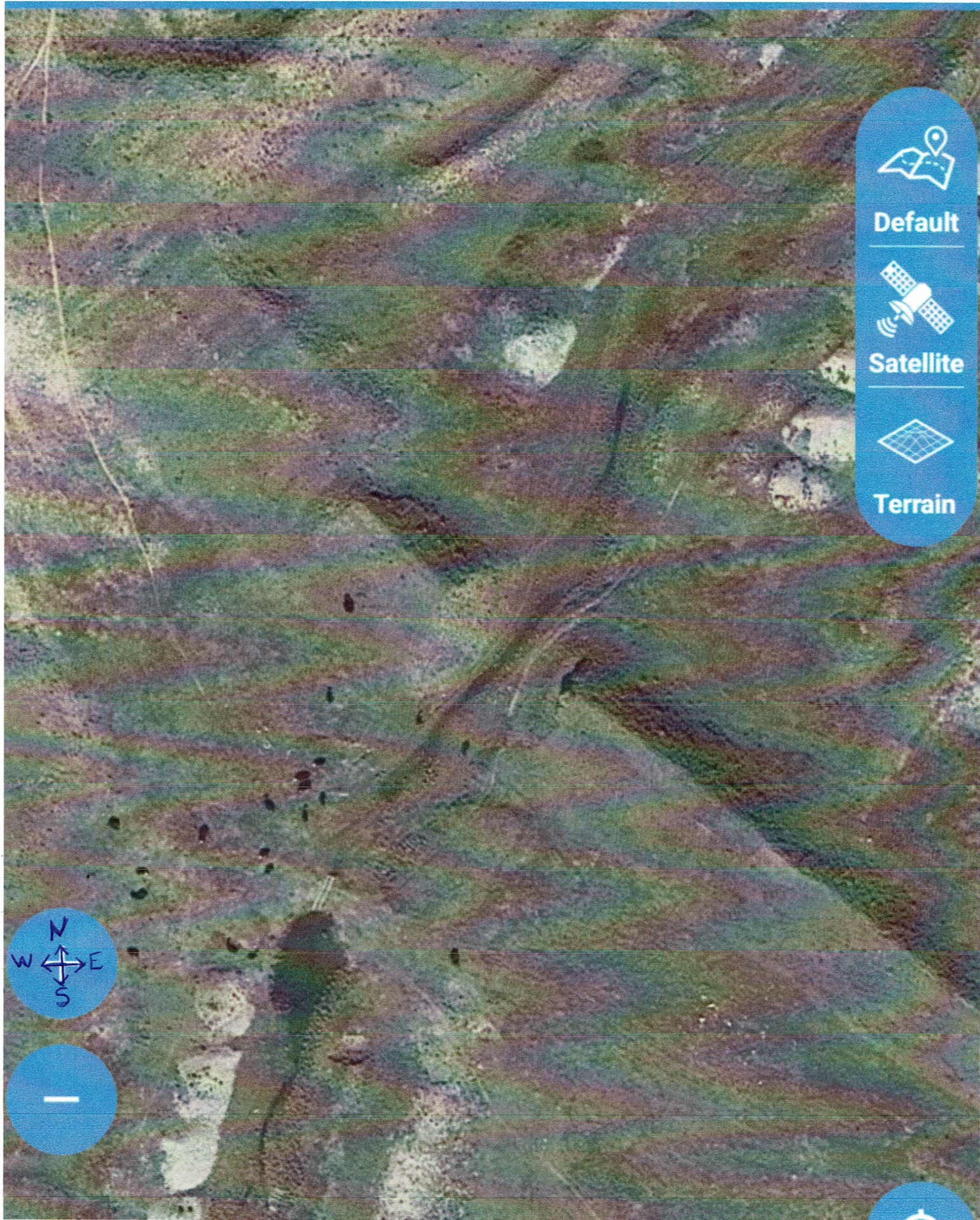

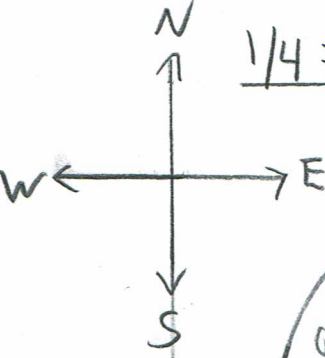

$1/4 = 1 \text{ FOOT}$

EXHIBIT C

POND, LAYOUT STOCK PILED MATERIALS

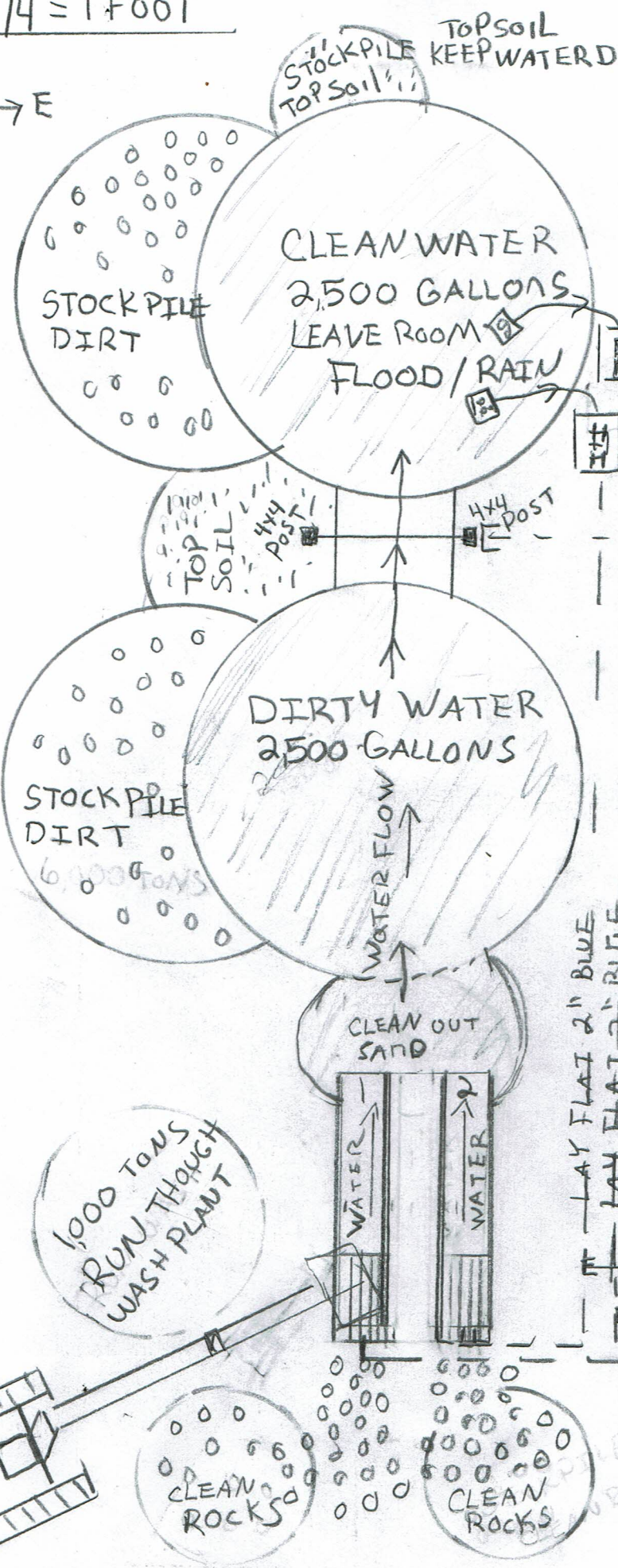

NOTE ■ 4x4 POST

2" WATER PUMP 250 g min

2" WATER PUMP 250 gallons min

LAND SCAPING
ECO GARDENER
PROFESSIONAL GRADE
LANDSCAP FABRIC
FILTER

PONDS NOTS!

10' DIAMETER

4' DEEP

5' RADIUS OF 10

650 CUBIC FEET

5,000 GALLONS

TOTAL MAX

FILL UP 2,500
GALLONS LEAVE
ROOM FLOOD/RAIN
OVER FLOW

2" WATER PUMP CHAMPION

2" WATER PUMP LAY FLAT 2" BLUE

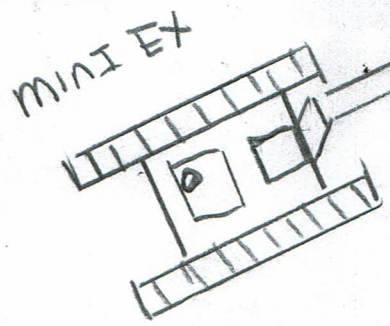

1" INCH = 100' FOOT

EXHIBIT D

HEAVY EQUIPMENT 11 PITS MAX

5 ACRE / CAMPER PARKING / TRUCK PARKING

TRAILER PARKING /

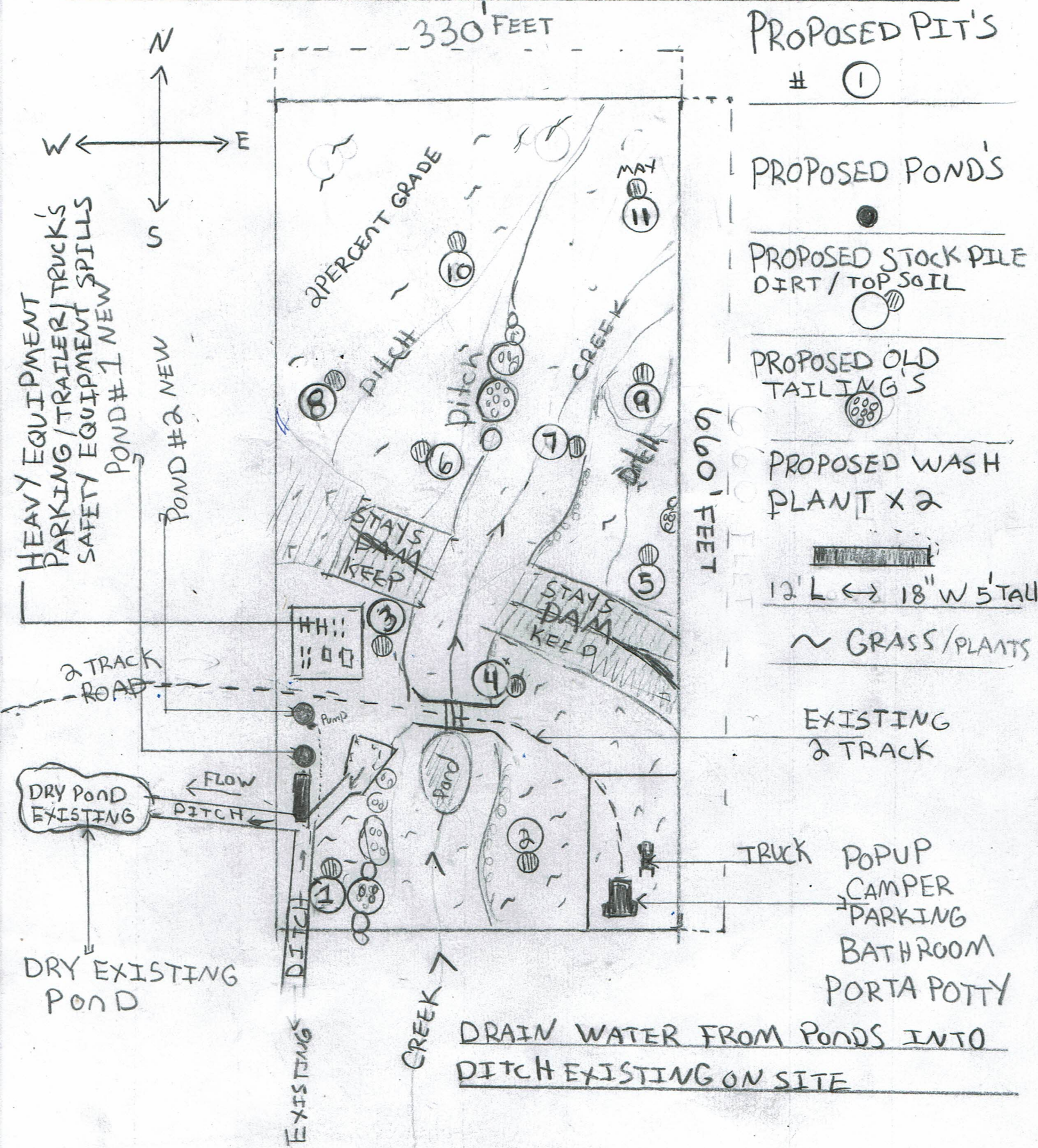

POND'S LAYOUT RADIUS

1/4 = 1 FOOT

MESURMENT'S

EXHIBIT E

INSTALL POND LINER ON EACH POND x2

NOTE'S

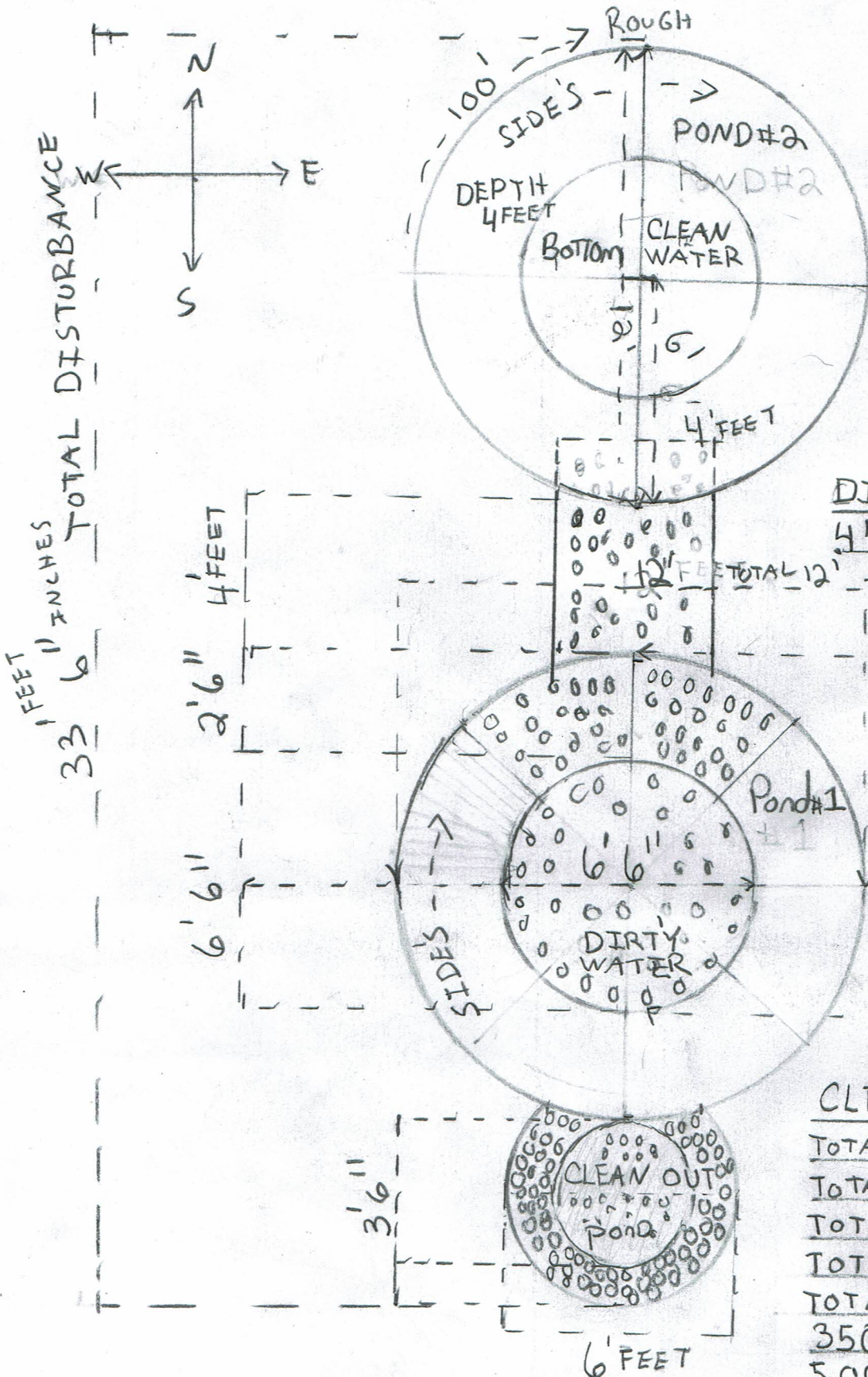

TOTAL W 12' FEET

TOTAL RADIUS 6' FEET

TOTAL DEPTH 4' FEET

INSIDE POND 6' FEET W

INSIDE POND 3' FEET RADIUS

2,500 GALLONS FILL

5,000 GALLONS MAX

NOTES

DITCH DIMENSION'S

4' FEET WIDE

5' LONG

2' DEEP

BOTTOM 2" ROCKS

INSTALL FILTER

SEE EXHIBIT C

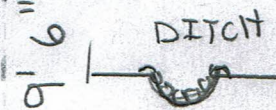

PACK 2" ROCK INTO BOTTOM

NOTE'S

CLEAN OUT POND

TOTAL DEPTH 5' FEET

TOTAL RADIUS 3' FEET TOP

TOTAL WIDTH 6' FEET

TOTAL BOTTOM 3' 6"

TOTAL BOTTOM RADIUS 1' 9"

350 GALLON FILL

500 GALLON MAX

Correspondence with operator Casey Evans

CPD Exploration Notice: COC80497

05/03/2021 at 12:45 pm

Additional information for the CPD Exploration Notice received on 04/19/2021; BLM response deadline was 05/05/2021

Conversation regarding the additional information received for the CPD Exploration Notice; New BLM response deadline is 05/18/2021

During the conversation with the operator, Mr. Evans confirmed the size of the individual excavation pits and the estimated maximum amount of gold concentrate that he intends to remove offsite.

Mr. Evans is estimating to remove off-site a maximum of 200 tons of gold concentrate for the duration of the Notice.

Mr. Evans clarified the size of the proposed excavation pits which consist of a 15-foot radius, 30 foot diameter, and 10-12 foot depth.

A handwritten signature in black ink that reads "Josh Elkington". The signature is fluid and cursive, with the first name "Josh" and last name "Elkington" clearly legible.

Josh Elkington



United States Department of the Interior

BUREAU OF LAND MANAGEMENT
Royal Gorge Field Office
3028 East Main Street
Cañon City, Colorado 81212



3809 LLCOF02000
COC80457

CPD Exploration LLC :
Attn: Casey Evans : Surface Management
700 Rosalie Rd. :
Bailey, CO. 80421 :

ADDITIONAL INFORMATION NEEDED

Dear Mr. Evans:

On April 02, 2021, BLM received the CPD Exploration LLC Notice to explore for gold and rare earth metals on Desert Gold 2 & 3 mining claims, located in 6th PM, T. 09 S., R. 75 W., Section 17. The Notice included excavating 10 test holes at 100 tons per hole of paleo river gravels and processing those gravels using a motorized sluice and water pump.

In accordance with 43 CFR 3809 regulations, BLM is responding within 15 days of receiving this information. BLM has reviewed the Notice to determine if your operation prevents undue or unnecessary degradation (UUD) per 43 CFR 3809.311(c) and whether the Notice meets the content requirements for completeness per 43 CFR 3809.301(b). Based on our review, the following information is still needed for BLM to continue processing the Notice.

1. Mine Plan:

- a. What are the dimensions (length, width, height) of the proposed excavation pits?
Per the Notice received, the excavation pits would be 30 foot wide by 5 foot deep.
Please provide the length dimension of the proposed excavation pits.
- b. Provide a map of the approximate locations of stockpiled materials such as topsoil, concentrate and overburden.
- c. Provide a monitoring plan for site conditions (e.g., erosion, excavation pit stability, water, stormwater controls, etc.)
- d. Provide a diagram of the processing area including the two setting ponds, drainages, fiber filter, sluice, and water pump.

- e. Provide a map where all heavy equipment and lodging (e.g., trucks, travel trailer, mini excavator, and grader) would be located during active operations.
- f. Concerning the proposed water source, the operator needs to contact the South Platte Water Related Activities Program (SPWRAP) to understand if their requirements apply to this operation. It is the operator's responsibility to comply with all applicable Federal and State laws and regulations.
- g. It appears that you may be requesting concurrence of a proposed occupancy proposal per the Notice (e.g., occupying public lands longer than 14-days). Please clarify your intentions based on the regulations under 43 CFR 3715 (Enclosure 1). If you would like to pursue an occupancy, BLM will need to conduct an environmental analysis, in accordance with applicable laws.
- h. Per 43 CFR 3809.11(b) regulations, bulk sampling of 1,000 tons and above of presumed ore requires submittal of a Plan of Operations. Given the amount of tonnage that is proposed to be sampled, please clarify if this is accurate, so this proposed operation can be processed appropriately. If you intend to bulk sample less than 1,000 tons of material and remain at a Notice level, you will need to provide a system of measurement that accurately measures/weights the material. BLM will periodically check the amounts being recorded.

2. Reclamation Plan:

- a. Would the processing water from the lined settling ponds be filtered and drained back into either the creek or natural pond prior to backfilling?

Until a complete Notice is filed with this office, BLM is unable to determine that your proposed operations will not result in unnecessary or undue degradation as defined under 43 CFR 3809.5.

If you have any questions, please contact Stephanie Carter at 719-269-8551.

Sincerely,

**MATTHEW
RUSTAND**

Digitally signed by
MATTHEW RUSTAND
Date: 2021.04.14
16:55:34 -06'00'

Matthew C. Rustand
Acting Field Manager
Royal Gorge Field Office

Enclosure:

1 – 43 CFR 3715 regulations

Spread and Contour - Recontour Disturbed Excavation Pits

- 10 Excavation Pits • Radius - 15ft • Depth - 12ft

Volume of a round hole $\pi(r)^2(\text{Depth})$

$$\pi(15\text{ft})^2(12\text{ft}) = 8,482\text{ft}^3$$

$$8,482\text{ft}^3 \times 0.037037 = 314\text{yd}^3$$

↳ conversion to yd^3

$$314\text{yd}^3 \times 10 = 3,140\text{yd}^3$$

↳ 10 excavation pits

- 3,140 yd^3 is the total volume of material from the excavation pits that will need spread and contour earthwork

Spread and Contour - Recontour settling pond #1

- Radius 5ft • Depth 4ft $\pi(r)^2(\text{Depth})$

$$\pi(5\text{ft})^2(4\text{ft}) = 314\text{ft}^3$$

$$314\text{ft}^3 \times 0.037037 = 12\text{yd}^3$$

↳ Conversion to yd^3

- 12 yd^3 is the total volume of material from a single settling pond that will need spread and contour earthwork

Pond Impoundments - Settling pond #1 (Removal of pond liner)

- Radius 5ft

$$\text{Surface area} = 3\pi r^2$$

$$\text{Surface area} = 3\pi(5)^2 = 236\text{ft}^2$$

- 236 ft^2 is the total surface area of a single settling pond that will need to be removed.

Demolition - Fencing - Removal of fencing surrounding the two settling ponds

- Radius of settling pond 5ft

$$\text{Circumference} = 2\pi r = 2\pi(5\text{ft}) = 31.42\text{ft}$$

Demolition - Fencing - Removal of fencing surrounding the singular excavation pit

- Radius 15ft $C = 2\pi(15\text{ft}) = 94.25\text{ft}$

$$\text{Total fencing demolition} = 31.42 + 31.42 + 94.25 = 157\text{feet}$$

[Project List](#) / [Projects](#) / Reports

[PROJECT INPUT](#) / [SUMMARY REPORT](#) / [DETAILS FOR PROJECT](#)

Report: CPD Exploration Notice

Required Bond Value

\$2,726

Bonds Estimate

| Project Costs | Costs |
|----------------------|---------|
| Earth Moving | \$599 |
| Site Work | \$0 |
| Planting and Seeding | \$140 |
| Closures | \$16 |
| Demolition | \$72 |
| Disposal | \$1,049 |

Project Costs**Costs**

Monitoring

\$0

ISL Remediation

\$0

Mobilization

\$50

Administration

\$800

Required Bond Value

\$2,726

Fleet Requirements**Project Machinery****Machine Size**

Bulldozer

215 horsepower

Flatbed Truck

15,000 pound gvw

Project Machinery

Machine Size

[REDACTED]

Crew Requirements

Project Crew

Requirements

Bulldozer Operators

6.09 hours

Laborers

23.31 hours

Service Truck Drivers

1.93 hours

Mechanics

19.45 hours

Haul Truck Drivers

0.15 hours

[REDACTED]

Mobilization

| Machine | Unit Cost | Trips | Total Cost |
|-----------|----------------|--------|-----------------|
| | (dollars/mile) | (each) | (dollars) |
| Bulldozer | \$1.66 | 0 | [REDACTED] \$50 |

| Machine | Unit Cost | Trips | Total Cost |
|---------|----------------|--------|------------|
| | (dollars/mile) | (each) | (dollars) |

| | | | |
|--|--|--|--|
| | | | |
|--|--|--|--|

| | | | |
|--|--|--|--|
| | | | |
|--|--|--|--|

| | | | |
|-------|--|--|------|
| TOTAL | | | \$50 |
|-------|--|--|------|

Project Cost Summary

| Unit Processes | Costs |
|-------------------------------------------------------------------------------------------------------------------------|-------|
| Recontour Disturbed Excavation Pits | \$597 |
| Recontour Settling Pond 1 | \$1 |
| Recontour Settling Pond 2 | \$1 |
| Seeding: Moss campion, Drummond sedge, Colorado fescue, Western Indian paint brush, Black root sedge, Bellardi kobresia | \$140 |
| Removal of fencing | \$72 |
| Settling Pond 1 (Removal of Pond Liner) | \$8 |
| Settling Pond 2 (Removal of Pond Liner) | \$8 |
| Disposal of 2010 Deere Excavator model 50C | \$679 |

| Unit Processes | Costs |
|------------------------------------------------|-----------------------|
| Disposal of processing sluice box - Supper Hog | \$42 |
| Disposal of 2006 Holland LX665 Skid Steer | \$328 |
| Bulldozer Mobilization | \$50 |
| TOTAL | ██████ \$1,926 |

Project Overhead Costs

Project Cost

Project Operation and Maintenance Costs ██████ \$1,926

| Overhead Costs | Percentage | | Costs |
|--------------------------|------------|---|--------------|
| Project Contingency ⑦ | 7.00 | % | ██████ \$135 |
| Contractor's Profit ⑦ | 10.00 | % | ██████ \$193 |
| Liability Insurance ⑦ | 1.50 | % | ██████ \$29 |
| Bond Premium ⑦ | 0.00 | % | \$0 |
| Engineering and Design ⑦ | 6.00 | % | ██████ \$116 |

| Overhead Costs | Percentage | | Costs |
|----------------------------------|------------|---|--------------|
| Agency's Indirect Costs ② | 14.00 | % | ██████ \$270 |
| Agency Contract Administration ② | 21.00 | % | ██████ \$57 |
| Project Overhead Cost | | | ██████ \$800 |

All edits to this document were made and approved by Amber Sanderson,
Geologist, BLM RGFO

AMBER
SANDERSON

Digitally signed by
AMBER SANDERSON
Date: 2021.05.12
12:47:25 -06'00'

CPD Exploration Notice Bond Outline

The complete bond review for the CPD Exploration Notice consists of earth moving, seeding, pond closures, demolition of fencing, and the disposal of machinery.

- The bond estimate for earth moving consists of the spread and contour work for all 10 proposed excavation holes and the two settling ponds. The dozing segment for each is the diameter of the proposed excavation holes/settling ponds. The earthwork parameters for the volume estimate are found at the bottom of this document.
- The bond estimate for seeding utilizes a high county seed mix which the operator provided: Moss campion, Drummond sedge, Colorado fescue, Western Indian paint brush, Black root sedge, Bellardi kobresia. The estimated area of seeding is 1 acre due to the size of the proposed 10 excavation pits, settling ponds, processing area, and parking area for the mine equipment/travel trailer.
- The bond estimate for the removal of the two pond liners include parameters of the pond surface area and pond depth.
- The bond estimate for the demolition/removal of fencing considers that fencing would be around the two settling ponds and the singular active excavation pit. The parameters used in this bond estimate include the type of fencing, height of fencing, and the total length of the fence (calculated via circumference).
- The bond estimate for the disposal of machinery only includes the 2010 Deere Excavator model 50G, Supper Hog - processing sluice box, and 2006 Holland LX665 Skid Steer. The parameters used in this bond estimate include mobility & operational status, machine weight, and the transport distance. The other equipment such as the rental mini excavator, Chevy truck, travel trailer, water pump, and trailer with a 350-gallon water tank are not considered in this bond estimate.
- The bond estimate for mobilization is \$50. The bulldozer would be the only equipment requiring mobilization.

Spread and Contour - Recontour Disturbed Excavation Pits

- 10 Excavation Pits • Radius - 15ft • Depth - 12ft

Volume of a round hole $\pi(r)^2(\text{Depth})$

$$\pi(15\text{ft})^2(12\text{ft}) = 8,482\text{ft}^3$$

$$8,482\text{ft}^3 \times 0.037037 = 314\text{yd}^3$$

↳ conversion to yd³

$$314\text{yd}^3 \times 10 = 3,140\text{yd}^3$$

↳ 10 excavation pits

- 3,140 yd³ is the total volume of material from the excavation pits that will need spread and contour earthwork

Spread and Contour - Recontour settling pond #1

- Radius 5ft • Depth 4ft $\pi(r)^2(\text{Depth})$

$$\pi(5\text{ft})^2(4\text{ft}) = 314\text{ft}^3$$

$$314\text{ft}^3 \times 0.037037 = 12\text{yd}^3$$

↳ Conversion to yd³

- 12 yd³ is the total volume of material from a single settling pond that will need spread and contour earthwork

Pond Impoundments - Settling pond #1 (Removal of pond liner)

- Radius 5ft Surface area = $3\pi r^2$

$$\text{Surface area} = 3\pi(5)^2 = 236\text{ft}^2$$

- 236 ft² is the total surface area of a single settling pond that will need to be removed.

Demolition - Fencing - Removal of fencing surrounding the two settling ponds

- Radius of settling pond 5ft

$$\text{Circumference} = 2\pi r = 2\pi(5\text{ft}) = 31.42\text{ft}$$

Demolition - Fencing - Removal of fencing surrounding the singular excavation pit

- Radius 15ft $C = 2\pi(15\text{ft}) = 94.25\text{ft}$

$$\text{Total fencing demolition} = 31.42 + 31.42 + 94.25 = 157\text{feet}$$