

Note: Map permit boundary and map features are illustrative and not based on a survey.

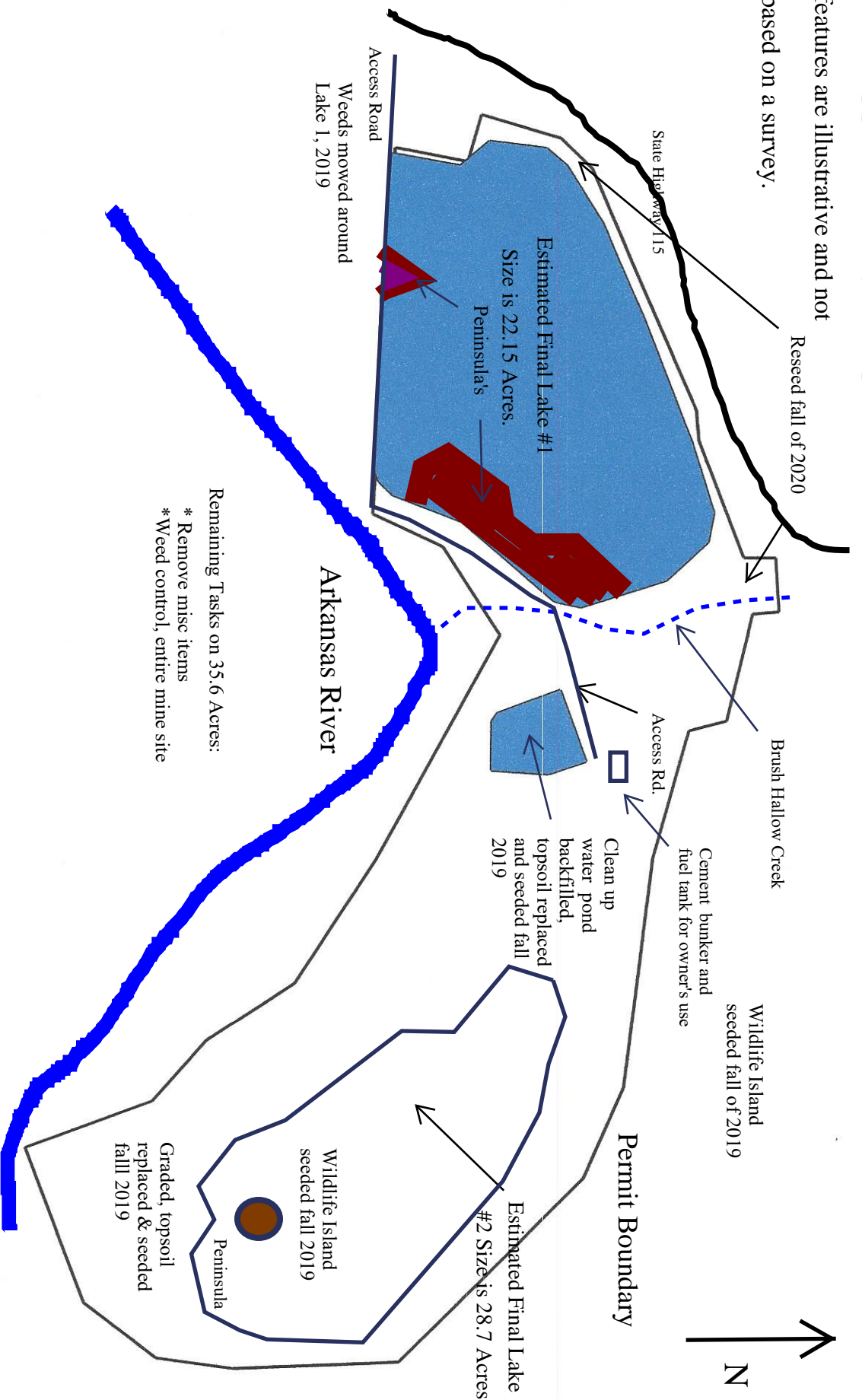

M2001-005 Grisenti Farms Gravel Pit

5-24-2021

Scale: 1 inch= 500 feet

File: Permit boundary with ponds.ndp

Operator: Continental Materials, Inc.

Permit Area 115.3 Acres Gravel pit located in Fremont County