



MINERALS PROGRAM INSPECTION REPORT
PHONE: (303) 866-3567

The Division of Reclamation, Mining and Safety has conducted an inspection of the mining operation noted below. This report documents observations concerning compliance with the terms of the permit and applicable rules and regulations of the Mined Land Reclamation Board.

MINE NAME: Dist No 2 Gravel Pit	MINE/PROSPECTING ID#: M-1979-216	MINERAL: Sand and gravel	COUNTY: Fremont
INSPECTION TYPE: Monitoring	INSPECTOR(S): Timothy Cazier, P.E.	INSP. DATE: March 30, 2021	INSP. TIME: 11:05
OPERATOR: Fremont County	OPERATOR REPRESENTATIVE: Sterling Rife	TYPE OF OPERATION: 110c - Construction Limited Impact	
REASON FOR INSPECTION: Normal I&E Program	BOND CALCULATION TYPE: None	BOND AMOUNT: No Bond Held	
DATE OF COMPLAINT: NA	POST INSP. CONTACTS: None	JOINT INSP. AGENCY: None	
WEATHER: Cloudy	INSPECTOR'S SIGNATURE: 	SIGNATURE DATE: May 21, 2021	

GENERAL INSPECTION TOPICS

This list identifies the environmental and permit parameters inspected and gives a categorical evaluation of each. No problems or possible violations were noted during the inspection. The mine operation was found to be in full compliance with Mineral Rules and Regulations of the Colorado Mined Land Reclamation Board for the Extraction of Construction Materials and/or for Hard Rock, Metal and Designated Mining Operations. Any person engaged in any mining operation shall notify the office of any failure or imminent failure, as soon as reasonably practicable after such person has knowledge of such condition or of any impoundment, embankment, or slope that poses a reasonable potential for danger to any persons or property or to the environment; or any environmental protection facility designed to contain or control chemicals or waste which are acid or toxic-forming, as identified in the permit.

(AR) RECORDS----- <u>Y</u>	(FN) FINANCIAL WARRANTY----- <u>NA</u>	(RD) ROADS----- <u>Y</u>
(HB) HYDROLOGIC BALANCE----- <u>Y</u>	(BG) BACKFILL & GRADING----- <u>Y</u>	(EX) EXPLOSIVES----- <u>NA</u>
(PW) PROCESSING WASTE/TAILING---- <u>Y</u>	(SF) PROCESSING FACILITIES----- <u>Y</u>	(TS) TOPSOIL----- <u>Y</u>
(MP) GENL MINE PLAN COMPLIANCE- <u>Y</u>	(FW) FISH & WILDLIFE----- <u>Y</u>	(RV) REVEGETATION---- <u>Y</u>
(SM) SIGNS AND MARKERS----- <u>Y</u>	(SP) STORM WATER MGT PLAN---- <u>Y</u>	(RS) RECL PLAN/COMP-- <u>Y</u>
(ES) OVERBURDEN/DEV. WASTE----- <u>Y</u>	(SC) EROSION/SEDIMENTATION--- <u>Y</u>	(ST) STIPULATIONS----- <u>Y</u>
(AT) ACID OR TOXIC MATERIALS----- <u>Y</u>	(OD) OFF-SITE DAMAGE----- <u>Y</u>	

Y = Inspected / N = Not inspected / NA = Not applicable to this operation / PB = Problem cited / PV = Possible violation cited

OBSERVATIONS

This inspection was conducted as part of the regular monitoring program. The Permittee (Fremont County) was represented by Mr. Sterling Rife during the inspection. The east permit boundary is shared with the west permit boundary of another Fremont County permitted pit (M-2000-056 / Union Hill Gravel Pit) which was inspected at the same time. A separate inspection report will be generated for the Union Hill Gravel Pit.

The Dist No 2 Gravel Pit site entrance is located approximately 0.5 miles north of Florence off Hwy 67. This is a 110c gravel mine. It was not operating at the time of the inspection.

Availability of Records: Annual fees are paid through January 2021. [The DRMS notes the maps submitted with the annual reports show the property boundary, not the permit boundary as required. Please provide a map showing the permit boundary with next year's annual report.](#) The previous inspection was on June 16, 2016. The approved post-mine land use is industrial/commercial. The original permit states the most probable use for the site is an expansion of the solid waste landfill on the north side of the site. There are no open infractions. Both the surface and minerals are owned by Fremont County. No revisions have been made to this permit.

Acid And Toxic Materials: No acid or toxic materials are involved in this operation.

Backfilling and Grading: Sufficient backfill material appeared to be available.

Excess Spoil and Dev. Waste: Overburden piles were observed, and appeared stable.

Financial Warranty: As the site is permitted by the County, no bond is required.

Fish and Wildlife: No impact to wildlife was observed.

Hydrologic Balance: No standing water was observed in the pit and no exposed groundwater was observed.

Gen. Compliance with Mine Plan: The operation appeared to be in compliance with the approved mine plan. The maximum allowed disturbed area is 9.9 acres. Google Earth was used to measure the disturbed area, which was estimated to be approximately 7.7 acres, based on 2019 imagery. Highwalls were highest on the north side (see **Photo 1**), estimated to be 20 feet in height and lower (~15 feet in height) in the southeast corner (see **Photo 2**). Highwalls appeared stable.

Off-site Damage: The operation appeared to be confined to the permit boundary, based on Google Earth review and site observations.

Processing Waste: A stockpile of material had been pushed up on the east end of the pit to expose the shale layer underneath. (see **Photo 3**).

Roads: Haul and access roads did not appear to be a source of sediment that could be tracked offsite.

Right of Entry: Fremont owns the land and mineral rights.

Reclamation Success: Mr. Rife indicated this site is all but mined out. The County has completed the grading (to ~3H:1V), placed topsoil and seeded the highwalls on the north and south portions (see **Photo 4**) of the pit. The pushed up material in **Photo 3** remains to be graded out and the pit floor will need to be topsoiled and seeded.

Revegetation: Mr. Rife indicated the north (south facing) slope had been seeded, whereas the south slope and pit floor are self-revegetated. No noxious weeds were observed.

Sediment Control: No erosion problems were observed and no BMPs were needed at the time of the inspection.

Support Facilities On-site: No equipment was observed on site.

Signs and Markers: The permit sign was properly posted (see **Photo 5**) and boundary markers were observed to delineate the permit boundary (see **Photo 4**).

Permit Stipulations: There are no permit stipulations.

Storm Water MGT Plan: No oil or fuel spills observed. Stormwater drains to the pit floor (see **Photo 6**) and infiltrates.

Topsoil: Topsoil was salvaged on the order of 40 years ago and was of poor quality as is the topsoil in most of this region. Mr. Rife presumed the stockpiles located on the northwest (see **Photo 7**) and southeast crests (see **Photo 4**) are what remains of the salvaged topsoil. [This material should be spread on the pit floor prior to final seeding to help assure vegetation is re-established.](#)

Structures: No structures were observed within 200 feet of the affected area.

Please contact Tim Cazier (303)866-3567 ext. 8169 or email at tim.cazier@state.co.us if you have any questions regarding this report.

PHOTOGRAPHS



Photo 1. North (south facing) reclaimed highwalls (looking NE from pit floor).

PHOTOGRAPHS (cont.)



Photo 2. South / southeast partially reclaimed highwalls (looking south from east pit floor).



Photo 3. Pushed up stockpiled material left from exposing shale layer on pit floor (south side, looking east).

PHOTOGRAPHS (cont.)

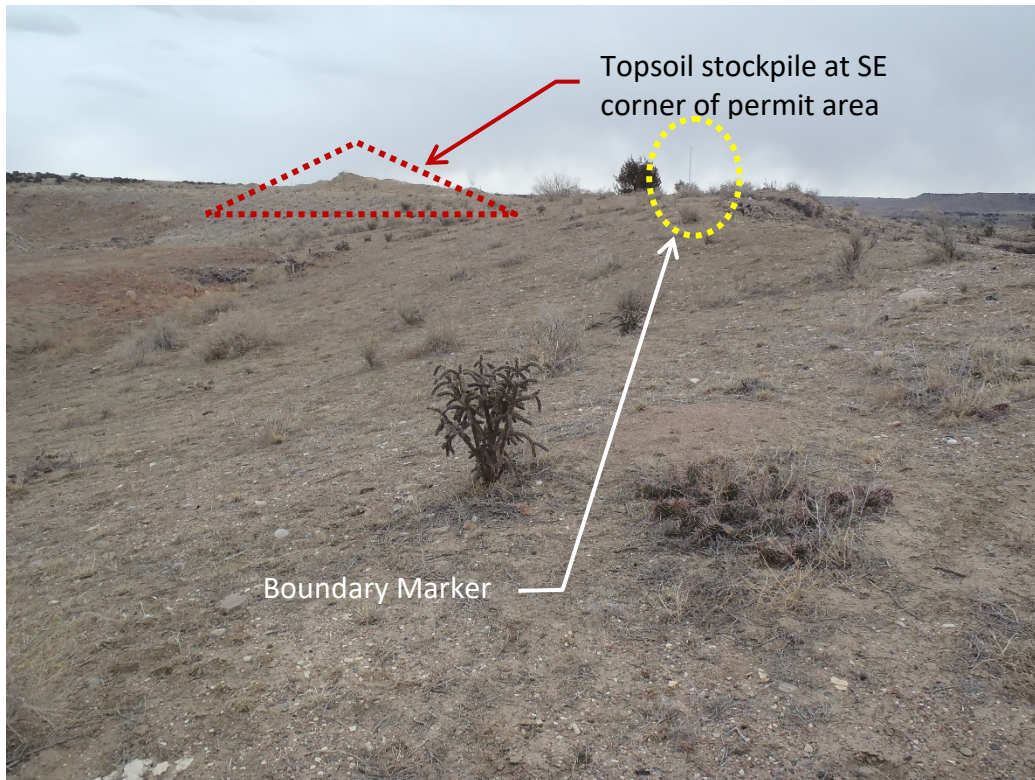

Photo 4. Crest of south self-vegetated highwall (looking east).



Photo 5. Permit sign at entrance (includes newer Union Hill permit accessed from the same entrance).

PHOTOGRAPHS (cont.)



Photo 6. Low point in pit where stormwater infiltrates (east end looking west).

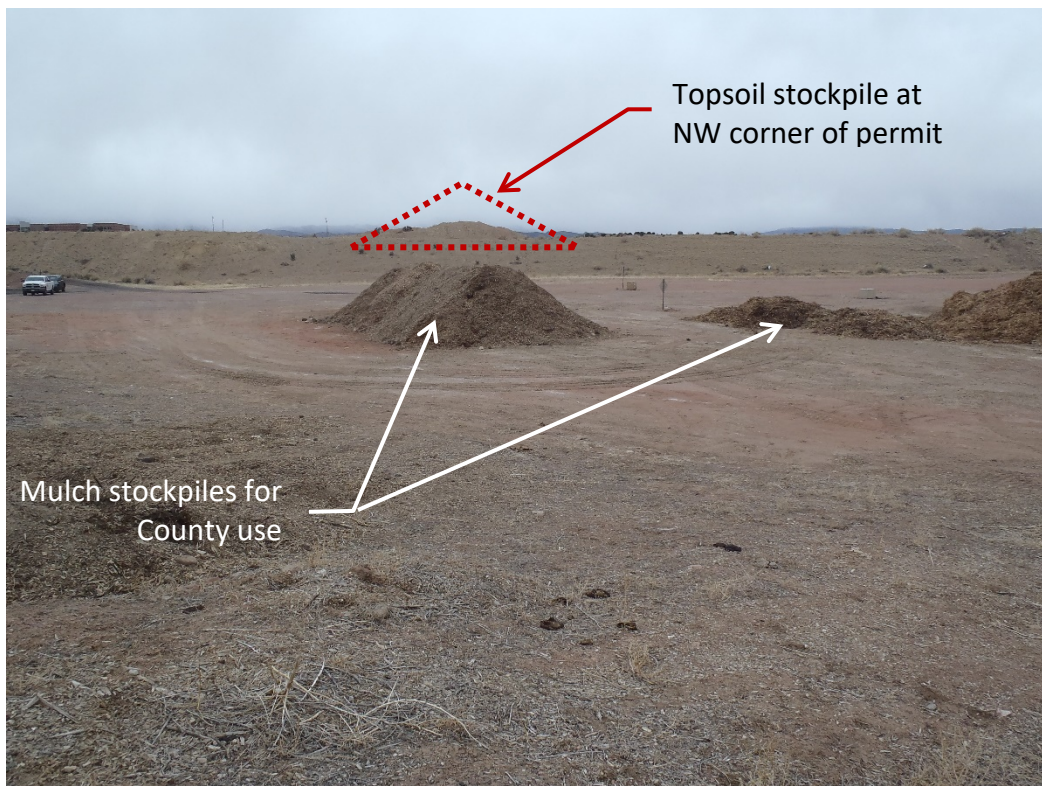

Photo 7. Screen, conveyor, loader, and backhoe (south side).

Inspection Contact Address

Sterling Rife
Fremont County
1170 Red Canyon Road
Canon City, CO 81212

ec: DRMS file
Annette Ortega, Fremont County