

LEGEND

- PERMIT BOUNDARY
- SECTION LINE
- STREAMS
- POSTMINING CONTOUR
- DISTURBANCE BOUNDARY
- A-A' CROSS SECTION LINES FOR COLLOM PIT (SEE MAP 20C)
- AFFECTED AREAS

POSTMINING LAND USE IS "RANGELAND"

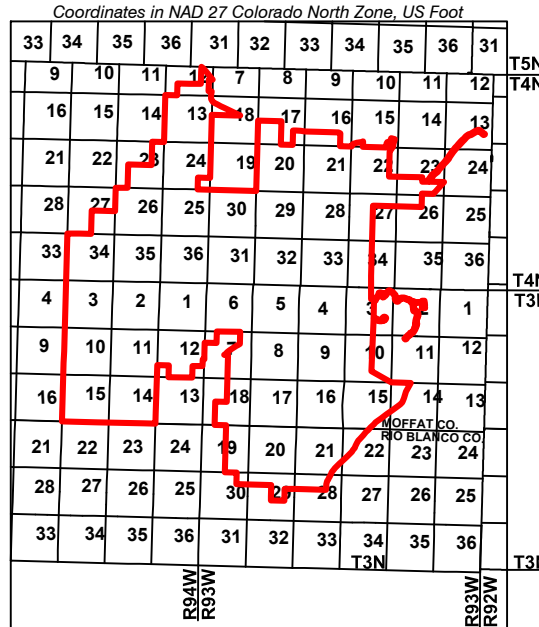
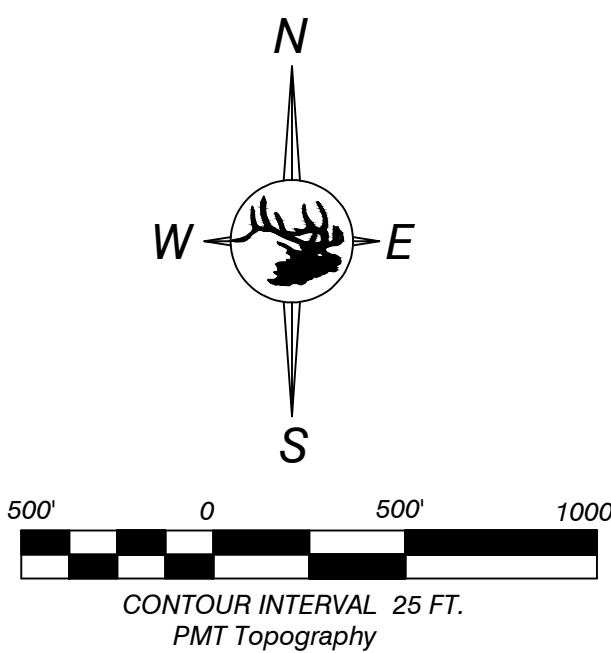

ENGINEERS CERTIFICATION
I, LEE E. SAMMONS, hereby certify that this map has been reviewed by me and is true and correct to the best of my knowledge and information, relying on information supplied by experts employed by Colowyo Coal Company or qualified consultants working for Colowyo Coal Company, and that I am a Professional Engineer licensed in Colorado as required by the provisions of C.R.S. 12-20-101 through C.R.S. 12-20-119. IN WITNESS WHEREOF, I have hereunder set my hand and affixed my seal.



POSTMINING TOPOGRAPHY
Collom Area



SCALE: 1" = 500'
DATE: 5/28/06
DRAWN BY: JCP
APPROVED BY: TONY
DRAWN NO.

MAP 19C

| No. | REVISION | DATE | BY | CHK |
|--------|--------------------------------------|---------|------|-----|
| TR-118 | REVISED DISTURBANCE BOUNDARY | 1/19/18 | TONY | AA |
| TR-134 | ADDED AFFECTED AREAS, UPDATED LEGEND | 10/1/19 | TONY | AA |
| TR-147 | UPDATED AFFECTED AREAS | 4/26/21 | TONY | AA |