

LEGEND

- Permit Boundary
- Roads
- Streams
- Spoil Grading by Year
- Disturbance Boundary
- Reclaimed Areas
- Regraded Areas

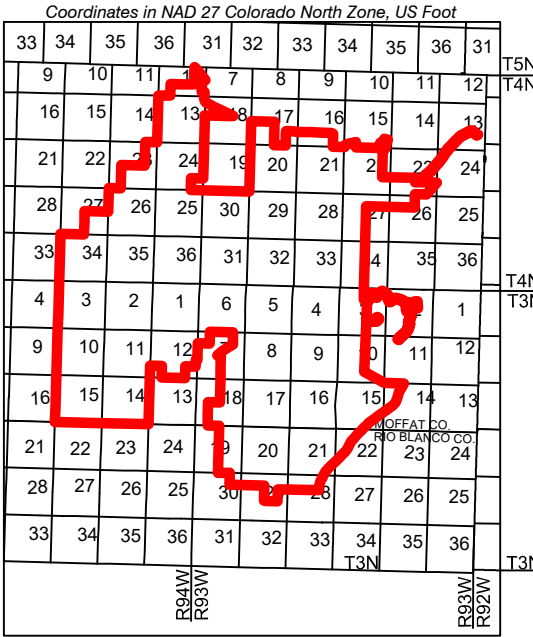

ENGINEERS CERTIFICATION
I, LEE E. SAMMON, hereby certify that this map has been reviewed by me and is true and correct to the best of my knowledge and information, relying on information supplied by experts employed by Colowyo Coal Company or qualified consultants working for Colowyo Coal Company, and that I am a Professional Engineer licensed in Colorado as required by the provisions of C.R.S. 12-25-101 through C.R.S. 12-25-110. IN WITNESS WHEREOF, I have hereunder set my hand and affixed my seal.

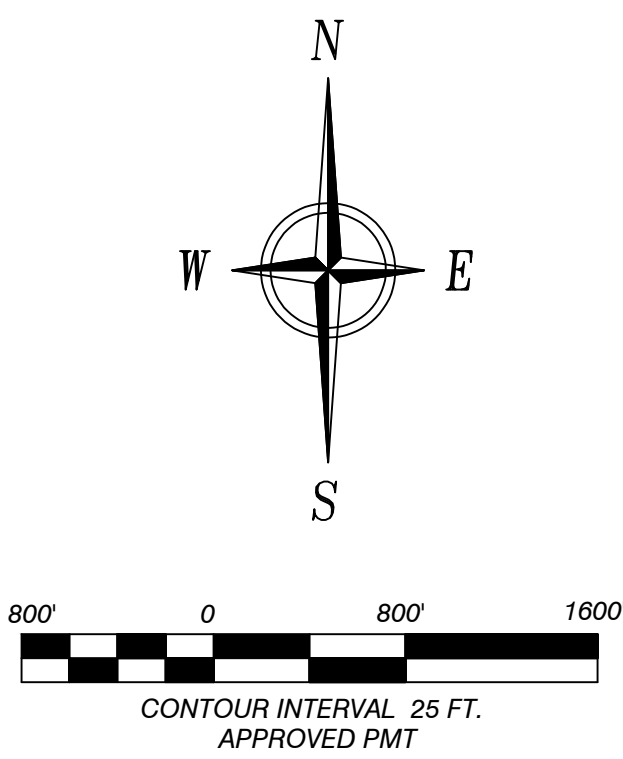

SPOIL GRADING
West & South Taylor Pits



SCALE: 1" = 800'
DATE: 2/20/2021
DRAWN BY: JTD/DES
APPROVED BY: TAT
DRWG NO. MAP 29

No.	REVISION	DATE	BY	CHK
TR-135	Updated Permit Boundary, Reclamation, and Spoil Blocks Consolidated Map 29 and 29A into one map.	12/20/19	TONY	JG
TR-141	Updated Permit Boundary	8/13/20	TONY	AA
TR-145	Revised PMT & Spoil Grading Blocks/Timing	11/16/20	TONY	LES
TR-145	Revised Spoil Grading Blocks/Timing	3/23/21	TONY	LES

Note: All spoil grading areas shown have an approved variance from contemporaneous reclamation. Please see Volumes 1, Section 4.13 and Volume 12, Section 2.05.4(2)(c).