

1/6/2019 1:15:46 PM - \\ITT-LOCAL\VER\PROJECTS\ENVER\235141\33-23514-17005\CAD\SHEETFILES\DRMS\F-3 EXHIBIT F EAST AREA RECLAMATION PLAN.DWG - ANDRYAUSKAS, JEREMY

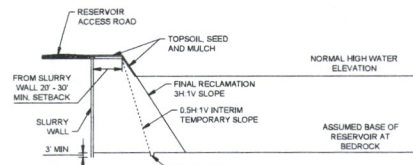

THIS MAP WAS PREPARED BY TETRA TECH IN COOPERATION WITH AGGREGATE INDUSTRIES-WCR, INC. AGGREGATE INDUSTRIES-WCR, INC. WILL KEEP THE DIVISION OF RECLAMATION, MINING, AND SAFETY INFORMED OF ANY CHANGES TO THE MINING OR RECLAMATION PLANS THROUGH ANNUAL REPORTS AND FILE TECHNICAL REVISIONS OR AMENDMENT APPLICATIONS AS NECESSARY THROUGHOUT THE LIFE OF THE MINE.

THOMAS HESEMANN



1 TYPICAL RESERVOIR CROSS-SECTION

NOTE: UNDERGROUND UTILITIES NOT SHOWN.

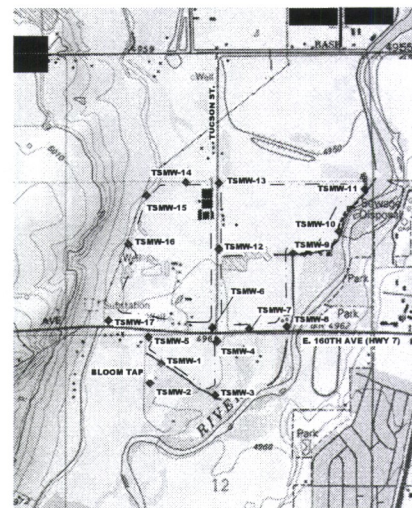

MONITORING WELL LOCATION MAP

NTS

The area known as the "south parcel" was removed in TR-02 approved by the DRMS on August 11, 2020. This 24.3 acre area is removed in this acreage reduction.

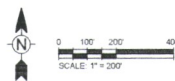

LEGEND:

-

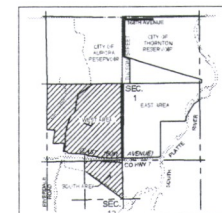

KEY MAP
NOT TO SCALE



TETRA TECH

300 S. Sunset St., Ste. 1-E
Longmont, CO 80501
Phone: (303) 772-5262

AGGREGATE INDUSTRIES - WORK INC.			DATE	DESCRIPTION	BY
1	THRU	FIRST AGENCY RETURN RESPONSE			
2	THRU	SECOND AGENCY RETURN RESPONSE			
3	THRU	THIRD AGENCY RETURN RESPONSE			

EXHIBIT F

**SOUTH AREA & WEST AREA
RECLAMATION PLAN**

Project No.:	200-23514-18004
--------------	-----------------

Designed By:	
Checked By:	

Drawn By:	
Checked By:	

Checked By:	

F-2

EXHIBIT

Bar Measures 1 inch

Copyright © 2004 John Wiley & Sons, Ltd.