

# McATEE CONSTRUCTION CO.

HARLEY PIT #1 - M-1986-147

ANNUAL REPORT 2019-2020

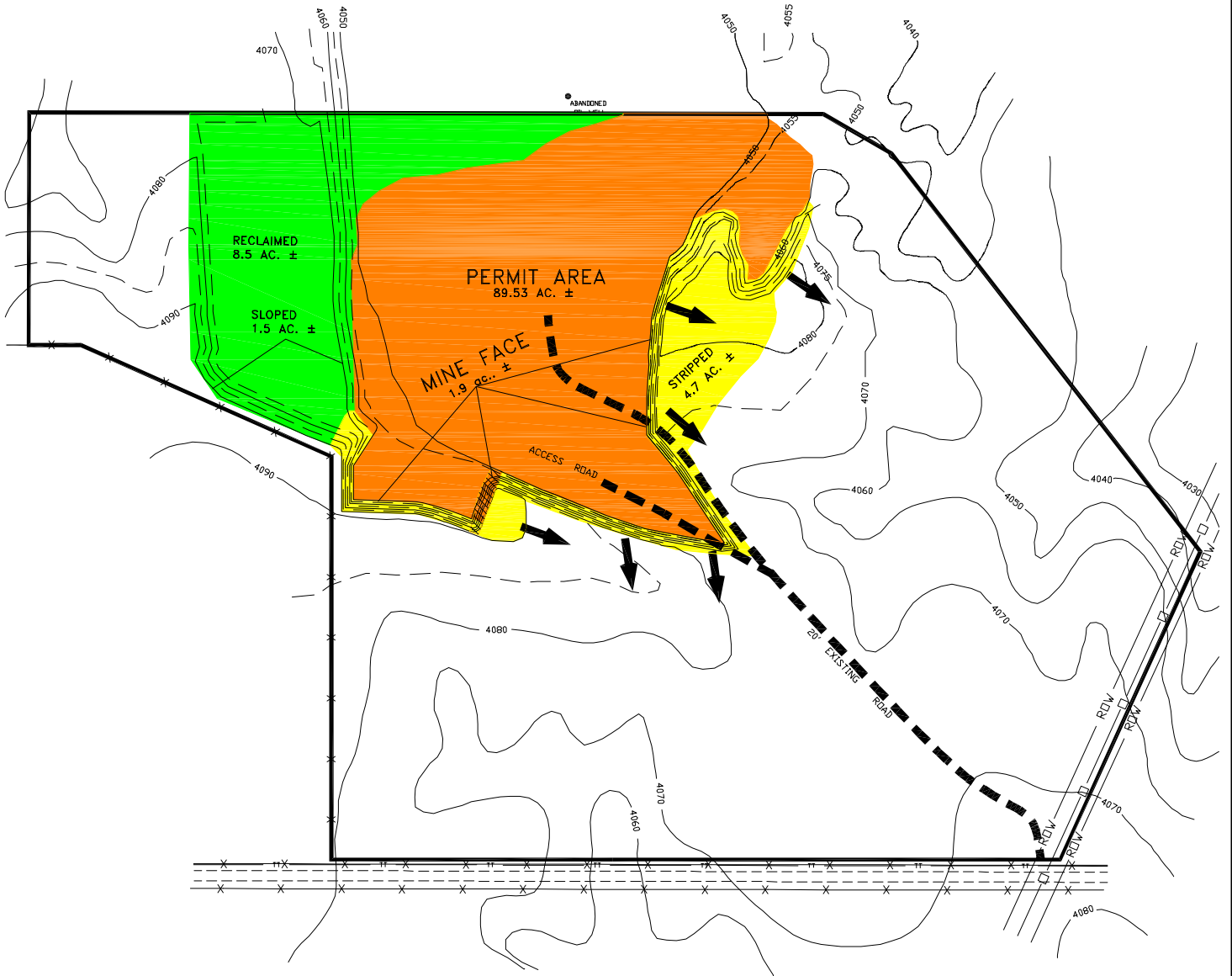

SCALE 1"=200'

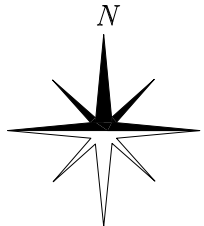

NOV 30, 2020 - 12:34:11

PREPARED BY: *ENVIRONMENT, INC.*  
7985 VANCE DR., # 205A  
ARVADA, CO 80003  
(303) 423-7297



MINING DIRECTION



MINE FLOOR AREA - 17.6 AC. ±



PARTIALLY MINED 2020 - 0.11 AC. ±



STRIPPED & PARTIALLY MINED - 4.7 AC. ±

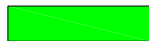

RECLAIMED & SEEDED AREA - 8.5 AC. ±

## LEGEND

- AFFECTED LANDS
- ROADS
- ABANDONED OIL WELL
- WINDMILL
- FENCE