

CARGILL, INC

BEGING PART OF THE SOUTH EAST 1/4 OF SECTION 23,
TOWNSHIP 3 NORTH, RANGE 47 WEST OF THE 6TH P.M.
YUMA COUNTY, COLORADO

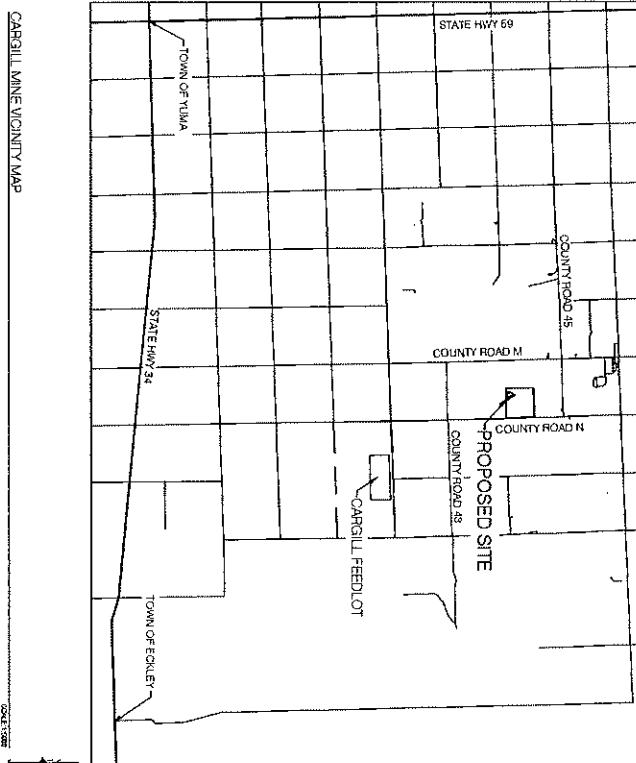

APPLICANT INFORMATION
CARGILL, INC.
12000 N. 10TH ST.
SUITE 200
DENVER, CO 80231
PHONE: (303) 755-5001
FAX: (303) 755-5015
AGPRO PROJECT # 154291

PROJECT TEAM
AGPRO PROFESSIONALS, LLC
3050 87th AVENUE, SUITE 200, GREELEY, CO 80634
PHONE: (970) 535-9318
FAX: (970) 535-9854

BY PROFESSIONAL ENGINEER
DATE PREPARED: _____

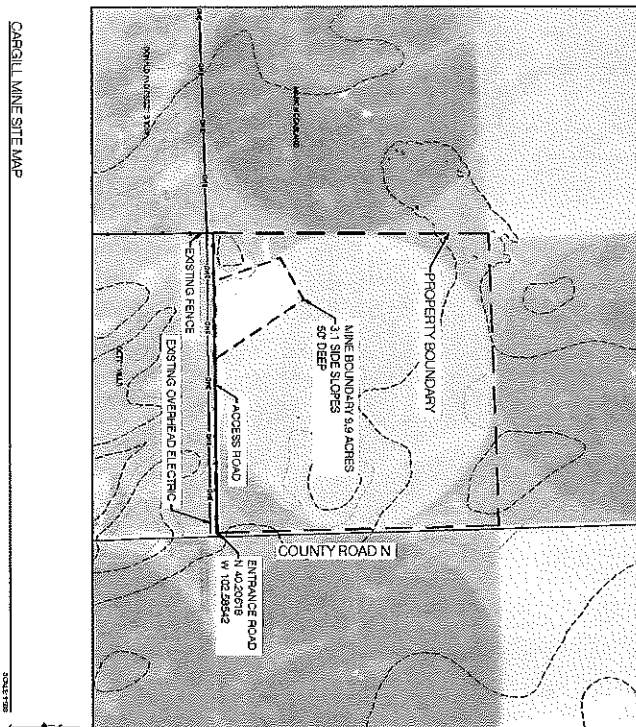

LEGEND:

--- PROPERTY BOUNDARY

--- MINE BOUNDARY

--- EXISTING OVERHEAD ELECTRIC

--- EXISTING BARBED WIRE FENCE

E-1

SHEET

CARGILL, INC
LOCATION MAP - EXHIBIT E-1
YUMA COUNTY, COLORADO



AGPROprofessionals
DEVELOPERS OF AGRICULTURE
3050 87th Avenue, Suite 200, Greeley, CO 80634
(970) 535-9318 • fax (970) 535-9854



DATE	BY	REVISION	DATE	BY	REVISION
11/11/2013	AGPRO				
11	AGPRO	1.0			
12	AGPRO	1.1			
13	AGPRO	1.2			
14	AGPRO	1.3			
15	AGPRO	1.4			

BEING PART OF THE SOUTH EAST 1/4 OF SECTION 23,
TOWNSHIP 3 NORTH, RANGE 47 WEST OF THE 6TH P.M.
YUMA COUNTY, COLORADO

LAINE BOUNDARY 9.9 ACRES
3:1 SIDE SLOPES
50' DEEP
ELEV AT SURFACE 3985

MARK MCCASLAND

-PROPERTY LINE

EXISTING FENCE

DONALD AND PEGGY BROWN

BENTY'NILLS

YAW ELECTRIC ASSOCIATION, INC.
EXISTING OVERHEAD ELECTRIC

EXISTING MINING PERIMETER

ACCESS ROAD

1815.55

LEGEND:

- = PROPERTY BOUNDARY
- = MINE BOUNDARY
- = EXISTING OVERHEAD ELECTRIC
- = EXISTING BARBED WIRE FENCE
- = INDEX CONTOURS WITH ELEVATIONS
- = INTERMEDIATE CONTOURS WITH ELEVATIONS
- = EXISTING MINE PERIMETER

COUNTY ROAD N

~~CARGILL MINE PLAN MAP~~
~~DATE: 07 APRIL 2017~~

SCALE: 1:1000

77
3

SHEET:

CARGILL, INC
MINING PLAN MAP - EXHIBIT E-3
YUMA COUNTY, COLORADO



AGPROessionals
DEVELOPERS OF AGRICULTURE

3050 67th Avenue, Suite 200, Greeley, CO 80634
(970) 535-9318 • fax (970) 535-9854



OCL 4412297		DRIVER AGED
REMARKS		
01	DECE	4-1-1
02	DECE	4-1-1
03	DECE	4-1-1
04	DECE	4-1-1
05	DECE	4-1-1