

LEGEND	
BOUNDARIES	
DRMS Permit Boundary	
200' Offset of DRMS Permit Boundary	
Section line	
Found section corner	
STRUCTURES	
Building	
Well	
Tanks	
Fence	
Power transmission line, pole, tower	
Power transmission line, buried	
Telephone/data line, above ground	
Telephone/data line, buried	
Buried water line	
Highway	
Light duty road, paved	
Light duty road, gravel	
Unimproved road	
Trail	
Road block, berm, or barrier	
Gate on road	
Cattle crossing guard	
Railroad	
CONTOURS	
Baseline Index	
Baseline Intermediate	
Post-Mining Index	
Post-Mining Intermediate	
Post-Reclamation Index	
Post-Reclamation Intermediate	
RIVERS, LAKES, SHORELINES, AND CANALS	
Perennial stream/ditch	
Perennial river	
Intermittent stream/ditch	
Intermittent river	
Dam	
Perennial lake/pond	
Intermittent lake/pond	
Dry lake/pond	
Elevated aqueduct, flume, or conduit	
Waterwell	
Spring or seep	
Drainage Basin	
Flood Plain	
MINING FEATURES	
Fixed Structures	
Mobile Structures	
Mining Phases	
Berm/windrow	
VEGETATION (NRCS Ecological Site Description)	
Woodland	
Shrubland/Scattered Trees	
NRCS Ecological Site Boundary	
WETLANDS (USFWS National Wetland Inventory)	
Freshwater Emergent	
Freshwater Forested/Shrub	
Estuarine	
Riverine	

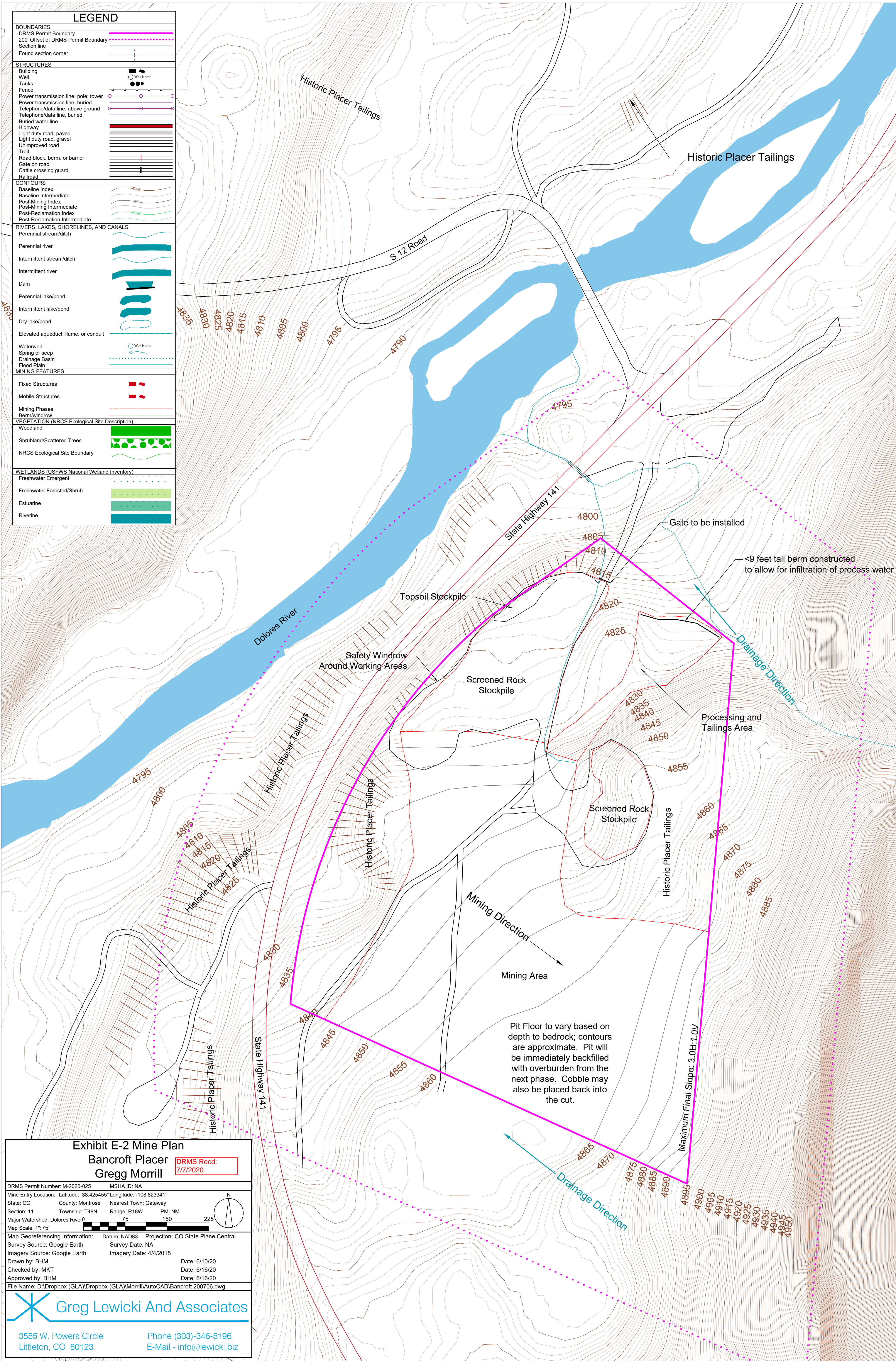

Exhibit E-2 Mine Plan

Bancroft Placer

Gregg Morrill

DRMS Recd:
7/7/2020

DRMS Permit Number: M-2020-025

MSHA ID: NA

Mine Entry Location: Latitude: 38.425455° Longitude: -108.823341°

State: CO County: Montrose Nearest Town: Gateway

Section: 11 Township: T48N Range: R18W PM: NM

Major Watershed: Dolores River

Map Scale: 1"= 75'

0 75 150 225

Map Georeferencing Information: Datum: NAD83 Projection: CO State Plane Central

Survey Source: Google Earth Survey Date: NA

Imagery Source: Google Earth Imagery Date: 4/4/2015

Drawn by: BHM Date: 6/10/20

Checked by: MKT Date: 6/16/20

Approved by: BHM Date: 6/16/20

File Name: D:\Dropbox (GLA)\Dropbox (GLA)\Morrill\AutoCAD\Bancroft 200706.dwg

Greg Lewicki And Associates

3555 W. Powers Circle

Littleton, CO 80123

Phone (303)-346-5196

E-Mail - info@lewicki.biz