

Lone Tree Pit Annual Progress Report
By the Huerfano County Noxious Weed Department

Date of Review: 4-30-20

Site: 37.67722 -104.72776

Permit #: Lone Tree - Permit #M-2014-034

Status: Active\Idle

County: Huerfano

State: Colorado

Type: Non-metallic surface

Reviewed By: C. Bryant CDA Applicator License#: 33222

A. SITE OBSERVATIONS

The mined\disturbed area of the Lone Tree Pit is approximately 11 acres. This site is currently idle, but still considered active. Mining operations will resume at an undetermined future date. Disturbed areas have seen the establishment of limited native vegetation, with large bareground areas occupying most of the acreage, as reclamation efforts have yet to be implemented. Portions of the perimeter berm have a considerable amount of western or possibly thick-spike wheatgrass along with limited amounts of cheatgrass and Russian thistle.

B. COLORADO STATE LIST NOXIOUS WEEDS PRESENT

While conducting the reclamation process review, only a few of state "C list" noxious weeds were encountered, primarily along the main haul road. The observed species were: Redstem filaree and cheat grass.

1. Distribution of Noxious\Invasive Species

The greatest density of Kochia, cheatgrass and Redstem filaree were encountered along the perimeter of the haul road and in a few other isolated areas that seem to be consistent with quantities found elsewhere in the undisturbed, non-mine areas immediately surrounding the site. Redstem filaree, Kochia and cheatgrass did not appear to be forming any monocultures as is common with these varieties, and their overall threat level was deemed insignificant.

Lone Tree Pit Annual Progress Report

By the Huerfano County Noxious Weed Department

2. Anticipated Treatment Methods

Given the drought situations that the region is experiencing, Russian thistle is likely to become problematic. Russian thistle tends to favor drought conditions and can quickly displace native plant species. A spring time\early summer chemical application of **E2 herbicide (2,4-d+dicamba+fluroxypyr) @ 2 pints\acre** will be used to control the areas where Russian thistle appears to be problematic. While Russian thistle is not a Colorado State List noxious species, it is a non-native invasive species that will hamper reclamation efforts if left unchecked. The **C list species** documented on site will be monitored and site operations are anticipated to exert enough pressure to preclude any further growth or establishment during active operation. All state list noxious weed species will be monitored and control efforts will be taken should the overall density and coverage increase beyond tolerable thresholds, unless control is otherwise directed by the Bureau of Reclamation.

C. CONCLUSION OF ANNUAL REVIEW

After a comprehensive review of site conditions and plant inventory, the overall site condition has been deemed **satisfactory**. The satisfactory progress status was determined due to the following factors:

1. An absence of noxious weed species with the exception of those areas\species as described above.
2. The amount and density of native vegetation present onsite.
3. The absence of soil erosion within the pit and surrounding slopes.
4. The absence of noxious weed species encountered beyond permit boundaries in the immediate area.
5. Final reclamation practices have not been practiced given the active status of the pit.

Lone Tree Pit Annual Progress Report

By the Huerfano County Noxious Weed Department



Lone Tree Pit Annual Progress Report

By the Huerfano County Noxious Weed Department



Lone Tree Pit Annual Progress Report

By the Huerfano County Noxious Weed Department

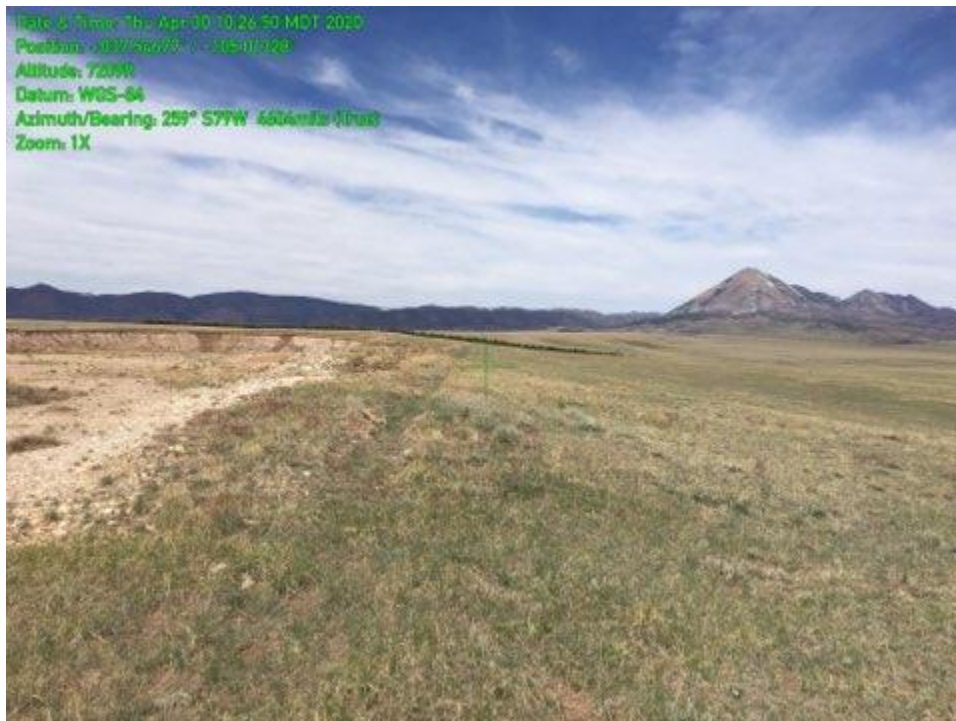

Lone Tree Pit Annual Progress Report

By the Huerfano County Noxious Weed Department

Date & Time: Thu Apr 30 16:32:33 MDT 2020
Position: +037.54590° / -105.01120°
Altitude: 7200ft
Datum: WGS-84
Azimuth/Bearing: 002° N02E 0036mils (True)
Zoom: 1X



Date & Time: Thu Apr 30 16:39:40 MDT 2020
Position: +037.55561° / -105.01120°
Altitude: 7200ft
Datum: WGS-84
Azimuth/Bearing: 002° N02E 1626mils (True)
Zoom: 1X



Lone Tree Pit Annual Progress Report

By the Huerfano County Noxious Weed Department

Date & Time: Thu Apr 30 16:33:43 MDT 2020
Position: +037.54451° / -105.01131°
Altitude: 7205R
Datum: WGS-84
Azimuth/Bearing: 152° SSW 3236mils (True)
Zoom: 1X



Date & Time: Thu Apr 30 18:32:52 MDT 2020
Position: +037.54601° / -105.01125°
Altitude: 7205R
Datum: WGS-84
Azimuth/Bearing: 272° N88W 4836mils (True)
Zoom: 1X



Lone Tree Pit Annual Progress Report
By the Huerfano County Noxious Weed Department

